

NOTE: EXPANSION JOINT TO BE LOCATED AT 6.0 m O.C.

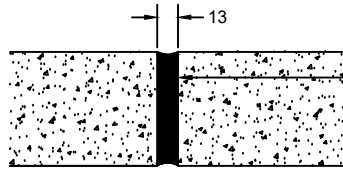

BITUMINOUS FIBRE BOARD WATER-PROOFED WITH SEALANT

EXPANSION JOINT

NOTE: CONTROL JOINTS BE LOCATED AT 1.5 m O.C.

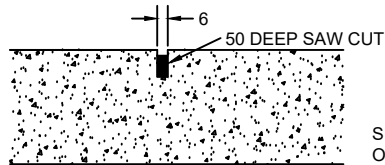

SEE PLAN FOR LOCATION OF CONTROL JOINTS

CONTROL JOINT

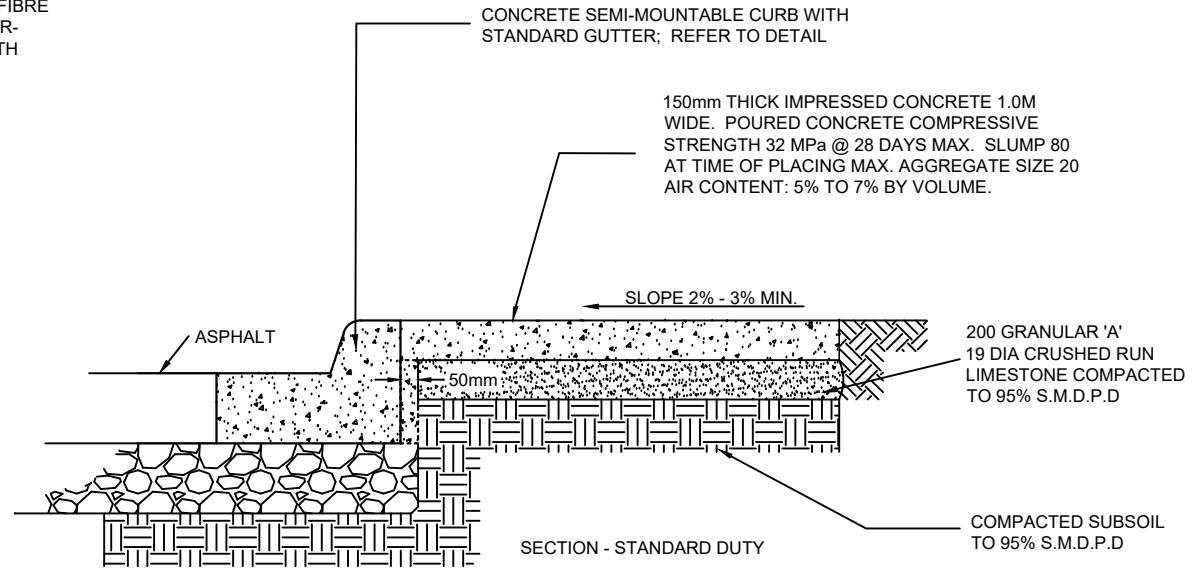

SECTION - STANDARD DUTY

NOTE:

1. COLOUR FOR CONCRETE TO BE REVIEWED AND APPROVED BY THE TOWN OF CALEDON LANDSCAPE ARCHITECT.
2. IMPRESSED CONCRETE PATTERN: 300mm X 300mm WITH SLATE TEXTURE.

TOWN OF CALEDON IMPRESSED CONCRETE SPLASH PAD	4	ADDITION OF ADDITIONAL WIDTH OF CONCRETE AS TYPICAL IN CURB WITH SIDEWALK ADJACENT TO CURB. DIMENSIONED.	JUNE 19	APR'D: C.C.	DATE: 26/06/19
	3	STANDARD No. 218 NOW 221	MAY 19		
	2	ASPHALT THICKNESS CHANGED, NOTE EDIT, STD No. 262 NOW 218	JUNE 08	DRAWN:	SCALE: N.T.S.
	1	ASPHALT AND BASE MATERIAL DIMENSIONS REMOVED, PATTERN AND NOTE ADDED, SIDEWALK REMOVED, NAME CORRECTION	MARCH 08		
	NO.	REVISION	APR'D	DATE	STANDARD No. 221