

CON. 5 W.H.S. (CAL)

CON. 4 W.H.S. (CAL)

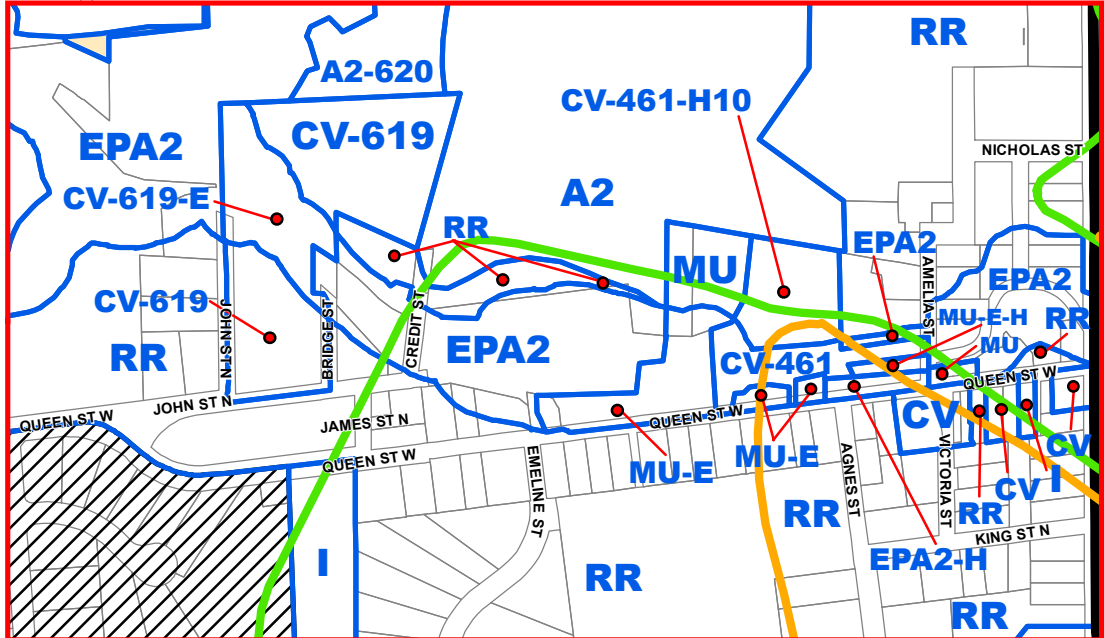

This copy is provided for convenience only. If necessary, the original may be referred to in the office of the Town Clerk.

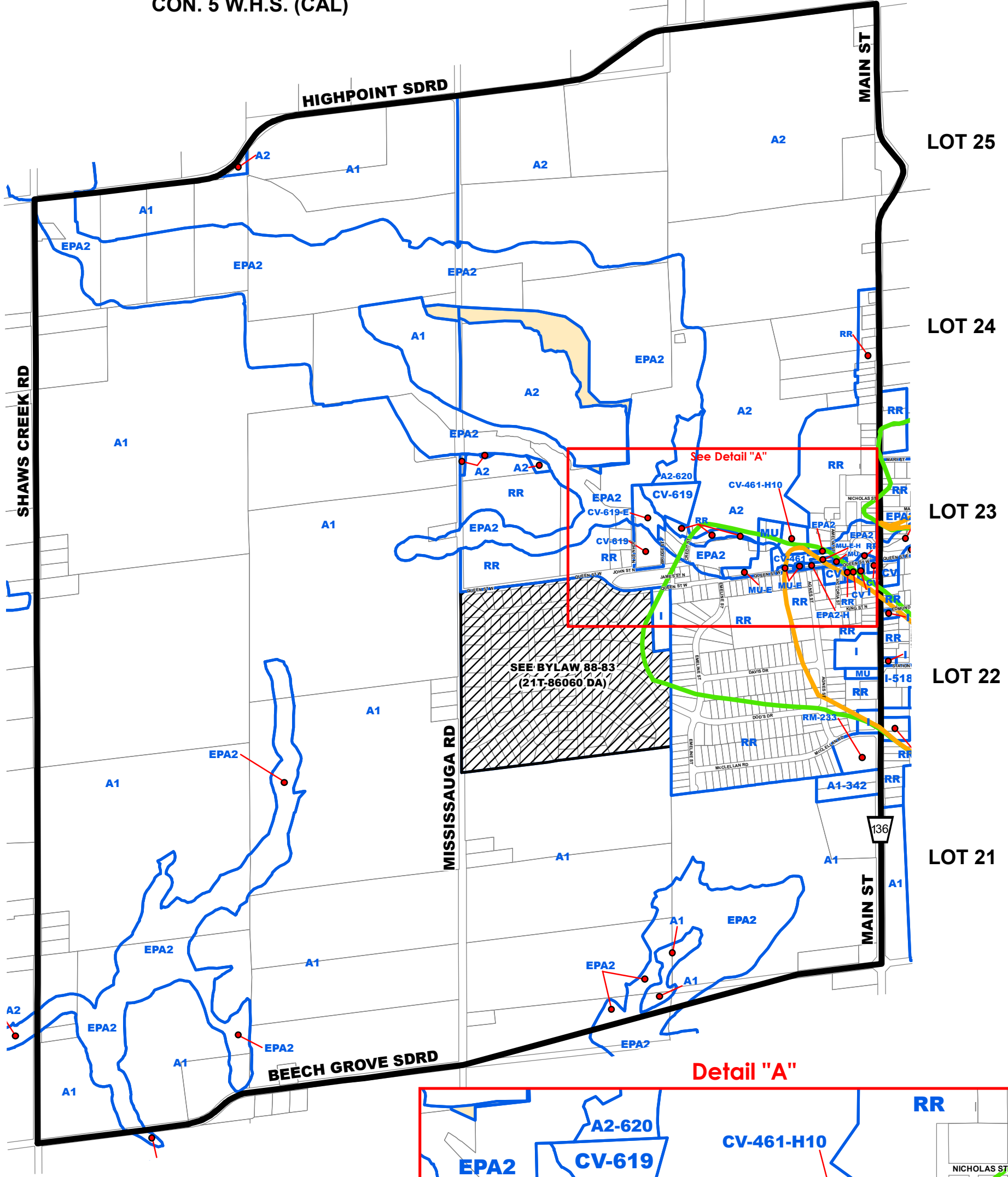
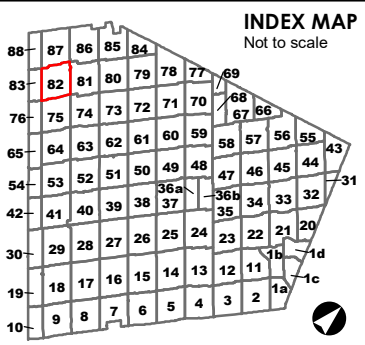

- A2** ZONE SYMBOL
- A2-###** ZONE SYMBOL
Note: Number of suffixes represent Exceptions which can be looked up in the Exceptions section of the By-law.
- [Blue outline]** ZONE BOUNDARY
- [3x3 Grid]** STRUCTURAL ENVELOPE MAP
- [Blue hatched box]** NIAGARA ESCARPMENT DEVELOPMENT CONTROL AREA
Lands lying within the Development Control area pursuant to the Niagara Planning and Development Act are subject to permit requirements under Ontario Regulations 685/50, as amended.
- [Pink hatched box]** OAK RIDGES MORANE CONSERVATION PLAN AREA BOUNDARY
- [Red line]** WELLHEAD PROTECTION AREA BOUNDARY
WP-2 WP-5 WP-10 WP-25
Zone Maps amended to indicate the 2, 5, 10, and 25 year Wellhead Protection Areas.
- [Blue box]** For applicable zoning see By-law 87-250, as amended.

The base data on this map is provided for convenience only. The Town of Caledon is not responsible for any deficiency or inaccuracy in the base data, and will not accept any liability whatsoever therefor. The reproduction of the base data, in whole or in part, by any means is prohibited without the prior written permission of the Town of Caledon.

BY-LAW 2006-50
ZONE MAP 82
SCHEDULE "A"

TOWN OF CALEDON

Date: 3 April 2006 Revised: October 31, 2019

File: S:\POLICY SECTION\GIS\zoning_bylaw\msd\2015_msd

82