

CON. 5 W.H.S. (CAL)

CON. 4 W.H.S. (CAL)

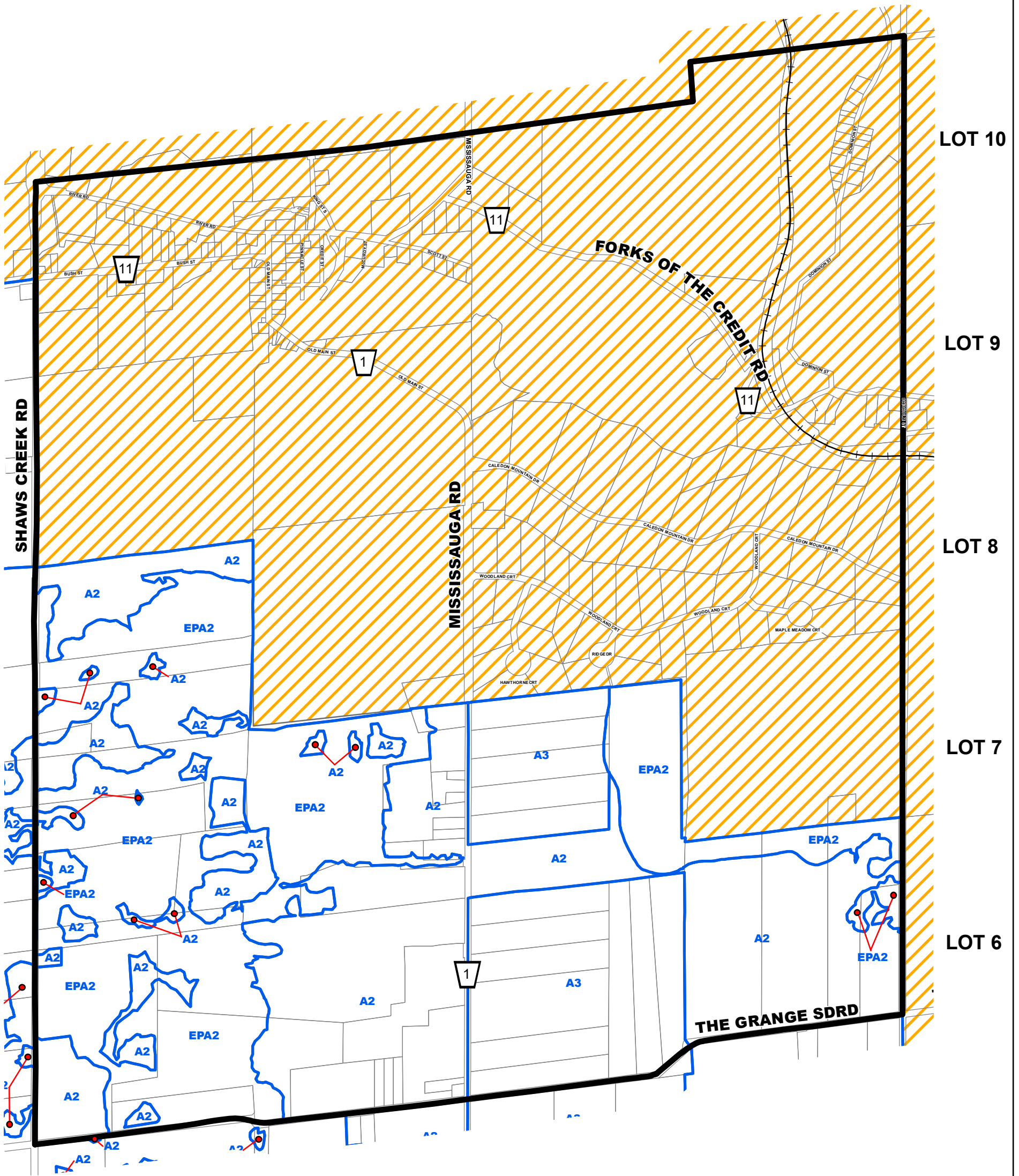

This copy is provided for convenience only. If necessary, the original may be referred to in the office of the Town Clerk.

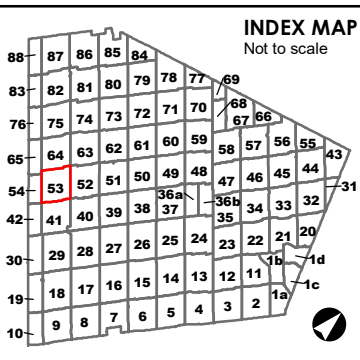

- A2 ZONE SYMBOL**
- A2-### ZONE SYMBOL**
Note: Number of suffixes represent Exceptions which can be looked up in the Exceptions section of the By-law.
- ZONE BOUNDARY**
- STRUCTURAL ENVELOPE MAP**

- NIAGARA ESCARPMENT DEVELOPMENT CONTROL AREA**
Lands lying within the Development Control area pursuant to the Niagara Planning and Development Act are subject to permit requirements under Ontario Regulations 685/50, as amended.
- OAK RIDGES MORAINÉ CONSERVATION PLAN AREA BOUNDARY**
- WELLHEAD PROTECTION AREA BOUNDARY**
WP-2 WP-5 WP-10 WP-25
Zone Maps amended to indicate the 2, 5, 10, and 25 year Wellhead Protection Areas.

The base data on this map is provided for convenience only. The Town of Caledon is not responsible for any deficiency or inaccuracy in the base data, and will not accept any liability whatsoever therefor. The reproduction of the base data, in whole or in part, by any means is prohibited without the prior written permission of the Town of Caledon.

BY-LAW 2006-50
ZONE MAP 53
SCHEDULE "A"

Date: 3 April 2006 Revised: August 21, 2015

File: S:\POLICY SECTION\GIS\zoning_bylaw2015_mxd

53