

CON. 3 E.H.S. (CAL)

CON. 2 E.H.S. (CAL)

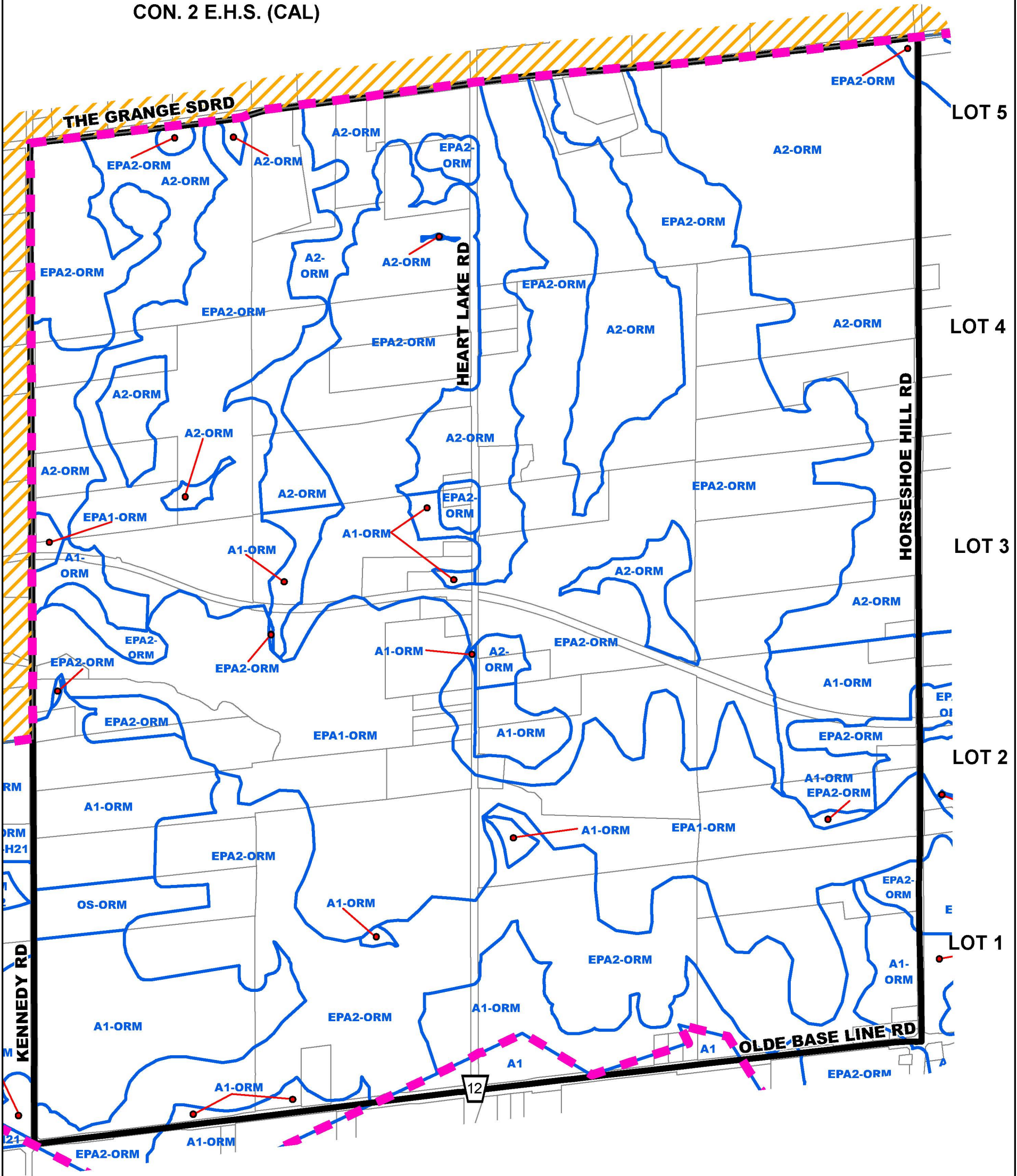

This copy is provided for convenience only. If necessary, the original may be referred to in the office of the Town Clerk.

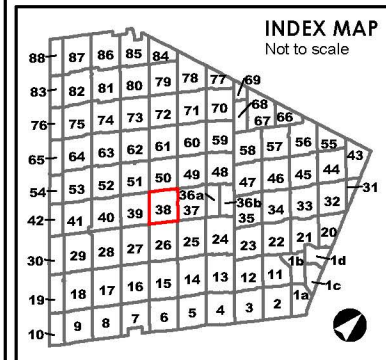

**A2 ZONE SYMBOL**

**A2-### ZONE SYMBOL**  
Note: Number of suffixes represent Exceptions which can be looked up in the Exceptions section of the By-law.

**ZONE BOUNDARY**

**STRUCTURAL ENVELOPE MAP**

**NIAGARA ESCARPMENT DEVELOPMENT CONTROL AREA**  
Lands lying within the Development Control area pursuant to the Niagara Planning and Development Act are subject to permit requirements under Ontario Regulations 685/50, as amended.

**OAK RIDGES MORAINÉ CONSERVATION PLAN AREA BOUNDARY**

**WELLHEAD PROTECTION AREA BOUNDARY**  
Zone Maps amended to indicate the 2, 5, 10, and 25 year Wellhead Protection Areas.

WP-2 WP-5 WP-10 WP-25

BY-LAW 2006-50

**ZONE MAP 38**

SCHEDULE "A"

0 135 270 540

TOWN OF CALEDON

Date: 3 April 2006 Revised: August 4, 2015

File: S:\POLICY SECTION\GIS\Zoning\_bylaw2015\_mxd

**38**