

CON. 6 E.H.S. (CHING)

CON. 1 (ALB)

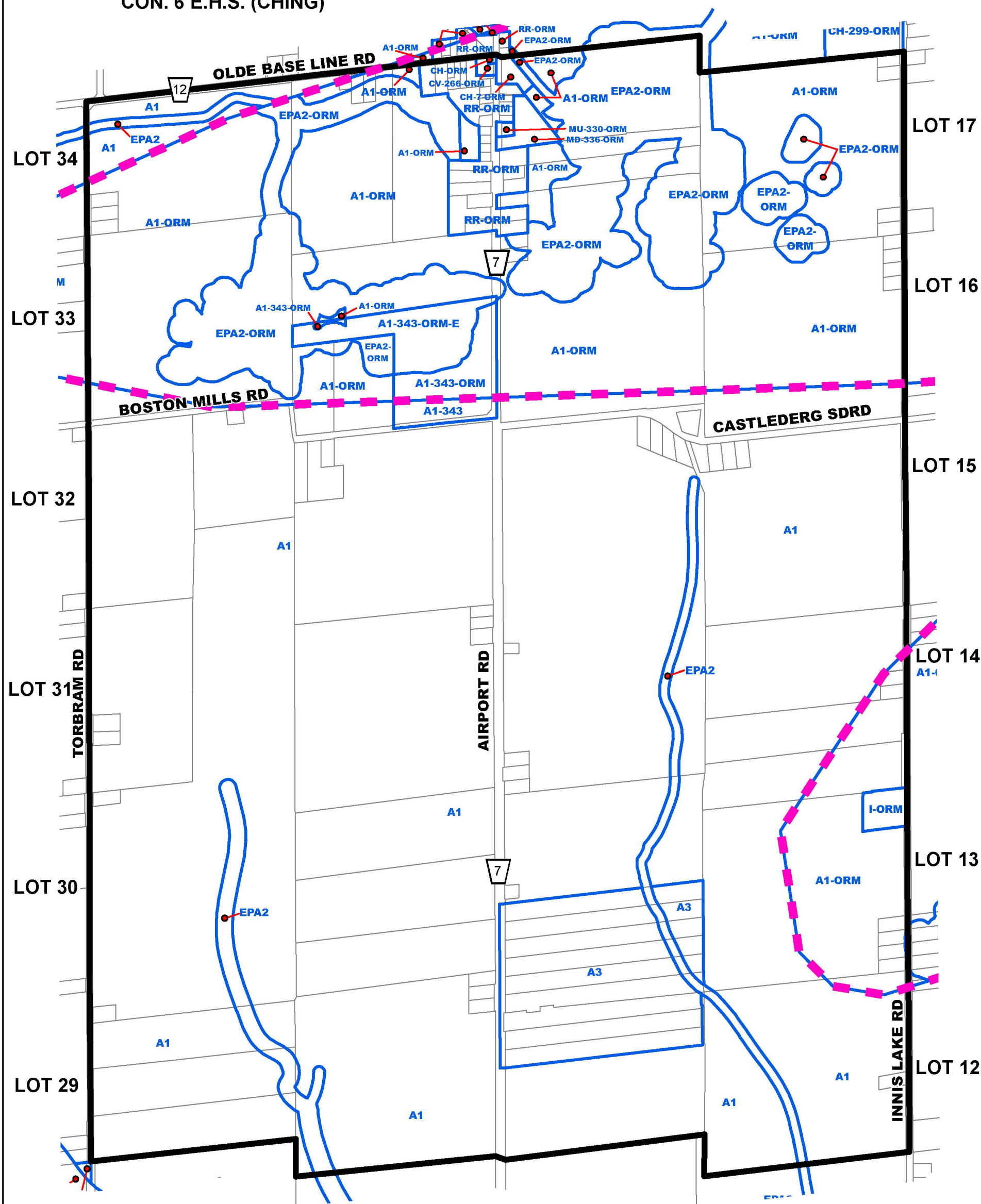

This copy is provided for convenience only. If necessary, the original may be referred to in the office of the Town Clerk.

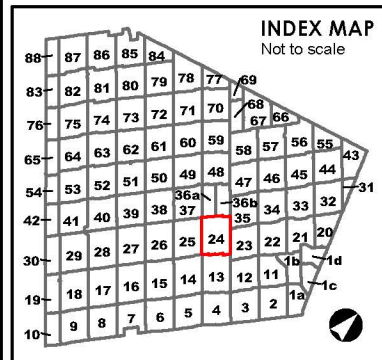

A2 ZONE SYMBOL

A2-### ZONE SYMBOL
Note: Number of suffixes represent Exceptions which can be looked up in the Exceptions section of the By-law.

ZONE BOUNDARY

STRUCTURAL ENVELOPE MAP

NIAGARA ESCARPMENT DEVELOPMENT CONTROL AREA
Lands lying within the Development Control area pursuant to the Niagara Planning and Development Act are subject to permit requirements under Ontario Regulations 685/50, as amended.

OAK RIDGES MORAINIC CONSERVATION PLAN AREA BOUNDARY

WELLHEAD PROTECTION AREA BOUNDARY
Zone Maps amended to indicate the 2, 5, 10, and 25 year Wellhead Protection Areas.

WP-2 WP-5 WP-10 WP-25

BY-LAW 2006-50

ZONE MAP 24

SCHEDULE "A"

0 140 280 560

TOWN OF CALEDON

Date: 3 April 2006 Revised: October 14, 2015

File: S:\POLICY SECTION\GIS\Zoning_bylaw2015_mxd

24

The base data on this map is provided for convenience only. The Town of Caledon is not responsible for any deficiency or inaccuracy in the base data, and will not accept any liability whatsoever therefor. The reproduction of the base data, in whole or in part, by any means is prohibited without the prior written permission of the Town of Caledon.