

This copy is provided for convenience only. If necessary, the original may be referred to in the office of the Town Clerk.

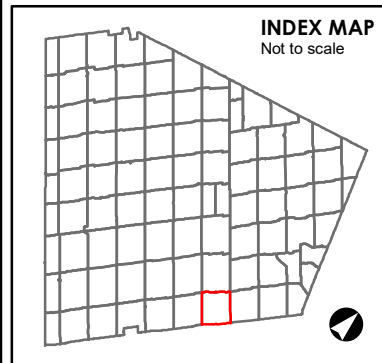

A2 ZONE SYMBOL

A2-### ZONE SYMBOL
Note: Number of suffixes represent Exceptions which can be looked up in the Exceptions section of the By-law.

ZONE BOUNDARY

STRUCTURAL ENVELOPE MAP

NIAGARA ESCARPMENT DEVELOPMENT CONTROL AREA
Lands lying within the Development Control area pursuant to the Niagara Planning and Development Act are subject to permit requirements under Ontario Regulations 685/50, as amended.

OAK RIDGES MORaine CONSERVATION PLAN AREA BOUNDARY

WELLHEAD PROTECTION AREA BOUNDARY
Zone Maps amended to indicate the 2, 5, 10, and 25 year Wellhead Protection Areas.

WP-2 **WP-5** **WP-10** **WP-25**

BY-LAW 2006-50

ZONE MAP 4

SCHEDULE "A"

0 137.5 275 550 m

TOWN OF CALEDON

Date: 3 April 2006 Revised: November 29, 2022

File: S:\POLICY SECTION\GIS\zoning_bylaw\2015_mxd

4