

BUILDING 1 LANDSCAPE PLAN
Scale: 1:400

PLANT LIST: BUILDING 1 (Repeated on L1.2)

Key	Qty	Botanical Name	Common Name	Cal.	Ht./Sp.	Cond.	Notes
DECIDUOUS TREES							
AS	23	Acer saccharum 'Green Mountain'	Green Mountain Sugar Maple	70mm		W.B.	
CO	9	Celtis occidentalis	Hickory	70mm		W.B.	
GTS	20	Geopelia imbricatus	Howey Locust	70mm		W.B.	
TA	23	Tilia americana 'Redmond'	Redmond Basswood	70mm		W.B.	
SRIS	4	Syringa reticulata 'Vivid Silk'	Ivory Silk Lilac	70mm		W.B.	
GB	7	Gragea bicolor 'Princeton Sentry'	Maidenhair Tree	70mm		W.B.	
OM	38	Quercus macrocarpa	Blunt Oak	70mm		W.B.	
DECIDUOUS TREES - LIVE STAKES & BRIS (BARE ROOT STAKI)							
PDL	20	Populus deltoides	Eastern Cottonwood		15 gal. CO		
PBL	30	Populus balsamifera	Baldwin Poplar		15 gal. CO		
SKL	40	Salix amygdaloides	Peachleaf willow		LIVE STAKE		
AM	13	Aster spicatum	Snow Maple	1250mm	BRIS		
CONIFEROUS TREES							
PG	30	Picea glauca	White Spruce	200cm		W.B.	
AB	29	Abies balsamea	Balsam Fir	200cm		W.B.	
PS	3	Pinus strobus	White Pine	200cm		W.B.	
DECIDUOUS SHRUBS							
SI	227	Spirea japonica 'Little Princess'	Japanese Spirea	80cm		3 gal pot	
WB	84	Weigela 'Bristol Ruby'	Bristol Ruby Weigela	80cm		3 gal pot	
RF	60	Ribes nigra	Speddered Ribwort	80cm		3 gal pot	
RF	60	Salix discolor	Pussy Willow	80cm		3 gal pot	
SC	60	Sambucus canadensis	American Elderberry	80cm		3 gal pot	
CS	60	Cornus sericea	Red Osier Dogwood	80cm		3 gal pot	
CONIFEROUS SHRUBS							
YC	1	Yucca canadensis	Canadian Yew	80cm		1-3 gal pot	
PERENNIALS & GRASSES							
CAK	262	Catanagrostis s. scurifera 'Karl Foerster'	Father Reed Grass	80cm dc		2 gal pot	
HAH	244	Hemerocallis 'Stella D'Orop'	Daylily	60cm/dc		1 gal pot	
PAH	60	Pennisetum alopecuroides 'Hameln'	Dwarf Fountain Grass	60cm/dc		1 gal pot	
IG	15	Fraxinus glauca 'Tilgh Blar'	Blunt Blue Fraxinus	60cm/dc		1 gal pot	
RL	34	Rudbeckia hirta	Black Gold Rudbeckia	60cm/dc		1 gal pot	
RCB	169	Rudbeckia hirta 'Cherry Brandy'	Gloriosa Daisy	60cm/dc		1 gal pot	

LEGEND

- PROPOSED DECIDUOUS TREE
- PROPOSED CONIFEROUS TREE
- PROPOSED CONTINUOUS SHRUB PERENNIAL BED
- ARMOUR STONE
REFER TO DETAIL 9 ON DWG L-3
- SOD
SODDED AREA
- CSW
CONCRETE PAVING
REFER TO DETAIL 6 ON DWG L-2
- STORMWATER POND MIXTURE OSC #8190
REFER TO DETAIL 10 ON DWG L-2
- LOW GROW NATIVE GRASS LAND MIX OSC #8125
REFER TO DETAIL 11 ON DWG L-2
- PLANT KEY
- DETAIL KEY
- PROPERTY LINE
- 2.4m BLACK VINYL SECURITY FENCE
SEE DETAIL 5 ON L-3
- EPA 2-1 ZONE BOUNDARY
- GEORGE BOLTON PARKWAY EXTENSION
SEE DETAIL 4 ON L-2

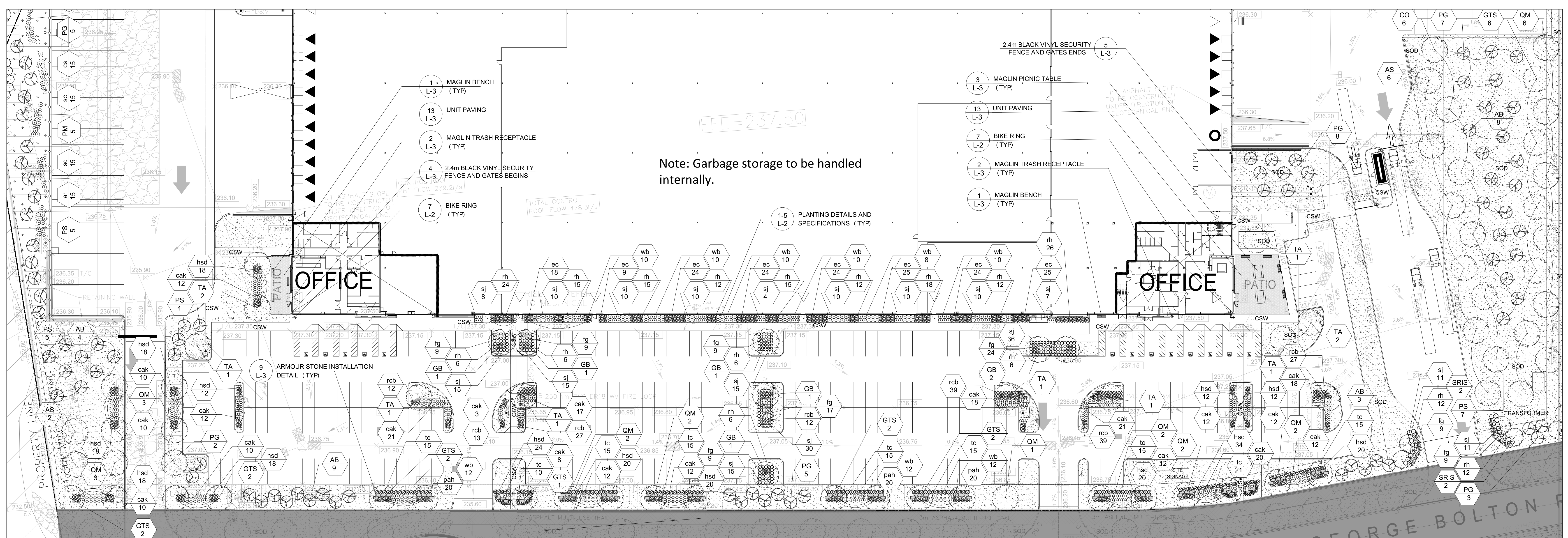

BUILDING 1 LANDSCAPE PLAN
Scale: 1:400

- GENERAL NOTES**
- Do not scale the drawings. All dimensions are in millimeters unless noted otherwise.
 - This drawing is to be read in conjunction with the architectural drawings prepared by project architect and project engineer.
 - The contractor shall check and verify all dimensions and conditions on the project and immediately report any discrepancies to the Landscape Architect before proceeding with the work.
 - The contractor is to be aware of all existing and proposed services and utilities. The contractor is responsible for having all underground services and utility lines located by each agency having jurisdiction prior to commencing work.
 - Do not leave any holes open overnight.
 - Keep area suitable for construction zone clean and workable by others at all times. Contractor shall thoroughly clean areas surrounding the construction zone at the end of each work day.
 - Contractor shall maintain a detailed record of all authorized changes in the form of a redline mark up drawing. These records shall be submitted to the Landscape Architect as a condition of obtaining substantial completion.
 - Contractor is to make good all damage resulting from the work at no additional cost.
 - Plant quantities indicated on the plan supersede the quantities from the plant list. Report any discrepancies to the Landscape Architect.
 - Contractor shall verify the Landscape Architect prior to installation of any site furniture. Final location of site furniture to be confirmed on site with Owner and Landscape Architect.
 - This drawing is Copyright MHC Planning, 2021.

Revision No.	Date	Issued / Revision	By
17	March 01, 2021	Issued for SPA	PD
16	August 19, 2020	Issued for Site Plan Updates	PD
15	June 08, 2020	Issued for Site Plan Updates	PD
14	May 13, 2020	Issued for Site Plan Updates	PD
13	August 14, 2019	Issued for SPA Variance	JD
12	July 25, 2019	Issued for SPA	PD
11	June 12, 2019	Issued for SPA	PD
10	June 11, 2019	Issued for ZBA	PD
9	April 02, 2019	Re-Issued for SPA	PD
8	March 27, 2019	Issued for Coordination	PD
7	October 02, 2018	Issued for SPA	PD
6	September 7, 2018	Issued for SPA	PD
5	August 15, 2018	Issued for SPA	PD
4	April 26, 2018	Issued for SPA	LK
3	March 22, 2018	Issued for Review	PD
2	March 19, 2018	Issued for Review	PD
1	February 27, 2018	Issued for Review	LK

MHC PLANNING
230-7000 WESTON ROAD WOODBRIDGE, ON L4L 8C7 | P: 905-741-5388 F: 905-741-5389 | WWW.MHCPLAN.COM

PLANNING URBAN DESIGN & LANDSCAPE ARCHITECTURE

Stamp:

Date: February, 2018

Drawn By: L.K.

Plan Scale: as noted

File No.: 13581

Checked By: N.M.

SPA No.: SPA 19-0044

Project: **Triovest and Boltco North Development**
Town of Caledon

File Name: **BUILDING 1 LANDSCAPE PLAN**

Dwg No.: **L-1.1**