

KEY PLAN

TOWN OF CALEDON

LEGEND

- 279.90 PROP. ELEVATION
- KEY NATURAL HERITAGE FEATURE
- KEY NATURAL HERITAGE FEATURE 30m MINIMUM VEGETATION PROTECTION ZONE (MVPZ)
- ENVIRONMENTAL ZONE 2
- PROP. GRASSED SWALE
- LIMIT OF STRUCTURE ENVELOPE
- MIN. 56 sq.m. BACKYARD AMENITY AREA (CONCEPT PLAN)

SCALE 1:500

GENERAL NOTES

- THE INFORMATION SHOWN HEREIN IS PRELIMINARY AND SUBJECT TO DETAIL DESIGN.
- CONTOURS GENERATED FROM ORTHOPHOGRAPHY DEVELOPED IN THE SPRING OF 2002, AND SURVEYED ELEVATIONS BY CALDER ENGINEERING LTD. (2017 & 2019) AND EPLETT WOROBEC RAKES SURVEYING LTD. (2015). ACTUAL ELEVATIONS MAY VARY FROM THOSE SHOWN.
- EZZ ZONE LIMITS INFERRED FROM INFORMATION PROVIDED BY AZIMUTH ENVIRONMENTAL CONSULTANTS INC. DATED NOVEMBER 2016.

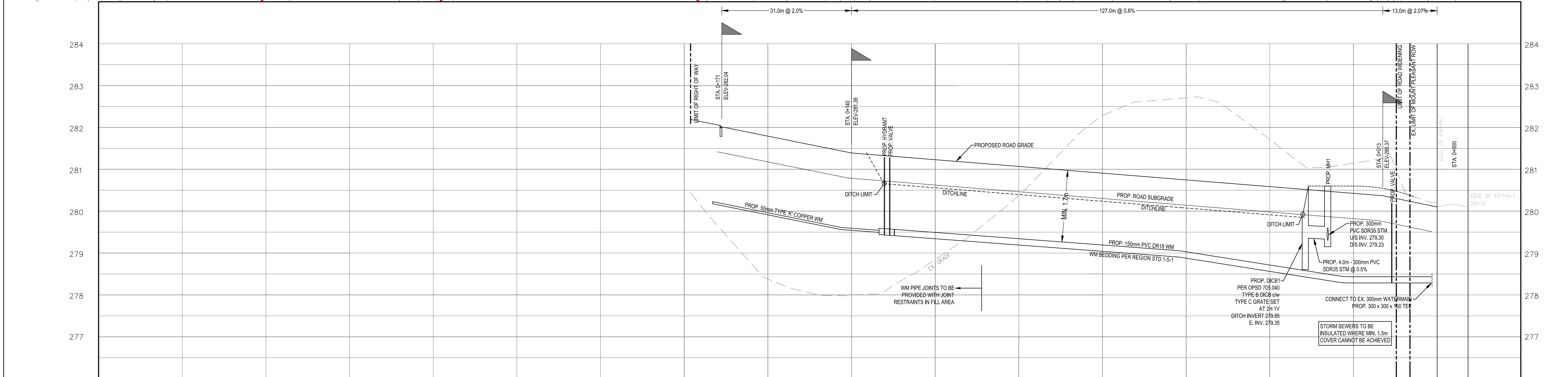

STORM SEWER INVERT														STORM SEWER INVERT
PROPOSED ROAD GRADE														PROPOSED ROAD GRADE
CHAINAGE														CHAINAGE

Calder Engineering Ltd.
T 905-857-7600 E calder@caldereng.com W www.caldereng.com

DESIGNED BY	APPROVED BY

N°	Date	Revisions	Dwn.	Dsg'd.	Ch'kd.
14	DEC 2020	FOURTH SUBMISSION	KNC	KNC	RJW
28	FEB 2020	THIRD SUBMISSION	KNC	KNC	RJW
03	MAY 2019	SECOND SUBMISSION	KNC	KNC	RJW
15	MAR 2017	FIRST SUBMISSION	KNC	DH	RJW

Client: **LAURELPARK INC.**

Project Name: **LAURELPARK SUBDIVISION
PART OF LOT 19, CONCESSION 8 (ALBION)
TOWN OF CALEDON, REGIONAL MUNICIPALITY OF PEEL**

Title Name: **PLAN AND PROFILE
DOHERTY LANE**

Drawing N°: **16-168-02** Sheet N°: **2 OF 10** Rev. N°: **(D)**
Scale: **H 1:500 V 1:50**