

NOTE(S):  
 1) GATE AND END POSTS SHALL BE LENGTHENED WHEN BARBED WIRE IS SPECIFIED, EXCEPT WHEN BARBED WIRE ARMS ARE USED.  
 2) ALL DIMENSIONS ARE IN MILLIMETRES UNLESS OTHERWISE SHOWN.

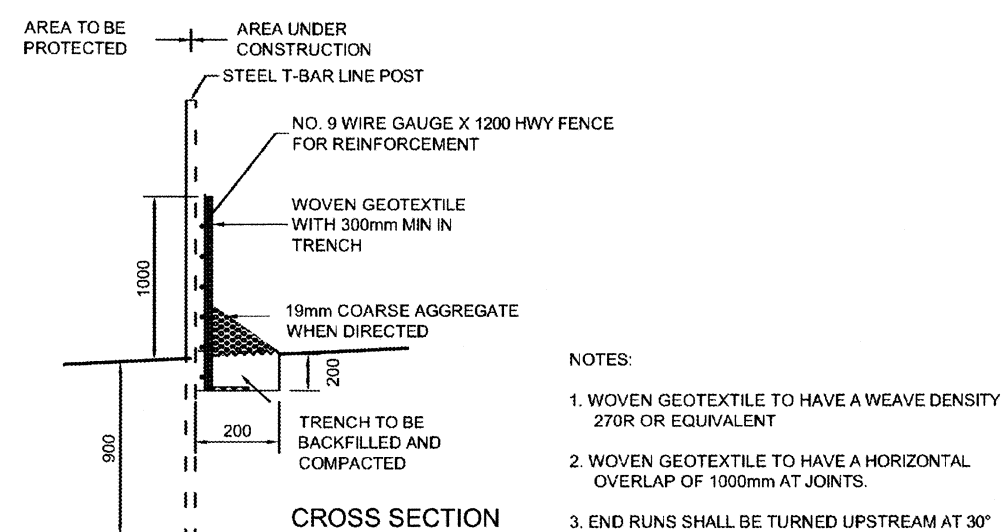
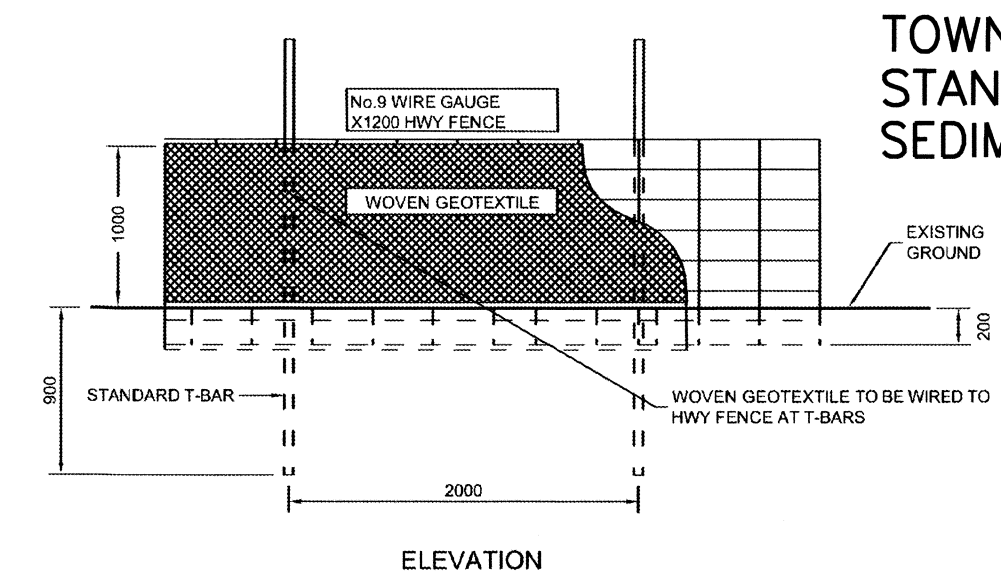

NOTES:  
 1. WOVEN GEOTEXTILE TO HAVE A WEAVE DENSITY OF 270R OR EQUIVALENT  
 2. WOVEN GEOTEXTILE TO HAVE A HORIZONTAL OVERLAP OF 1000mm AT JOINTS.  
 3. END RUNS SHALL BE TURNED UPSTREAM AT 30°

### TOWN OF CALEDON STANDARD No.304 TREE PROTECTION

SPECIFICATIONS FOR THE PROTECTION AND PRESERVATION OF EXISTING VEGETATION:

- PRIOR TO ISSUANCE OF THE BUILDING PERMIT, ALL EXISTING TREES THAT ARE TO BE PRESERVED SHALL BE FULLY PROTECTED WITH HOARDINGS (IE SNOW FENCING) OUTSIDE THEIR 'DRIPLINES' TO THE SATISFACTION OF THE TOWN.
- GROUPS OF TREES AND OTHER EXISTING PLANTINGS TO BE PROTECTED SHALL BE TREATED IN A LIKE MANNER WITH HOARDING AROUND THE ENTIRE CLUMP(S).
- AREAS WITHIN THE PROTECTIVE FENCING SHALL REMAIN UNDISTURBED AND SHALL NOT BE USED FOR THE STORAGE OF BUILDING MATERIALS OR EQUIPMENT NO CONTAMINANTS SHALL BE DUMPED OR FLUSHED WHERE FEEDER ROOTS OF TREES EXIST.
- PRUNE BRANCHES TO REMOVE DAMAGED LIMBS ONLY. DO NOT DAMAGE LEADERS. ALL CUTS OVER 25mm SHALL BE TREATED IN ACCORDANCE WITH APPROPRIATE HORTICULTURAL PRACTICES AS APPROVED BY THE TOWN.
- CUTTING OF ROOTS OR CHANGING OF GRADES AROUND EXISTING TREES TO BE PRESERVED WILL NOT BE PERMITTED WITHOUT THE APPROVAL OF THE PUBLIC WORKS AND ENGINEERING DEPARTMENT.
- TREES THAT HAVE DIED, OR HAVE BEEN DAMAGED BEYOND REPAIR SHALL BE REPLACED AT THE DEVELOPER'S EXPENSE WITH TREES OF A SIZE AND SPECIES APPROVED BY THE TOWN.
- IF TREES ARE BEING ADVERSELY AFFECTED BY CONSTRUCTION, A WATERING AND FERTILIZING PROGRAM IS TO BE SET UP TO THE SATISFACTION OF THE TOWN.
- TREE PRESERVATION FENCE TO BE INSPECTED BY THE CONSULTING LANDSCAPE ARCHITECT AND APPROVED PRIOR TO CONSTRUCTION COMMENCING.

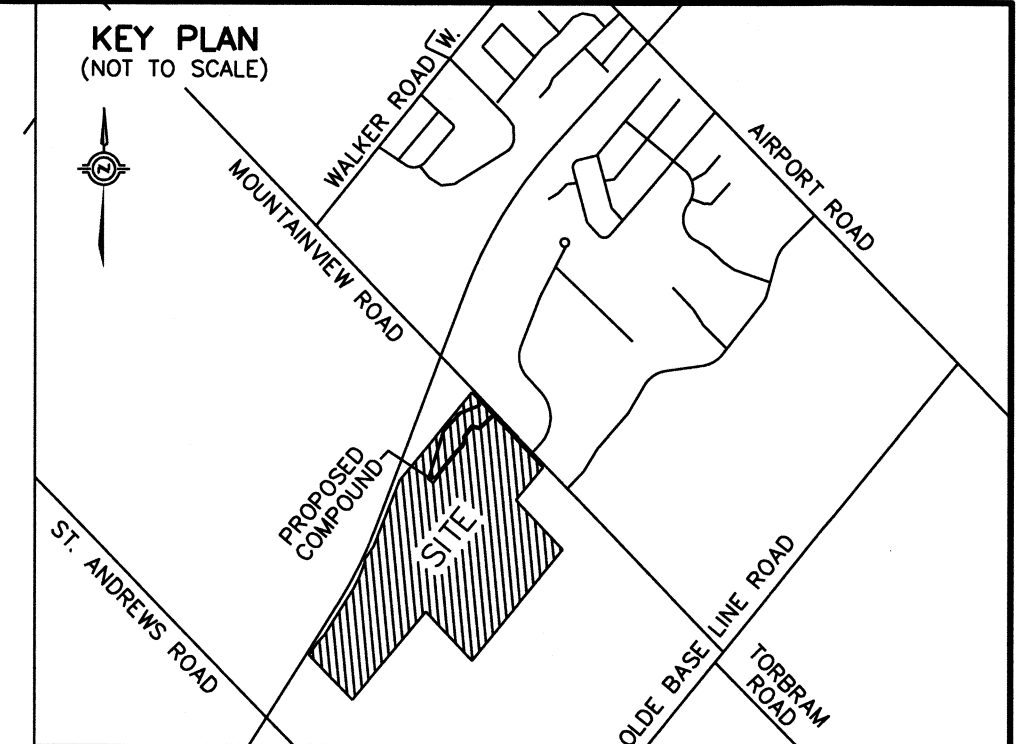
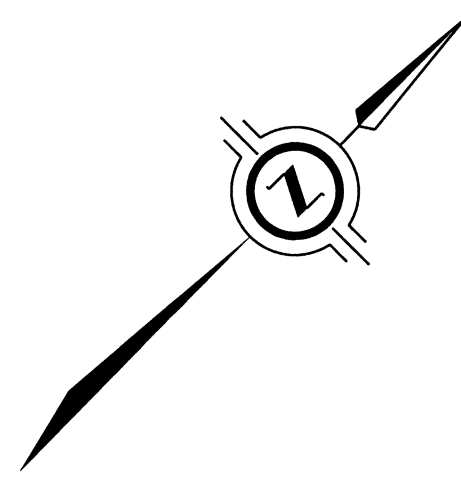
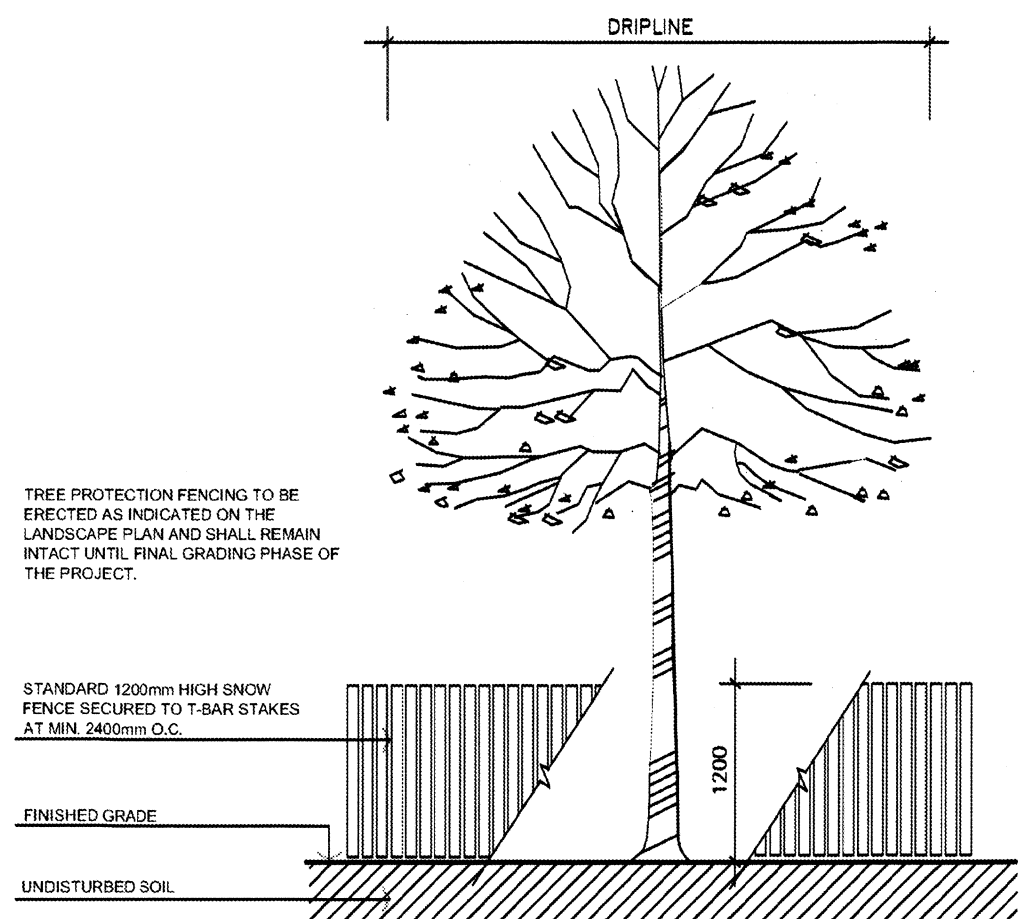

PLAN SHOWING TOPOGRAPHY AND SITE LAYOUT DESIGN OF PROPOSED TELECOM TOWER INSTALLATION  
**PART OF LOT 2 CONCESSION 5, EAST OF HURONTARIO STREET**  
 (GEOGRAPHIC TOWNSHIP OF CALEDON)  
**TOWN OF CALEDON**  
 REGIONAL MUNICIPALITY OF PEEL  
 SCALE 1 : 200

J.D. BARNES LIMITED  
 ONTARIO LAND SURVEYORS  
 © COPYRIGHT  
**METRIC** DISTANCES AND/OR COORDINATES SHOWN ON THIS PLAN ARE IN METRES AND CAN BE CONVERTED TO FEET BY DIVIDING BY 0.3048.

**NOTES**  
 BEARINGS ARE UTM GRID, DERIVED FROM REAL TIME NETWORK (SMARTNET) OBSERVATIONS, UTM ZONE 17, NAD 83 (CSRS) (2010)  
 DISTANCES ARE GROUND AND CAN BE CONVERTED TO GRID BY MULTIPLYING BY THE COMBINED SCALE FACTOR OF 0.999701.

**BENCHMARK**  
 ELEVATIONS SHOWN HEREON ARE RELATED TO GEODETIC DATUM AND ARE DERIVED FROM GPS OBSERVATION USING THE POWERNET NETWORK SERVICE AND REFER TO THE HT2\_OA VERTICAL SYSTEM.

**CERTIFICATE OF COMPLETION**  
 I CERTIFY THAT:  
 1. THE FIELD WORK WAS COMPLETED ON THE 21st DAY OF OCTOBER, 2018.

DATE May 17, 2019  
*Grant T. Stidwill*  
 GRANT T. STIDWILL  
 ONTARIO LAND SURVEYOR

**CAUTION**  
 LOCATIONS OF ANY UNDERGROUND SERVICES ARE APPROXIMATE. OTHER BURIED UTILITIES MAY EXIST WHICH ARE NOT SHOWN BECAUSE OF INSUFFICIENT INFORMATION. CONTACT ALL POTENTIAL OWNERS OF UNDERGROUND UTILITIES PRIOR TO COMMENCEMENT OF CONSTRUCTION

### PROPOSED COMPOUND LAYOUT PLAN & GRADING PLAN

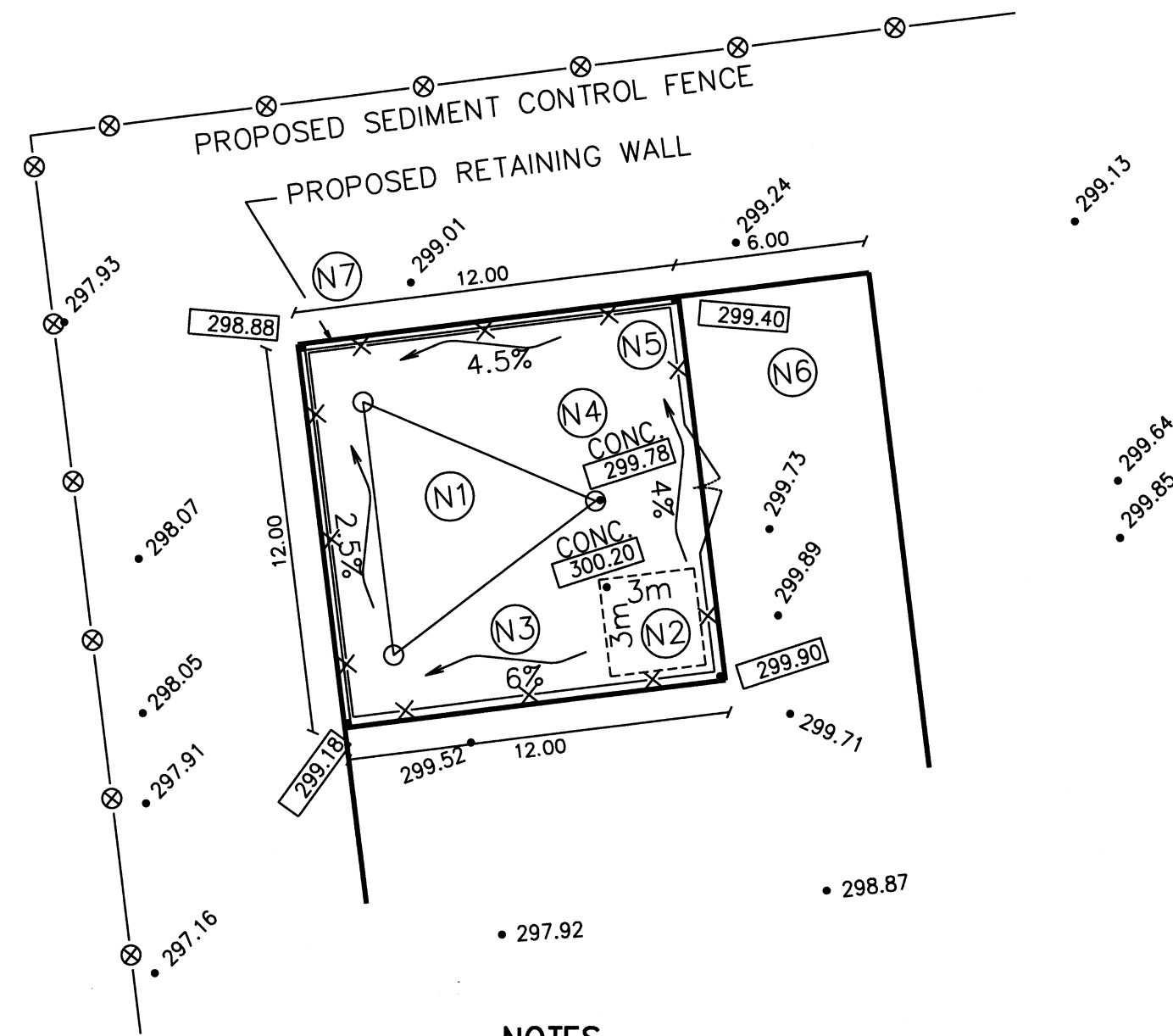

- NOTES**
- (N1) PROPOSED STEEL LATTICE TRIPOLE TOWER WITH LIGHTNING PROTECTION SYSTEM. PAINT COLOUR SUBJECT TO NAV CANADA REQUIREMENTS. ANTENNA NUMBER AND LOCATIONS TO BE DETERMINED. FOUNDATION DESIGN PENDING SOIL REPORT.
  - (N2) PROPOSED PREFABRICATED GALVANIZED STEEL RADIO EQUIPMENT CABINET ON CAST IN PLACE REINFORCED CONCRETE SLAB (3.0m x 3.0m).
  - (N3) HYDRO CONNECTION AND ROUTING TO BE DETERMINED BY QUALIFIED PERSONNEL IN CONSULTATION WITH LOCAL AUTHORITY.
  - (N4) REMOVE EXISTING TOPSOIL. PROOF ROLL SUBGRADE AND PLACE 300 mm GRANULAR A ACROSS COMPOUND AREA. FINISHED GRAVEL SURFACE TO BE MIN. 150 mm ABOVE EXISTING GRADE AND SLOPED AWAY FROM PROPOSED STRUCTURES AT MIN. 2% ON ALL SIDES TO PROVIDE ADEQUATE DRAINAGE.
  - (N5) PROPOSED 1.8 m HIGH CHAIN LINK FENCE TOPPED WITH BARBED WIRE SURROUNDED COMPOUND.
  - (N6) PARKING AREA FOR MAINTENANCE VEHICLE.
  - (N7) PROPOSED RETAINING WALL TO BE DESIGNED BY OTHERS BASED ON SITE CONDITIONS

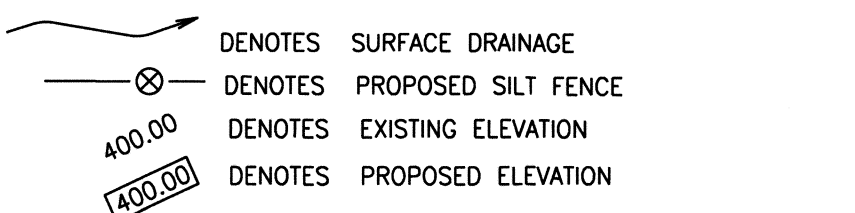

<b>ROGERS</b>		LATITUDE N 43°51'16.4"
SITE: C6540		LONGITUDE W 79°52'29.2"
MOUNTAINVIEW RD. & CALEDON TRAILWAY		ELEVATION 299.3m
<b>J.D. BARNES LIMITED</b>		
LAND INFORMATION SPECIALISTS		
401 WHEELABRATOR WAY, SUITE A, MILTON, ON L9T 3C1		
T: (905) 875-9955 F: (905) 875-9956 www.jdbarnes.com		
DRAWN BY: TAB	CHECKED BY: GS	REFERENCE NO.: 18-30-298-00-B
FILE: G:\18-30-298\00\Drawing\18-30-298-B.dgn		DATED: MAY 15th, 2019