

- KEY PLAN N.T.S.
- LEGEND
- SITE LIGHTING POLE: 12.2m (40') ROUND CONCRETE PRESTRESSED AND REINFORCED, BY STRESS-CRETE CAT.# E400-BPO-G-CSA C/W TWIN BULLHORN FOR MOUNTING TWO (2) 150W EFH LUMINAIRES, 90° APART. EFH LUMINAIRES ARE TO BE AIMED 45° DOWNWARD, AND ARE TO INCLUDE TOP AND SIDE VISORS PER THE MANUFACTURER. LUMINAIRE: GE EFH LED AREA LIGHT TYPE III 3000K C/W 7-PIN PHOTO CONTROL TO MATCH EFH101_AA66730...-TSVBLC
 - PROPOSED GROUND ROD.
 - HYDRO ONE TRANSFORMER.
 - SITELIGHT CABLE: 2-#6RWU (RED AND BLACK FOR 240V) C/W 1-#6 RWU GND. CABLE INSTALLED IN 50mm PVC TYPE 2 DIRECT BURIED DUCT IN COMPLETE ACCORDANCE WITH E.S.A. STANDARDS & SPECIFICATIONS
 - METERED PEDESTAL SUPPLY BY HYDRO ONE, SUBJECT TO SERVICE APPLICATION.
 - METERED STREETLIGHT POWER SUPPLY PEDESTAL TO BE MANUFACTURED BY PEDESTAL SOLUTIONS INC. (PSI), YORK, ONTARIO, CAT.#SLM4226-40, 100A 2 POLE MAIN BREAKER, 6-40 240V BRANCH BREAKERS, WEATHER PROOF, TAMPER PROOF CABINET, DARK GREEN, PROVISIONS FOR PADLOCKING, MOUNT ON PRE-CAST CONCRETE FOUNDATION (USI UP2022 BASE)

TOWN OF CALEDON
PLANNING
RECEIVED
Feb.24, 2021

APPROVED FOR CONSTRUCTION
THIS APPROVAL CONSTITUTES A GENERAL REVIEW AND DOES NOT CERTIFY DIMENSIONAL ACCURACY.

THIS APPROVAL IS SUBJECT TO THE FURTHER CERTIFICATION OF THE "AS CONSTRUCTED" WORKS BY A REGISTERED PROFESSIONAL ENGINEER OF THE PROVINCE OF ONTARIO.

DATE: _____ APPROVED BY: _____

Ordering Number Logic
Evolve™ LED High Output Flood Light (EFH)

EFH1	01	7
1	1	1
2	2	2
3	3	3
4	4	4
5	5	5
6	6	6
7	7	7
8	8	8
9	9	9
10	10	10
11	11	11
12	12	12
13	13	13
14	14	14
15	15	15
16	16	16
17	17	17
18	18	18
19	19	19
20	20	20
21	21	21
22	22	22
23	23	23
24	24	24
25	25	25
26	26	26
27	27	27
28	28	28
29	29	29
30	30	30
31	31	31
32	32	32
33	33	33
34	34	34
35	35	35
36	36	36
37	37	37
38	38	38
39	39	39
40	40	40
41	41	41
42	42	42
43	43	43
44	44	44
45	45	45
46	46	46
47	47	47
48	48	48
49	49	49
50	50	50
51	51	51
52	52	52
53	53	53
54	54	54
55	55	55
56	56	56
57	57	57
58	58	58
59	59	59
60	60	60
61	61	61
62	62	62
63	63	63
64	64	64
65	65	65
66	66	66
67	67	67
68	68	68
69	69	69
70	70	70
71	71	71
72	72	72
73	73	73
74	74	74
75	75	75
76	76	76
77	77	77
78	78	78
79	79	79
80	80	80
81	81	81
82	82	82
83	83	83
84	84	84
85	85	85
86	86	86
87	87	87
88	88	88
89	89	89
90	90	90
91	91	91
92	92	92
93	93	93
94	94	94
95	95	95
96	96	96
97	97	97
98	98	98
99	99	99
100	100	100

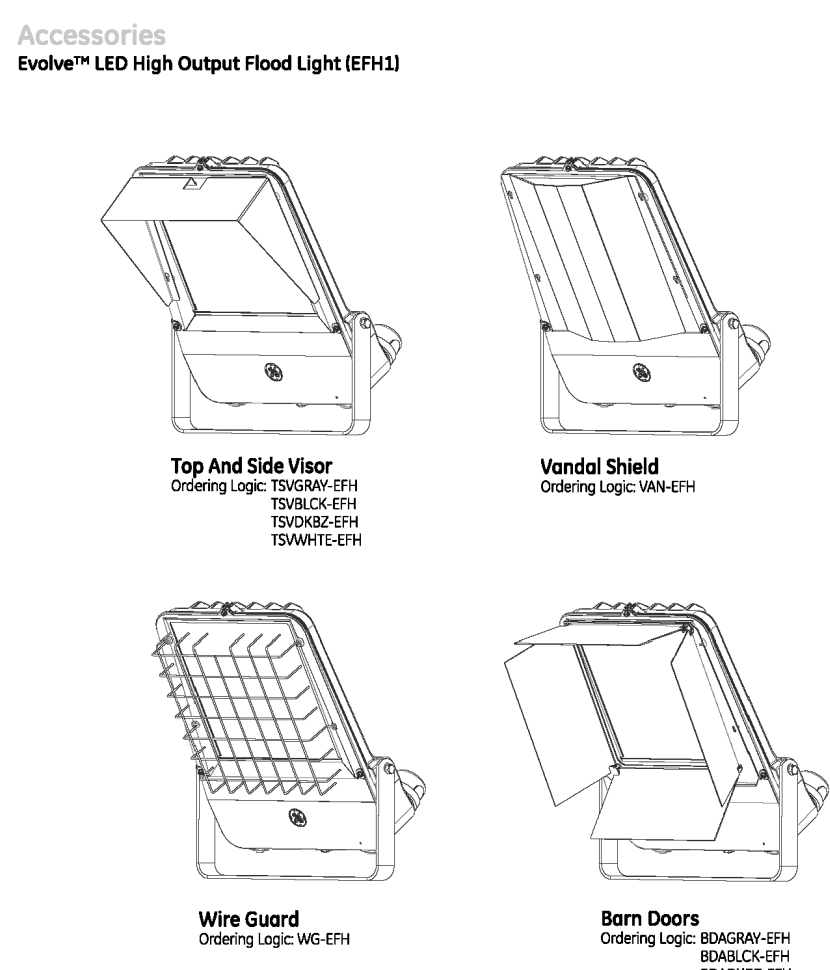

Octagonal Class B - Medium Duty Pole

Octagonal Class B - Medium Duty Pole

Physical Details:

- Octagonal symmetrical tapered shaft
- 5.075" flat to flat pole top
- 6.125" per linear ft. taper increase
- 300 lb. transverse bending strength @ 6 ft. from top
- Model finish is standard but optional painted or powder finish and Decor colors are available
- For various mounting details, please reference arms and accessories.

Direct Embedment

Pole Catalog Number	Pole Height Above Grade	Assured Embedment Depth*	Overall Pole Height	Pole Butt Flare to Butt (Inches)	Ultimate Ground Line Moment (K-fts.)	Maximal Weight (lbs.)
E-250-SPB-G	25' 0"	5' 0"	30' 0"	4.84	16,000	1715
E-275-SPB-G	27' 0"	5' 0"	32' 0"	4.81	16,400	1957
E-300-SPB-G	30' 0"	5' 0"	35' 0"	4.81	16,400	1957
E-325-SPB-G	32' 0"	5' 0"	37' 0"	4.81	16,400	1957
E-350-SPB-G	35' 0"	5' 0"	40' 0"	4.81	16,400	1957
E-375-SPB-G	37' 0"	5' 0"	42' 0"	4.81	16,400	1957
E-400-SPB-G	40' 0"	5' 0"	45' 0"	4.81	16,400	1957
E-425-SPB-G	42' 0"	5' 0"	47' 0"	4.81	16,400	1957
E-450-SPB-G	45' 0"	5' 0"	50' 0"	4.81	16,400	1957

Base Plate

Pole Catalog Number	Pole Height Above Grade	Pole Butt Flare to Butt (Inches)	Base Plate Size (Inches)	Base Plate Weight (lbs.)	Ultimate Ground Line Moment (K-fts.)	Maximal Weight (lbs.)
P-250-SPB-G	25' 0"	4.84	11.5 x 11.5	11.5	25,000	1000
P-275-SPB-G	27' 0"	4.81	11.5 x 11.5	11.5	25,000	1220
P-300-SPB-G	30' 0"	4.81	11.5 x 11.5	11.5	25,000	1375
P-325-SPB-G	32' 0"	4.81	11.5 x 11.5	11.5	25,000	1500
P-350-SPB-G	35' 0"	4.81	11.5 x 11.5	11.5	25,000	1600
P-375-SPB-G	37' 0"	4.81	11.5 x 11.5	11.5	25,000	1650
P-400-SPB-G	40' 0"	4.81	11.5 x 11.5	11.5	25,000	1715

Class - EPA Loading

Pole Height Above Grade	Pole Butt Flare to Butt (Inches)	Class - EPA Loading
25' 0"	4.84	Class - EPA Loading
27' 0"	4.81	Class - EPA Loading
30' 0"	4.81	Class - EPA Loading
32' 0"	4.81	Class - EPA Loading
35' 0"	4.81	Class - EPA Loading
37' 0"	4.81	Class - EPA Loading
40' 0"	4.81	Class - EPA Loading
42' 0"	4.81	Class - EPA Loading
45' 0"	4.81	Class - EPA Loading
47' 0"	4.81	Class - EPA Loading
50' 0"	4.81	Class - EPA Loading

Decor Colors & Finishes

Color	Finish	Color	Finish	Color	Finish	Color	Finish
Black	Black	White	White	Gray	Gray	Green	Green
Blue	Blue	Yellow	Yellow	Orange	Orange	Red	Red
Pink	Pink	Brown	Brown	Gold	Gold	Silver	Silver

- NOTES:
- INSTALL LIGHTS AT 1.0m FROM BACK EDGE OF PARKING AREA AS SHOWN.
 - TRENCH AT 0.5m FROM BACK EDGE OF PARKING AREA AS SHOWN.
 - ENTIRE INSTALLATION TO BE IN FULL ACCORDANCE WITH THE E.S.A.

RTG SYSTEMS INC.
ELECTRICAL CONSULTING ENGINEERS
3518 Mainway Dr., Suite 201
Burlington ON L7M 1A8
Office: (905) 339-4470
Toronto: (905) 827-7887
E-MAIL: general@rtgsystems.com

TOWN OF CALEDON

RAFAT STORAGE YARD
0 SIMPSON ROAD
SITE LIGHTING

DWG BY: S.C.G. DATE: 2021.02.01 CK'D BY: DATE: DATE: DATE: SCALE: 1:500 EXCEPT SYMBOLS DRAWING NO. SL-2 SHEET 2 OF 2