

PLANT LIST

KEY	QUANTITY	BOTANICAL NAME	COMMON NAME	GALIPER	HEIGHT	SPREAD	ROOT	REMARKS	SPACING
DECIDUOUS TREES									
A	2	BETULA Papyrifera (GLUMP)	GLUMP PAPER BIRCH	3x10mm	4000mm	2000mm	S.B.	MULTI-STEM	----
D	4	ULMUS X 'HOMESTEAD'	HOMESTEAD ELM	10mm	3500mm	1500mm	S.B.	EQUAL FORM	----
F	2	ACER SAGCHARUM	SUGAR MAPLE	10mm	3500mm	1500mm	S.B.	EQUAL FORM	----
G	6	QUERCUS RUBRA	RED OAK	10mm	3500mm	1500mm	S.B.	EQUAL FORM	----
J	4	QUERCUS ALBA	WHITE OAK	10mm	3500mm	1500mm	S.B.	EQUAL FORM	----
CONIFEROUS TREES									
E	4	PICEA FENS	COLORADO SPRUCE	----	2000mm	1000mm	S.B.	SPECIMEN	----
H	12	PINUS STROBUS	EASTERN WHITE PINE	----	2000mm	1000mm	S.B.	SPECIMEN	----
CONIFEROUS SHRUBS									
aa	40	JUNIPERUS HORIZONTALIS 'ICEE BLUE'	ICEE BLUE JUNIPER	----	----	500mm	POTTED	MIN. 15 CANDLES	600mm
bb	3	JUNIPERUS SCOPULORUM 'WICHITA BLUE'	WICHITA BLUE JUNIPER	----	----	1500mm	POTTED	SPECIMEN	----
cc	21	TAXUS MEDIA 'DENSIFORMIS'	DENSE YEW	----	----	600mm	POTTED	MIN. 15 CANDLES	800mm
dd	3	TAXUS MEDIA 'HILLI'	HILL'S YEW	----	----	1000mm	POTTED	SPECIMEN	----
DECIDUOUS SHRUBS									
ee	17	HYDRANGEA PANICULATA 'LITTLE QUICK FIRE'	LITTLE QUICK FIRE HYDRANGEA	----	500mm	----	POTTED	MIN. 10 STEMS	800mm
ff	53	RIBES ALPINUM	ALPINE CURRANT	----	500mm	----	POTTED	MIN. 10 STEMS	100mm
gg	63	SPIRAEA JAPONICA 'GOLDFLAME'	GOLDFLAME SPIREA	----	500mm	----	POTTED	MIN. 10 STEMS	650mm
hh	70	CORNUS RACEMOSA	GRAY DOGWOOD	----	800mm	----	POTTED	MIN. 10 STEMS	1000mm
kk	10	RUBUS ODORATUS	FLOWERING RASPBERRY	----	500mm	----	POTTED	MIN. 10 STEMS	1000mm
mm	70	DIERVILLA LONICERA	BUSH HONEYSUCKLE	----	800mm	----	POTTED	MIN. 10 STEMS	1000mm
nn	70	CORNUS SERICEA	RED OSIER DOGWOOD	----	800mm	----	POTTED	MIN. 10 STEMS	1000mm
PERENNIALS AND GRASSES									
aaa	18	CALAMAGROSTIS X ACUTIFLORA 'KARL FOERSTER'	KARL FOERSTER FEATHER REED GRASS	----	----	1 gal. POT	----	----	800mm
bbb	57	HOSTA FORTUNEI 'ALBOMARGINATA'	VARIEGATED PLANTAIN LILY	----	----	1 gal. POT	MIN. 2 YRS. GTH.	----	500mm

HYDROSEEDING SEED MIXTURE

HYDROSEED WITH THE FOLLOWING SEED MIXTURE
AS SUPPLIED BY ONTARIO SEED COMPANY (1-800-465-5849)
OR APPROVED EQUAL

TYPE 1:

OSC # 8140 - NATIVE UPLAND FORAGE & MEADOW MIXTURE

CANADIAN WILD RYE (<i>Elymus canadensis</i>)	35%
FOWL BLUEGRASS/FOWL MEADOWGRASS (<i>Poa palustris</i>)	10%
FOX SEDGE (<i>Carex vulpinoidea</i>)	5%
LITTLE BLUE STEM (<i>Schizachyrium scoparium</i>)	5%
SAND DROPSEED (<i>Sporobolus cryptandrus</i>)	10%
VIRGINIA WILD RYE (<i>Elymus virginicus</i>)	35%

SEED RATE: 22-25 kg/ha

NURSE CROP

ANNUAL RYE GRASS (*Lolium multiflorum*)
SEED RATE: 28kg/ha

TYPE 2:

OSC # 8240 - SEASONALLY FLOODED MIX

DEER TONGUE (<i>Panicum clandestinum</i>)	4%
FOWL BLUEGRASS/FOWL MEADOWGRASS (<i>Poa palustris</i>)	23%
FOX SEDGE (<i>Carex vulpinoidea</i>)	20%
NODDING BUR MARIGOLD (<i>Bidens ceruina</i>)	1%
SMOOTH OX EYE/FALSE SUNFLOWER (<i>Helioopsis helianthoides</i>)*	2%
SWITCHGRASS (<i>Panicum virgatum</i>)*	25%
VIRGINIA WILD RYE (<i>Elymus virginicus</i>)*	25%

SEED RATE: 22-25 kg/ha

NURSE CROP

ANNUAL RYE GRASS (*Lolium multiflorum*)
SEED RATE: 28kg/ha

TREE PRESERVATION NOTE

REFER TO REVISED ARBORIST REPORT
PREPARED BY THE TREE SPECIALIST,
REVISED JUNE 1, 2020 FOR MORE
INFORMATION AND DETAILS ON TREE
PRESERVATION AND REMOVALS ON SITE.

MULCH NOTE:

ALL MULCH TO BE BLACK IN COLOUR

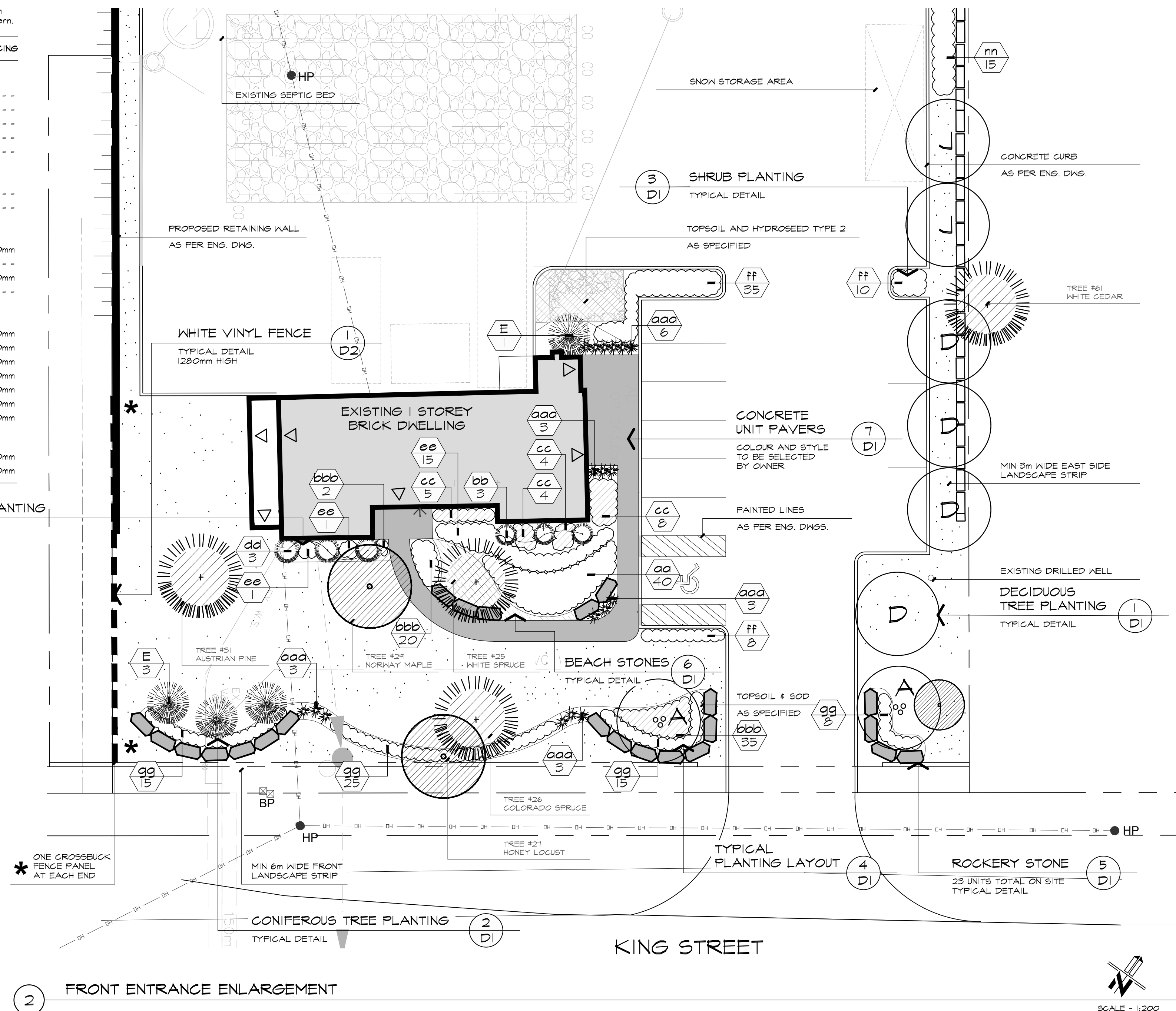

KEY MAP

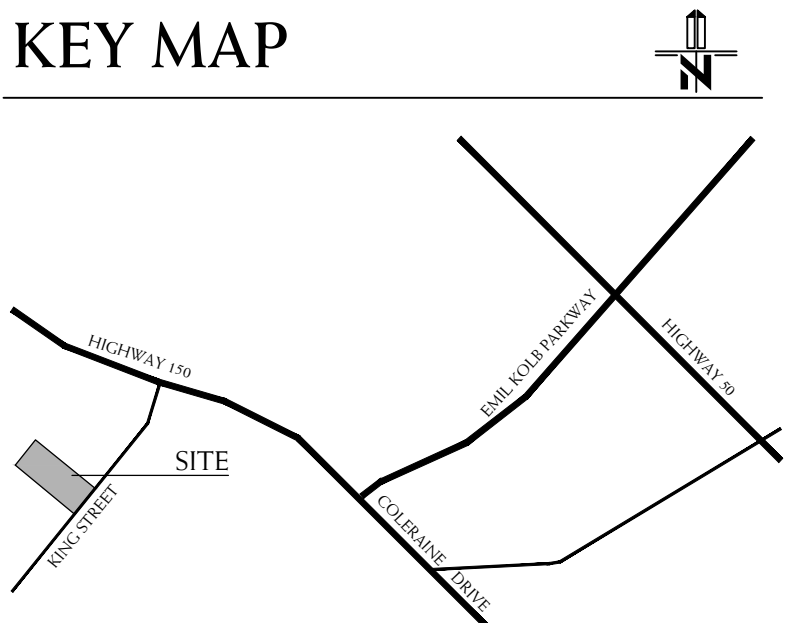

LEGEND

- EXISTING TREES TO REMAIN
- DECIDUOUS TREE
- CONIFEROUS TREES
- SHRUB PLANTING
- SEEDING
- BEACH STONES
- CONCRETE UNIT PAVERS
- SODDED AREA
- ROCKERY STONE
- WHITE VINYL FENCE
- EXISTING OVERHEAD WIRES
- EXISTING BELL PEDESTAL
- CHAIN LINK FENCE

BASE INFORMATION OBTAINED ELECTRONICALLY FROM
CALDER ENGINEERING INC. (TEL. 905-857-7600)

3.	JUN 1 2020	ISSUED FOR SECOND SUBMISSION	LK/RS
2.	JUNE 1 2017	REISSUED FOR SPA SUBMISSION	DN
1.	NOV. 3 2016	REISSUED FOR SPA SUBMISSION	BF
0.	OCT. 3 2016	ISSUED FOR FIRST SUBMISSION	LH/BF
no.	date	version	by

All information hereon to be checked and verified at the site and any discrepancies must be reported to and clarified by the landscape architect before commencing work. All drawings, specifications, details, digital information, etc., prepared by the landscape architect are instruments of service and as such are his property and must be returned at his request.

ALEXANDER BUDREVICS
LANDSCAPE ARCHITECTS

895 Don Mills Road, Second Tower, Suite 212
Toronto, Ontario, Canada, M3C 1W3

416.444.5201
416.444.5208

www.budrevics.com

ONTARIO ASSOCIATION OF LANDSCAPE ARCHITECTS
LESLIE KIELA
MEMBER

project SPA #: 16-063

KING STREET INDUSTRIAL

8186 KING STREET
BOLTON, ONTARIO

2473903 ONTARIO INC.

drawing

LANDSCAPE PLAN

date	APRIL 20, 2016	drawn	LH
scale*	AS SHOWN	file	3032 L1 R3-200601
direction		project no.	3032
		sheet no.	L-1

*NOTED SCALE IS APPLICABLE ONLY WHEN PRINTED ON ARCH D (34"x36") SIZE SHEET