

TOWN OF CALEDON  
PLANNING  
RECEIVED  
Aug 22, 2022

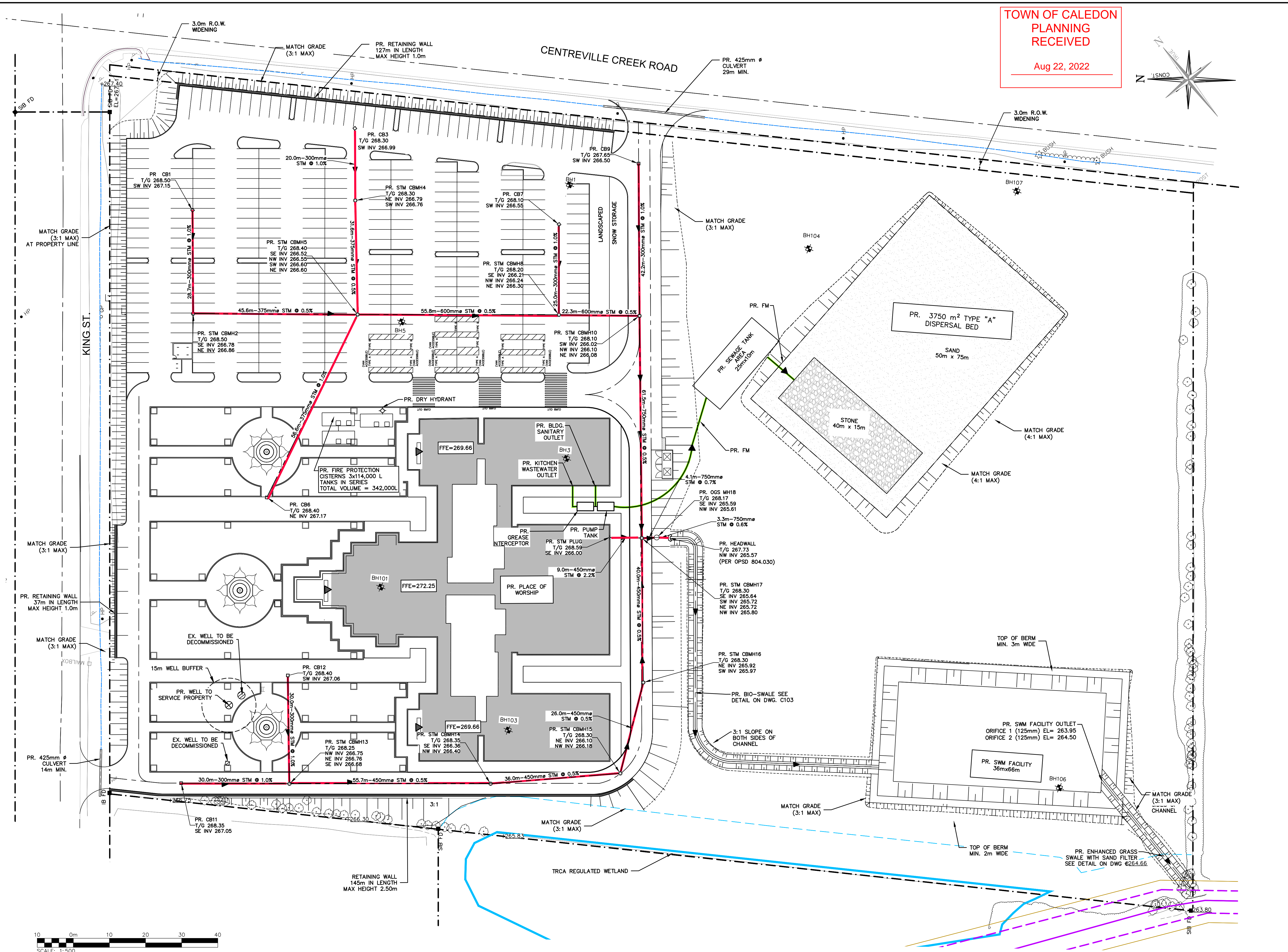
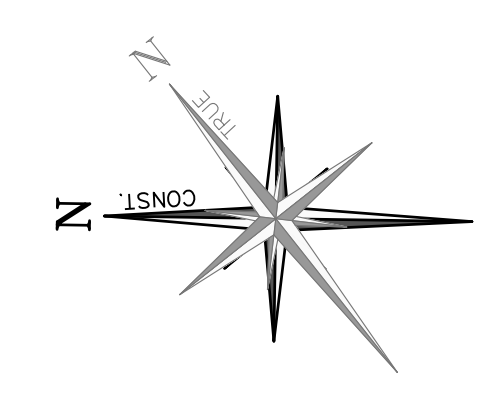

**LEGEND**

- PROPERTY LINE
- EXISTING DITCH
- EXISTING FENCE
- EXISTING TREE DRIP LINE
- EXISTING TREE
- TRCA REGULATED WETLAND
- 10.0m TRCA REGULATED WETLAND BUFFER
- BOREHOLES (BY OTHERS)
- PROPOSED RETAINING WALL
- PROPOSED SLOPE
- PROPOSED WELL
- PROPOSED SANITARY FORCEMAIN
- PROPOSED STORM SEWER & MANHOLE
- PROPOSED CATCHBASIN MANHOLE
- PROPOSED SINGLE / DOUBLE CATCHBASIN
- PROPOSED DRY HYDRANT

**NOT FOR CONSTRUCTION**



1	ISSUED FOR SECOND SUBMISSION	2022/JUN/17
0	ISSUED FOR FIRST SUBMISSION	2020/DEC/23
No.	ISSUE / REVISION	YYYY/MM/DD

**ELEVATION NOTE:**  
ELEVATIONS SHOWN ON THIS PLAN ARE DERIVED FROM A COSINE BENCHMARK No. 00B1975057  
ELEVATION = 251.929m

**SURVEY NOTES:**  
SURVEY COMPLETED BY P&C SURVEYING INC. (2019/DEC/06)  
REFERENCE No.: 2019-1206  
BEARINGS ARE UTM GRID. DERIVED FROM RTN OBSERVATIONS  
UTM ZONE 17, NAD83 (GSR) (2010.0)  
DISTANCES ARE GROUND AND CAN BE CONVERTED TO GRID BY MULTIPLYING BY THE COMBINED SCALE FACTOR OF 0.9996781

**SITE PLAN NOTES:**  
DESIGN ELEMENTS ARE BASED ON SITE PLAN BY BATTAGLIA ARCHITECT INC.  
DRAWING No.: A1, REV 2 (2022/MAY/31)

**DRAWING NOTES:**  
THIS DRAWING IS THE EXCLUSIVE PROPERTY OF C.F. CROZIER & ASSOCIATES INC. AND THE REPRODUCTION OF ANY PART OF IT WITHOUT PRIOR WRITTEN CONSENT OF THIS OFFICE IS STRICTLY PROHIBITED.  
THE CONTRACTOR SHALL VERIFY ALL DIMENSIONS, LEVELS, AND DATUMS ON SITE AND REPORT ANY DISCREPANCIES OR OMISSIONS TO THIS OFFICE PRIOR TO CONSTRUCTION.  
THIS DRAWING IS TO BE READ AND UNDERSTOOD IN CONJUNCTION WITH ALL OTHER PLANS AND DOCUMENTS APPLICABLE TO THIS PROJECT. DO NOT SCALE THIS DRAWING.  
ALL EXISTING UNDERGROUND UTILITIES TO BE VERIFIED IN THE FIELD BY THE CONTRACTOR PRIOR TO CONSTRUCTION.

Project  
**6939 KING STREET  
TOWN OF CALEDON  
REGION OF PEE**

Drawing  
**PRELIMINARY SERVICING PLAN**

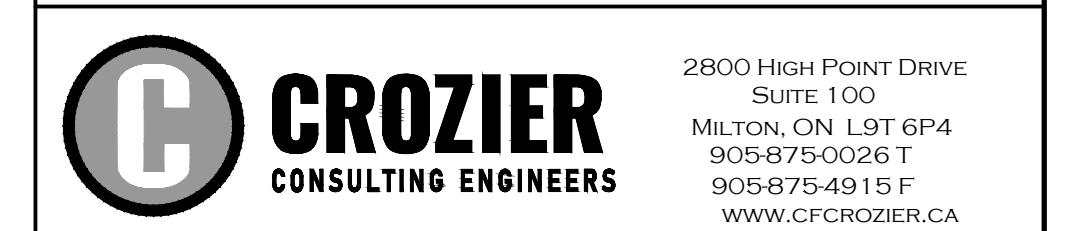

Drawn	A.S.	Design	A.S.	Project No.	1990-5787
Check	K.R./R.A.	Check	K.R./R.A.	Scale	1:500
				Dwg.	C102

