

SPECIFICATIONS

A. General

The following Tree Preservation and Protection Measures will be undertaken to help eliminate and/or significantly reduce construction injury to all trees recommended for preservation. All temporary tree protection measures cited for retained trees must comply with the Town of Caledon Tree Protection Specifications and Details. Any variation from the standard tree protection measures must be approved in writing by the Town of Caledon.

B. Pre-Construction Phase

- Prior to construction, the trees to be preserved shall be protected with a Tree Protection Barrier. The barrier shall consist of 1.2m (4ft) high orange plastic snow fence wired to T-bars (see Town of Caledon Tree Preservation Fencing, STD 606).
- If applicable, attach a filter cloth 600mm high to the construction side of the hoarding to act as sediment control. Sediment control fencing shall meet or exceed CPSP 210.110, and be installed to the satisfaction of the Town of Caledon.
- All supports and bracing used to safely secure the barrier should be located outside the Tree Protection Zone (TPZ). All supports and bracing should minimize damage to roots.
- The TPZ fence is to be installed along the edge of the tree protection zones. This hoarding is to remain in place and remain in good condition throughout the entire duration of the project. Dismantling the tree protection barrier prior to approval by the Town of Caledon staff may constitute a contravention.
- The applicant shall notify the Town of Caledon and the consulting certified arborist or landscape architect to confirm that the tree protection barriers are in place.

- Where fill or excavated material must be temporarily located near a TPZ, a wooden barrier must be used to ensure no material enters the TPZ.
- Remove any garbage and foreign debris from the tree protection zones, daily.
- For the trees that were recommended for removal and/or crown pruning that are within the TPZ limits, these activities are to be performed by a qualified ISA certified arborist prior to the installation of the Tree Protection Zone barriers and prior to the commencement of any construction activities. Install the Tree Protection Zone barrier as per Tree Preservation Fencing, STD 606 at the limits shown on the tree inventory and protection plan after the tree removal, whichever is greater, and crown pruning activities are completed.
- A Tree Protection Zone sign must be mounted on all sides of the tree protection barrier for the duration of site construction. The sign should be a minimum of 40cm x 60cm and made of white gator board or equivalent material.
- The sign must be similar to the illustration shown below, or as directed by the Town of Caledon.

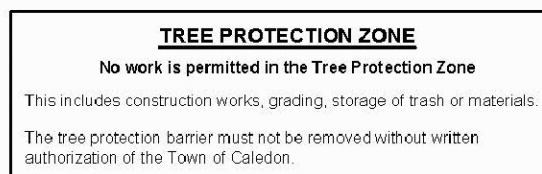

- All contractors and site visitors should be informed of the tree preservation and protection measures at a pre-construction meeting.

specifications continued on next panel...

TOWN OF CALEDON		APPRD.	B.B.	DATE	AUGUST 17
TREE PRESERVATION STANDARD NOTES - PART 1		DRAWN	B.M.	SCALE	NTS
NO.	REVISION	APPRD.	DATE	STANDARD No. 710	

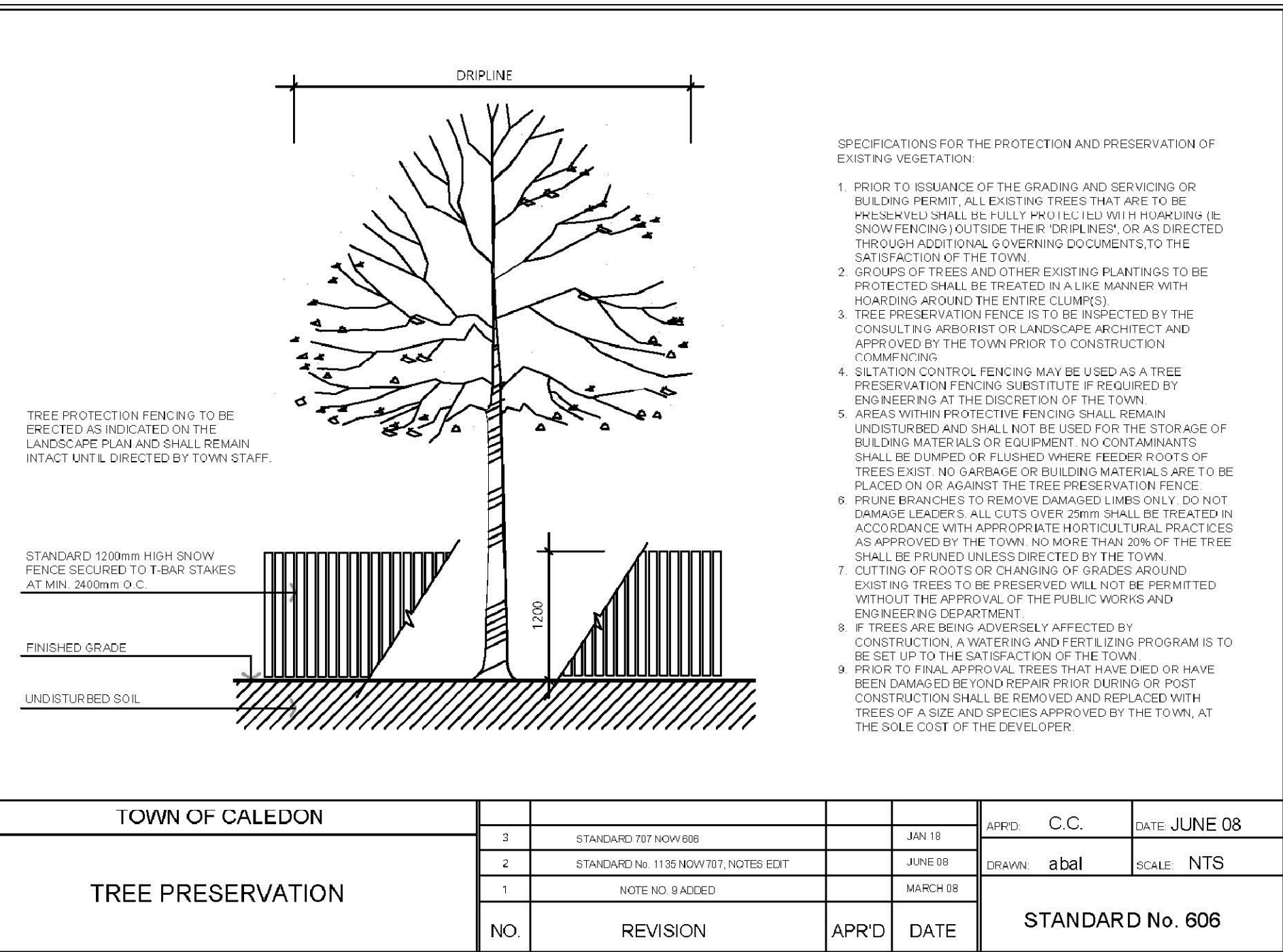

SPECIFICATIONS

continued from previous panel

C. During Construction Phase

- All areas within the TPZ shall remain undisturbed for the duration of construction. There will be no grade changes, dumping, and storage of any materials, structures or equipment within these areas. The Tree Protection Barrier must not be removed without the written authorization of the Town of Caledon.
- Minor grading works will be permitted at the edge of the preservation zone as required to correct localized depressions, and blend to existing grades. This work to be undertaken under the direct supervision of an ISA certified arborist. A certified ISA arborist will undertake proper root pruning in accordance with acceptable arboriculture practices when and if roots of retained trees are to be exposed, damaged, or severed by construction work. The exposed roots will be banded with appropriate material as soon as possible to prevent desiccation. Root pruning prior to excavation will help prevent necessary damage to tree roots. The use of low pressure hydrovac to expose roots is discouraged, as is root sawing.
- The Town of Caledon must be notified for all work that impacts the TPZ for temporary removal of a section of hoarding to gain access for fine grading or other works. All works are to be supervised by the Town of Caledon.
- No cables, wire or ropes of any kind shall be wrapped around or installed in trees to be preserved.
- No contaminants will be dumped or flushed in the TPZ areas or where feeder roots of trees exist (generally beyond the TPZ areas).
- Single tree protection zones during drought conditions, June to September to reduce drought stress.
- Inspect the site daily to ensure hoarding is in place and in good condition. Inspect trees to monitor condition.

D. Post Construction Phase

- Following the completion of all site works including landscaping, and after review and approval by the Town of Caledon staff, the protective hoarding may be removed.
- After removal of the protective hoarding, the Tree Preservation Zones shall be inspected by the Town of Caledon staff. Any remaining dead, diseased, or hazardous limbs or trees are to be removed by an ISA certified arborist as directed by the consulting arborist or Town of Caledon staff.

end of specifications

TOWN OF CALEDON		APPRD.	B.B.	DATE	AUGUST 17
TREE PRESERVATION STANDARD NOTES - PART 2		DRAWN	B.M.	SCALE	NTS
NO.	REVISION	APPRD.	DATE	STANDARD No. 711	

01 TREE PROTECTION HOARDING AND STANDARD NOTES

EXISTING TREE INVENTORY

KEY	SPECIES	DSH (cm)	CROWN (m)	HEALTH G/F/P	STRUCTURE	COMMENTS	OWNERSHIP	PRESERVATION DIRECTION	MIN. TPZ (m)	KEY
040	Malus	31,34,37 (59)	12	Poor	Multi-Stem	Crowded by adjacent tree, 3 stems, union at base, major decay, epicormic growth, declining	Neighbour	To be Removed by Adjacent Owner Under Separate Application	3.6	040
041	Basswood	60	10	Poor	Irregular	Crowded by adjacent tree, major decay, broken branch, decay in trunk	Neighbour	To be Removed by Adjacent Owner Under Separate Application	3.6	041
042	Basswood	41	10	Poor	Double - Leader	Crowded by adjacent tree, broken branches, major deadwood	Neighbour	To be Removed by Adjacent Owner Under Separate Application	3.0	042
043	Basswood	21,25,33,38 (60)	12	Poor	Multi-Stem	Crowded by adjacent tree, 4 stems, broken branches, fruiting bodies present, union at base	Neighbour	To be Removed by Adjacent Owner Under Separate Application	3.6	043
044	Basswood	24,31,32,33 (60)	12	Poor	Multi-Stem	Crowded by adjacent tree, 5 stems, broken branches, cross branching, broken branches, declining, %50 dead	Neighbour	To be Removed by Adjacent Owner Under Separate Application	3.6	044
045	Mix Vegetation	<10	varies	Poor	Group	A mix of dead ash and buckthorn	Private	Remove	1.2	045
046	Basswood	9,11,13,15 (24)	4	Fair	Multi-Stem	Crowded by adjacent tree, 4 stems, narrow form, crowded branching	Private	Remove	1.8	046
047	Basswood	22	6	Fair	High-Crown	Crowded by adjacent tree, epicormic growth	Private	Remove	1.8	047
048	Basswood	11,11 (16)	4	Poor	Multi-Stem	2 stems, narrow form	Private	Remove	1.8	048
049	Basswood	17	4	Fair	Narrow	Crowded by adjacent tree, high crown, vine entangled	Private	Remove	1.8	049
050	Basswood	17	4	Poor	Narrow	Crowded by adjacent tree, one-sided, vine entangled	Private	Remove	1.8	050
051	Manitoba Maple	35	12	Poor	One-sided	Major deadwood, double leader, crowded branches, broken branches	Private	Remove	2.4	051
052	Basswood	11,20,34,39,45 (70)	14	Fair	Multi-Stem	5 stems, broad form, crowded branches, union at base, broken branches	Private	Remove	4.2	052
053	Basswood	13,21,29,42 (57)	14	Fair	Multi-Stem	4 stems, broad form, union at base, crowded branches, cross branching	Private	Remove	3.6	053
054	Basswood	10-15	varies	Fair	Group	Crowded by adjacent tree, 8 stems, high crown	Private	Remove	1.8	054
055	Mix Vegetation	<60	varies	Poor	Group	Mix of Basswood, dead Ash, Scots pine and Birch	Shared	Preserve	3.6	055
056	Buckthorn	<10	varies	Poor	Group		Shared	Preserve	1.2	056
057	Birch	11	3	Fair	Leaning	Crowded by adjacent tree	Shared	Remove	1.8	057
058	Birch	26	8	Fair	High-Crown	Crowded by adjacent tree, crowded branching, minor deadwood	Shared	Remove	1.8	058
059	Birch	22	6	Poor	Narrow	Crowded by adjacent tree, %50 dead, leaning, declining	Shared	Remove	1.8	059
060	Birch	26	6	Poor	Narrow	Crowded by adjacent tree, 50% dead, major deadwood	Shared	Remove	1.8	060
061	Birch	12	3	Poor	One-sided	Crowded by adjacent tree, broken branches	Shared	Remove	1.8	061
062	Birch	12	3	Poor	One-sided	Crowded by adjacent tree, dieback in crown, broken branches	Shared	Remove	1.8	062
063	Birch	12	3	Poor	Leaning	Crowded by adjacent tree, irregular form, broken branches	Shared	Remove	1.8	063

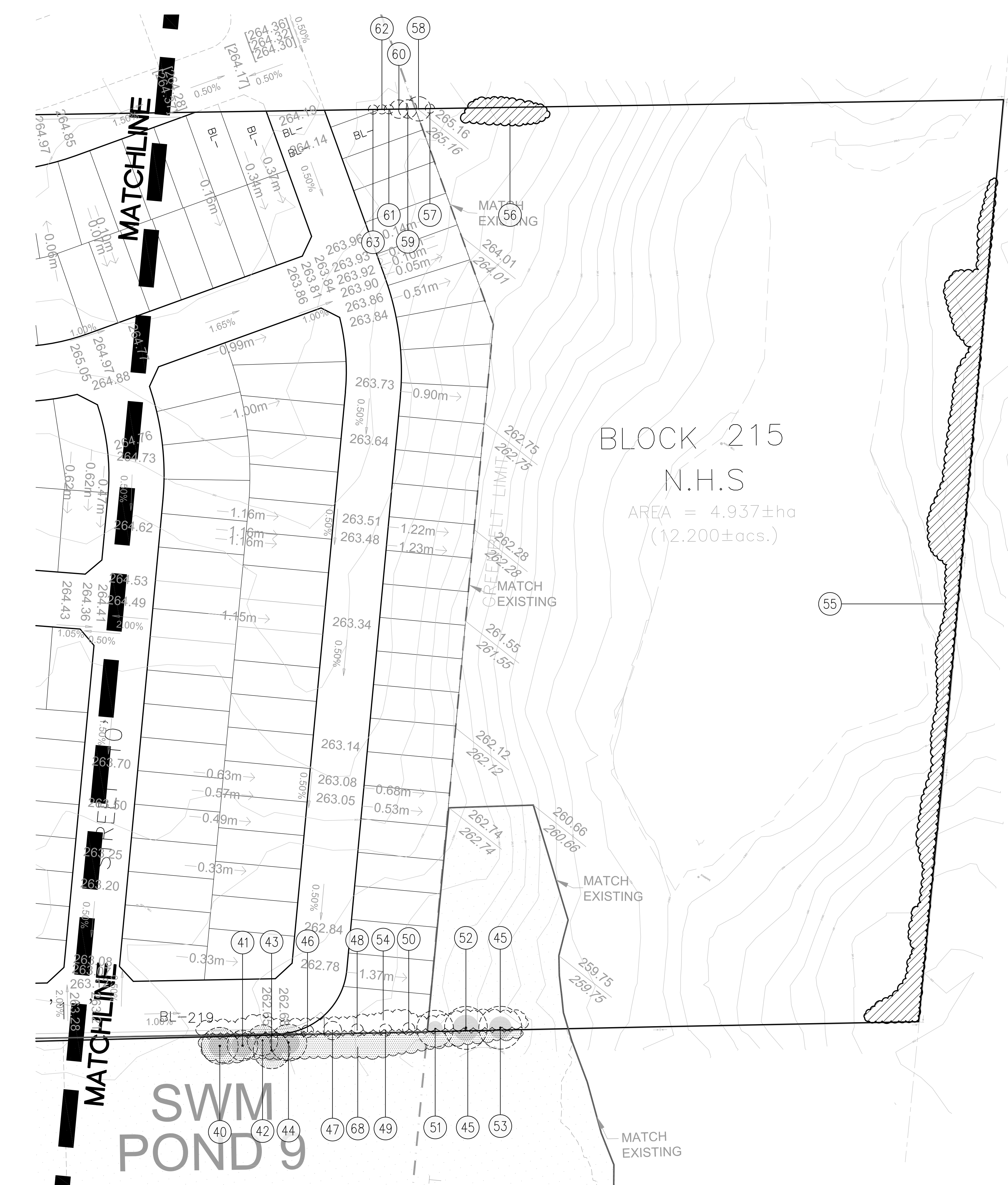

TOWN OF CALEDON PLANNING RECEIVED
05/07/2026

GENERAL NOTES

- VERIFY ALL DIMENSIONS. DO NOT SCALE DRAWINGS.
- REPORT ANY DISCREPANCIES, DISCOVERED ERRORS, OR OMISSIONS TO THE LANDSCAPE ARCHITECT BEFORE PROCEEDING.
- IT IS ADVISED THAT CONTRACTORS CONTACT THE LANDSCAPE ARCHITECT PRIOR TO CONSTRUCTION TO ENSURE THE USE OF THE LATEST REVISED DRAWINGS.
- DRAWINGS AND SPECIFICATIONS ARE THE PROPERTY OF THE LANDSCAPE ARCHITECT.

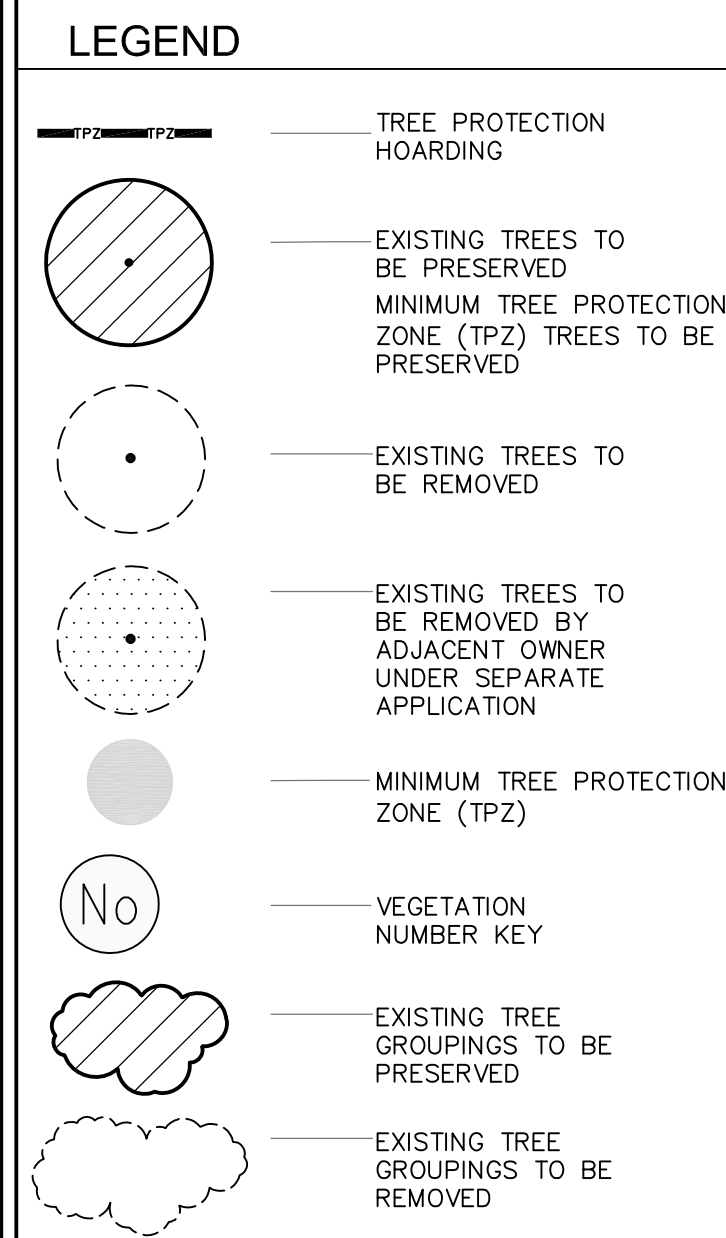
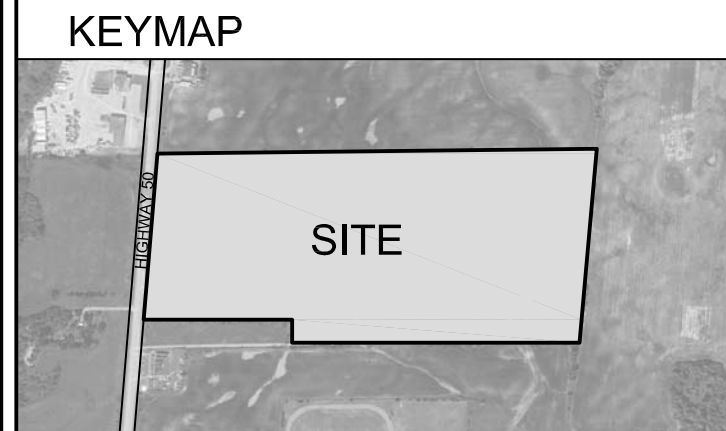

Matthew C. Gehres
MATTHEW C. GEHRES
International Society of Arboriculture
Certified Arborist #ON-1144
Date: MAY 5th 2026

3.	MAY 5, 2026	NEW PRELIMINARY GRADING PLAN	M.G.
2.	APR 15, 2026	ISSUED FOR SUBMISSION	M.G.
1.	APR 10, 2026	ISSUED FOR REVIEW	M.G.
No.	DATE	REVISION	BY

It is the responsibility of the Contractor and/or Owner to ensure that the drawings with the latest revisions are used for construction.

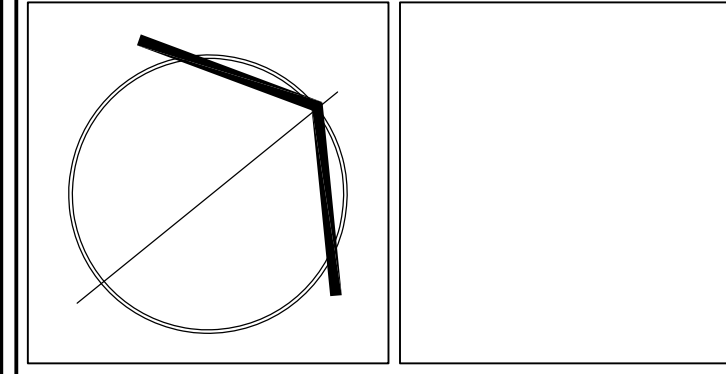

SBK 5770 HURONTARIO STREET, SUITE 320
MISSISSAUGA, ONTARIO, L4R 3G5
T: 416.695.4949 F: 905.712.3101
WWW.STRYBOS.COM

STRAYBOS BARRON KING
LANDSCAPE ARCHITECTURE

PROJECT:
14337 HIGHWAY 50, PART 1
BOLTON NORTH HILL
LANDOWNERS GROUP
VILLAGE OF BOLTON, TOWN OF CALEDON
ONTARIO

DRAWING TITLE:
EXISTING TREE INVENTORY AND PRESERVATION PLAN

SCALE:	1:750	PROJECT No.	6206
DATE:	APRIL 2026	DRAWING No.	V101
DRAWN BY:	A.S.M.	CHECKED BY:	M.G.