



**STRYBOS BARRON KING**  
LANDSCAPE ARCHITECTURE

PARTNERS  
ASSOCIATES

BRYN BARRON, OALA, CSLA, ISA  
ALISTAIR JOHNSTON, LOHTA, ISA, ASCA  
SALVATORE VIOLA, OALA, CSLA  
MATTHEW REGIMBAL, LOHTA, ISA  
LORIE ANN BLACK, OALA, CSLA

TOWN OF CALEDON  
PLANNING  
RECEIVED

March 12, 2025

---

## **ARBORIST REPORT**

**ARGO MAYFIELD WEST V  
PROPOSED RESIDENTIAL SUBDIVISION  
12192 CHINGUACOUSY ROAD  
TOWN OF CALEDON, ONTARIO**

---

**PREPARED FOR:  
ARGO MAYFIELD WEST V  
c/o ARGO DEVELOPMENT CORPORATION  
4900 PALLADIUM WAY, SUITE 105  
BURLINGTON, ONTARIO  
L7M 0W7**

**PREPARED BY:  
STRYBOS BARRON KING LTD.  
5770 HURONTARIO STREET  
SUITE 320  
MISSISSAUGA, ONTARIO  
L5R 3G5**

**ISA CERTIFIED ARBORIST  
MATTHEW C. GEHRES ON-1114A  
OUR PROJECT NO:  
24-6065**

**February 7, 2025**

## TABLE OF CONTENTS

Introduction .....	1
Site Context .....	1
Plans Utilized.....	1
Tree Inventory .....	1
Inventory List.....	2
Inventory Summary .....	3
Discussion & Recommendations.....	4
Summary of Removals Subject to Private Tree Bylaw .....	4
Removal Compensation Ratio for Healthy Tableland Trees.....	7
Tree Protection Measures.....	9
Pre-Construction.....	9
Conclusion .....	10
Appendix A – Conceptual Draft Plan .....	11
Appendix B – Contextual Tree Inventory and Preservation Plan.....	12
Appendix C – Site Photographs .....	13
Appendix D - Tree Protection Hoarding Details (for reference) .....	18

Enclosed:      Tree Inventory and Preservation Plans

### **Introduction**

Strybos Barron King Ltd. was retained by Argo Mayfield West V, c/o Argo Development Corporation, to prepare and Arborist Report for the subject property in accordance with the Town of Caledon requirements. The purpose of this study is to determine the species, composition, character and health of existing trees and assess opportunities for preservation in relation to a proposed Draft Plan of subdivision. The subject property is located at 12192 Chinguacousy Road (North of Mayfield Road on the west side of Chinguacousy Road) in the Town of Caledon, Ontario.

The owner is filing a Draft Plan of Subdivision application in support of a residential development on the subject property. Based on the preliminary Draft Plan of Subdivision and anticipated construction, grading and servicing works, all trees within the development areas will require removal. A total of 103 trees, subject to the Private Tree Bylaw, require removal.

### **Site Context**

The subject site (12192 Chinguacousy Rd.) is located on the west side of Chinguacousy Road, north of Mayfield Road. Currently, the subject property is a working horse farm including a residence, stables, sheds/barns, horse tracks and open fields. The majority of the existing trees are generally semi-mature to mature and occur along the property boundaries as well as sporadically throughout the property and around exiting buildings. The trees are composed of coniferous hedgerows, mixed, intermittent rows of trees and naturalized individuals.

### **Plans Utilized**

A Preliminary Draft Plan prepared by Gerrard Design along with a Topographic survey plan provided by RP-E Surveying Ltd., were used to determine the location of existing trees in relation to the proposed development works.

### **Tree Inventory**

The site was visited by an ISA Certified Arborist. All trees and groupings within the subject site as well as within 6 metres of the subject site were inventoried as per Town of Caledon requirements. All trees inventoried were tagged with metal tree tags and located on the Topographic survey.

The trees are described in terms of species and diameter at breast height (DBH – measured at 1.4m from grade). They were assessed in terms of their general health from poor to good; **GOOD** – trees in good overall health and condition with desirable structure, **FAIR** – trees in moderate health and condition with less desirable structure, and **POOR** – trees displaying prominent health issues such as decay and disease and/or poor form and structure.

Refer to attached V100, V101 & V102 - *Tree Inventory and Preservation Plan* for locations of, and details pertaining to specific trees.

**STRYBOS BARRON KING LTD.**  
**Arborist Report**  
 Argo Mayfield West V – Town of Caledon

EXISTING TREE INVENTORY										
KEY	SPECIES	DBH (centimetres)	CROWN (metres)	HEALTH G/F/P	STRUCTURE	COMMENTS	OWNERSHIP	PRESERVATION DIRECTION	MIN. TPZ (metres)	KEY
801	Scots Pine	30	6	Fair-Good	Leaning	Scaffolding branches, minor deadwood in crown, pruned lower branches, poor pruning	Subject Site	Remove	2.4	801
802	Scots Pine	28	6	Fair	One-Sided	Pruned lower branches, poor pruning, minor deadwood, crowded by adjacent tree	Subject Site	Remove	1.8	802
803	Scots Pine	30	8	Fair	Symmetrical	Pruned lower branches, poor pruning, crowded by adjacent tree, dieback in lower branches	Subject Site	Remove	2.4	803
804	Scots Pine	23	6	Poor-Fair	One-Sided	Crowded by adjacent trees, broken branches, adjacent tree 805 leaning on crown, twist in trunk	Subject Site	Remove	1.8	804
805	Scots Pine	25			DEAD	Broken at base, leaning on tree 804	Subject Site	Remove	1.8	805
806	Scots Pine	17			DEAD	Leaning	Subject Site	Remove	1.8	806
807	Scots Pine	24	4	Fair	One-Sided	Pruned lower branches, poor pruning, crowded by adjacent tree, dieback in lower branches	Subject Site	Remove	1.8	807
808	Scots Pine	22	6	Fair	Irregular	Pruned lower branches, poor pruning, crowded by adjacent tree, twist in trunk	Subject Site	Remove	1.8	808
809	Scots Pine	29	8	Fair	One-Sided	Pruned lower branches, crowded by adjacent tree, open wound on trunk	Subject Site	Remove	1.8	809
810	Scots Pine	26	8	Fair	One-Sided	Pruned lower branches, crowded by adjacent tree, open wound at .5m.ht	Subject Site	Remove	1.8	810
811	Scots Pine	15	4	Fair-Poor	Leaning	Pruned lower branches, poor pruning, minor deadwood, crowded by adjacent tree, curve in trunk	Subject Site	Remove	1.8	811
812	Scots Pine	28	8	Fair-Poor	Irregular	Pruned lower branches, poor pruning, broken branches, crowded by adjacent tree	Subject Site	Remove	1.8	812
813	Scots Pine	26	6	Fair	One-Sided	Crowded by adjacent trees, curve in trunk	Subject Site	Remove	1.8	813
814	Scots Pine	28	8	Fair	One-Sided	Pruned lower branches, poor pruning, minor deadwood, crowded by adjacent tree	Subject Site	Remove	1.8	814
815	Scots Pine	26	6	Fair	Leaning	Pruned lower branches, poor pruning, crowded by adjacent tree, slight lean in trunk	Subject Site	Remove	1.8	815
816	Scots Pine	19	4	Fair	Irregular	Pruned lower branches, poor pruning, crowded by adjacent tree, twist in trunk	Subject Site	Remove	1.8	816
817	Scots Pine	26	8	Fair	Symmetrical	Pruned lower branches, poor pruning, minor deadwood, crowded by adjacent tree	Subject Site	Remove	1.8	817
818	Scots Pine	32	10	Fair	One-Sided	Pruned lower branches, poor pruning, minor deadwood, crowded by adjacent tree	Subject Site	Remove	2.4	818
819	Scots Pine	18			DEAD		Subject Site	Remove	1.8	819
820	Scots Pine	15	2	Fair	Major Lean	Pruned lower branches, horizontal stem, crowded by adjacent tree	Subject Site	Remove	1.8	820
821	Scots Pine	22	8	Poor-Fair	Leaning	Pruned lower branches, crowded by adjacent tree, multi-leader, broken branches, included bark	Subject Site	Remove	1.8	821
822	Buckthorn	<10	varies	Poor	Multi-Stem	11 stems in total, union at base, crowded branching	Subject Site	Remove	1.2	822
823	Scots Pine	19			DEAD		Subject Site	Remove	1.8	823
824	Scots Pine	20			DEAD		Subject Site	Remove	1.8	824
825	Scots Pine	22			DEAD		Subject Site	Remove	1.8	825
826	Scots Pine	31	8	Fair	Double Leader	Pruned lower branches, crowded by adjacent tree, included bark, union at 3m.ht	Subject Site	Remove	2.4	826
827	Scots Pine	22	6	Fair	Major Lean	Pruned lower branches, poor pruning, crowded by adjacent tree	Subject Site	Remove	1.8	827
828	Scots Pine	29	8	Fair	One-Sided	Pruned lower branches, poor pruning, minor deadwood, crowded by adjacent tree	Subject Site	Remove	1.8	828
829	Scots Pine	24	8	Fair	Symmetrical	Pruned lower branches, poor pruning, minor deadwood, crowded by adjacent tree	Subject Site	Remove	1.8	829
830	Scots Pine	23	6	Fair	One-Sided	Pruned lower branches, poor pruning, minor deadwood, crowded by adjacent tree	Subject Site	Remove	1.8	830
831	Scots Pine	25	8	Fair	One-Sided	Pruned lower branches, poor pruning, minor deadwood, crowded by adjacent tree	Subject Site	Remove	1.8	831
832	Scots Pine	29	8	Fair	Irregular	Pruned lower branches, poor pruning, minor deadwood, crowded by adjacent tree	Subject Site	Remove	1.8	832
833	Scots Pine	27	8	Fair	Leaning	Pruned lower branches, poor pruning, minor deadwood, crowded by adjacent tree	Subject Site	Remove	1.8	833
834	Scots Pine	22	6	Fair	One-Sided	Pruned lower branches, poor pruning, minor deadwood, crowded by adjacent tree	Subject Site	Remove	1.8	834
835	Scots Pine	14	4	Poor	Leaning	Pruned lower branches, poor pruning, crowded by adjacent tree, double leader	Subject Site	Remove	1.8	835
836	Scots Pine	28			DEAD		Subject Site	Remove	1.8	836
837	Scots Pine	30	8	Fair-Good	Leaning	Pruned lower branches, double leader, crowded by adjacent tree	Subject Site	Remove	2.4	837
838	Scots Pine	13	4	Fair	Leaning	Pruned lower branches, poor pruning, double leader, crowded by adjacent tree	Subject Site	Remove	1.8	838
839	Scots Pine	31	8	Fair	Double Leader	Pruned lower branches, union at 4m.ht., minor deadwood, crowded by adjacent tree	Subject Site	Remove	2.4	839
840	Scots Pine	30	8	Fair	Irregular	Pruned lower branches, twist in trunk, minor deadwood, crowded by adjacent tree	Subject Site	Remove	2.4	840
841	Scots Pine	23			DEAD		Subject Site	Remove	1.8	841
842	Buckthorn	3-15	varies	Poor	Multi-Stem	6 stems in total, 1 stem over 10cm DBH, union at base, crowded by adjacent tree	Subject Site	Remove	1.8	842
843	White Spruce	43	12	Good	Pyramidal	Crowded by adjacent tree, dieback in lower branches	Subject Site	Remove	3.0	843
844	White Spruce	18-21	8	Fair	Double Leader	union at base, included bark, dieback in lower branches	Subject Site	Remove	1.8	844
845	Scots Pine	22	3	Poor	High Crown	Crowded by adjacent tree, dieback in lower branches, broken branches	Subject Site	Remove	1.8	845
846	Manitoba Maple	13	2	Poor	Leaning	crowded by adjacent tree, epicormic growth	Subject Site	Remove	1.8	846
847	White Spruce	33	10	Fair-Good	Pyramidal	Crowded by adjacent tree, dieback in lower branches	Subject Site	Remove	1.8	847
848	White Spruce	29	8	Poor	Irregular	Broken leader, dieback in crown, broken branches, double leader	Subject Site	Remove	1.8	848
849	White Spruce	36	6	Fair	Pyramidal	Dieback in lower branches, broken branches	Subject Site	Remove	2.4	849
850	Juniper	14	4	Good	Oval	leaning, branching to grade	Subject Site	Remove	1.8	850
851	Buckthorn	<11	6	Poor	Multi-Stem	6 Stems in total, 1 over 10cm DBH, crowded by adjacent tree	Subject Site	Remove	1.8	851
852	White Spruce	30	8	Fair	Pyramidal	Dieback in lower branches, leaning, exposed roots, crowded by adjacent tree	Subject Site	Remove	2.4	852
853	Buckthorn	6-15	8	Poor	Multi-Stem	4 stems in total, 2 stems over 10cm DBH, crowded by adjacent tree, union at base	Subject Site	Remove	1.8	853
854	White Spruce	30	8	Fair	Pyramidal	Crowded by adjacent tree, dieback in lower branches	Subject Site	Remove	2.4	854
855	White Spruce	21			DEAD		Subject Site	Remove	1.8	855
856	Bur Oak	105	24	Good	Broad	Mature tree, minor deadwood, epicormic growth, poor pruning	Subject Site	Remove	6.3	856
857	White Spruce	40	8	Fair-Good	Pyramidal	Crowded by adjacent tree, minor deadwood, dieback in lower branches	Subject Site	Remove	2.4	857
858	White Spruce	20			DEAD		Subject Site	Remove	1.8	858
859	White Spruce	19	2	Poor	Pyramidal	Dieback in lower branches, broken branches	Subject Site	Remove	1.8	859
860	White Spruce	28	8	Fair-Good	Pyramidal	Minor deadwood, leaning, branching to grade	Subject Site	Remove	1.8	860
861	White Spruce	27	6	Fair	Pyramidal	Narrow form, branching to grade	Subject Site	Remove	1.8	861
862	White Spruce	38	8	Fair-Good	Pyramidal	Crowded by adjacent tree, branching to grade	Subject Site	Remove	2.4	862
863	Buckthorn	18	4	Poor	Irregular	Crowded by adjacent tree	Subject Site	Remove	1.8	863
864	White Spruce	34	8	Fair	Pyramidal	Crowded by adjacent tree, branching to grade, dieback in lower branches	Subject Site	Remove	2.4	864
865	White Spruce	41	10	Fair	Pyramidal	Crowded by adjacent tree, branching to grade, broken branches, minor deadwood	Subject Site	Remove	3.0	865
866	Buckthorn	14,16	4	Poor	Multi-Stem	Union at base, crowded branching	Subject Site	Remove	1.8	866
867	Buckthorn	10-18	varies	Poor	Group	10 stems in total, 2 stems over 10cm DBH, crowded branching, epicormic growth throughout	Boundary	Remove	1.8	867
868	Mulberry	21	5	Fair-Poor	Double Leader	Crowded by adjacent tree, included bark, poor pruning, broken branches	Subject Site	Remove	1.8	868
869	Black Walnut	10	1	Fair-Poor	Narrow	Crowded by adjacent tree	Subject Site	Remove	1.8	869
870	Mulberry	28	8	Fair	Double Leader	Crowded by adjacent tree, included bark, poor pruning, broken branches, crowded branching	Subject Site	Remove	1.8	870
871	Emerald Cedar	3-19	4	Good	Pyramidal	6 stems in total, 2 stems over 10cm DBH	Subject Site	Remove	1.8	871
872	Bur Oak	113	24	Poor-Fair	Mature	Major decay at base, peeling bark, broken branches	Subject Site	Remove	6.8	872
873	Bur Oak	88	22	Fair	Mature	Crowded by adjacent tree, dieback in lower branches, broken branches	Subject Site	Remove	5.4	873
874	Bur Oak	80	24	Fair	Mature	Crowded by adjacent tree, dieback in lower branches, broken branches	Subject Site	Remove	5.4	874
875	Bur Oak	99	20	Fair	Mature	Crowded by adjacent tree, dieback in lower branches, broken branches	Subject Site	Remove	6.0	875

EXISTING TREE INVENTORY										
KEY	SPECIES	DBH	CROWN	HEALTH	STRUCTURE	COMMENTS	OWNERSHIP	PRESERVATION	MIN. TPZ	KEY
		(centimetres)	(metres)	G/F/P				DIRECTION	(metres)	
876	Colorado Blue Spruce	22	6	Good	One-Sided	Branching to grade, dieback in lower branches, crowded by adjacent tree	Subject Site	Remove	1.8	876
877	Colorado Blue Spruce	29	6	Good	One-Sided	Branching to grade, dieback in lower branches, crowded by adjacent tree	Subject Site	Remove	1.8	877
878	Colorado Blue Spruce	25	6	Good	One-Sided	Branching to grade, dieback in lower branches, crowded by adjacent tree	Subject Site	Remove	1.8	878
879	Colorado Blue Spruce	39	8	Good	One-Sided	Branching to grade, dieback in lower branches, crowded by adjacent tree	Subject Site	Remove	2.4	879
880	Colorado Blue Spruce	24	6	Good	One-Sided	Branching to grade, dieback in lower branches, crowded by adjacent tree	Subject Site	Remove	1.8	880
881	Colorado Blue Spruce	31	8	Good	Pyramidal	Branching to grade, dieback in lower branches, crowded by adjacent tree	Subject Site	Remove	2.4	881
882	Colorado Blue Spruce	28	6	Good	One-Sided	Raised lower branches, crowded by adjacent tree	Subject Site	Remove	1.8	882
883	Colorado Blue Spruce	38	8	Poor	One-Sided	Pruned leader, raised lower branches, crowded by adjacent tree	Subject Site	Remove	2.4	883
884	Colorado Blue Spruce	32	6	Good	One-Sided	Raised lower branches, crowded by adjacent tree	Subject Site	Remove	2.4	884
885	Colorado Blue Spruce	52	6	Good	One-Sided	Raised lower branches, crowded by adjacent tree	Subject Site	Remove	3.6	885
886	Colorado Blue Spruce	27	6	Good	One-Sided	Raised lower branches, crowded by adjacent tree	Subject Site	Remove	1.8	886
887	Colorado Blue Spruce	29	6	Good	One-Sided	Raised lower branches, crowded by adjacent tree	Subject Site	Remove	1.8	887
888	Colorado Blue Spruce	44	8	Good	One-Sided	Raised lower branches, crowded by adjacent tree	Subject Site	Remove	3.0	888
889	Shag Bark Hickory	76	16	Poor	One-Sided	Broken leader, epicormic growth throughout, major split in trunk	Subject Site	Remove	4.8	889
890	Chokecherry	8-14	4	Fair-Good	Multi-Stem	3 stems total, 1 stem over 10cm DBH, union at base	Subject Site	Remove	1.8	890
891	Shag Bark Hickory	51	16	Fair	One-Sided	Crowded by adjacent tree, broken branches, minor deadwood	Subject Site	Remove	3.6	891
892	Bur Oak	111	24	Fair	Mature	Crowded by adjacent tree, broken branches, broad form	Subject Site	Remove	6.6	892
893	Ash	13			DEAD		Subject Site	Remove	1.8	893
894	Bur Oak	77	24	Fair	Mature	Crowded by adjacent tree, double leader, included bark, broken branches	Subject Site	Remove	4.8	894
895	White Oak	47	12	Fair-Good	Narrow	Crowded by adjacent tree, minor deadwood, broken branches	Boundary	Remove	3.0	895
896	American Elm	14,20	8	Fair	Double Leader	Crowded by adjacent tree, union at base, twist in trunk	Subject Site	Remove	1.8	896
897	Bur Oak	63	20	Fair-Good	Double Leader	Crowded by adjacent tree, one-sided, included bark, broken branches	Neighbour	Removed by Others	4.2	897
898	Bur Oak	41	18	Poor-Fair	One-Sided	Crowded by adjacent, double leader, epicormic growth	Subject Site	Remove	3.0	898
899	Bur Oak	56			DEAD		Neighbour	Removed by Others	3.6	899
900	Buckthorn	25	8	Poor	Multi-Leader	Crowded branching, adjacent to fence, epicormic growth throughout	Subject Site	Remove	1.8	900
901	American Elm	17-24	10	Poor-Fair	Multi-Stem	5 stems total, (17,18,19,21,24), Union at base, branching to grade, crowded branching	Subject Site	Remove	1.8	901
902	Buckthorn	<10	varies	Poor	Group	Adjacent to fence	Boundary	Removed by Others	1.8	902
903	Bur Oak	78	24	Poor-Fair	Mature	Crowded by adjacent tree, broken branches, poor pruning	Subject Site	Remove	4.8	903
904	Bur Oak	67	24	Fair	Mature	Crowded by adjacent tree, broken branches, cross branching	Boundary	Remove	4.2	904
905	American Elm	46	16	Fair-Poor	Multi-Leader	Union at 4m.ht, included bark, epicormic growth throughout	Subject Site	Remove	3.0	905
906	Buckthorn	<10	varies	Poor	Group	Adjacent to fence	Boundary	Removed by Others	1.2	906
907	Bur Oak	21	10	Fair-Good	Round	Crowded by adjacent tree	Subject Site	Remove	1.8	907
908	Bur Oak	22,23	12	Poor-Fair	Multi-Stem	Union at base, vine entangled, epicormic growth throughout.	Neighbour	Removed by Others	1.8	908
909	Bur Oak	109	28	Good	Mature	Broad, multi leader, minor deadwood	Subject Site	Remove	6.5	909
910	Shag Bark Hickory	17	4	Fair	Irregular	Crowded by adjacent tree, adjacent to fence	Subject Site	Remove	1.8	910
911	Shag Bark Hickory	15	4	Fair	Irregular	Crowded by adjacent tree, adjacent to fence	Subject Site	Remove	1.8	911
912	Malus Species	10-18	6	Poor-Fair	Multi-Stem	5 stems total, union at base, cross branching, epicormic growth throughout, minor deadwood	Subject Site	Remove	1.8	912
913	Buckthorn	<10	varies	Poor	Group	Adjacent to fence	Boundary	Removed by Others	1.2	913
914	American Elm	10-15	8	Poor	Multi-Stem	5 stems total, union at base, branching to grade, epicormic growth throughout	Neighbour	Removed by Others	1.8	914
915	Bur Oak	90			DEAD		Boundary	Remove	5.4	915
916	Manitoba Maple	21	6	Poor	Multi-Leader	Crowded by adjacent tree, adjacent to barn, open wound in trunk, minor decay	Subject Site	Remove	1.8	916
917	Manitoba Maple	23	6	Poor	Multi-Leader	Crowded by adjacent tree, epicormic growth throughout	Subject Site	Remove	1.8	917
918	Mulberry	47	12	Poor	Double Leader	Pollarded, poor pruning, broken branches	Subject Site	Remove	3.0	918
919	Juniper	26	12	Fair	Leaning	Elevated crown, scaffolding branches	Subject Site	Remove	1.8	919
920	Black Walnut	26	8	Poor-Fair	Irregular	Crowded by adjacent tree, twist in trunk	Subject Site	Remove	1.8	920
921	Colorado Blue Spruce	32	10	Good	Pyramidal	Branching to grade	Subject Site	Remove	2.4	921
922	Bur Oak	16	6	Good	Symmetrical	Poor pruning	Subject Site	Remove	1.8	922
923	Colorado Blue Spruce	43	10	Fair-Good	Pyramidal	Elevated crown	Subject Site	Remove	3.0	923
924	Austrian Pine	14,15	6	Fair	Multi-Stem	Union at base, epicormic growth throughout, poor pruning	Subject Site	Remove	1.8	924
925	Honey Locust	45	18	Poor-Fair	Irregular	Poor pruning, broken branches, epicormic growth throughout, crowded by adjacent tree	Subject Site	Remove	3.0	925
926	Mulberry	11	4	Fair	Irregular	Crowded by adjacent tree, open wound in trunk, poor pruning	Subject Site	Remove	1.8	926
927	Mulberry	20,20,25	10	Poor	Multi-Stem	Poor pruning, split at union, decay at base	Subject Site	Remove	1.8	927
928	Columnar Oak	52	6	Good	Columnar	Minor deadwood	Subject Site	Remove	3.6	928
929	Austrian Pine	12,17,36	8	Poor	Multi-Stem	Crowded by adjacent tree, broken branches, branching to grade	Subject Site	Remove	2.4	929
930	Buckthorn	<12	varies	Poor	Group	3 stems over 10cm DBH, crowded branching, crowded by adjacent tree	Subject Site	Remove	1.8	930
931	Colorado Blue Spruce	18	4	Poor	One-Sided	Raised canopy, adjacent to fence, broken branches, poor pruning, leaning	Subject Site	Remove	1.8	931

### Inventory Summary

The subject site is mainly composed of working horse farm including residential dwelling, stables/barns, paddocks, horse tracks and open fields. Most of the trees are composed of a mix of semi-mature to mature, coniferous hedgerows as well as naturalized, invasive thickets along the property lines. A number of mature, individual, naturalized trees occur along the property limits as well as around the existing buildings.

A staggered row of mature Scots Pine trees flanks the frontage of the property along Chinguacousy Road. This row is in generally poor to fair condition. The north property limit is flanked by a mix of mature coniferous hedgerows, invasive Buckthorn thickets, and individual Bur Oak trees. The health and condition of these trees and hedgerows varies from poor to good.

**Arborist Report**

Argo Mayfield West V – Town of Caledon

Mature rows of Colorado Blue Spruce trees occur along the rear yard flanking the west side of the existing dwelling. A mix of landscape accent trees including Juniper, Black Walnut, Colorado Blue Spruce, Bur Oak, Austrian Pine and Honey Locust occur around the existing dwelling. Overall, the health and condition of these trees varies from poor to good. A small number of mature individual Bur Oak trees as well as immature Shagbark Hickory and apple trees flank the southwest limit of the subject site. These trees are in generally fair condition with a few in poor or good health. The south property limit along the central and east limit of the subject site is sparsely treed and is limited to a small number of immature Buckthorn clusters.

The associated Tree Inventory & Preservation Plan prepared by our office provides detailed tree locations and removal/preservation recommendations.

**Discussion & Recommendations**

To accommodate the proposed Draft Plan with associated servicing, grading and construction requirements, all trees within the subject site will require removal. Several trees on the neighbouring lands abutting the subject site will also require removal to accommodate adjacent developments. These trees will be removed under the applications of the adjacent development proposals. Since no trees are to be preserved, tree protection hoarding is not required.

**Summary of Removals Subject to Town of Caledon Bylaw Requirements**

The following is a summary of proposed tree removals for this site.

***Tree Removals (Refer to The Tree Inventory List for specific details)***

KEY	SPECIES	DBH (cm)	HEALTH G/F/P	OWNERSHIP	ACTION
801	Scots Pine	30	Fair-Good	Subject Site	Remove
802	Scots Pine	28	Fair	Subject Site	Remove
803	Scots Pine	30	Fair	Subject Site	Remove
804	Scots Pine	23	Poor-Fair	Subject Site	Remove
807	Scots Pine	24	Fair	Subject Site	Remove
808	Scots Pine	22	Fair	Subject Site	Remove
809	Scots Pine	29	Fair	Subject Site	Remove
810	Scots Pine	26	Fair	Subject Site	Remove
811	Scots Pine	15	Fair-Poor	Subject Site	Remove
812	Scots Pine	28	Fair-Poor	Subject Site	Remove
813	Scots Pine	26	Fair	Subject Site	Remove
814	Scots Pine	28	Fair	Subject Site	Remove
815	Scots Pine	26	Fair	Subject Site	Remove
816	Scots Pine	19	Fair	Subject Site	Remove
817	Scots Pine	26	Fair	Subject Site	Remove
818	Scots Pine	32	Fair	Subject Site	Remove
820	Scots Pine	15	Fair	Subject Site	Remove
821	Scots Pine	22	Poor-Fair	Subject Site	Remove
826	Scots Pine	31	Fair	Subject Site	Remove
827	Scots Pine	22	Fair	Subject Site	Remove
828	Scots Pine	29	Fair	Subject Site	Remove
829	Scots Pine	24	Fair	Subject Site	Remove
830	Scots Pine	23	Fair	Subject Site	Remove

**STRYBOS BARRON KING LTD.****Arborist Report**

Argo Mayfield West V – Town of Caledon

KEY	SPECIES	DBH (cm)	HEALTH G/F/P	OWNERSHIP	ACTION
831	Scots Pine	25	Fair	Subject Site	Remove
832	Scots Pine	29	Fair	Subject Site	Remove
833	Scots Pine	27	Fair	Subject Site	Remove
834	Scots Pine	22	Fair	Subject Site	Remove
835	Scots Pine	14	Poor	Subject Site	Remove
837	Scots Pine	30	Fair-Good	Subject Site	Remove
838	Scots Pine	13	Fair	Subject Site	Remove
839	Scots Pine	31	Fair	Subject Site	Remove
840	Scots Pine	30	Fair	Subject Site	Remove
843	White Spruce	43	Good	Subject Site	Remove
844	White Spruce	18-21	Fair	Subject Site	Remove
845	Scots Pine	22	Poor	Subject Site	Remove
846	Manitoba Maple	13	Poor	Subject Site	Remove
847	White Spruce	33	Fair-Good	Subject Site	Remove
848	White Spruce	29	Poor	Subject Site	Remove
849	White Spruce	36	Fair	Subject Site	Remove
850	Juniper	14	Good	Subject Site	Remove
852	White Spruce	30	Fair	Subject Site	Remove
854	White Spruce	30	Fair	Subject Site	Remove
856	Bur Oak	105	Good	Subject Site	Remove
857	White Spruce	40	Fair-Good	Subject Site	Remove
859	White Spruce	19	Poor	Subject Site	Remove
860	White Spruce	28	Fair-Good	Subject Site	Remove
861	White Spruce	27	Fair	Subject Site	Remove
862	White Spruce	38	Fair-Good	Subject Site	Remove
864	White Spruce	34	Fair	Subject Site	Remove
865	White Spruce	41	Fair	Subject Site	Remove
868	Mulberry	21	Fair-Poor	Subject Site	Remove
869	Black Walnut	10	Fair-Poor	Subject Site	Remove
870	Mulberry	28	Fair	Subject Site	Remove
871	Emerald Cedar	3-19	Good	Subject Site	Remove
872	Bur Oak	113	Poor-Fair	Subject Site	Remove
873	Bur Oak	88	Fair	Subject Site	Remove
874	Bur Oak	80	Fair	Subject Site	Remove
875	Bur Oak	99	Fair	Subject Site	Remove
876	Colorado Blue Spruce	22	Good	Subject Site	Remove
877	Colorado Blue Spruce	29	Good	Subject Site	Remove
878	Colorado Blue Spruce	25	Good	Subject Site	Remove
879	Colorado Blue Spruce	39	Good	Subject Site	Remove
880	Colorado Blue Spruce	24	Good	Subject Site	Remove
881	Colorado Blue Spruce	31	Good	Subject Site	Remove
882	Colorado Blue Spruce	28	Good	Subject Site	Remove
883	Colorado Blue Spruce	38	Poor	Subject Site	Remove
884	Colorado Blue Spruce	32	Good	Subject Site	Remove
885	Colorado Blue Spruce	52	Good	Subject Site	Remove
886	Colorado Blue Spruce	27	Good	Subject Site	Remove
887	Colorado Blue Spruce	29	Good	Subject Site	Remove
888	Colorado Blue Spruce	44	Good	Subject Site	Remove
889	Shag Bark Hickory	76	Poor	Subject Site	Remove
890	Chokecherry	8-14	Fair-Good	Subject Site	Remove

**STRYBOS BARRON KING LTD.****Arborist Report**

Argo Mayfield West V – Town of Caledon

KEY	SPECIES	DBH	HEALTH	OWNERSHIP	ACTION
		(cm)	G/F/P		
891	Shag Bark Hickory	51	Fair	Subject Site	Remove
892	Bur Oak	111	Fair	Subject Site	Remove
894	Bur Oak	77	Fair	Subject Site	Remove
895	White Oak	47	Fair-Good	Boundary	Remove
896	American Elm	14,20	Fair	Subject Site	Remove
898	Bur Oak	41	Poor-Fair	Subject Site	Remove
901	American Elm	17-24	Poor-Fair	Subject Site	Remove
903	Bur Oak	78	Poor-Fair	Subject Site	Remove
904	Bur Oak	67	Fair	Boundary	Remove
905	American Elm	46	Fair-Poor	Subject Site	Remove
907	Bur Oak	21	Fair-Good	Subject Site	Remove
909	Bur Oak	109	Good	Subject Site	Remove
910	Shag Bark Hickory	17	Fair	Subject Site	Remove
911	Shag Bark Hickory	15	Fair	Subject Site	Remove
912	Malus Species	10-18	Poor-Fair	Subject Site	Remove
916	Manitoba Maple	21	Poor	Subject Site	Remove
917	Manitoba Maple	23	Poor	Subject Site	Remove
918	Mulberry	47	Poor	Subject Site	Remove
919	Juniper	26	Fair	Subject Site	Remove
920	Black Walnut	26	Poor-Fair	Subject Site	Remove
921	Colorado Blue Spruce	32	Good	Subject Site	Remove
922	Bur Oak	16	Good	Subject Site	Remove
923	Colorado Blue Spruce	43	Fair-Good	Subject Site	Remove
924	Austrian Pine	14,15	Fair	Subject Site	Remove
925	Honey Locust	45	Poor-Fair	Subject Site	Remove
926	Mulberry	11	Fair	Subject Site	Remove
927	Mulberry	20,20,25	Poor	Subject Site	Remove
928	Columnar Oak	52	Good	Subject Site	Remove
929	Austrian Pine	12,17,36	Poor	Subject Site	Remove
931	Colorado Blue Spruce	18	Poor	Subject Site	Remove

**Total number of tree removals - 103**



**Arborist Report**

Argo Mayfield West V – Town of Caledon

**Removal Compensation Ratio for Healthy Tableland Trees**

Compensation will be required for all privately owned tree removals at a rate as determined by the Town's Tableland Tree Removal Compensation guidelines. Tree compensation planting will be in addition to the standard required planting. Dead trees, neighbouring trees to be removed under a separate Draft Plan approval application, as well as invasive exotic trees, such as Buckthorn, are not included in the compensation calculations.

***Tree Removal Compensation Ratio for Healthy Tableland Trees***

<b>DBH (cm)</b>	<b>Ratio</b>
<10	N/A
10-20	1:1
21-35	2:1
36-50	3:1
51-65	4:1
>65	5:1

To reduce the impact of the removal of mature trees to the urban tree canopy, compensation trees will be 60mm DBH, unless otherwise approved by the Town.

<b>Key</b>	<b>Species</b>	<b>DBH</b>	<b>Health</b>	<b>Owner</b>	<b>Compensation</b>	<b>Totals</b>
		(cm)	G/F/P			
801	Scots Pine	30	Fair-Good	Subject Site	2:1	2
802	Scots Pine	28	Fair	Subject Site	2:1	2
803	Scots Pine	30	Fair	Subject Site	2:1	2
804	Scots Pine	23	Poor-Fair	Subject Site	2:1	2
807	Scots Pine	24	Fair	Subject Site	2:1	2
808	Scots Pine	22	Fair	Subject Site	2:1	2
809	Scots Pine	29	Fair	Subject Site	2:1	2
810	Scots Pine	26	Fair	Subject Site	2:1	2
811	Scots Pine	15	Fair-Poor	Subject Site	1:1	1
812	Scots Pine	28	Fair-Poor	Subject Site	2:1	2
813	Scots Pine	26	Fair	Subject Site	2:1	2
814	Scots Pine	28	Fair	Subject Site	2:1	2
815	Scots Pine	26	Fair	Subject Site	2:1	2
816	Scots Pine	19	Fair	Subject Site	1:1	1
817	Scots Pine	26	Fair	Subject Site	2:1	2
818	Scots Pine	32	Fair	Subject Site	2:1	2
820	Scots Pine	15	Fair	Subject Site	1:1	1
821	Scots Pine	22	Poor-Fair	Subject Site	2:1	2
826	Scots Pine	31	Fair	Subject Site	2:1	2
827	Scots Pine	22	Fair	Subject Site	2:1	2
828	Scots Pine	29	Fair	Subject Site	2:1	2
829	Scots Pine	24	Fair	Subject Site	2:1	2
830	Scots Pine	23	Fair	Subject Site	2:1	2
831	Scots Pine	25	Fair	Subject Site	2:1	2
832	Scots Pine	29	Fair	Subject Site	2:1	2
833	Scots Pine	27	Fair	Subject Site	2:1	2
834	Scots Pine	22	Fair	Subject Site	2:1	2
835	Scots Pine	14	Poor	Subject Site	1:1	1

**STRYBOS BARRON KING LTD.****Arborist Report**

Argo Mayfield West V – Town of Caledon

Key	Species	DBH (cm)	Health G/F/P	Owner	Compensation	Totals
837	Scots Pine	30	Fair-Good	Subject Site	2:1	2
838	Scots Pine	13	Fair	Subject Site	1:1	1
839	Scots Pine	31	Fair	Subject Site	2:1	2
840	Scots Pine	30	Fair	Subject Site	2:1	2
843	White Spruce	43	Good	Subject Site	3:1	3
844	White Spruce	18-21	Fair	Subject Site	2:1	2
845	Scots Pine	22	Poor	Subject Site	2:1	2
846	Manitoba Maple	13	Poor	Subject Site	1:1	1
847	White Spruce	33	Fair-Good	Subject Site	2:1	2
848	White Spruce	29	Poor	Subject Site	2:1	2
849	White Spruce	36	Fair	Subject Site	3:1	3
850	Juniper	14	Good	Subject Site	1:1	1
852	White Spruce	30	Fair	Subject Site	2:1	2
854	White Spruce	30	Fair	Subject Site	2:1	2
856	Bur Oak	105	Good	Subject Site	5:1	5
857	White Spruce	40	Fair-Good	Subject Site	3:1	3
859	White Spruce	19	Poor	Subject Site	1:1	1
860	White Spruce	28	Fair-Good	Subject Site	2:1	2
861	White Spruce	27	Fair	Subject Site	2:1	2
862	White Spruce	38	Fair-Good	Subject Site	3:1	3
864	White Spruce	34	Fair	Subject Site	2:1	2
865	White Spruce	41	Fair	Subject Site	3:1	3
868	Mulberry	21	Fair-Poor	Subject Site	2:1	2
869	Black Walnut	10	Fair-Poor	Subject Site	1:1	1
870	Mulberry	28	Fair	Subject Site	2:1	2
871	Emerald Cedar	3-19	Good	Subject Site	1:1	1
872	Bur Oak	113	Poor-Fair	Subject Site	5:1	5
873	Bur Oak	88	Fair	Subject Site	5:1	5
874	Bur Oak	80	Fair	Subject Site	5:1	5
875	Bur Oak	99	Fair	Subject Site	5:1	5
876	Colorado Blue Spruce	22	Good	Subject Site	2:1	2
877	Colorado Blue Spruce	29	Good	Subject Site	2:1	2
878	Colorado Blue Spruce	25	Good	Subject Site	2:1	2
879	Colorado Blue Spruce	39	Good	Subject Site	3:1	3
880	Colorado Blue Spruce	24	Good	Subject Site	2:1	2
881	Colorado Blue Spruce	31	Good	Subject Site	2:1	2
882	Colorado Blue Spruce	28	Good	Subject Site	2:1	2
883	Colorado Blue Spruce	38	Poor	Subject Site	3:1	3
884	Colorado Blue Spruce	32	Good	Subject Site	2:1	2
885	Colorado Blue Spruce	52	Good	Subject Site	4:1	4
886	Colorado Blue Spruce	27	Good	Subject Site	2:1	2
887	Colorado Blue Spruce	29	Good	Subject Site	2:1	2
888	Colorado Blue Spruce	44	Good	Subject Site	3:1	3
889	Shag Bark Hickory	76	Poor	Subject Site	5:1	5
890	Chokecherry	8-14	Fair-Good	Subject Site	1:1	1

**STRYBOS BARRON KING LTD.****Arborist Report**

Argo Mayfield West V – Town of Caledon

Key	Species	DBH (cm)	Health G/F/P	Owner	Compensation	Totals
891	Shag Bark Hickory	51	Fair	Subject Site	4:1	4
892	Bur Oak	111	Fair	Subject Site	5:1	5
894	Bur Oak	77	Fair	Subject Site	5:1	5
895	White Oak	47	Fair-Good	Boundary	3:1	3
896	American Elm	14,20	Fair	Subject Site	2:1	2
898	Bur Oak	41	Poor-Fair	Subject Site	3:1	3
901	American Elm	17-24	Poor-Fair	Subject Site	2:1	2
903	Bur Oak	78	Poor-Fair	Subject Site	5:1	5
904	Bur Oak	67	Fair	Boundary	5:1	5
905	American Elm	46	Fair-Poor	Subject Site	3:1	3
907	Bur Oak	21	Fair-Good	Subject Site	2:1	2
909	Bur Oak	109	Good	Subject Site	5:1	5
910	Shag Bark Hickory	17	Fair	Subject Site	1:1	1
911	Shag Bark Hickory	15	Fair	Subject Site	1:1	1
912	Malus Species	10-18	Poor-Fair	Subject Site	1:1	1
916	Manitoba Maple	21	Poor	Subject Site	2:1	2
917	Manitoba Maple	23	Poor	Subject Site	2:1	2
918	Mulberry	47	Poor	Subject Site	3:1	3
919	Juniper	26	Fair	Subject Site	2:1	2
920	Black Walnut	26	Poor-Fair	Subject Site	2:1	2
921	Colorado Blue Spruce	32	Good	Subject Site	2:1	2
922	Bur Oak	16	Good	Subject Site	1:1	1
923	Colorado Blue Spruce	43	Fair-Good	Subject Site	3:1	3
924	Austrian Pine	14,15	Fair	Subject Site	1:1	1
925	Honey Locust	45	Poor-Fair	Subject Site	3:1	3
926	Mulberry	11	Fair	Subject Site	1:1	1
927	Mulberry	20,20,25	Poor	Subject Site	2:1	2
928	Columnar Oak	52	Good	Subject Site	4:1	4
929	Austrian Pine	12,17,36	Poor	Subject Site	3:1	3
931	Colorado Blue Spruce	18	Poor	Subject Site	1:1	1

Based on the Tree Removal Compensation Ratio above, **two hundred, forty-two (242)** trees are required for compensation.

**Tree Protection Measures**

Pending final grading and servicing requirements, there are currently no tree protection measures required; however, the Town of Caledon approved tree protection hoarding is included in the appendices for reference.

**Pre-Construction**

- Although tree protection measures are not required, ESC fencing as per the approved Civil plans will need to be installed prior to internal site tree removals.

## **Conclusion**

Strybos Barron King Ltd. was retained by Argo Mayfield West V, c/o Argo Development Corporation, to prepare and Arborist Report for the subject property in accordance with the Town of Caledon requirements.

The subject site is mainly composed of working horse farm including residential and farm buildings and structures as well as horse tracks and fields. The majority of the semi-mature to mature trees occur as coniferous hedgerows and remnant windrows along the north and part of the southern property boundary as well as individual trees situated around the existing residential dwelling.

Upon review of the proposed Draft Plan, anticipated grading and servicing requirements, and development connections on adjacent properties, it was determined that all trees internal to the subject site will require removal. A total of one hundred three (103) trees, subject to the Private Tree Bylaw, require removal. Based on the Town's compensation guidelines two hundred forty-two (242) trees will be required. Compensation trees shall be planted in accordance with the Town of Caledon's standard planting details.

**Prepared By:**  
**STRYBOS BARRON KING LTD.**

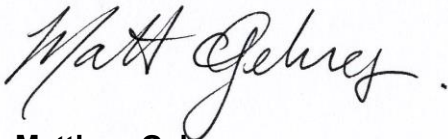

**Matthew Gehres**  
*ISA Certified Arborist ISA ON-1114A*  
*Senior Landscape Technologist*

**APPENDIX A – CONCEPTUAL DRAFT PLAN**

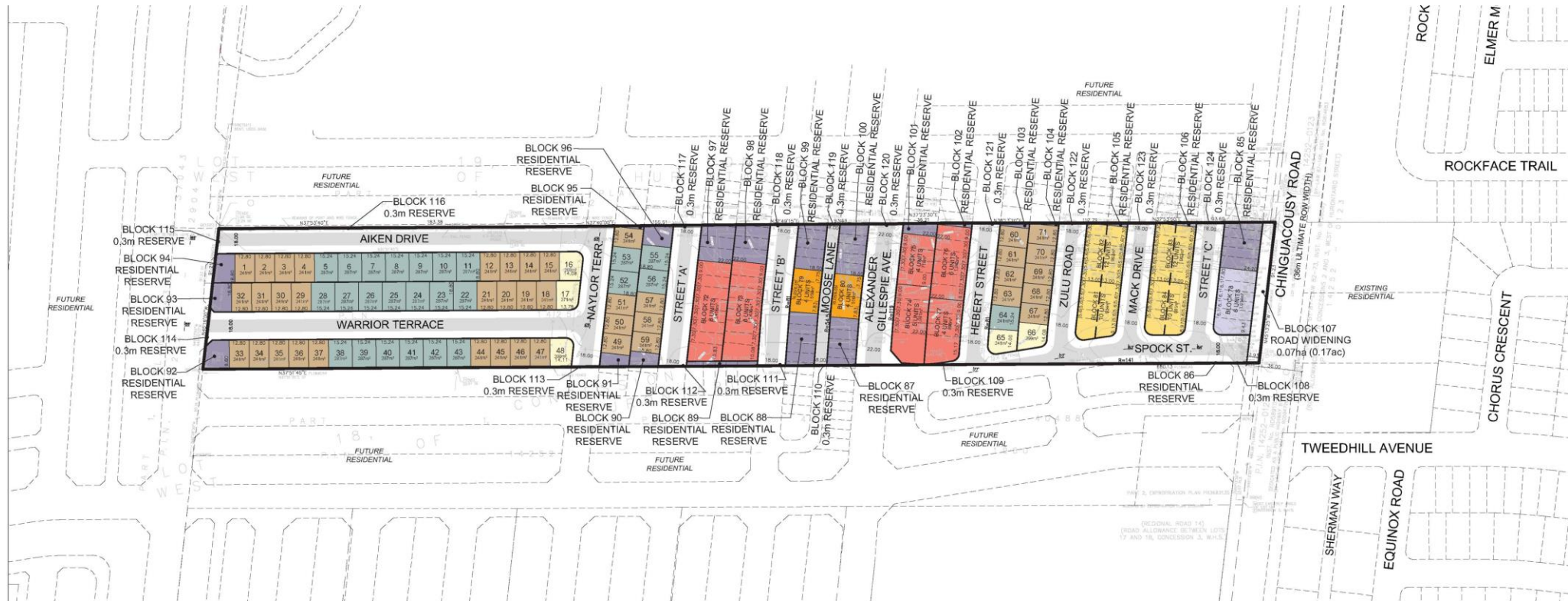

**APPENDIX B – CONTEXTUAL TREE INVENTORY AND PRESERVATION PLAN**

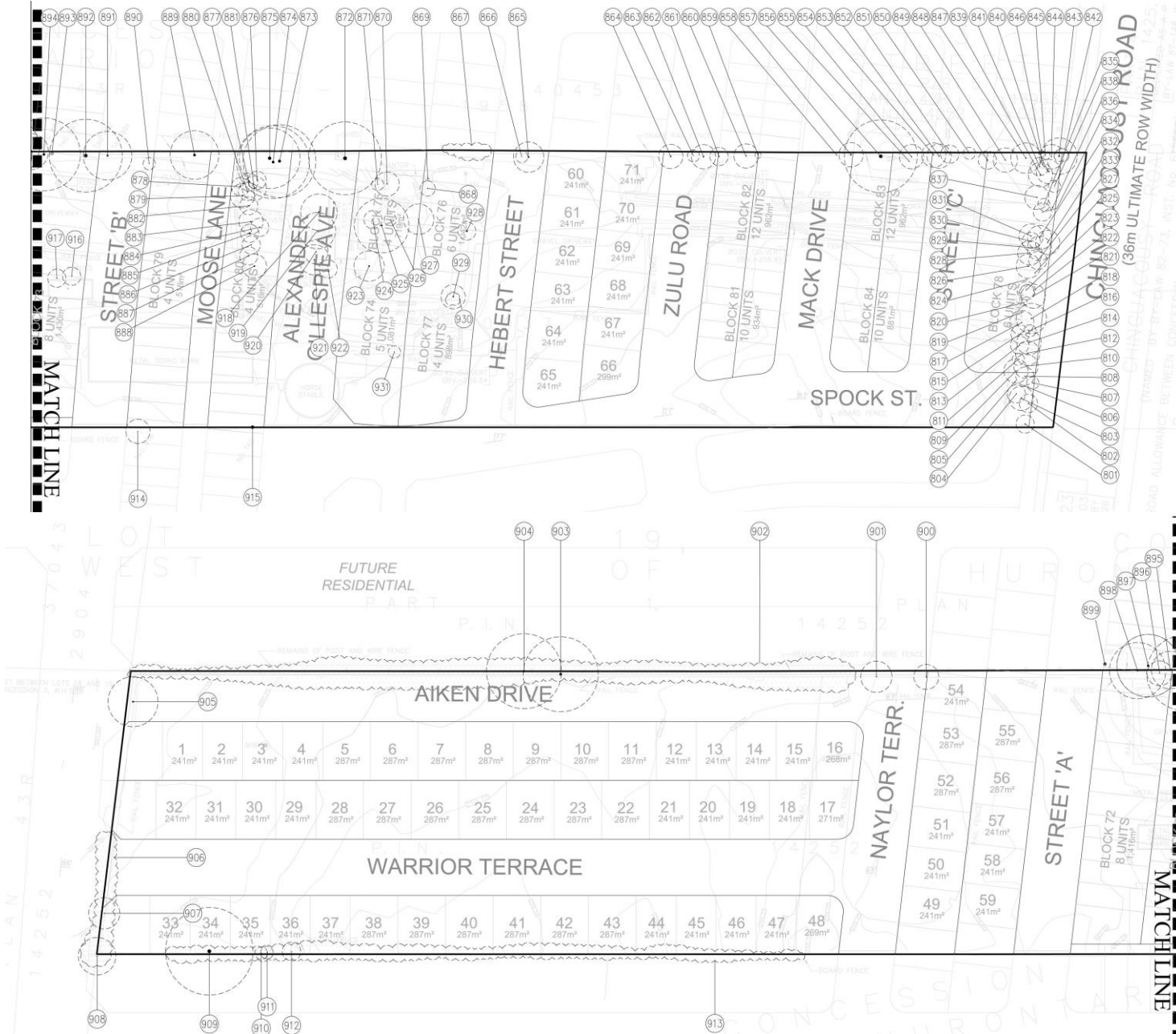

**Appendix C – SITE PHOTOGRAPHS**



Trees #801-806



Trees # 805-833



Trees #824-833



Trees #834-846



Trees #854-858



Trees #859-864



Trees #865-867



Trees #868 & 869



Tree #872



Trees #873-875



Trees #876-888



Trees #891 & 892





Trees #893-898



Tree #900



Tree #901



Trees #903 & 904



Tree #905



Trees #906 & 907



Tree #908



Tree #909



Trees #910, 911 & 913



Tree #914



Trees #916 & 917



Trees #918-921



Trees #921 & 922



Tree #923



Trees #924-926



Trees #927 & 928



Trees #929 & 930



Tree #931

**Appendix D – TREE PROTECTION HOARDING**

TREE PROTECTION FENCING TO BE ERECTED AS INDICATED ON THE LANDSCAPE PLAN AND SHALL REMAIN INTACT UNTIL DIRECTED BY TOWN STAFF.

STANDARD 1200mm HIGH SNOW FENCE SECURED TO T-BAR STAKES AT MIN. 2400mm O.C.

FINISHED GRADE

UNDISTURBED SOIL

SPECIFICATIONS FOR THE PROTECTION AND PRESERVATION OF EXISTING VEGETATION:

1. PRIOR TO ISSUANCE OF THE GRADING AND SERVICING OR BUILDING PERMIT, ALL EXISTING TREES THAT ARE TO BE PRESERVED SHALL BE FULLY PROTECTED WITH HOARDING (IE SNOW FENCING) OUTSIDE THEIR DRIPLINES, OR AS DIRECTED THROUGH ADDITIONAL GOVERNING DOCUMENTS, TO THE SATISFACTION OF THE TOWN.
2. GROUPS OF TREES AND OTHER EXISTING PLANTINGS TO BE PROTECTED SHALL BE TREATED IN A LIKE MANNER WITH HOARDING AROUND THE ENTIRE CLUMP(S).
3. TREE PRESERVATION FENCE IS TO BE INSPECTED BY THE CONSULTING ARBORIST OR LANDSCAPE ARCHITECT AND APPROVED BY THE TOWN PRIOR TO CONSTRUCTION COMMENCING.
4. SILTATION CONTROL FENCING MAY BE USED AS A TREE PRESERVATION FENCING SUBSTITUTE IF REQUIRED BY ENGINEERING AT THE DISCRETION OF THE TOWN.
5. AREAS WITHIN PROTECTIVE FENCING SHALL REMAIN UNDISTURBED AND SHALL NOT BE USED FOR THE STORAGE OF BUILDING MATERIALS OR EQUIPMENT. NO CONTAMINANTS SHALL BE DUMPED OR FLUSHED WHERE FEEDER ROOTS OF TREES EXIST. NO GARBAGE OR BUILDING MATERIALS ARE TO BE PLACED ON OR AGAINST THE TREE PRESERVATION FENCE.
6. PRUNE BRANCHES TO REMOVE DAMAGED LIMBS ONLY. DO NOT DAMAGE LEADERS. ALL CUTS OVER 25mm SHALL BE TREATED IN ACCORDANCE WITH APPROPRIATE HORTICULTURAL PRACTICES AS APPROVED BY THE TOWN. NO MORE THAN 20% OF THE TREE SHALL BE PRUNED UNLESS DIRECTED BY THE TOWN.
7. CUTTING OF ROOTS OR CHANGING OF GRADES AROUND EXISTING TREES TO BE PRESERVED WILL NOT BE PERMITTED WITHOUT THE APPROVAL OF THE PUBLIC WORKS AND ENGINEERING DEPARTMENT.
8. IF TREES ARE BEING ADVERSELY AFFECTED BY CONSTRUCTION, A WATERING AND FERTILIZING PROGRAM IS TO BE SET UP TO THE SATISFACTION OF THE TOWN.
9. PRIOR TO FINAL APPROVAL TREES THAT HAVE DIED OR HAVE BEEN DAMAGED BEYOND REPAIR PRIOR DURING OR POST CONSTRUCTION SHALL BE REMOVED AND REPLACED WITH TREES OF A SIZE AND SPECIES APPROVED BY THE TOWN, AT THE SOLE COST OF THE DEVELOPER.

<b>TOWN OF CALEDON</b>					
<b>TREE PRESERVATION</b>	3	STANDARD 707 NOV 606	JAN 18	APR'D: C.C.	DATE: JUNE 08
	2	STANDARD No. 1135 NOV 707, NOTES EDIT	JUNE 08	DRAWN: abal	SCALE: NTS
	1	NOTE NO. 9 ADDED	MARCH 08		
	NO.	REVISION	APR'D	DATE	<b>STANDARD No. 606</b>

**SPECIFICATIONS**

**A. General**

The following Tree Preservation and Protection Measures will be undertaken to help eliminate and/or significantly reduce construction injury to all trees recommended for preservation. All temporary tree protection measures cited for retained trees must comply with the Town of Caledon Tree Protection Specifications and Details. Any variation from the standard tree protection measures must be approved in writing by the Town of Caledon.

**B. Pre-Construction Phase**

1. Prior to construction, the trees to be preserved shall be protected with a Tree Protection Barrier. The barrier shall consist of 1.2m (4ft) high orange plastic snow fence wired to T-bars (see Town of Caledon Tree Preservation Fencing, STD 606).
2. If applicable, attach a filter cloth 600mm high to the construction side of the hoarding to act as sediment control. Sediment control fencing shall meet or exceed OPSD-219.110, and be installed to the satisfaction of the Town of Caledon.
3. All supports and bracing used to safely secure the barrier should be located outside the Tree Protection Zone (TPZ). All supports and bracing should minimize damage to roots.
4. The TPZ fence is to be installed along the edge of the tree protection zones. This hoarding is to remain in place and remain in good condition throughout the entire duration of the project. Dismantling the tree protection barrier prior to approval by the Town of Caledon staff may constitute a contravention.
5. The applicant shall notify the Town of Caledon and the consulting certified arborist or landscape architect to confirm that the tree protection barriers are in place.

6. Where fill or excavated material must be temporarily located near a TPZ, a wooden barrier must be used to ensure no material enters the TPZ.
7. Remove any garbage and foreign debris from the tree protection zones, daily.
8. For the trees that were recommended for removal and/or crown pruning that are within the TPZ limits, these activities are to be performed by a qualified ISA certified arborist prior to the installation of the Tree Protection Zone barriers and prior to the commencement of any construction activities. Install the Tree Protection Zone barrier as per Tree Preservation Fencing, STD 606 at the limits shown on the tree inventory and protection plan after the tree removal, whichever is greater, and crown pruning activities are completed.
9. A **Tree Protection Zone** sign must be mounted on all sides of the tree protection barrier for the duration of site construction. The sign should be a minimum of 40cm x 60cm and made of white gator board or equivalent material.
10. The sign must be similar to the illustration shown below, or as directed by the Town of Caledon.

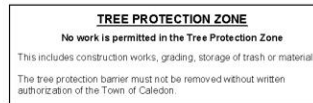

11. All contractors and site visitors should be informed of the tree preservation and protection measures at a pre-construction meeting.

specifications continued on next panel...

TOWN OF CALEDON					APR'D: B.B.	DATE: AUGUST 17
TREE PRESERVATION STANDARD NOTES - PART 1					DRAWN: B.M.	SCALE: NTS
	NO.	REVISION	APR'D	DATE	STANDARD No. 710	

**SPECIFICATIONS** continued from previous panel

**C. During Construction Phase**

1. All areas within the TPZ shall remain undisturbed for the duration of construction. There will be no grade changes, dumping, and storage of any materials, structures or equipment within these areas. The Tree Protection Barrier must not be removed without the written authorization of the Town of Caledon.
2. Minor grading works will be permitted at the edge of the preservation zone as required to correct localized depressions, and blend to existing grades. This work to be undertaken under the direct supervision of an ISA certified arborist.
3. A certified ISA arborist will undertake proper root pruning in accordance with acceptable arboriculture practices when and if roots of retained trees are to be exposed, damaged, or severed by construction work. The exposed roots will be backfilled with appropriate material as soon as possible to prevent desiccation. Root pruning prior to excavation will help prevent necessary damage to tree roots. The use of low pressure hydrovac to expose roots is recommended, at no additional cost.
4. The Town of Caledon must be notified for all work that impacts the TPZ for temporary removal of a section of hoarding to gain access for fine grading or other works. All works are to be supervised by the Town of Caledon.
5. No cables, wire or ropes of any kind shall be wrapped around or installed in trees to be preserved.
6. No contaminants will be dumped or flushed in the TPZ areas or where feeder roots of trees exist (generally beyond the TPZ areas).
7. Irrigate tree protection zones during drought conditions, June to September to reduce drought stress.
8. Inspect the site daily to ensure hoarding is in place and in good condition. Inspect trees to monitor condition.

**D. Post Construction Phase**

1. Following the completion of all site works including landscaping, and after review and approval by the Town of Caledon staff, the protective hoarding may be removed.
2. After removal of the protective hoarding, the Tree Preservation Zones shall be inspected by the Town of Caledon staff. Any remaining dead, diseased, or hazardous limbs or trees are to be removed by an ISA certified arborist as directed by the consulting arborist or Town of Caledon staff.

end of specifications

TOWN OF CALEDON				APPR'D: B.B.	DATE: AUGUST 17
TREE PRESERVATION STANDARD NOTES - PART 2				DRAWN: B.M.	SCALE: NTS
				STANDARD No. 711	
NO.	REVISION	APR'D	DATE		