

STORAGE TABLE – SURFACE STORAGE		
DESCRIPTION	PROVIDED STORAGE	REQUIRED STORAGE
SURFACE STORAGE MAX EL. 254.25	55.4 m ³	55.2 m ³

**SUBMISSION
DRAWING**
NOT TO BE USED FOR CONSTRUCTION

TOWN OF CALEDON
PLANNING
RECEIVED
October 8, 2024

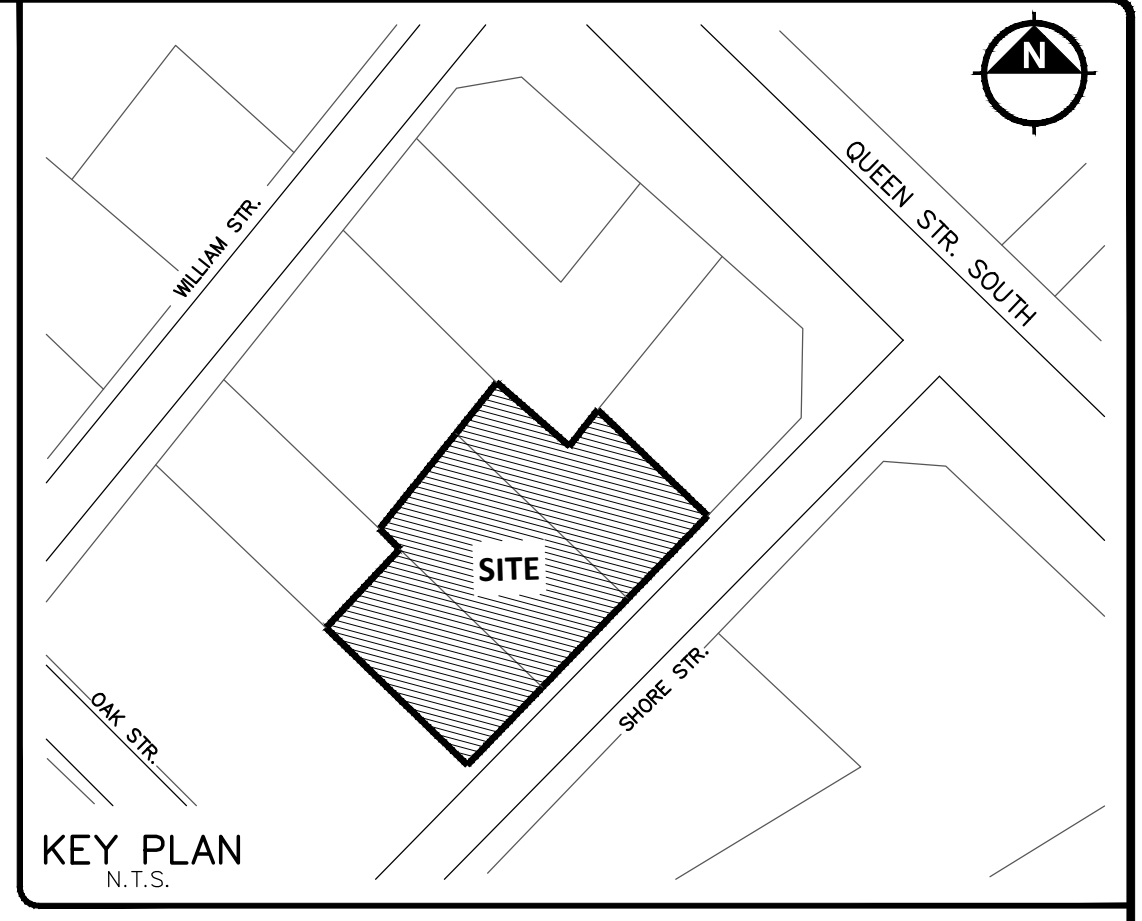

OAK STREET

REGIONAL ROAD #50
(HIGHWAY #50)

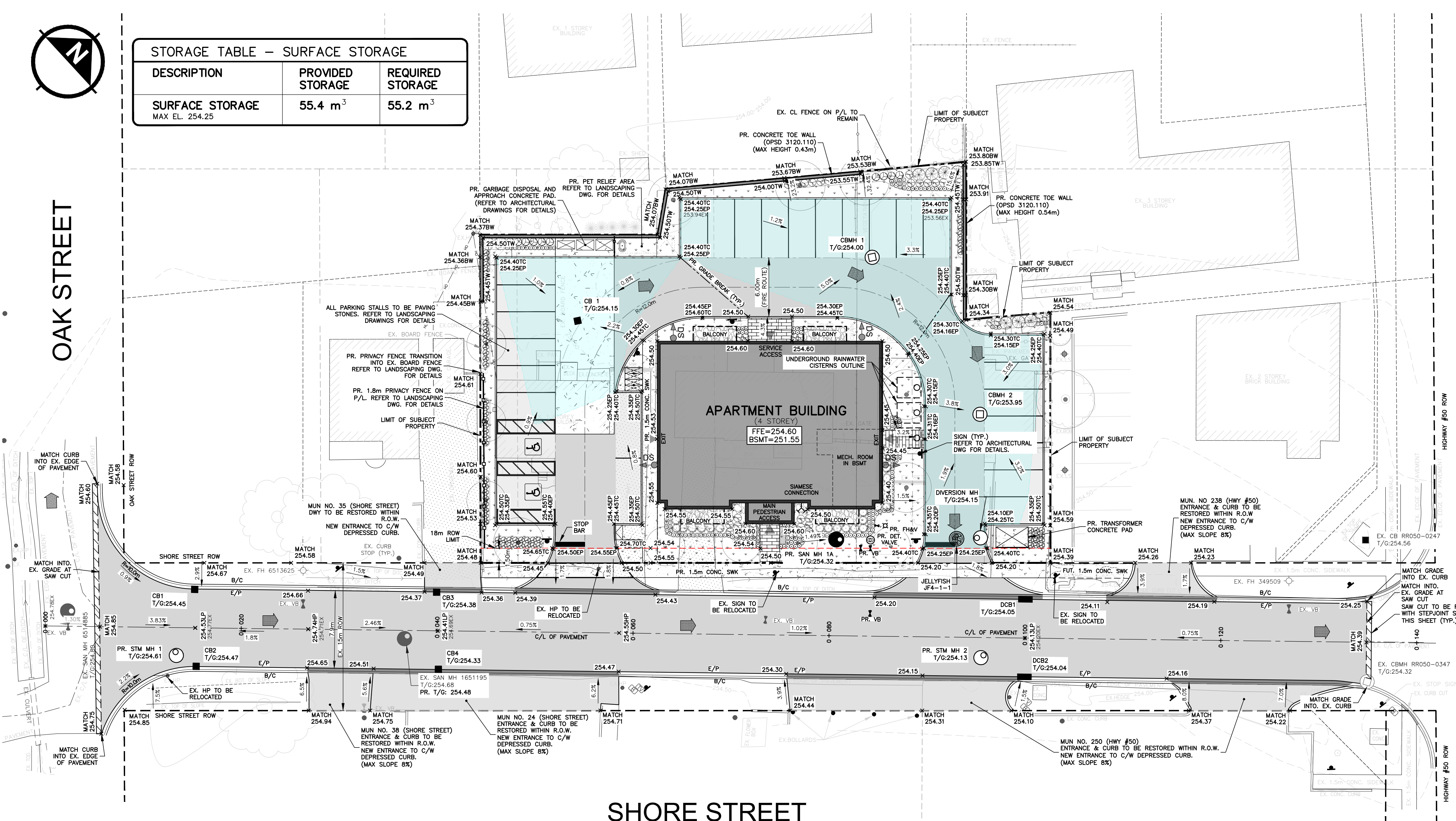

- KEY PLAN
N.T.S.
- LIMIT OF SUBJECT PROPERTY
 - - - ROAD WIDENING SET BACK / ULTIMATE PROPERTY LINE
 - ⊕ VALVE AND BOX
 - ⊕ HYDRANT
 - CATCH BASIN
 - CB
 - DOUBLE INLET CATCHBASIN
 - SANITARY MANHOLE
 - STORM MANHOLE
 - CATCH BASIN MANHOLE
 - DETECTOR CHECK VALVE IN CHAMBER
 - CONCRETE WALKWAY
 - LANDSCAPED AREAS
 - DS
 - DOWNSPOUT (C/W OVERFLOW VALVE)
 - - - GRADE BREAK
 - MAJOR OVERLAND FLOW
 - ▲ TRAFFIC SIGN (REFER TO ARCHITECTURAL DWG FOR DETAILS)
 - MAX. SURFACE STORAGE PONDING EXTENTS (ELEV. 254.25)

SHORE STREET

SHORE STREET TO BE URBANIZED AS PER TOWN STD DWG 202
GRADING TO BE CONFIRMED DURING DETAILED DESIGN

- GRADING NOTES:**
- WITHIN SUBJECT PROPERTY LIMITS BARRIER CURB TO OPSS 600.110
 - CURB AND GUTTER WITHIN SHORE STREET RIGHT-OF-WAY TO BE OPSS 600.040
 - PARKING STALLS TO BE PAVING STONES. REFER TO LANDSCAPING DRAWINGS FOR DETAILS
 - TOP OF CURB ELEVATIONS 0.15m ABOVE EDGE OF PAVEMENT ELEVATIONS SHOWN
 - ALL BOULEVARDS WITHIN SHORE STREET R.O.W TO BE REGRADED TO NEW BACK OF CURB WITH 300mm OF TOPSOIL AND NURSERY SOD.

- SERVICING NOTE:**
- ALL ROOF DRAINS TO CONNECT TO UNDERGROUND INFILTRATION FACILITY SHOWN

- GENERAL NOTES:**
- THIS DRAWING TO BE READ IN CONJUNCTION WITH THE APPROVED ARCHITECTURAL AND LANDSCAPE PLANS.
 - THE LOCATION OF ALL UNDERGROUND AND ABOVEGROUND UTILITIES AND STRUCTURES IS NOT NECESSARILY SHOWN ON ENGINEERING DRAWINGS, AND WHERE SHOWN THE ACCURACY OF THE LOCATION AND ELEVATION OF SUCH UTILITIES AND STRUCTURES IS NOT GUARANTEED. PRIOR TO COMMENCING CONSTRUCTION, THE CONTRACTOR SHALL VERIFY EXACT LOCATION AND ELEVATION OF SUCH UTILITIES AND STRUCTURES AND SHALL ASSUME ALL LIABILITIES OF DAMAGE.
 - ALL DIMENSIONS SHALL BE CHECKED AND VERIFIED IN THE FIELD BY THE CONTRACTOR PRIOR TO CONSTRUCTION AND ANY DISCREPANCIES SHALL BE REPORTED IMMEDIATELY TO THE ENGINEER. DETAILS ARE NOT TO BE SCALED FROM THE DRAWINGS.
 - THE WORK AREA SHALL BE ISOLATED FROM PUBLIC ACCESS AT ALL TIMES. OPEN EXCAVATIONS SHALL BE BACKFILLED OR PLATED AT THE END OF EACH WORK DAY. ALL CONSTRUCTION WORKS SHALL BE CARRIED OUT IN ACCORDANCE WITH THE REQUIREMENTS OF THE OCCUPATIONAL HEALTH AND SAFETY ACT AND REGULATIONS FOR CONSTRUCTION PROJECTS.

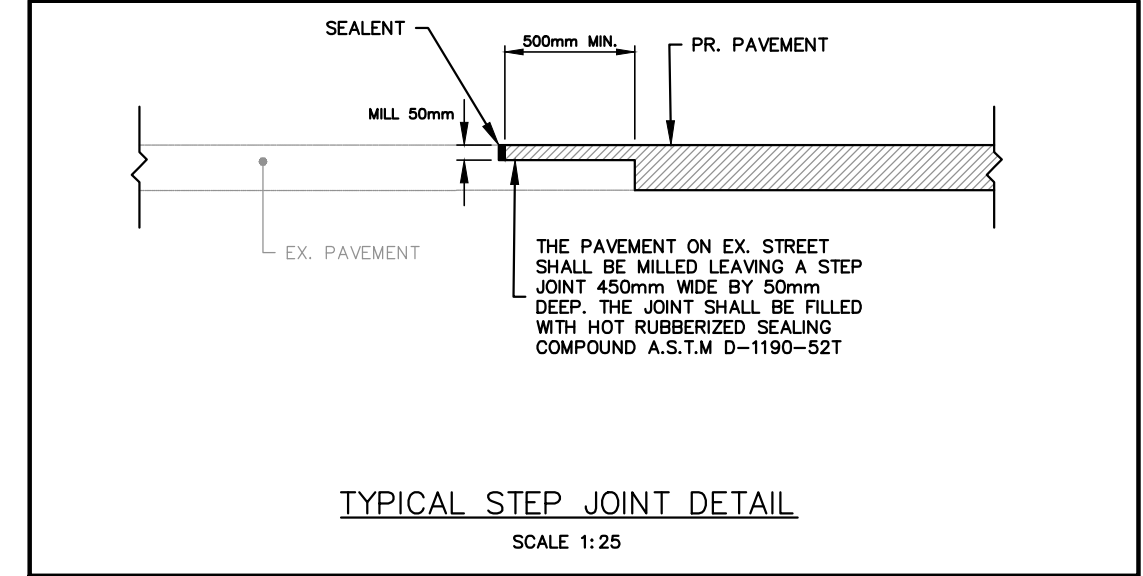

SUBMISSION HISTORY

No.	ISSUED FOR	DATE
1	ISSUED FOR FIRST SUBMISSION	24/09/24

REVISIONS

No.	DESCRIPTION	BY	DATE
-----	-------------	----	------

BENCHMARK NOTE:
ELEVATIONS SHOWN ARE RELATED TO GEODETIC DATUM AND ARE DERIVED FROM TOWN OF CALEDON BENCH MARK NO. 758057 HAVING A PUBLISHED ELEVATION OF 251.920m.

SURVEY COMPLETED BY:
GUIDO PAPA SURVEYING
9135 KEELE STREET, UNIT B7
VAUGHAN, ONTARIO
L4K 5J4

GUIDO PAPA REF. NO. 23-18-550-00
SURVEY COMPLETED ON:
AUGUST 11, 2023

CONSULTANT:
T. DUMYAN
100072175
SEP 23, 2024
PROVINCE OF ONTARIO

MUNICIPAL APPROVAL:
APPROVED AS TO FORM IN RELIANCE UPON THE PROFESSIONAL SKILL AND ABILITY OF URBANWORKS ENGINEERING CORP. AS TO DESIGN AND SPECIFICATION.

DIRECTOR OF DEVELOPMENT ENGINEERING
DAN TERZEVSKI

DATE:

1945 Dundas Street E., Unit 200, Mississauga, ON, L4X 2T8
general@urbanworkseng.com | www.urbanworkseng.com | 905-361-0224

**MULTI-UNIT RESIDENTIAL DEVELOPMENT
SHORE STREET URBANIZATION**
15,21,27 SHORE STREET, CALEDON

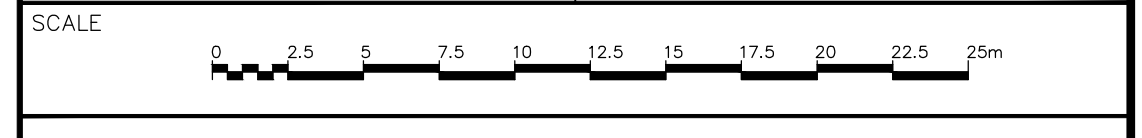

SITE GRADING PLAN

TOWN FILE: PRE-2023-0116 PRE-2023-0274	PROJECT No. 24-0002CA
DATE: SEP 24, 2024	DESIGNED BY: DV
SCALE: 1:250	DRAWN BY: DV
	CHECKED BY: TD

DWG. No.
SG-01

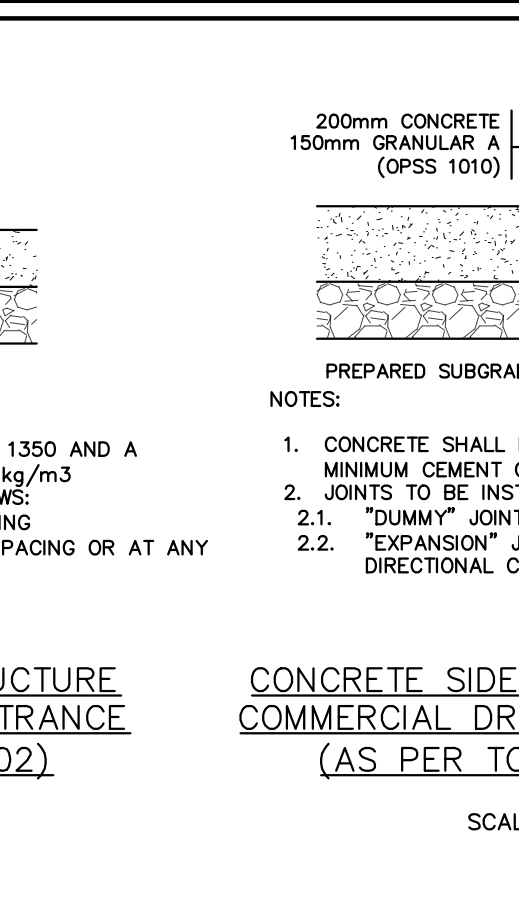
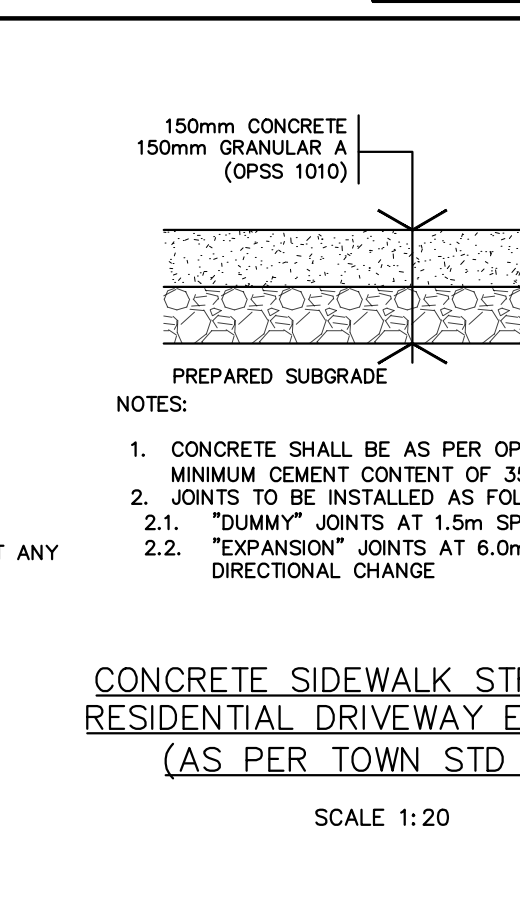
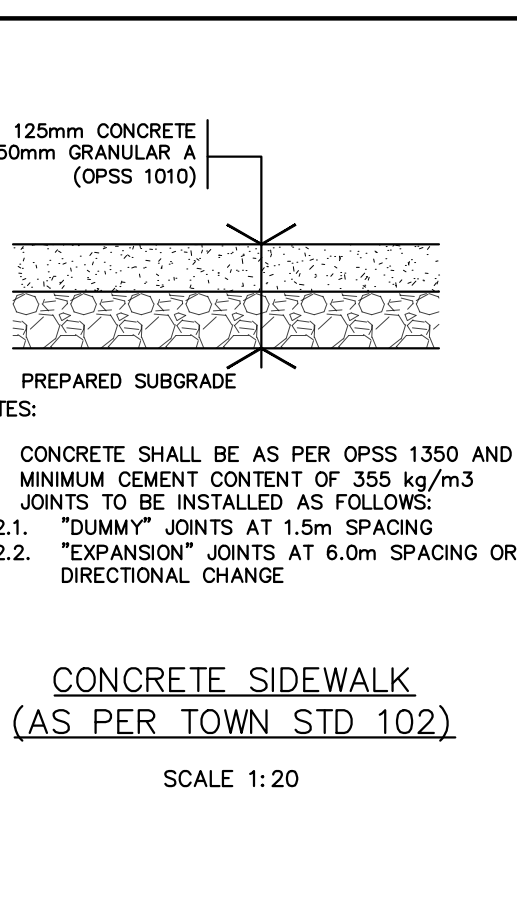
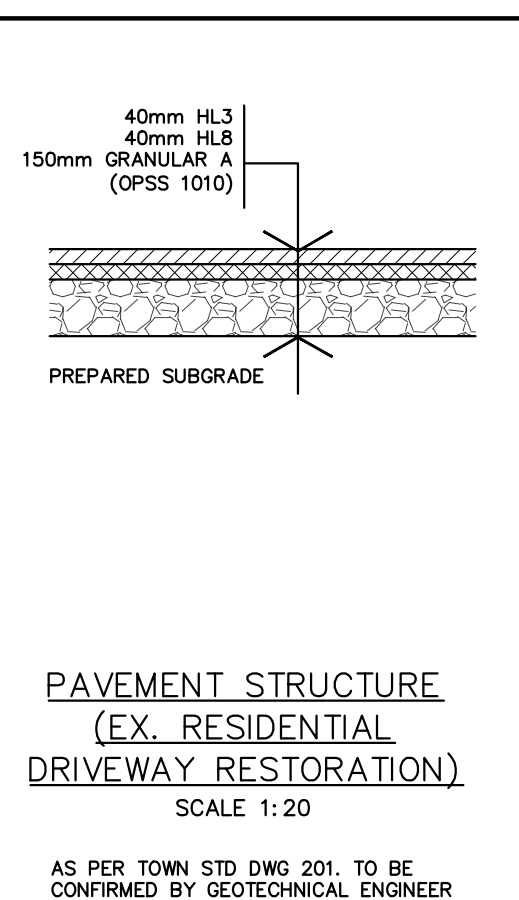
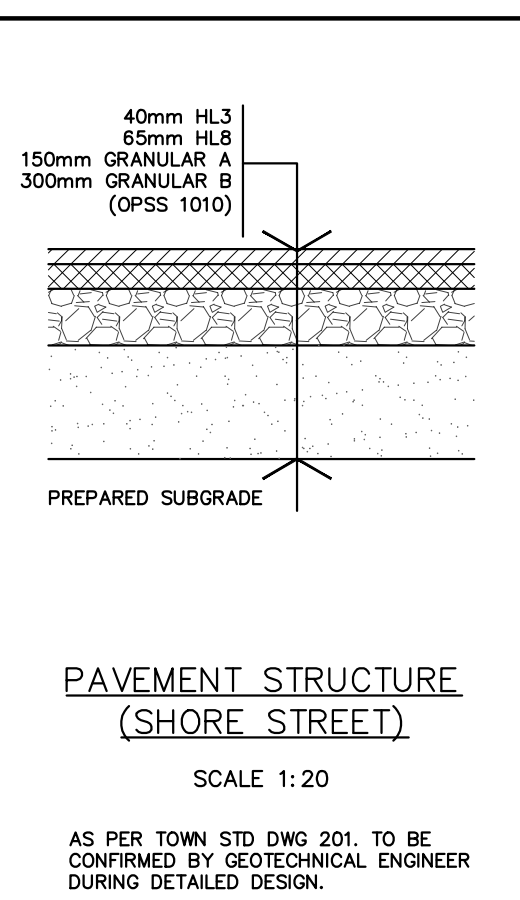
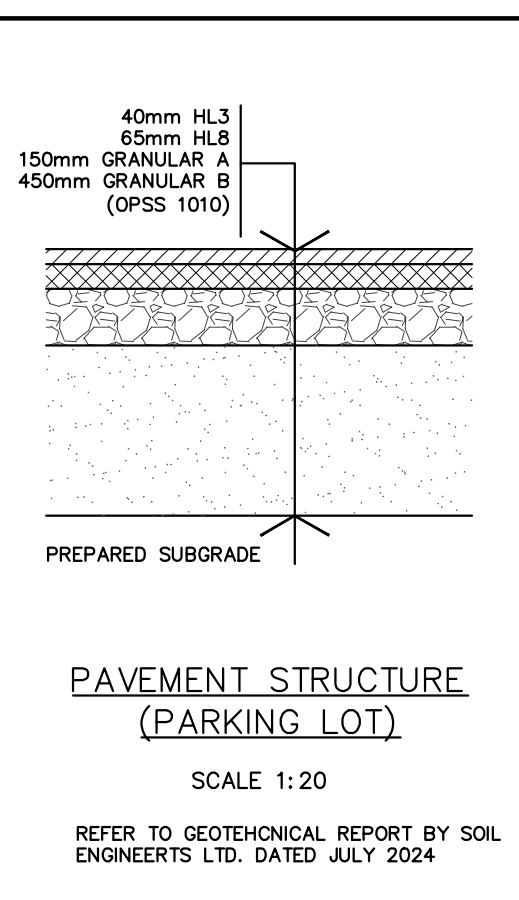
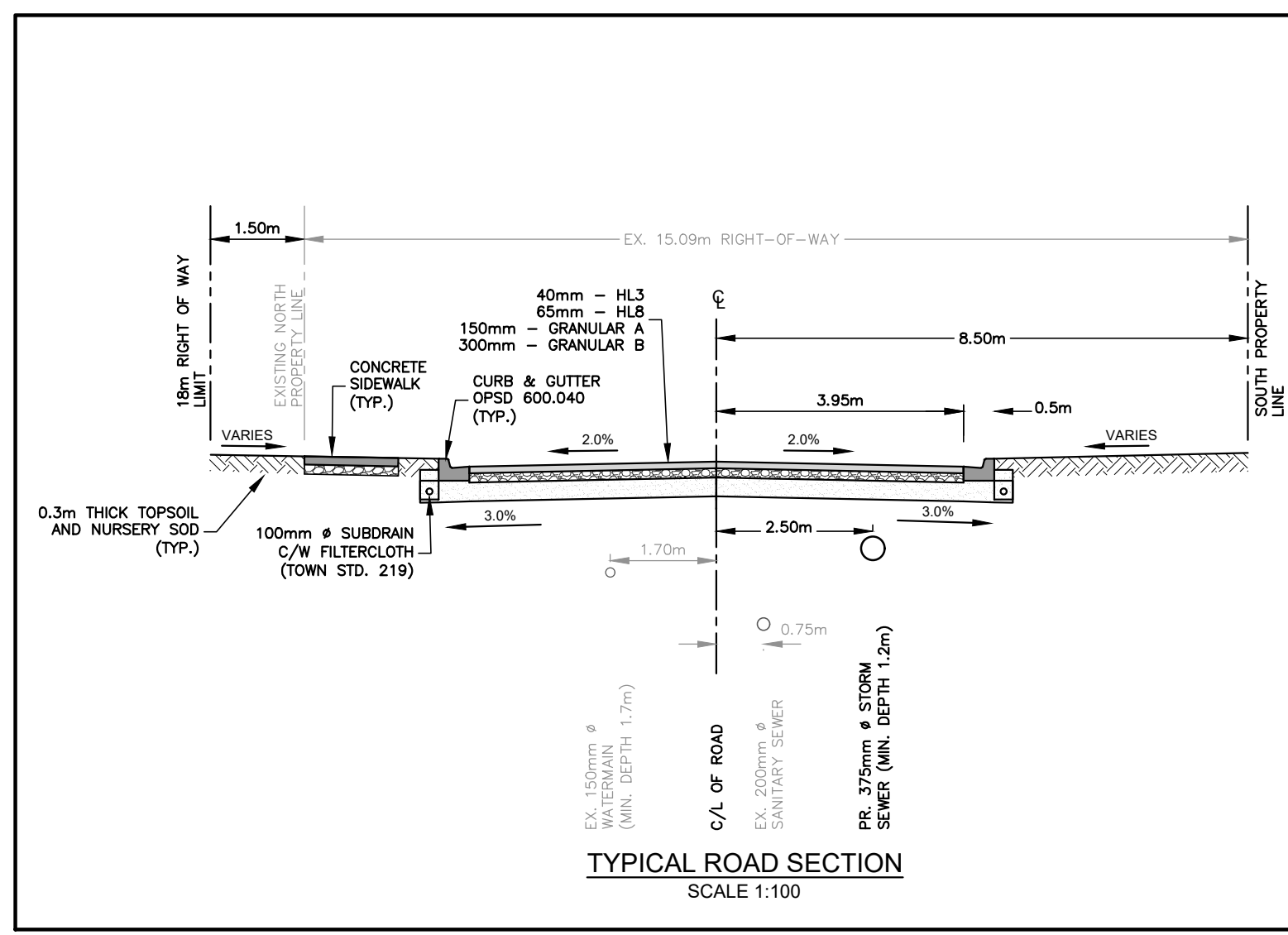

REFER TO GEOTECHNICAL REPORT BY SOIL ENGINEERS LTD. DATED JULY 2024

AS PER TOWN STD DWG 201, TO BE CONFIRMED BY GEOTECHNICAL ENGINEER DURING DETAILED DESIGN.

AS PER TOWN STD DWG 201, TO BE CONFIRMED BY GEOTECHNICAL ENGINEER DURING DETAILED DESIGN.

AS PER TOWN STD DWG 201, TO BE CONFIRMED BY GEOTECHNICAL ENGINEER DURING DETAILED DESIGN.

AS PER TOWN STD DWG 201, TO BE CONFIRMED BY GEOTECHNICAL ENGINEER DURING DETAILED DESIGN.

AS PER TOWN STD DWG 201, TO BE CONFIRMED BY GEOTECHNICAL ENGINEER DURING DETAILED DESIGN.

AS PER TOWN STD DWG 201, TO BE CONFIRMED BY GEOTECHNICAL ENGINEER DURING DETAILED DESIGN.