

COLUMBIA SQUARE

BOLTON, ONTARIO

© Copyright KFA Architects and Planners Inc., all rights reserved. No part of this document whether printed form or supplied as digital data may be reproduced, stored in a retrieval system or transmitted in any form or by any means, mechanical photocopying, recording or otherwise without the prior written permission of KFA Architects and Planners Inc. All dimensions to be checked on site by the contractor. Drawings are not to be scaled, any discrepancies are to be reported to the Architect before proceeding with the work.

No.	Description	Date
1	ISSUED FOR OPA	2023/12/15
16	ISSUED FOR OPA/ZBA	2024/03/25
19	ISSUED FOR REVIEW	2024/10/21
22	ISSUED FOR COORDINATION	2025/02/19

TOWN OF CALEDON  
PLANNING  
RECEIVED  
May 15th, 2025

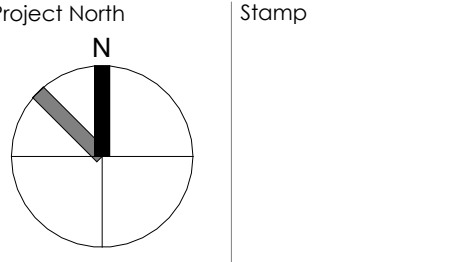
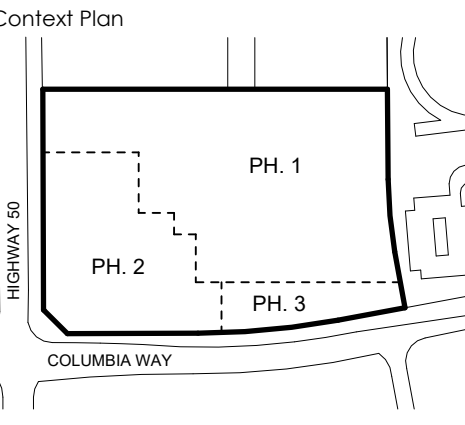

Clients  
**Columbia Square Inc.**

**KFA**  
architects + planners inc.  
197 SPADINA AVE. - SUITE 500  
TORONTO, ON M5T 2C5  
416.633.6286 - telephone  
www.kfaarchitecture.com

Project No.: 20065

Scale: As indicated

Issue Date: 07/24/2023

Drawn By:

Title

P2 LEVEL PLAN  
PHASES 1, 2, 3

No.

A101

PHASE 1  
PHASE 2

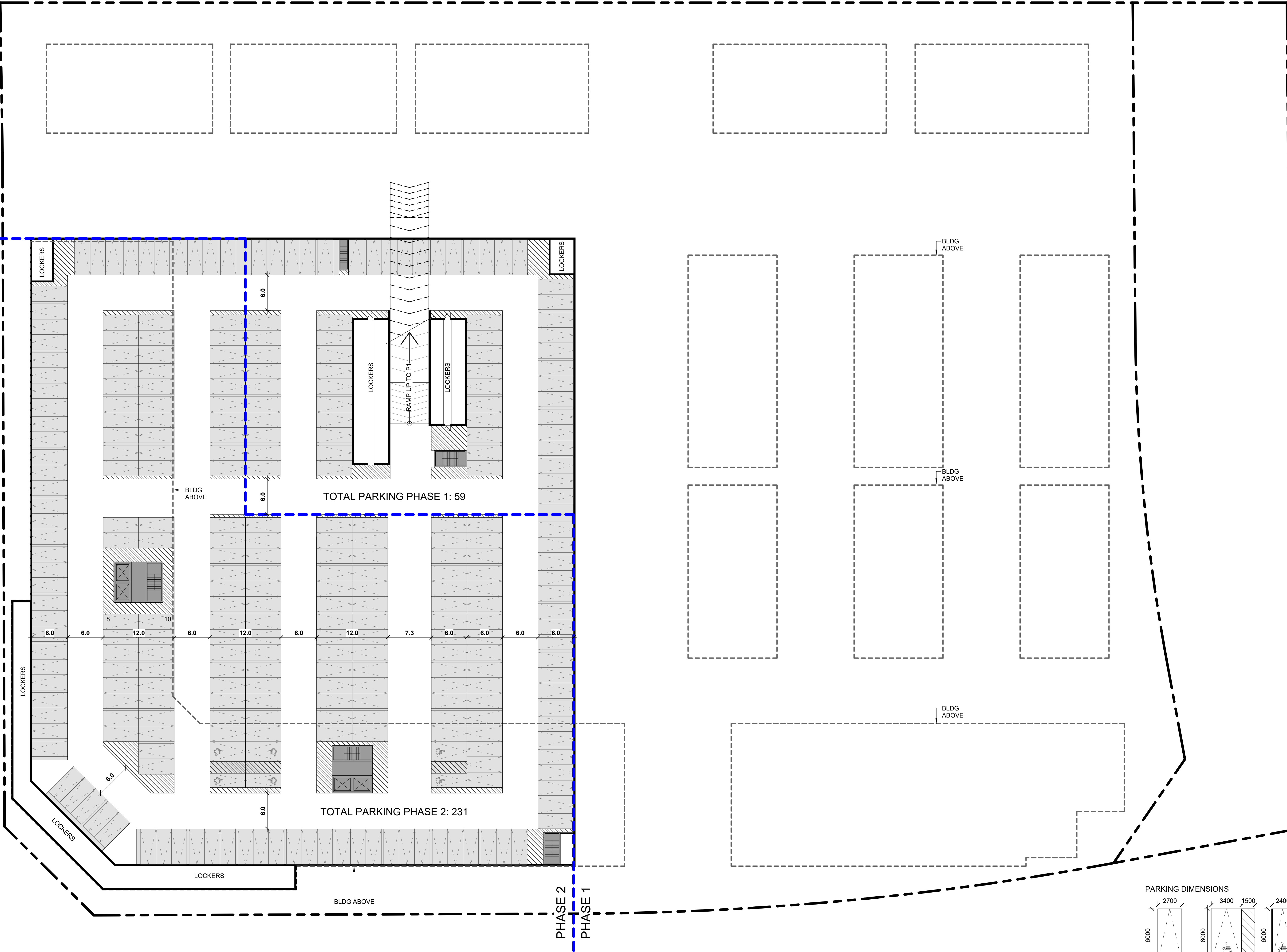

PARKING DIMENSIONS

