

Proposed Plant Material List

KEY	QTY	BOTANICAL NAME	COMMON NAME	HTCAL	SPREAD	ROOT	DRUGG/SLUGG	NATIVE	REMARKS
DECIDUOUS TREES									
AD	9	<i>Araliacae ornata</i>	Dwarf Serviceberry	60 mm		B&B	High	Yes	Tree Form
AB	16	<i>Acer rubrum 'Spectol'</i>	Blackish Red Maple	70 mm		B&B	High	Yes	Full Form
AF	1	<i>Acer 'Fraxino 'Jefferson'</i>	Jefferson Fraxino Maple	70 mm		B&B	High	Yes	Full Form
OS	6	<i>Castilleja bicolor 'Shademaster'</i>	Shademaster Honey-Locust	70 mm		B&B	High	Yes	Full Form
LT	10	<i>Liriodendron tulipifera</i>	Tulip Tree	70 mm	cream	B&B	High	Yes	Full Form
QA	2	<i>Quercus macrocarpa</i>	Bur Oak	70 mm		B&B	High	Yes	Full Form
CONIFEROUS TREES									
PS	6	<i>Pinus strobus</i>	White Pine	200 cm		B&B	High	Yes	Full Form
PR	9	<i>Pinus resinosa</i>	Red Pine	200 cm		B&B	High	Yes	Full Form
DECIDUOUS SHRUBS									
BC	3	<i>Buddleia 'Lo & Behold Blue Chip'</i>	Dwarf Butterfly Bush	50 cm		C.C.	High	Yes	Full Form
DF	65	<i>Cornus sericea 'Yarrow'</i>	Atis Tree Dogwood	60 cm		C.C.	High	Yes	Full Form
LC	23	<i>Liquidum vicari</i>	Golden Privet	60 cm		C.C.	High	Yes	Full Form
PO	40	<i>Physocarpus opulifolius 'Summer Wine'</i>	Summer Wine Ninebark	60 cm		C.C.	High	Yes	Dwarf - Purple leaf
SA	40	<i>Spiraea japonica 'Anthony Waterer'</i>	Anthony Waterer Spirea	60 cm		C.C.	High	Yes	Full Form
CONIFEROUS SHRUBS									
AB	19	<i>Abies balsamea 'Nano'</i>	Dwarf Balsam Fir	50 cm		C.C.	High	Yes	Full Form
TF	52	<i>Taxus canadensis 'Fairview'</i>	Fairview Yew	65 cm		C.C.	High	Yes	Full Form
SH	87	<i>Thuja occidentalis 'Hollis'</i>	Hollis's Yew	80 cm		C.C.	High	Yes	Full Form
TF	18	<i>Thuja occidentalis 'Tallitops'</i>	Pyramidal Cedar	180 cm		B&B	High	Yes	Full Form
PERENNIALS									
ED	9	<i>Echinacea</i>	Purple Cone Flower			2 Gal.	High	Yes	Full Form
CA	114	<i>Callirhoe arvensis</i>	Common Callirhoe			2 Gal.	High	Yes	Full Form
HE	298	<i>Hemerocallis 'Black Emperor'</i>	Black Emperor (Purple) Daylily			2 Gal.	High	Yes	Full Form
HD	199	<i>Hemerocallis 'Shells O'On'</i>	Shells O'On (Yellow) Daylily			2 Gal.	High	Yes	Full Form
PP	40	<i>Isis pumila 'Purple'</i>	Dwarf Purple Iris			2 Gal.	High	Yes	Full Form
HM	111	<i>Hepatica musini</i>	Blue Cornbit			2 Gal.	High	Yes	Full Form
GRASSES									
CA	46	<i>Cadagrostis occifera 'Karl Foerster'</i>	Karl Foerster Feather Reed Grass			2 Gal.	High	Yes	Full Form (PPOY Winner)
FB	12	<i>Pennisetum alopecuroides 'Little Bunny'</i>	Little Bunny Dwarf Fountain Grass			2 Gal.	High	Yes	Full Form
FO	56	<i>Festuca ovina glauca</i>	Blue Fescue Ornamental Grass			2 Gal.	High	Yes	Full Form

Key Map



Legend

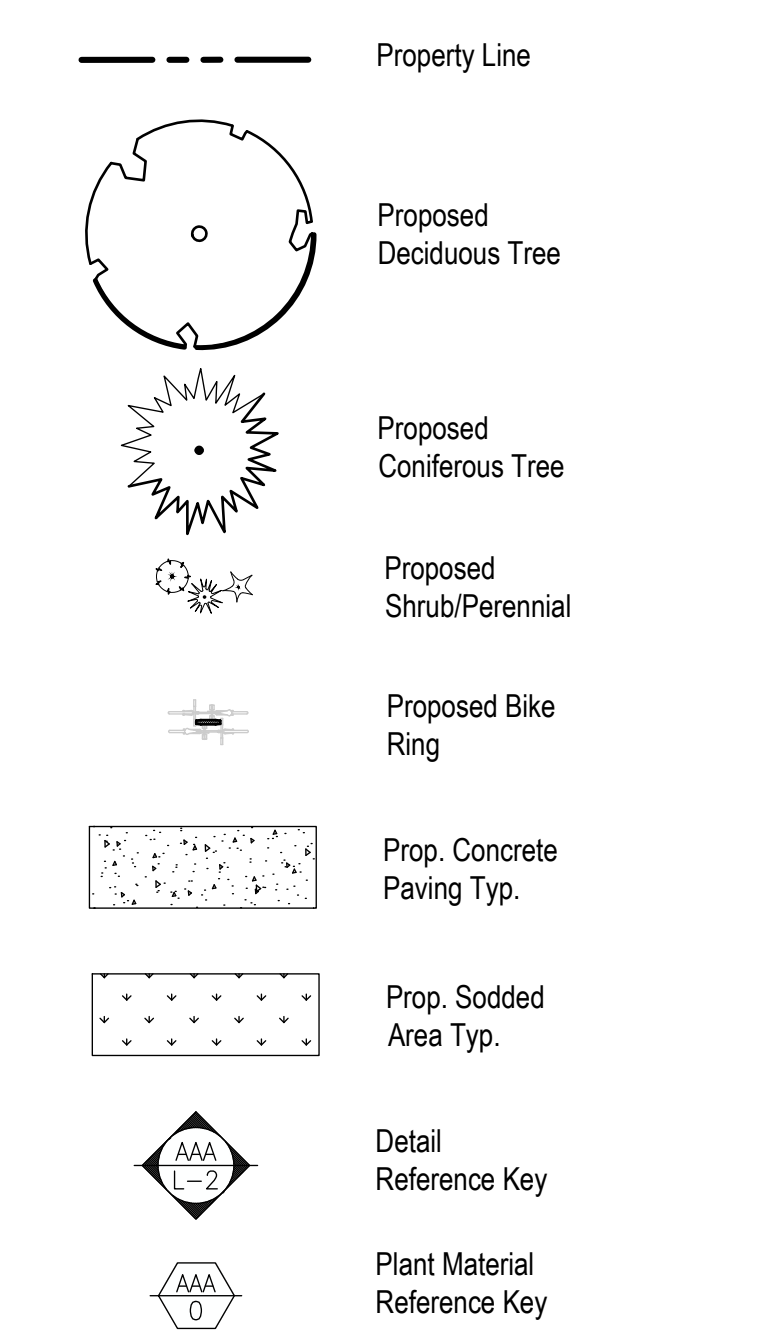

msla
MARTON SMITH LANDSCAPE ARCHITECTS
 170 The Donway W Suite 206
 Toronto, Ontario, Canada, M3C 2G3
 tel. 416.492.9966 | email. info@msla.ca

Architect:
 Municipality:
TOWN OF CALEDON

Notes:

02 Issued for SPA submission 11/28/19
 01 Issued for Review 11/27/19
 No. Revision Date
 North: Stamp:

Project:
Proposed Mixed Use Development
 Highway- 10 and King St
 Caledon, Ontario

Scale: 1:150 Date: Nov. 2019
 Drawn By: J.B. Checked By: L.M.
 Drawing Title:
Landscape Master Plan

Project No. Sheet No.
19185 L1-01

All information contained in these plans shall be checked by the contractor. All discrepancies shall be reported to the Landscape Architect (L.A.) before commencing with construction. All drawings have copyright and shall remain the property of the Landscape Architect. Copying or any reproduction in part or whole shall not be permitted without consent of L.A. A drawing shall not be used for construction unless sealed & SIGNED.
 NOTE FOR ANY AND ALL GRADING INFORMATION REFER TO SITE GRADING ENGINEERING DRAWINGS. NO SLICES ARE TO EXCEED 31°. PROPERTY LINES AND SETBACKS MUST BE COVERED BY CONTRACTOR PRIOR TO CONSTRUCTION. ANY AND ALL RETAINING WALLS MUST BE APPROVED BY STRUCTURAL ENGINEER PRIOR TO CONSTRUCTION.
 DO NOT SCALE DRAWINGS • PRELIMINARY NOT FOR CONSTRUCTION • THESE DRAWINGS ARE NOT TO BE USED FOR CONSTRUCTION UNTIL COUNTERSIGNED BY L.A. ARCHITECT • SIGNED DATE

