

SUBDIVISION PLANT LIST - L1

KEY	QUANT.	BOTANICAL NAME	COMMON NAME	CAL.	HEIGHT	SPREAD	SPACE	COND.
DECIDUOUS TREES								
Ar	5	Acer rubrum	Red Maple	60	-	-	-	BB
Ag	2	Amelanchier grandiflora	Autumn Brilliance	60	-	-	-	BB
Ark	3	Acer rubrum 'Karpick'	Karpick Red Maple	60	-	-	-	BB
SHRUBS and GRASSES								
rb	11	Rosa blanda	Smooth Rose	-	600	-	1200	potted
cs	25	Cornus Sericea	Red Osier Dogwood	-	600	-	1200	potted
ss	42	Schizachyrium scaparium	Little Bluestem	-	400	-	600	potted

NOTE:

- REFER TO LD-1 FOR NOTES AND DETAILS.
- FINAL LOCATIONS OF ALL TREES WILL BE CONFIRMED ON SITE BY THE LANDSCAPE ARCHITECT AFTER THE ABOVE GROUND AND BELOW GROUND UTILITIES ARE INSTALLED AND DRIVEWAY LOCATIONS ARE FINALIZED.
- UNDERGROUND SECONDARY SERVICE TO BE LOCATED NEAR OR UNDER DRIVEWAYS. (TYP.)

CHECK ALL QUANTITIES.

- REPORT ANY DISCREPANCIES TO THE LANDSCAPE ARCHITECT.
- THE QUANTITIES INDICATED ON THE PLAN SUPERSEDE THE TOTALS OF THE PLANT LIST.
- THE LAYOUT OF ALL PLANT MATERIAL IS TO BE APPROVED BY THE LANDSCAPE ARCHITECT PRIOR TO PLANTING.
- SOIL PROFILE TO BE SUITABLE QUALITY FOR TREE TO THRIVE AND MATURE. SOIL TESTING SHOULD BE COMPLETED. IF CONDITIONS ARE POOR TO FAIR, CONSIDER SOIL AMENDMENT AND/OR REPLACEMENT.
- DEPICTED ON THIS PLAN ARE THE SPECIES AND THE APPROXIMATE LOCATION OF STREET TREE. ONCE DRIVEWAYS, UTILITIES AND LIGHT STANDARDS HAVE BEEN INSTALLED, THE EXACT LOCATION OF STREET TREES WILL BE DETERMINED ON SITE BY THE LANDSCAPE CONSULTANT AND APPROVED BY THE MUNICIPALITY PRIOR TO PLANTING.

MINIMUM CLEARANCES FOR STREET TREES (WHEN TREES ARE PLANTED 1.5M FROM THE CURB):

- 2m FROM WATER HYDRANTS
- 2m FROM DRIVEWAYS
- 2m FROM NEIGHBOURHOOD MAILBOXES
- 3m FROM HYDRO TRANSFORMERS
- 5m FROM STREETLIGHTS
- 15m MINIMUM FROM STREET LINE (STREET INTERSECTION AS MEASURED FROM BACK OF CURB) AND BEHIND THE DAYLIGHT TRIANGLE AS PER THE GEOMETRIC DESIGN STANDARDS FOR ONTARIO HIGHWAYS 18m FROM FACE OF ALL WARNING AND REGULATORY SIGNS

- THE TREE PITS AND PLANTING BEDS FOR ALL TREES AND SHRUBS LOCATED WITHIN 1.0m OF UNDERGROUND UTILITIES ARE TO BE HAND DUG.

HABITAT FEATURE NOTES:

- BRANDENBARK BAT HABITAT: IT IS RECOMMENDED THAT BRANDENBARK-EQUIPPED POLES BE INSTALLED IN THE PERIPHERY OF THE PLANTING AREA TO PROVIDE HABITAT FOR BATS. THIS PRODUCT CAN BE PURCHASED ONLINE AT WWW.COPPERHEADCONSULTING.COM/BRANDENBARK/.
- BRUSH PILES SHOULD BE PLACED JUST INSIDE THE DRIP LINE OF THE EXISTING WOODLOT. THE PILES SHOULD CONSIST OF BRANCHES AND OTHER BRUSH COLLECTED ON SITE. PILES SHOULD BE LOOSELY PLACED AT LEAST 1 METRE HIGH.

REFER TO ARCHITECTURAL DRAWING FOR BACKYARD DECK STRUCTURES AND DETAILS.

NOTE: MINIMUM OF 30 CUBIC METRES OF SOIL IS REQUIRED FOR MEDIUM SIZED TREES. WHERE SOIL IS SHARED WITH ANOTHER TREE THE SOIL VOLUME CAN BE REDUCED BY UP TO 30%. (NO LARGE STREET TREES ARE PLANTED WITHIN THIS DEVELOPMENT)

NOTE: MINIMUM SOIL DEPTH FOR ALL SHRUBS AND TREES TO BE 600mm.

TOWN OF CALEDON
PLANNING
RECEIVED
Dec 22, 2023

RESTORATION PLANT LIST - L1

KEY	QUANT.	BOTANICAL NAME	COMMON NAME	CAL.	HEIGHT	SPREAD	SPACE	COND.
DECIDUOUS TREES								
Jn	15	Juglans nigra	Black Walnut	60	-	-	-	BB
Ta	2	Tilia americana	American Basswood	60	-	-	-	BB
Ar	7	Acer rubrum	Red Maple	60	-	-	-	BB
Cc	2	Carpinus carolina	Kentucky Coffee Tree	60	-	-	-	BB
Bp	4	Betula papyrifera	White Birch	60	-	-	-	BB
As	2	Acer saccharinum	Silver Maple	60	-	-	-	BB
To	4	Thuja occidentalis	White Cedar	60	2250	-	-	BB
Pt	4	Populus tremuloides	Trembling Aspen	60	-	-	-	BB
SHRUBS								
Iv	50	Ilex verticillata	Common Winterberry	-	-	-	-	1 gal pot
ro	30	Rubus ororatus	Purple-flowering Raspberry	-	-	-	-	1 gal pot
ai	50	Alnus incana	Speckled Alder	-	-	-	-	1 gal pot
sc	40	Sambucus canadensis	Common Elderberry	-	-	-	-	1 gal pot
vi	40	Viburnum lentago	Nannyberry	-	-	-	-	1 gal pot
ro	60	Rubus occidentalis	Black Raspberry	-	-	-	-	1 gal pot
rb	30	Rosa blanda	Smooth Rose	-	-	-	-	1 gal pot
rt	30	Rhus typhina	Staghorn Sumac	-	-	-	-	1 gal pot

SEED MIXTURE:

"NATIVE UPLAND FORAGE & MEADOW" BY OSC OR APPROVED EQUAL:

CANADA WILD RYE	(ELYMUS CANADENSIS)
FOWL BLUEGRASS	(POA PALUSTRIS)
FOX SEDGE	(CAREX VULPINOIDEA)
LITTLE BLUESTEM	(SCHIZACHYRIUM SCOPARIUM)
SAND DROPSEED	(SPORBOLUS CRYPTANDRUS)
VIRGINIA WILD RYE	(ELYMUS VIRGINICUS)

*APPLY AT 25 kg/HA SEEDING RATE
*APPLY WITH NURSE CROP OF Common Oats (Avena sativa) or Buckwheat (Fagopyrum esculentum) at a rate of 22-25kg/hectare. If seeding after October 31st, use Winter Wheat (Triticum aestivum) at same rate.

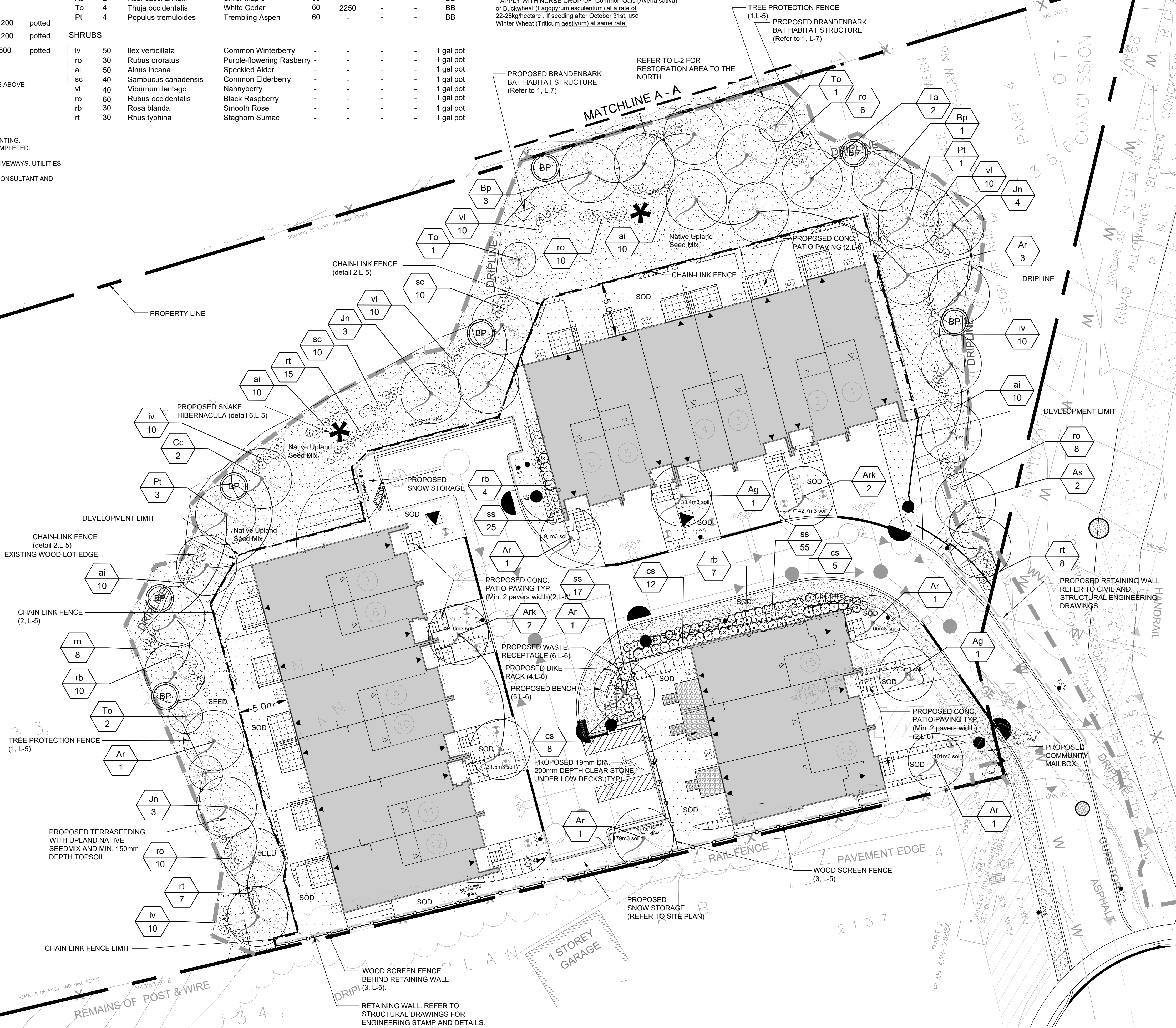

NOT FOR CONSTRUCTION
SPA ONLY

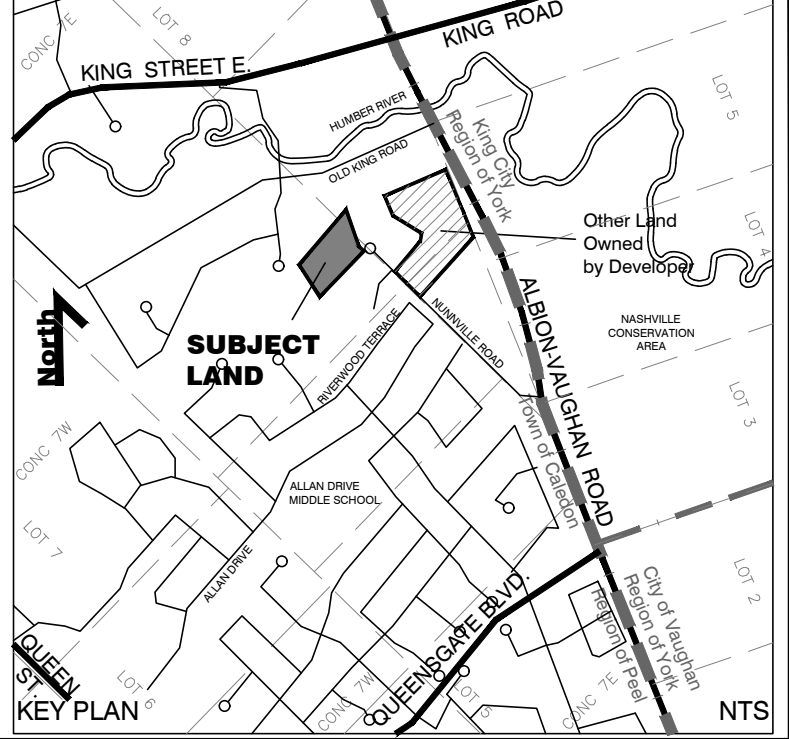

LEGEND	
	PROPOSED DECIDUOUS TREE
	PROPOSED CONIFEROUS TREE
	PROPOSED SOD WITH MIN. 150mm DEPTH TOPSOIL
	PROPOSED UPLAND SEED MIX WITH MIN. 150mm DEPTH TOPSOIL
	PROPOSED TREE PROTECTION FENCE (REFER TO DETAIL 1, L-4)
	PROPOSED RETAINING WALL (REFER TO ENGINEERING DRAWINGS)
	PROPOSED CONCRETE PATIO PAVING (REFER TO DETAIL 2, L-6)
	PROPOSED WOOD SCREEN FENCE (REFER TO DETAIL 4, L-4)
	PROPOSED CHAINLINK FENCE (REFER TO DETAILS 2, L-4)
	PROPOSED LIGHTING REFER TO ELECTRICAL ENGINEERING DRAWINGS
	PROPOSED TRANSFORMER
	PROPOSED FIRE HYDRANT
	PROPOSED SNAKE HIBERNACULA
	PROPOSED BRANDENBARK BAT HABITAT STRUCTURE
	PROPOSED BUSH PILE (refer to notes on this sheet)

5	ISSUED FOR 3rd SPA	18DEC2023
4	ISSUED FOR DART	20NOV2023
3	ISSUED FOR PRE-CONSULTATION (DART)	25APRIL2023
2	ISSUED FOR SECOND ENGINEERING SUBMISSION	9MAR2023
1	ISSUED FOR FIRST ENGINEERING SUBMISSION	28NOV2022
No.	REVISIONS TO DRAWING	DATE
ALL PREVIOUS ISSUES OF THIS DRAWING ARE SUPERSEDED		
PROJECT TITLE		
NUNNVILLE RESIDENTIAL DEVELOPMENT		
MUNICIPALITY		
TOWN OF CALEDON		
PROJECT ADDRESS		
13290 NUNNVILLE ROAD, CALEDON		
SHEET TITLE		
LANDSCAPE PLANTING PLAN		
CONSULTANT		
L LAND STUDIOS INC.		
STAMP		
SCALE	1:300	DATE
DESIGNED	LSN	DRAWN
DWG. NUMBER	L-1	