

DRAFT PLAN OF COMMON ELEMENTS CONDOMINIUM  
PART OF BLOCK 1, PLAN 43M-  
TOWN OF CALEDON  
REGIONAL MUNICIPALITY OF PEEL

SCALE 1:200  
R-PE SURVEYING LTD., O.L.S.  
DISTANCES SHOWN ON THIS PLAN ARE IN METRES AND  
CAN BE CONVERTED TO FEET BY DIVIDING BY 0.3048.

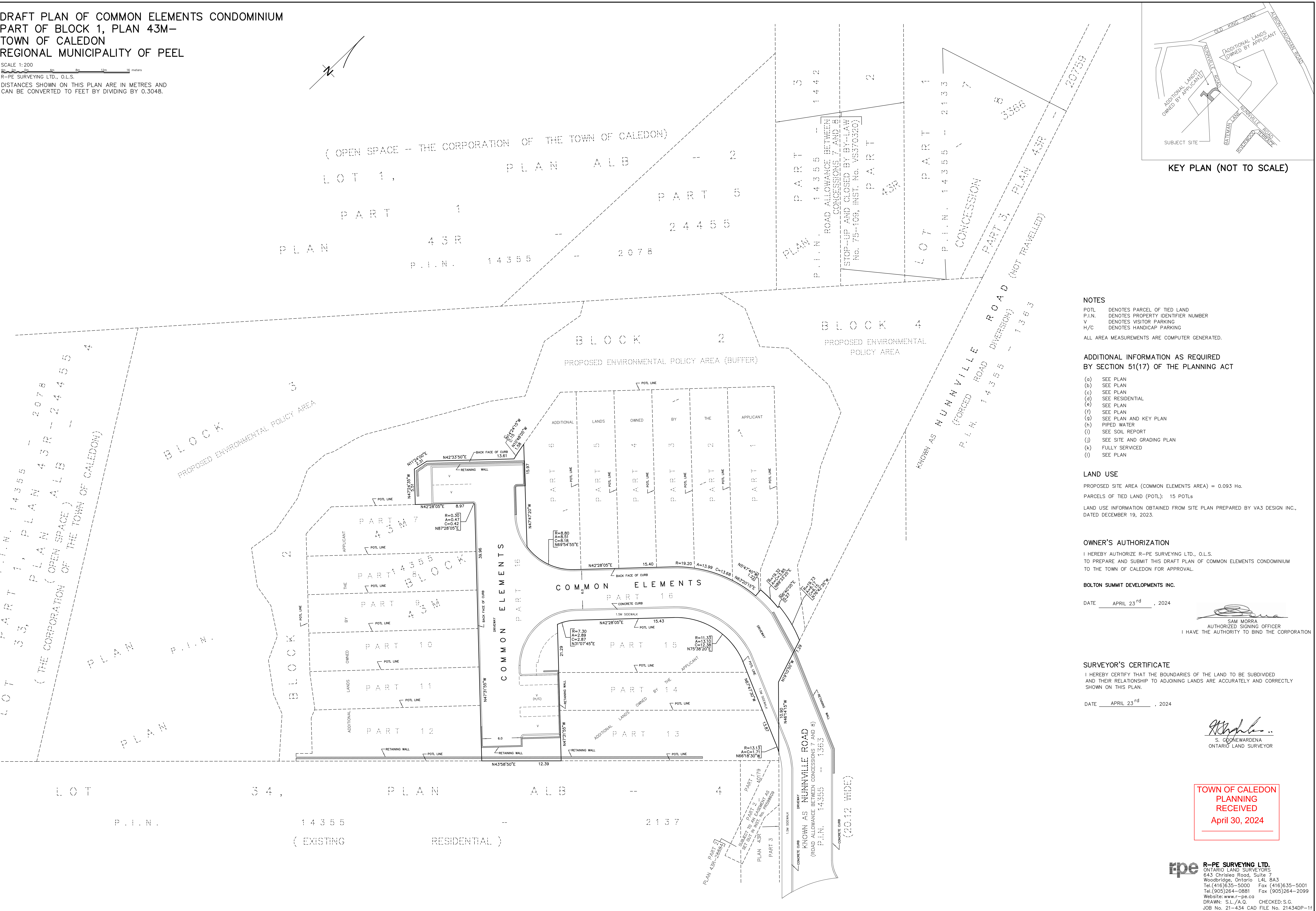

NOTES  
POTL DENOTES PARCEL OF TIED LAND  
P.I.N. DENOTES PROPERTY IDENTIFIER NUMBER  
V DENOTES VISITOR PARKING  
H/C DENOTES HANDICAP PARKING  
ALL AREA MEASUREMENTS ARE COMPUTER GENERATED.

ADDITIONAL INFORMATION AS REQUIRED  
BY SECTION 51(17) OF THE PLANNING ACT

- (a) SEE PLAN
- (b) SEE PLAN
- (c) SEE PLAN
- (d) SEE RESIDENTIAL
- (e) SEE PLAN
- (f) SEE PLAN
- (g) SEE PLAN AND KEY PLAN
- (h) PIPED WATER
- (i) SEE SOIL REPORT
- (j) SEE SITE AND GRADING PLAN
- (k) FULLY SERVICED
- (l) SEE PLAN

LAND USE  
PROPOSED SITE AREA (COMMON ELEMENTS AREA) = 0.093 Ha.  
PARCELS OF TIED LAND (POTL): 15 POTLs  
LAND USE INFORMATION OBTAINED FROM SITE PLAN PREPARED BY VA3 DESIGN INC.,  
DATED DECEMBER 19, 2023.

OWNER'S AUTHORIZATION  
I HEREBY AUTHORIZE R-PE SURVEYING LTD., O.L.S.  
TO PREPARE AND SUBMIT THIS DRAFT PLAN OF COMMON ELEMENTS CONDOMINIUM  
TO THE TOWN OF CALEDON FOR APPROVAL.

BOLTON SUMMIT DEVELOPMENTS INC.  
DATE APRIL 23<sup>rd</sup>, 2024  
SAM MORRA  
AUTHORIZED SIGNING OFFICER  
I HAVE THE AUTHORITY TO BIND THE CORPORATION

SURVEYOR'S CERTIFICATE  
I HEREBY CERTIFY THAT THE BOUNDARIES OF THE LAND TO BE SUBDIVIDED  
AND THEIR RELATIONSHIP TO ADJOINING LANDS ARE ACCURATELY AND CORRECTLY  
SHOWN ON THIS PLAN.  
DATE APRIL 23<sup>rd</sup>, 2024

S. GONWARDENA  
ONARIO LAND SURVEYOR

TOWN OF CALEDON  
PLANNING  
RECEIVED  
April 30, 2024