

- NOTE:
- REFER TO LD-1 FOR NOTES AND DETAILS.
  - FINAL LOCATIONS OF ALL TREES WILL BE CONFIRMED ON SITE BY THE LANDSCAPE ARCHITECT AFTER THE ABOVE GROUND AND BELOW GROUND UTILITIES ARE INSTALLED AND DRIVEWAY LOCATIONS ARE FINALIZED.
  - UNDERGROUND SECONDARY SERVICE TO BE LOCATED NEAR OR UNDER DRIVEWAYS. (TYP.)

- CHECK ALL QUANTITIES.
- REPORT ANY DISCREPANCIES TO THE LANDSCAPE ARCHITECT.
  - THE QUANTITIES INDICATED ON THE PLAN SUPERSEDE THE TOTALS OF THE PLANT LIST.
  - THE LAYOUT OF ALL PLANT MATERIAL IS TO BE APPROVED BY THE LANDSCAPE ARCHITECT PRIOR TO PLANTING.
  - SOIL PROFILE TO BE SUITABLE QUALITY FOR TREE TO THRIVE AND MATURE. SOIL TESTING SHOULD BE COMPLETED. IF CONDITIONS ARE POOR TO FAIR, CONSIDER SOIL AMENDMENT AND/OR REPLACEMENT.

**PLANT LIST - L1**

KEY	QUANT.	BOTANICAL NAME	COMMON NAME	CAL.	HEIGHT	SPREAD	SPACE	COND.
-----	--------	----------------	-------------	------	--------	--------	-------	-------

**DECIDUOUS TREES**

Ar	5	Acer rubrum	Red Maple	60	-	-	-	BB
Qa	7	Quercus rubra	Red Oak	60	-	-	-	BB
Qr	2	Quercus alba	White Oak	60	-	-	-	BB
Gd	3	Gymnocladus dioica	Kentucky Coffee Tree	60	-	-	-	BB

**CONIFEROUS TREE**

Pg	3	Picea glauca	White Spruce	-	1500	-	-	BB
----	---	--------------	--------------	---	------	---	---	----

**SEED MIXTURE:**

"NATIVE UPLAND FORAGE & MEADOW" BY OSC OR APPROVED EQUAL:

CANADA WILD RYE	( <i>ELYMUS CANADENSIS</i> )
FOWL BLUEGRASS	( <i>POA PALUSTRIS</i> )
FOX SEDGE	( <i>CAREX VULPINOIDEA</i> )
LITTLE BLUESTEM	( <i>SCHIZACHYRIUM SCOPARIUM</i> )
SAND DROPSEED	( <i>SPORBOLUS CRYPTANDRUS</i> )
VIRGINIA WILD RYE	( <i>ELYMUS VIRGINICUS</i> )

- \*APPLY AT 25 kg/HA SEEDING RATE
- \*APPLY WITH NURSE CROP OF ANNUAL RYE OR OATS AT 22.25kg/hectare

- DEPICTED ON THIS PLAN ARE THE SPECIES AND THE APPROXIMATE LOCATION OF STREET TREE. ONCE DRIVEWAYS, UTILITIES AND LIGHT STANDARDS HAVE BEEN INSTALLED, THE EXACT LOCATION OF STREET TREES WILL BE DETERMINED ON SITE BY THE LANDSCAPE CONSULTANT AND APPROVED BY THE MUNICIPALITY PRIOR TO PLANTING.
- MINIMUM CLEARANCES FOR STREET TREES (WHEN TREES ARE PLANTED 1.5M FROM THE CURB):  
 2m FROM WATER HYDRANTS  
 2m FROM DRIVEWAYS  
 2m FROM NEIGHBOURHOOD MAILBOXES  
 3m FROM HYDRO TRANSFORMERS  
 5m FROM STREET LIGHTS  
 15m MINIMUM FROM STREET LINE (STREET INTERSECTION AS MEASURED FROM BACK OF CURB) AND BEHIND THE DAYLIGHT TRIANGLE AS PER THE GEOMETRIC DESIGN STANDARDS FOR ONTARIO HIGHWAYS  
 18m FROM FACE OF ALL WARNING AND REGULATORY SIGNS
- THE TREE PITS AND PLANTING BEDS FOR ALL TREES AND SHRUBS LOCATED WITHIN 1.0m OF UNDERGROUND UTILITIES ARE TO BE HAND DUG.

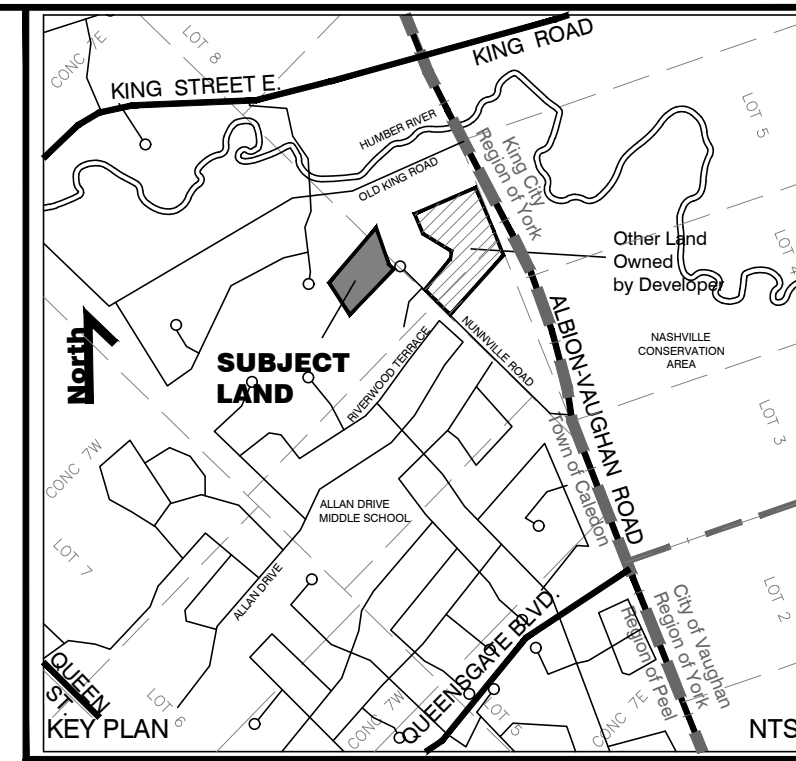

**LEGEND**

- PROPOSED DECIDUOUS TREE
- PROPOSED CONIFEROUS TREE
- PROPOSED SOD WITH MIN. 150mm DEPTH TOPSOIL
- PROPOSED UPLAND SEED MIX WITH MIN. 150mm DEPTH TOPSOIL
- TREE PROTECTION FENCE REFER TO TIPP FIGURE 1 FOR DETAILS
- LIGHTING REFER TO ELECTRICAL ENGINEERING DRAWINGS
- TRANSFORMER REFER TO ELECTRICAL ENGINEERING DRAWINGS

NOT FOR CONSTRUCTION SPA ONLY

1 ISSUED FOR REVIEW 31MAR2022

No. REVISIONS TO DRAWING DATE

ALL PREVIOUS ISSUES OF THIS DRAWING ARE SUPERSEDED

PROJECT TITLE

**NUNNVILLE RESIDENTIAL DEVELOPMENT**

MUNICIPALITY

TOWN OF CALEDON

PROJECT ADDRESS

13290 NUNNVILLE ROAD, CALEDON

SHEET TITLE

**LANDSCAPE PLANTING PLAN**

CONSULTANT

**L LAND STUDIOS INC.**

STAMP

SCALE 1:300 DATE 15 MAR 2022 PROJECT NUMBER 202203

DESIGNED LSN DRAWN LSN CHECKED LSN

DWG. NUMBER **L-1**

**TOWN OF CALEDON  
PLANNING  
RECEIVED**  
May 2, 2022

