

- NOTE:
- REFER TO LD-1 FOR NOTES AND DETAILS.
 - FINAL LOCATIONS OF ALL TREES WILL BE CONFIRMED ON SITE BY THE LANDSCAPE ARCHITECT AFTER THE ABOVE GROUND AND BELOW GROUND UTILITIES ARE INSTALLED AND DRIVEWAY LOCATIONS ARE FINALIZED.
 - UNDERGROUND SECONDARY SERVICE TO BE LOCATED NEAR OR UNDER DRIVEWAYS. (TYP.)

- CHECK ALL QUANTITIES.
- REPORT ANY DISCREPANCIES TO THE LANDSCAPE ARCHITECT.
 - THE QUANTITIES INDICATED ON THE PLAN SUPERSEDE THE TOTALS OF THE PLANT LIST.
 - THE LAYOUT OF ALL PLANT MATERIAL IS TO BE APPROVED BY THE LANDSCAPE ARCHITECT PRIOR TO PLANTING.
 - SOIL PROFILE TO BE SUITABLE QUALITY FOR TREE TO THRIVE AND MATURE. SOIL TESTING SHOULD BE COMPLETED. IF CONDITIONS ARE POOR TO FAIR, CONSIDER SOIL AMENDMENT AND/OR REPLACEMENT.

PLANT LIST - L1

KEY	QUANT.	BOTANICAL NAME	COMMON NAME	CAL.	HEIGHT	SPREAD	SPACE	COND.
-----	--------	----------------	-------------	------	--------	--------	-------	-------

DECIDUOUS TREES

Ar	7	Acer rubrum	Red Maple	60	-	-	-	BB
Qa	9	Quercus rubra	Red Oak	60	-	-	-	BB
Qr	2	Quercus alba	White Oak	60	-	-	-	BB
Gd	10	Gymnocladus dioica	Kentucky Coffee Tree	60	-	-	-	BB
Sr	1	Syringa reticulata	Ivory Silk Lilac	45	-	-	-	BB

CONIFEROUS TREE

Pg	6	Picea glauca	White Spruce	-	1800	-	-	BB
To	5	Thuja occidentalis	Eastern White Cedar	-	1800	-	-	BB

SHRUBS AND GRASSES

sa	12	Symphoricarpos albus	Snowberry	-	600	-	1200	potted
cs	13	Cornus Sericea	Red Osier Dogwood	-	600	-	1200	potted
ss	79	Schizachyrium scaparium	Little Bluestem	-	400	-	600	potted

- DEPICTED ON THIS PLAN ARE THE SPECIES AND THE APPROXIMATE LOCATION OF STREET TREE. ONCE DRIVEWAYS, UTILITIES AND LIGHT STANDARDS HAVE BEEN INSTALLED, THE EXACT LOCATION OF STREET TREES WILL BE DETERMINED ON SITE BY THE LANDSCAPE CONSULTANT AND APPROVED BY THE MUNICIPALITY PRIOR TO PLANTING.
- MINIMUM CLEARANCES FOR STREET TREES (WHEN TREES ARE PLANTED 1.5M FROM THE CURB):
 2m FROM WATER HYDRANTS
 2m FROM DRIVEWAYS
 2m FROM NEIGHBOURHOOD MAILBOXES
 3m FROM HYDRO TRANSFORMERS
 9m FROM STREET LIGHTS
 15m MINIMUM FROM STREET LINE (STREET INTERSECTION AS MEASURED FROM BACK OF CURB) AND BEHIND THE DAYLIGHT TRIANGLE AS PER THE GEOMETRIC DESIGN STANDARDS FOR ONTARIO HIGHWAYS
 18m FROM FACE OF ALL WARNING AND REGULATORY SIGNS
- THE TREE PITS AND PLANTING BEDS FOR ALL TREES AND SHRUBS LOCATED WITHIN 1.0m OF UNDERGROUND UTILITIES ARE TO BE HAND DUG.

SEED MIXTURE:
 "NATIVE UPLAND FORAGE & MEADOW" BY OSC OR APPROVED EQUAL:
 CANADA WILD RYE (ELYMUS CANADENSIS)
 FOWL BLUEGRASS (POA PALUSTRIS)
 FOX SEDGE (CAREX VULPINOIDEA)
 LITTLE BLUESTEM (SCHIZACHYRIUM SCOPARIUM)
 SAND DROPSEED (SPORBOLUS CRYPTANDRUS)
 VIRGINIA WILD RYE (ELYMUS VIRGINICUS)
 *APPLY AT 25 kg/HA SEEDING RATE
 *APPLY WITH NURSE CROP OF Common Oats (Avena sativa) or Buckwheat (Fagopyrum esculentum) at a rate of 22-25kg/hectare. If seeding after October 31st, use Winter Wheat (Triticum aestivum) at same rate.

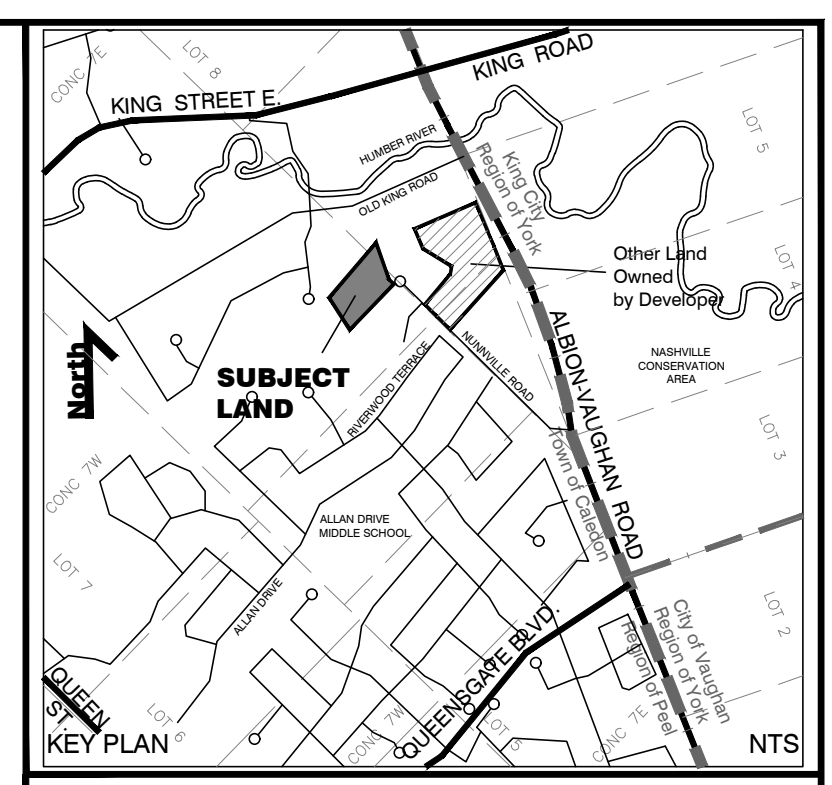
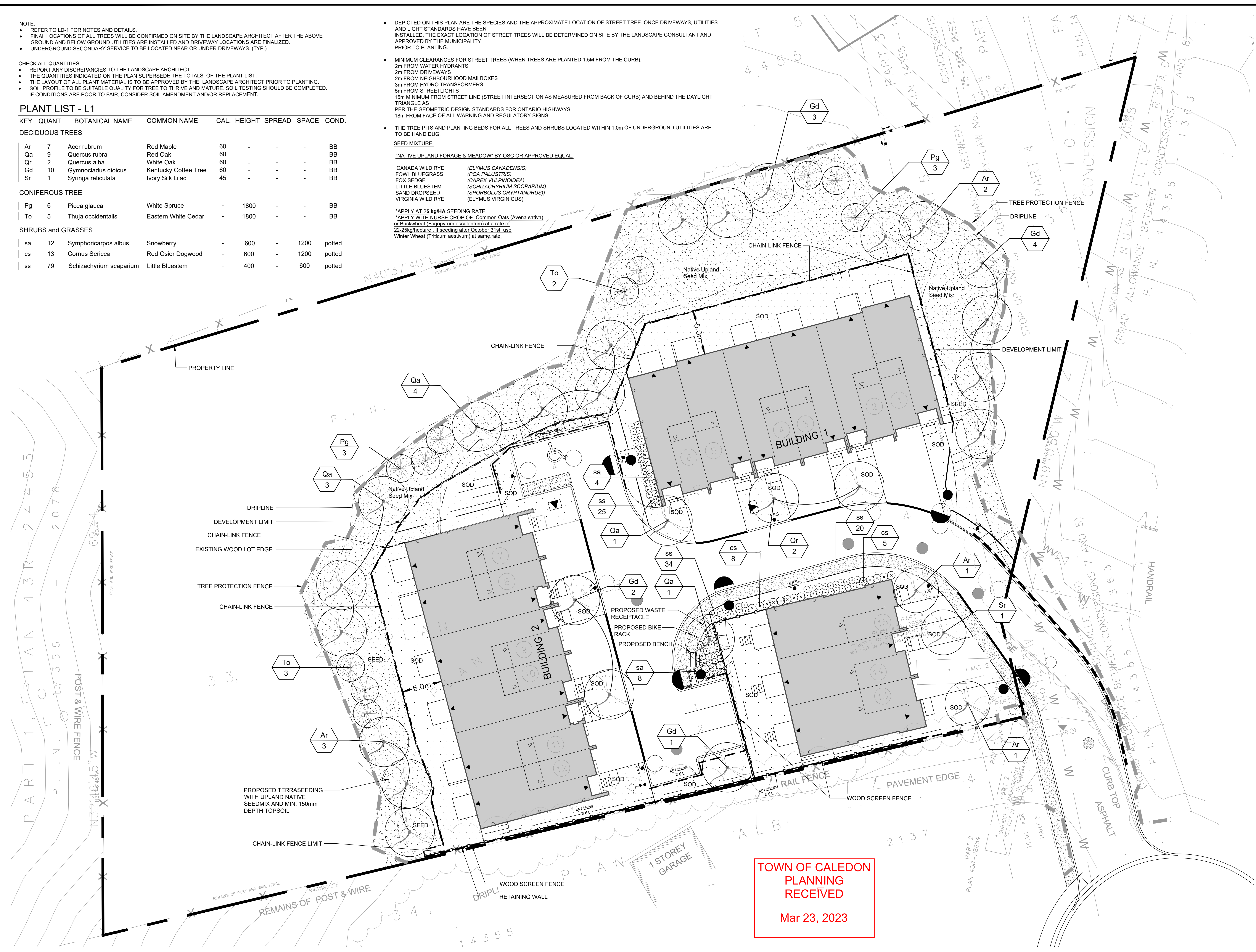

LEGEND

- PROPOSED DECIDUOUS TREE
- PROPOSED CONIFEROUS TREE
- PROPOSED SOD WITH MIN. 150mm DEPTH TOPSOIL
- PROPOSED UPLAND SEED MIX WITH MIN. 150mm DEPTH TOPSOIL
- TREE PROTECTION FENCE (REFER TO DETAIL 1, L-4)
- WOOD SCREEN FENCE (REFER TO DETAIL 4, L-4)
- CHAINLINK FENCE (REFER TO DETAILS 2, L-4)
- LIGHTING REFER TO ELECTRICAL ENGINEERING DRAWINGS
- TREE PROTECTION FENCE REFER TO TIPP FIGURE 1 FOR DETAILS

NOT FOR CONSTRUCTION SPA ONLY

2	ISSUED FOR SECOND ENGINEERING SUBMISSION	9MAR2023
1	ISSUED FOR FIRST ENGINEERING SUBMISSION	28NOV2022
No.	REVISIONS TO DRAWING	DATE

ALL PREVIOUS ISSUES OF THIS DRAWING ARE SUPERSEDED

PROJECT TITLE
 NUNNVILLE RESIDENTIAL DEVELOPMENT

MUNICIPALITY
 TOWN OF CALEDON

PROJECT ADDRESS
 13290 NUNNVILLE ROAD, CALEDON

SHEET TITLE
 LANDSCAPE PLANTING PLAN

CONSULTANT
 L STUDIOS INC.

STAMP

SCALE	1:300	DATE	15 MAR 2022	PROJECT NUMBER	202203
DESIGNED	LSN	DRAWN	LSN	CHECKED	LSN
DWG. NUMBER	L-1				

TOWN OF CALEDON
 PLANNING RECEIVED
 Mar 23, 2023