

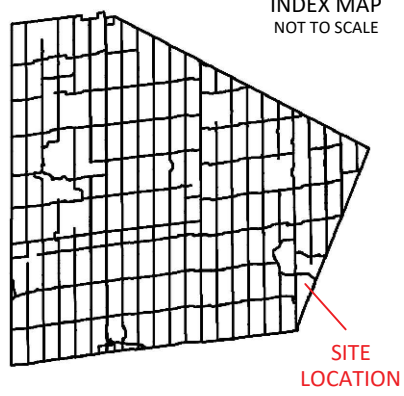

TOWN OF CALEDON  
PLANNING  
RECEIVED

Mar 23, 2023

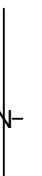
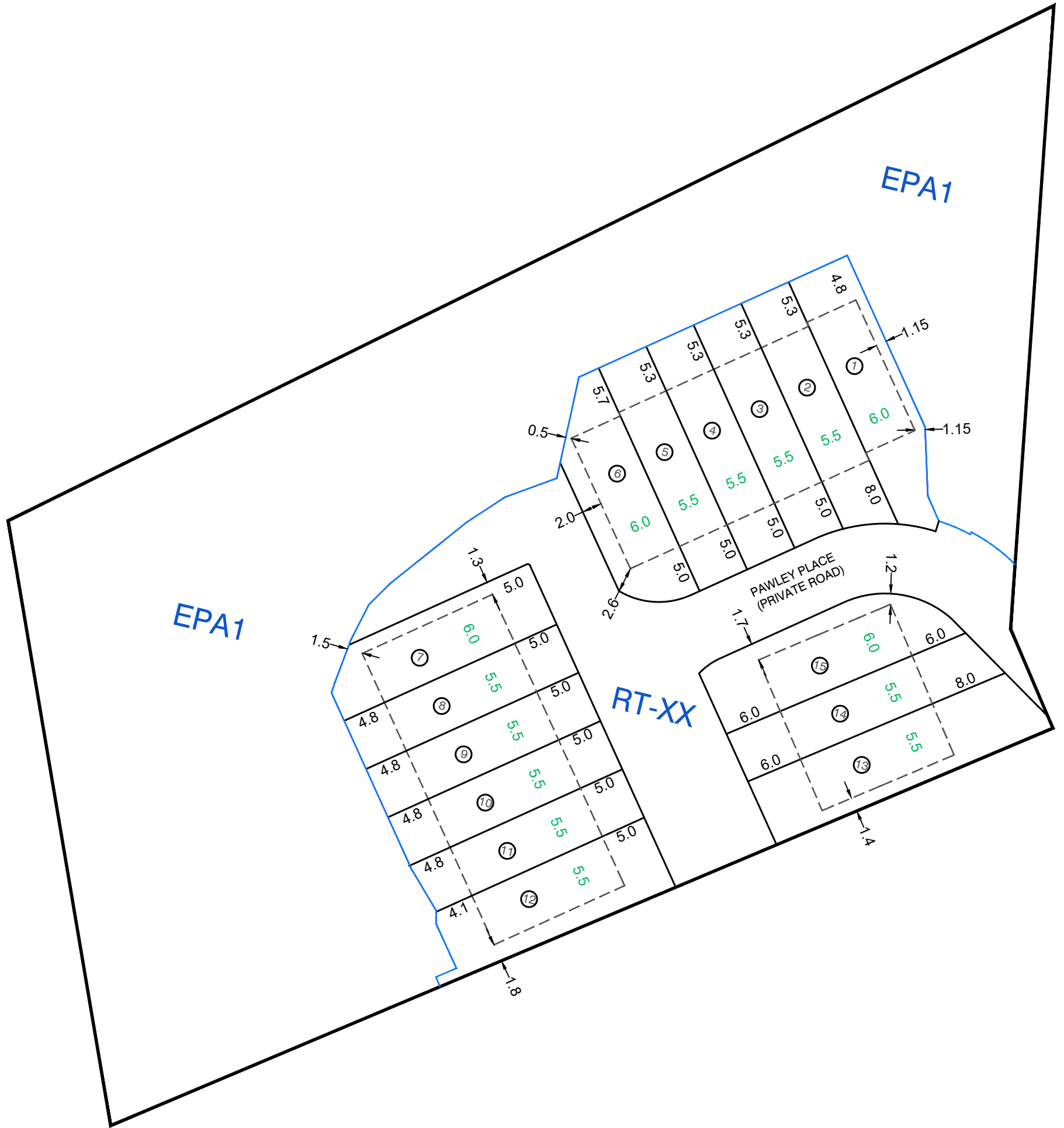
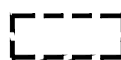

**LEGEND**

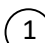
-  Structure Envelope
-  Zone Boundary
-  Unit Number

Frontage (Min)

All measurements are in metres

**Proposed Schedule 'B'  
ZONE MAP  
S.E.xx**

PART OF LOT 33, PLAN ALB-4 AND PART OF LOT 7  
CONCESSION 8 AND PART OF ROAD ALLOWANCE  
BETWEEN CONCESSION 7 AND 8 (STOPPED-UP AND  
CLOSED BY BY-LAW No. 75-109, INST. No. VS370320)  
GEOGRAPHIC TOWNSHIP OF ALBION, TOWN OF  
CALEDON, REGIONAL MUNICIPALITY OF PEEL



Date: March 10, 2023

Created: PM Checked: MA

211-09988-01