

DISTANCES SHOWN ON THIS PLAN ARE IN METRES AND  
 CAN BE CONVERTED TO FEET BY DIVIDING BY 0.3048

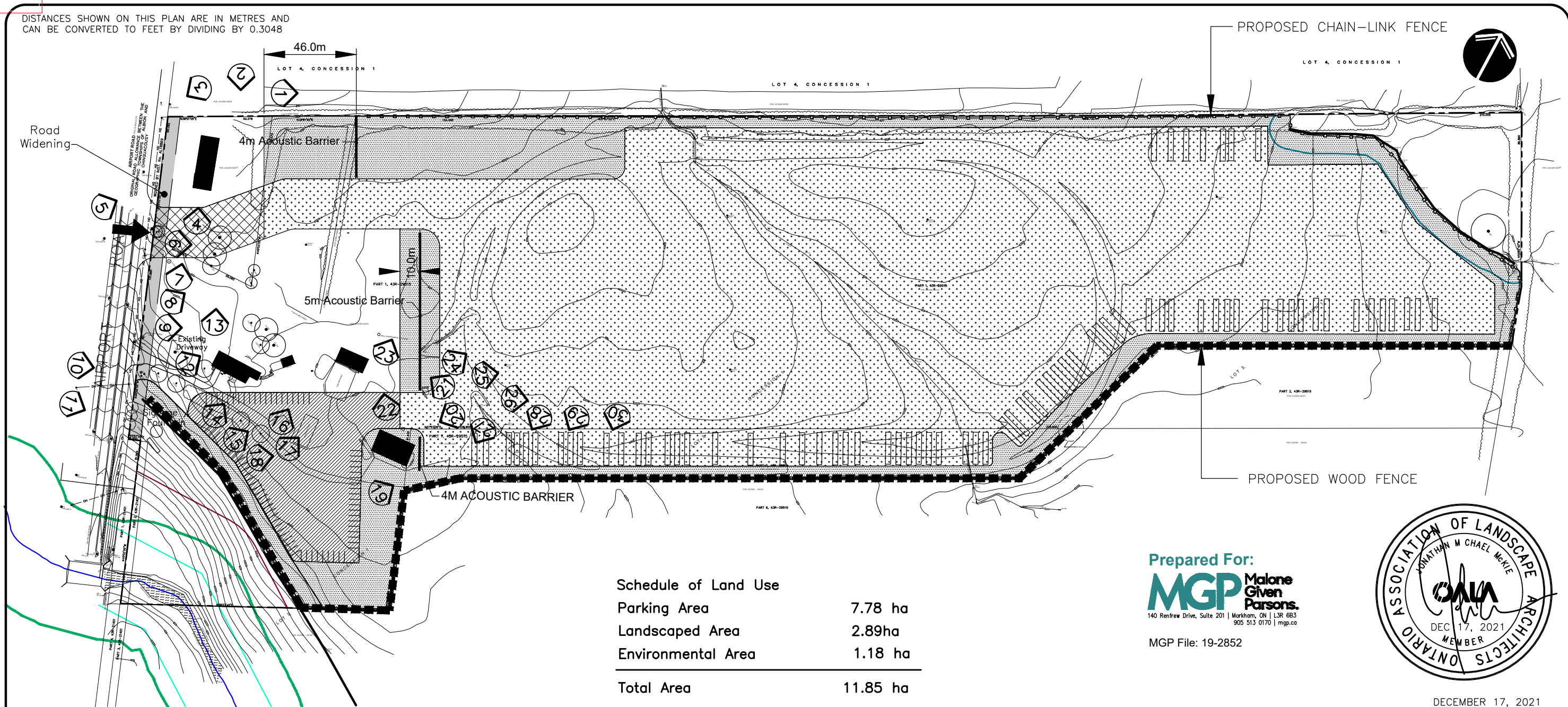

Schedule of Land Use	
Parking Area	7.78 ha
Landscaped Area	2.89ha
Environmental Area	1.18 ha
<b>Total Area</b>	<b>11.85 ha</b>

Prepared For:  
**MGP** Malone  
 Given  
 Parsons.  
 140 Renfrew Drive, Suite 201 | Markham, ON | L3R 6B3  
 905 513 0170 | mgp.ca  
 MGP File: 19-2852

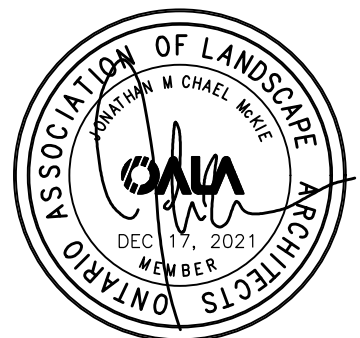

DECEMBER 17, 2021  
**CONCEPTUAL TRANSPORT  
 TRUCK/TRAILER PARKING LAYOUT**  
 12541 & 12577 AIRPORT ROAD  
 Town of Caledon  
 Regional Municipality of Peel

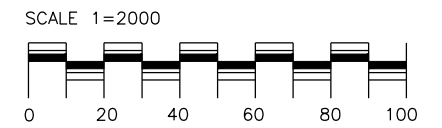

**M&M Design Consultants**  
 53 Doris Drive  
 Toronto, Ontario, M4B 3C7  
 (416) 453-2803  
 jonathan.mckie@gmail.com  
 www.mandmdesignconsultants.ca  
 © M&M DESIGN CONSULTANTS 2021

**LEGEND**

	PROPERTY LINE		GRAVEL TRUCK PARKING AREA
	PROPOSED CHAIN-LINK FENCE		VEGETATION GROUNDCOVER
	PROPOSED WOOD FENCE		GRAVEL TRUCK ENTRANCE
	PICTURE LOCATION		GRAVEL VEHICLE PARKING AREA

**NOTES:**

- USE EXISTING DRIVEWAY WHERE POSSIBLE AND SURFACE WITH GRAVEL PLACED ON FILTER-CLOTH
- ANY DEBRIS ENCOUNTERED DURING CONSTRUCTION SHALL BE DISPOSED OF OFF SITE
- ALL SURFACE RUN-OFF MUST BE CONTAINED ON SITE
- A DUST MANAGEMENT SYSTEM SHALL BE USED. IT SHALL BE ECO-FRIENDLY WITHOUT THE USE OF PETROLEUM BASED PRODUCTS SUCH AS WATER, MAGNESIUM CHLORIDE SOLUTION, DUST STOP, AND/OR CERTIFIED FOR ORGANIC PRODUCTION OR FOOD PROCESSING. THE PRODUCT AND DUST MANAGEMENT SYSTEM MUST BE APPROVED BY THE LOCAL AUTHORITY PRIOR TO USE.

**POST SITE REHABILITATION & VEGETATION GROUNDCOVER:**

- IF RESTORED WITH 4"-6" (0.1-0.15m) OF TOPSOIL HYDROSEED MAY BE USED. IF NOT, TERRASEED COULD BE USED. A NATIVE SEED MIXTURE SUCH AS "RURAL ONTARIO ROADSIDE NATIVE SEED MIX (8145)" FROM OSC SEEDS WITH A NATIVE NURSE CROP SUCH AS RYE OR OATS APPLIED AT 22-25kg/ha (21-23lbs/acre). THE SEED MIXTURE MUST BE APPROVED BY THE LOCAL AUTHORITY PRIOR TO USE.



Image 1



Image 2



Image 3



Image 4



Image 5



Image 6



Image 7

Image 8



Image 9

Image 10



Image 11

Image 12



Image 13



Image 14



Image 15



Image 16



Image 17



Image 18



Image 19



Image 20



Image 21



Image 22



Image 23



Image 24



Image 25



Image 26



Image 27



Image 28



Image 29



Image 30