

## SPECIFICATIONS

continued from previous panel

### C. BED PREPARATION

- i) The Contractor shall scarify the sides and bottom of excavated tree pits and shrub beds prior to backfilling. Due to the heavy clay soil in the Bolton area, tree and planting beds shall be backfilled to the specified depths with:

2 Parts "triple mix," delivered to the site, to be well-mixed with . . .

- 1 Part local topsoil (viz., subdivision topsoil that has been removed and stockpiled.) If topsoil is unavailable, topsoil with clay content shall be imported and mixed with triple mix.

- ii) Tree pits shall be constructed with saucers and mulch as detailed.

### D. PRELIMINARY ACCEPTANCE

- i) When landscaping is completed, the Landscape Architect shall submit a Certificate of Completion to the Town of Caledon certifying that all landscape works have been completed in accordance with the approved plans.

- ii) The Landscape Architect shall prepare a Summary Chart, indicating the plant species, quantity, location, planting date(s), and any other relevant information requested by the Municipality.

- iii) Upon receipt of the Certificate of Completion, the Planning Department will conduct a preliminary inspection of the site and, provided that the works are in satisfactory condition, will grant preliminary acceptance of the landscaping.

### E. GUARANTEE

- i) All streetscape landscaping shall carry a guarantee/maintenance of **TWO (2) years**, commencing from the date that written preliminary acceptance is granted by the Town of Caledon. In each of the next two years, the Landscape Architect shall conduct an inspection and prepare a report, recommending the replacements and/or works needed to achieve the intent of the approved landscape plan. All replacements shall be recorded in the inspection Summary Chart. The Landscape Architect shall file a copy of the report and/or Summary Chart with the Municipality.

- ii) Replacement plant material and repaired work shall be guaranteed for a minimum **TWO (2) years** from the date of replacement, and will not be granted final acceptance until the guarantee has expired or as otherwise determined by the Planning Department.

- iii) All other landscape work performed under this contract shall be fully guaranteed for **TWO (2) years**.

### F. MAINTENANCE

- i) The maintenance of all landscape installations throughout the guarantee period shall include:

- 1) proper irrigation to ensure optimum growth of trees and shrubs,
- 2) cultivation and weeding of tree pits and planting beds,
- 3) insect and disease control, and
- 4) pruning and fertilizing, as required or as directed by the Municipality or Landscape Architect.

specifications continue on next panel . . .

TOWN OF CALEDON

STREETSCAPE SPECIFICATIONS  
STANDARD NOTES  
PART 2

APR'D: C.C.

DATE: JUNE 08

DRAWN: abal

SCALE: NTS

1 STANDARD No. 1170.02 NOW 713

JUNE 08

NO.

REVISION

APR'D

DATE

STANDARD No. 713

## SPECIFICATIONS

### A. GENERAL

- i) These Specifications are to be read in conjunction with the General Conditions of the contract, as prepared by and available at the offices of \_\_\_\_\_.

- ii) Prior to commencing work, the Contractor shall:

1. Become familiar with the plans, details, and specifications of this project,
2. Visit the site to ascertain and take account of existing conditions and any deviations from the plans in work by others, and
3. Finalize all design alternatives in consultation with the Landscape Architect.

- iii) Prior to excavating, the Contractor shall verify the location of all underground utilities. In the event of a conflict between a proposed tree location and an underground service, the exact location of the tree shall be determined on site by the landscape architect and/or the Town's representative.

- iv) The Contractor shall, at his or her own expense, repair any damage to existing utilities, structures, facilities, etc. done in the performance of his work.

- v) All site work shall conform to the *Canadian National Master Construction Specifications*, a copy of which can be obtained from Construction Specifications Canada, 100 Lombard St., Suite 200, Toronto, Ontario M5C 1M3; Tel. (416) 777-2198; Fax (416) 777-2197. It is the responsibility of the Contractor to be thoroughly familiar with these specifications and their implications for this project.

### B. PLANT MATERIAL

- i) All plants shall be installed true to specified names, sizes, grades, etc., and shall conform to the standards of the Canadian Nursery Landscapes Association.

- ii) All plants shall be nursery grown in a hardiness zone appropriate to site conditions, as published by Agriculture Canada, titled 'Map of Plant Hardiness Zones in Canada'.

- iii) In the event of a discrepancy in plant quantity between the Planting Plan and the Plant List, the Planting Plan shall govern.

- iv) The Contractor shall make plants available for inspection by the Landscape Architect and/or the Town's representative prior to shipping to the site. This does not limit the right of the Landscape Architect and/or the Town's representative to later reject plant material that is of poor quality, damaged during shipping or installation, performing poorly while the guarantee period is still in effect, or otherwise does not conform to the specifications.

- v) Plant substitutions must be approved in writing by the Town and the Landscape Architect prior to delivery of the material to the site.

- vi) The Contractor shall use standard industry methods for planting trees and shrubs. Trees shall be turned to give the best appearance; they shall also be guyed or staked immediately after planting and as detailed on the drawings.

specifications continued on next panel . . .

TOWN OF CALEDON

STREETSCAPE SPECIFICATIONS  
STANDARD NOTES  
PART 1

APR'D: C.C.

DATE: JUNE 08

DRAWN: abal

SCALE: NTS

2 STANDARD No. 1170.01 NOW 712

1 CHANGES TO NOTES VI & VII

NO.

REVISION

APR'D

DATE

JUNE 08

MARCH 08

STANDARD No. 712

## PLANTING NOTES

1. The Contractor shall review all information in all drawings details and specifications and report any discrepancies to the Landscape Architect in writing prior to commencement of works.
2. All planting and related work shall be completed by experienced personnel under the direction and supervision of a qualified foreman.
3. All plant material which cannot be planted immediately will be properly heeled in or covered with a similar material which will keep root surfaces moist until planted.
4. All plant material and operations shall meet or exceed current horticultural standards of the Canadian Nursery Landscape Association. All plant material to be No. 1 Grade Nursery Stock. All unsatisfactory stock including field grown will be refused on site.
5. The Landscape Architect reserves the right to reject any material, plantings and sod prior to or after installation which does not conform to approved specifications in accordance with approved details. The Contractor will be asked to remove any unapproved material which does not conform to specifications unless there is prior written agreement with the Landscape Architect.
6. Trees and shrubs shall have an uncut, strong central leader, be sound, healthy, vigorous, well-branched, densely foliated, free of disease, insects and have well-developed root systems.
7. Where applicable, sod to be Canada No. 1 Nursery Sod, meeting Ontario Sod Growers Association Standards. All Areas to receive 100mm minimum depth of topsoil under sod unless otherwise indicated. See Drawings and Specifications for areas to be mulched.
8. The Contractor shall stake out all planting locations for approval by the Landscape Architect or Contract Administrator prior to planting. Where dimensions are not provided, the drawing may be scaled ONLY to determine approximate locations of plant material. Dimensions are in millimeters unless otherwise stated.
9. All mass plantings shall be in continuous beds with mulch as specified in planting details.
10. All planting will be under warranty by the Contractor for a minimum of 1 year. The Contractor shall water at time of planting and whenever deemed necessary to maintain trees in a healthy condition. Apply aqueous fertilizer in a ratio of 10-6-4 in accordance with manufacturers instructions. Sod, where specified, to be maintained and guaranteed until established, minimum after two mowings.
11. Unwrap or do not wrap tree trunks. Stake trees in accordance with required specifications.
12. Provide sufficient rodent protection on all new planting so as to deter bark or shoot damage by rodents. Significant rodent damage, as determined by the Landscape Architect will require plant replacement.

LANDMARK  
ENVIRONMENTAL GROUP LTD

## KEY PLAN

NTS

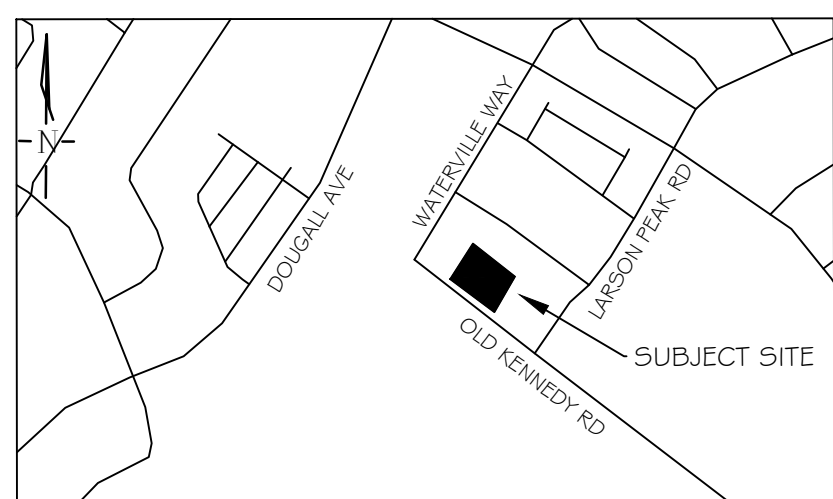

## GENERAL NOTES

The Client and its contractors are responsible for all utility locates and confirming all setbacks, elevations, grades, etc. prior to installation of the constructed works.

The Contractor is to report any discrepancies in writing to the Landscape Architect prior to proceeding with the works to determine the impact and suitability of the proposed works. The Landscape Architect will not be responsible for any unapproved adjustments on site.

Construction of the works must conform to Authority requirements and applicable codes where they have jurisdiction.

All specifications and drawings are instruments of service and are the property and ownership of the Landmark Environmental Group Ltd. As such, the drawings shall not be modified or reproduced without the expressed written consent of Landmark Environmental Group Ltd. or they will be considered void. The said drawings are for Site Plan approval only and may require additional detailing prior to tender and construction.

The Landmark Environmental Group Ltd. is not liable for errors or omissions from the use of these drawings prior to approval, seal, signature and date, and will be considered void.

It is advised that the Contractor contact the Landscape Architect prior to commencement of the construction works to ensure that the Contractor has the latest approved drawings.

The Landmark Environmental Group Ltd. is not responsible for the accuracy of the base drawing information (eg Survey, Architectural, Engineering, etcO. If there are any discrepancies, the Contractor will refer to the appropriate base drawing information and report discrepancies on the Landscape Drawings to the Landscape Architect.

© Copyright Landmark Environmental Group Ltd., 2020.

## LEGEND

NO.	DATE	BY	REVISIONS
STAMP			
APPROVAL			
TOWN OF CALEDON			
NAME _____			
DATE _____			
SIGNATURE _____			

	LANDSCAPE ARCHITECTS & CONSULTING ARBORISTS
OFFICE: 705-796-1122	
info@LEGroupLtd.com	
www.LEGroupLtd.com	

CLIENT:
MR. NAVINDER SINGH LAL

PROJECT:
1 2507 OLD KENNEDY RD, CALEDON CONSENT DEVELOPMENT

DRAWING:
DETAILS

SCALE BAR:
------------

PROJECT NO.: LA 499-20	SCALE: N.T.S
MUNICIPAL FILE NO.:	DATE: NOV 30-20
DRAWN BY: S.K / J.G	CHECKED BY: J.H
DRAWING No.: LG.O	

## PLANT LIST

KEY	QTY	BOTANICAL NAME	COMMON NAME	SIZE/CONDITION
Af*	3	<i>Acer x freemanni 'Autumn Blaze'</i>	Autumn Blaze Freeman's Maple	60mm cal/WB

\* DENOTES A STREET TREE