

11.5m 3000 CSR
CULVERT @ 0.40%
Ex. 2000 PVC WATER

OLD KENNEDY RD

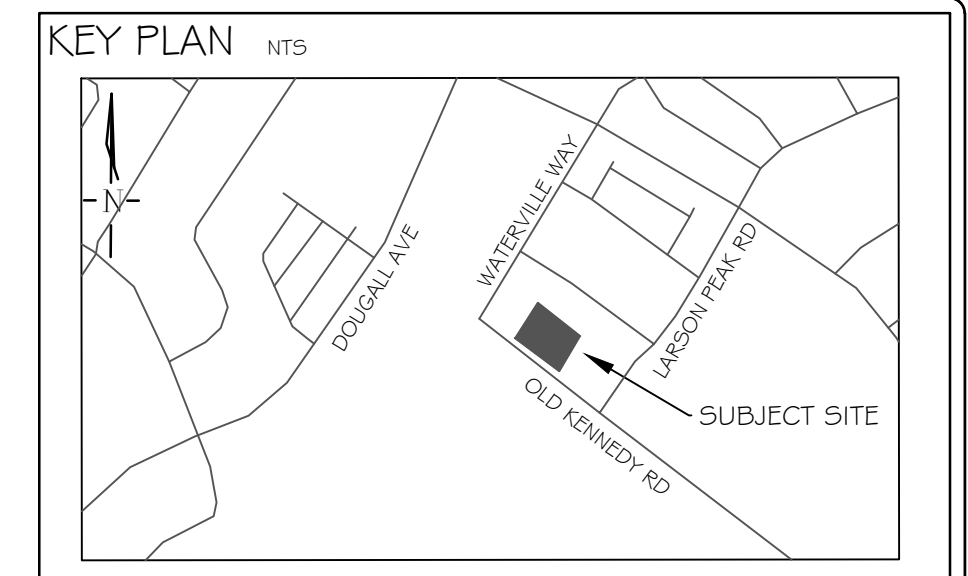

GENERAL NOTES

The Client and its contractors are responsible for all utility locates and confirming all setbacks, elevations, grades, etc. prior to installation of the constructed works.

The Contractor is to report any discrepancies in writing to the Landscape Architect prior to proceeding with the works to determine the impact and suitability of the proposed works. The Landscape Architect will not be responsible for any unapproved adjustments on site.

Construction of the works must conform to Authority requirements and applicable codes where they have jurisdiction.

All specifications and drawings are instruments of service and are the property and ownership of the Landmark Environmental Group Ltd. As such, the drawings shall not be modified or reproduced without the expressed written consent of Landmark Environmental Group Ltd. or they will be considered void. The said drawings are for Site Plan approval only and may require additional detailing prior to tender and construction.

The Landmark Environmental Group Ltd. is not liable for errors or omissions from the use of these drawings prior to approval, seal, signature and date, and will be considered void.

It is advised that the Contractor contact the Landscape Architect prior to commencement of the construction works to ensure that the Contractor has the latest approved drawings.

The Landmark Environmental Group Ltd. is not responsible for the accuracy of the base drawing information (eg Survey, Architectural, Engineering, etc.). If there are any discrepancies, the Contractor will refer to the appropriate base drawing information and report discrepancies to the Landscape Drawings to the Landscape Architect.

© Copyright Landmark Environmental Group Ltd, 2020.

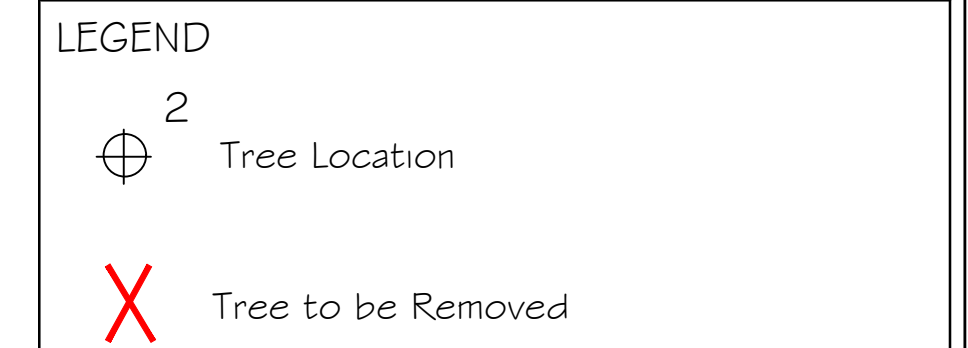

NO.	DATE	BY	REVISIONS

STAMP

APPROVAL

TOWN OF CALEDON

NAME: _____

DATE: _____

SIGNATURE: _____

BASE DATA PROVIDED BY RAM ENGINEERING INC.
(Old Kennedy Rd April 1 for Landscape.dwg)

LANDMARK ENVIRONMENTAL GROUP LTD.

LANDSCAPE ARCHITECTS & CONSULTING ARBORISTS

OFFICE: 705-796-1122

info@LEGroupLtd.com
www.LEGroupLtd.com

CLIENT:

MR. NAVINDER SINGH LAL

PROJECT:

1 2507 OLD KENNEDY RD, CALEDON
CONSENT DEVELOPMENT

DRAWING: ARBOR PLAN

SCALE BAR: 2m 0 2 4 6
Scale = 1:100

PROJECT NO.: LA 499-20	SCALE: 1:100
MUNICIPAL FILE NO.:	DATE: NOV 30-20
DRAWN BY: S.K./J.G	CHECKED BY: J.H
DRAWING No.: L4.0	