

PLANT LIST							
KEY	BOTANICAL NAME	COMMON NAME	SIZE	COND.	SPACING	QTY	COMMENTS
DECIDUOUS TREES							
Ar	Acer rubrum	Red Maple	70mm cal.	N.B.		4	Full form with dominant leader
Asi	Acer saccharinum	Silver Maple	70mm cal.	N.B.		5	Full form with dominant leader
AF	Acer x freemanii 'Jeffersred'	Autumn Blaze Maple	70mm cal.	N.B.		5	Full form with dominant leader
CO	Celtis occidentalis	Hackberry	70mm cal.	N.B.		5	Full form with dominant leader
Gt	Gleditsia triacanthos var. inermis 'Shademaster'	Shademaster Honeylocust	70mm cal.	N.B.		4	Full form with dominant leader
Qr	Quercus rubra	Red Oak	70mm cal.	N.B.		3	Full form with dominant leader
QF	Quercus robur 'Fastigiata'	Pyramidal English Oak	70mm cal.	N.B.		3	Full form with dominant leader
CONIFEROUS TREES							
Li	Larix laricina	American Larch	200cm	N.B.		3	Full form with dominant leader
Pg	Picea glauca	White Spruce	200cm	N.B.		10	Full form with dominant leader
To	Thuja occidentalis	Eastern White Cedar	200cm	N.B.		10	Full form with dominant leader
TOE	Thuja occidentalis 'Emerald'	Emerald Cedar	200cm	N.B.		9	Full form with dominant leader
DECIDUOUS SHRUBS							
Am	Aronia melanocarpa	Black Chokeberry	50cm	3 gal.	1.0m o.c.	31	Full form, minimum 3 stems
Bt	Berberis thunbergii	Royal Burgundy Barberry	50cm	3 gal.	1.0m o.c.	64	Full form, minimum 3 stems
Ca	Cornus stolonifera	Red Osier Dogwood	50cm	3 gal.	1.0m o.c.	33	Full form, minimum 3 stems
Di	Diervilla lonicera	Bush Honeysuckle	50cm	3 gal.	1.0m o.c.	42	Full form, minimum 3 stems
Ph	Physocarpus opulifolius	Common Ninebark	50cm	3 gal.	1.0m o.c.	49	Full form, minimum 3 stems
PO	Physocarpus opulifolius 'Tiny Wine Gold'	Tiny Wine Gold Ninebark	50cm	3 gal.	1.0m o.c.	39	Full form, minimum 3 stems
PV	Prunus virginiana	Chokecherry	50cm	3 gal.	1.0m o.c.	39	Full form, minimum 3 stems
Sc	sambucus canadensis	Common Elderberry	50cm	3 gal.	1.0m o.c.	53	Full form, minimum 3 stems
CONIFEROUS SHRUBS							
Jc	Juniperus chinensis sargentii 'Viridis'	Green Sargent Juniper	50cm	3 gal.	1.5m o.c.	44	Full form, minimum 3 stems
Jh	Juniperus horizontalis 'Turquoise Spreader'	Turquoise Spreader Juniper	50cm	3 gal.	2.0m o.c.	5	Full form, minimum 3 stems
Jv	Juniperus virginiana 'Grey Owl'	Grey Owl Juniper	50cm	3 gal.	1.5m o.c.	23	Full form, minimum 3 stems
Jp	Juniperus x pfitzeriana 'Old Gold'	Old Gold Juniper	50cm	3 gal.	1.0m o.c.	12	Full form, minimum 3 stems
PERENNIALS & GROUNDCOVERS							
hs	Hemerocallis 'Stella D'Oro'	Stella D'Oro Daylily		2 gal.	0.5m o.c.	560	
rf	Rudbeckia fulgida 'Goldsturm'	Black-Eyed Susan		2 gal.	0.5m o.c.	126	
sn	Salvia nemorosa 'May Night'	May Night Meadow Sage		2 gal.	0.5m o.c.	69	
ss	Sedum spectabile 'Autumn Fire'	Autumn Fire Stonecrop		2 gal.	0.5m o.c.	105	

SEED MIX			
KEY	BOTANICAL NAME	COMMON NAME	%
OSC RURAL ONTARIO ROADSIDE NATIVE SEED MIXTURE (8145)			
•••	Aster novae-angliae	New England Aster	2%
•••	Desmodium canadense	Showy Tick Trefoil	3%
•••	Elymus canadensis	Canada Wild Rye	24%
•••	Elymus virginicus	Virginia Wild Rye	22%
•••	Eupatorium perfoliatum	Boneset	1%
•••	Liatris spicata	Dense Blazing Star	1%
•••	Monarda fistulosa	Wild Bergamot	1%
•••	Penstemon digitalis	Foxglove	2%
•••	Rudbeckia hirta	Black Eyed Susan	2%
•••	Schizachyrium scorparium	Little Bluestem	20%
•••	Sorghastrum nutans	Indiangrass	2%
•••	Verbena hastata	Blue Vervain	2%
Cover crop to be Annual Oats Seed and cover crop application rate: 25 kg/ha			

#### LANDSCAPE NOTES

##### 1.0 GENERAL

- THESE SPECIFICATIONS ARE TO BE READ IN CONJUNCTION WITH THE GENERAL CONDITIONS OF THE CONTRACT AS PREPARED BY AND AVAILABLE AT THE OFFICE OF KATIE WARDROP (C.F. CROZIER & ASSOCIATES INC.).
- PRIOR TO COMMENCING WORK, THE CONTRACTOR SHALL:
  - FAMILIARIZE THEMSELVES WITH THE PLANS, DETAILS AND SPECIFICATIONS OF THIS PROJECT;
  - VISIT THE SITE TO ASCERTAIN AND TAKE ACCOUNT OF EXISTING CONDITIONS AND ANY DEVIATIONS FROM THE PLANS IN WORK BY OTHER; AND,
  - FINALIZE ALL DESIGN ALTERNATIVES IN CONSULTATION WITH THE LANDSCAPE ARCHITECT.
- PRIOR TO EXCAVATING THE CONTRACTOR SHALL VERIFY THE LOCATION OF ALL UNDERGROUND UTILITIES. IN THE EVENT OF A CONFLICT BETWEEN A PROPOSED TREE LOCATION AND AN UNDERGROUND SERVICE, THE EXACT LOCATION OF THE TREE SHALL BE DETERMINED ON SITE BY THE LANDSCAPE ARCHITECT. THE CONTRACTOR SHALL, AT HIS/HER OWN EXPENSE, REPAIR ANY DAMAGE TO EXISTING UTILITIES, STRUCTURES, FACILITIES, ETC. DONE IN THE PERFORMANCE OF THEIR WORK.

##### 2.0 SOFT LANDSCAPING PLANT MATERIALS

- ALL PLANTS SHALL BE INSTALLED TRUE TO SPECIFIED NAMES, SIZES, GRADES, ETC. AND SHALL CONFORM TO THE STANDARDS OF THE CANADIAN NURSERY LANDSCAPES ASSOCIATION.
- ALL PLANTS SHALL BE NURSERY GROWN IN A HARDINESS ZONE APPROPRIATE TO SITE CONDITIONS, AS PUBLISHED BY AGRICULTURE CANADA, ENTITLED MAP OF PLANT HARDINESS ZONES IN CANADA.
- IN THE EVENT OF A DISCREPANCY IN PLANT QUANTITY BETWEEN THE LANDSCAPE PLAN AND THE PLANT LIST, THE LANDSCAPE PLAN SHALL GOVERN.
- THE CONTRACTOR SHALL MAKE PLANTS AVAILABLE FOR INSPECTION BY THE LANDSCAPE ARCHITECT PRIOR TO SHIPPING TO THE SITE. THIS DOES NOT LIMIT THE RIGHT OF THE LANDSCAPE ARCHITECT AND/OR TOWN'S REPRESENTATIVE TO LATER REJECT PLANT MATERIAL THAT IS OF POOR QUALITY, DAMAGED DURING SHIPPING OR INSTALLATION, PERFORMING POORLY WHILE THE GUARANTEE PERIOD IS STILL IN EFFECT, OR OTHERWISE DOES NOT CONFORM TO THE SPECIFICATIONS.
- PLANT SUBSTITUTIONS MUST BE APPROVED IN WRITING BY THE LANDSCAPE ARCHITECT PRIOR TO DELIVERY OF THE MATERIAL ON-SITE. THE LANDSCAPE ARCHITECT MAY, UPON COMPLETION OF THE WORK AND NOTWITHSTANDING PRIOR APPROVAL AT SOURCE, REJECT PLANT MATERIAL NOT CONFORMING TO THE SPECIFICATIONS.
- THE CONTRACTOR SHALL USE STANDARD INDUSTRY METHODS FOR PLANTING TREES. TREES SHALL BE TURNED TO GIVE THE BEST APPEARANCE. THEY SHALL ALSO BE GUYED AND STAKED IMMEDIATELY AFTER PLANTING AND AS DETAILED ON THE DRAWINGS.

##### 3.0 BED PREPARATION

- PRIOR TO BACKFILLING, SCARIFY THE SIDES AND BOTTOM OF THE EXCAVATED TREE PITS AND SHRUB BEDS.
- WHERE HEAVY CLAY SOIL CONDITIONS PREVAIL, BACKFILL TO THE SPECIFIED DEPTHS WITH:
  - 2 PARTS "TRIPLE MIX" DELIVERED TO THE SITE WELL-MIXED WITH 1 PART LOCAL TOPSOIL (TOPSOIL THAT HAS REMOVED FROM THE SITE AND STOCKPILED; IF UNAVAILABLE, A TOPSOIL WITH CLAY CONTENT MUST BE IMPORTED)
- TREE PITS MUST BE CONSTRUCTED WITH SAUCERS AND MULCH AS DETAILED.

##### 4.0 MAINTENANCE

- MAINTENANCE OF ALL LANDSCAPE INSTALLATIONS THROUGHOUT TO INCLUDE:
  - PROPER IRRIGATION TO ENSURE OPTIMUM GROWTH AND DEVELOPMENT OF INSTALLED PLANT MATERIAL.
  - CULTIVATION, WEEDING AND FERTILIZATION OF THE TREE PITS AND PLANTING BEDS.
  - INSECT AND DISEASE CONTROL USING "INTEGRATED PEST MANAGEMENT" PRACTICES.
  - PRUNING AND MAINTENANCE TO FURTHER PROMOTE VISIBILITY AND VITALITY OF ITS INTENDED USE, AS DIRECTED BY THE LANDSCAPE ARCHITECT OR THE TOWN.

##### 5.0 GUARANTEE

- ALL PLANT MATERIALS SHALL BE GUARANTEED FOR A MINIMUM OF 1 YEAR FROM DATE OF WRITTEN LANDSCAPE CERTIFICATION FOR COMMENCEMENT OF PLANT WARRANTY AS GRANTED BY THE TOWN, AND UNTIL FINAL CERTIFICATION IS GRANTED BY THE TOWN. PLANTS WHICH DO NOT SURVIVE SATISFACTORILY DURING THE GUARANTEE PERIOD SHALL BE REPLACED AT NO EXTRA COST TO THE OWNER. PLANT MATERIAL WHICH IS REPLACED DUE TO UNSATISFACTORY PERFORMANCE SHALL, IN TURN, BE GUARANTEED FOR ANOTHER MINIMUM OF 1 YEAR, OR UNTIL FINAL CERTIFICATION IS GRANTED BY THE TOWN.
- SIMILARLY, ALL OTHER LANDSCAPE WORK PERFORMED UNDER THIS CONTRACT SHALL BE FULLY GUARANTEED FOR THE ABOVE SPECIFIED PERIOD.
- ALL WORK SHALL BE INSPECTED AT THE END OF THE WARRANTY PERIOD, AT WHICH TIME A FINAL CERTIFICATE WILL BE ISSUED BY THE LANDSCAPE ARCHITECT AND SUBMITTED TO THE TOWN FOR THEIR INSPECTION, AND APPROVAL OF FINAL CERTIFICATION, PERMITTING RELEASE OF SITE WORK SECURITIES.
- AT THE END OF THE GUARANTEE PERIOD, THE CONTRACTOR SHALL REMOVE ALL TREE STAKES, RODENT GUARDS AND BARK WRAP AND ALL EXTRA MULCH WHERE NECESSARY.

##### 6.0 ACCEPTANCE

- WORK WILL BE ACCEPTED BY THE OWNER OR THEIR REPRESENTATIVE UPON COMPLETION AND AT THE END OF THE SPECIFIED MAINTENANCE PERIOD, PROVIDED THAT ALL PLANT MATERIAL IS ALIVE AND IN HEALTHY GROWING CONDITIONS.
- WRITTEN PRELIMINARY AND FINAL CERTIFICATION MUST BE SUBMITTED TO THE TOWN BY THE LANDSCAPE ARCHITECT. THE CERTIFICATIONS SHALL BE SIGNED AND STAMPED WITH THE SEAL OF THE OALA.
- PRELIMINARY CERTIFICATION OF THE PROJECT SHALL SERVE AS THE START OF THE GUARANTEE PERIOD.
- FINAL ACCEPTANCE OF THE LANDSCAPE WORKS FOR THIS PROJECT IS GRANTED BY THE TOWN OF CALEDON UPON CONDUCTING A SATISFACTORY FINAL SITE INSPECTION

##### 7.0 CONTINUED RESPONSIBILITY OF THE OWNER

- THE OWNER HAS A RESPONSIBILITY TO MAINTAIN THE APPROVED LANDSCAPE IN A WELL CARED FOR MANNER THAT PROMOTES PLANT VITALITY AND HEALTHY APPEARANCE. ANY DECLINING OR DEAD PLANTS ARE TO BE REPLACED WITHIN THE SEASON TO SUSTAIN A KEPT LANDSCAPE. THE OWNER IS REMINDED THAT FUTURE SITE PLAN APPLICATIONS FOR THIS SITE WILL BE REVIEWED WITH REGARD TO THE CONFORMITY OF THE EXISTING LANDSCAPING TO THE APPROVED LANDSCAPE PLAN REGISTERED WITH THE TOWN OF CALEDON.

#### NOTES:

- BOULDER SHALL BE ROUNDED CAP LIMESTONE ROCKERY, SUPPLIED BY MAXWELL'S LANDSCAPE & MASONRY SUPPLY (705.448.0111) OR APPROVED EQUAL.
- BOULDER SIZE SHALL BE IN ACCORDANCE TO SCALE DEPICTED ON LANDSCAPE PLANS.
- STONE TO BE APPROVED BY THE LANDSCAPE ARCHITECT PRIOR TO INSTALLATION.

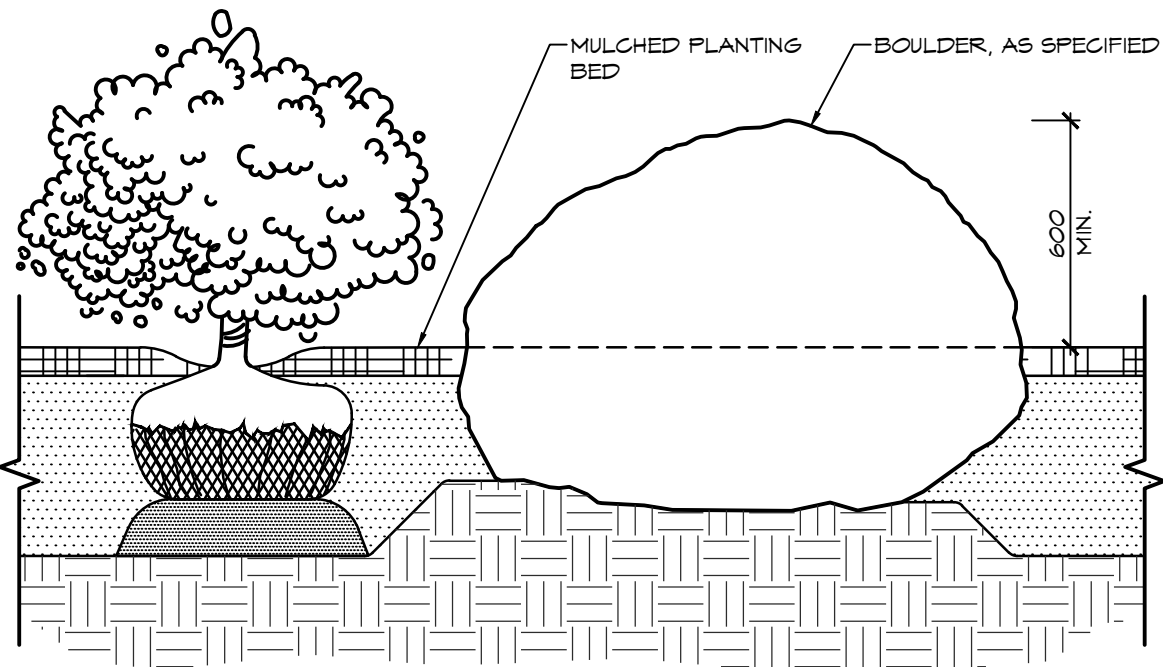

1 LANDSCAPE BOULDER

1:20

### MBR-2900-00001 BIKE RACK

**Sustainability Facts**

Net Size	One (1) MBR-2900-00001 Bike Rack
Carbon Footprint (GWP)	13 kg CO2-Eq
Measured in kilograms of carbon dioxide equivalent	
Total energy use (TPE)	2080 MJ-Eq
Measured in megajoules of energy equivalent	
Water use (WUP)	0.961 m3 water
Measured in cubic metres of water	
Material recyclability	100%
LEED v4.1 Credits	
Type III Environmental Product Declaration	
Material Inventory	
Low VOC finishes	
Free of Red List substances	
Maglin has been made by these materials	
https://www.maglin.com/maglin/	

DESCRIPTION: 2900 Series - MUG Bike Rack: Steel Frame, Surface Mount, 2 Bike Configuration

FINISH: All steel components are protected with E-Coat rust proofing. The Maglin Powdercoat System provides a durable finish on all metal surfaces.

INSTALLATION: The bike rack is delivered pre-assembled. The bike rack comes standard as a surface mount using 2 holes (9/16") for securing the base.

TO SPECIFY: Select MBR-2900-00001  
Choose:  
- Powdercoat Color

HEIGHT: 37 1/2" (95.3cm) LENGTH: 9" (22.9cm) DEPTH: 4 1/2" (11.4cm) WEIGHT: 50.25lbs (22.8kg)

**MAGLIN** Site Furniture  
1 800 776 5008  
4377 265 8993  
www.maglin.com  
sales@maglin.com

All drawings, specifications, design and details on this page remain the property of Maglin Site Furniture Inc. and may not be used without Maglin authorization.  
Details and specifications may vary due to continuing improvements of our products.

2 BICYCLE RACK

NTS.

### DECIDUOUS TREE PLANTING

NOTES:

- WILT/PROOF IN NURSERY PRIOR TO DELIVERY.
- PRUNING SHALL BE LIMITED TO DEAD, DISEASED OR BROKEN BRANCHES AFTER PLANTING. MAINTAIN ORIGINAL SHAPE OF THE TREE. DO NOT TRIM LEADER BRANCH.
- SET TOP OF ROOT BALL 75-100mm HIGHER THAN ADJACENT FINISHED GRADE TO ALLOW FOR SETTLEMENT.

NTS

TOWN OF CALEDON				APRD: B.B.	DATE: JUNE 08
2	STANDARD No. 700 NOW 800	JAN 18	DRAWN: abal	SCALE: NTS	
1	STANDARD No. 1100 NOW 700	JUNE 08			
NO.	REVISION	APRD	DATE	STANDARD No. 800	

3 DECIDUOUS TREE PLANTING

NTS

- THIS DRAWING IS THE EXCLUSIVE PROPERTY OF C.F. CROZIER & ASSOCIATES INC. AND THE REPRODUCTION OF ANY PART WITHOUT PRIOR WRITTEN CONSENT OF THIS OFFICE IS STRICTLY PROHIBITED.
- THE CONTRACTOR SHALL VERIFY ALL DIMENSIONS, LEVELS, AND DATUMS ON SITE AND REPORT ANY DISCREPANCIES OR OMISSIONS TO THIS OFFICE PRIOR TO CONSTRUCTION.
- THIS DRAWING IS TO BE READ AND UNDERSTOOD IN CONJUNCTION WITH ALL OTHER PLANS AND DOCUMENTS APPLICABLE TO THIS PROJECT.
- DO NOT SCALE THE DRAWINGS.
- ALL EXISTING UNDERGROUND UTILITIES TO BE VERIFIED IN THE FIELD BY THE CONTRACTOR PRIOR TO CONSTRUCTION.

- NOTES:
- ALL DIMENSION ARE IN MILLIMETERS UNLESS OTHERWISE NOTED.

Town

No.	ISSUE / REVISION	DATE: MM/DD/YYYY	STAMP
1	ISSUED FOR CLIENT REVIEW	01/20/2020	
2	ISSUED FOR APPROVAL	10/20/2020	
3	ISSUED FOR 2ND SUBMISSION	08/25/2021	
4	ISSUED FOR 3RD SUBMISSION	02/18/2022	
5	ISSUED FOR 4TH SUBMISSION	06/20/2022	



Project

12476 HIGHWAY 50  
TOWN OF BOLTON, ON  
SPA-2020-0044

Drawing

LANDSCAPE DETAILS



ADMIRAL BUILDING  
1 FIRST STREET, SUITE 200  
COLLINGWOOD, ON, L9Y 1A1  
705 446-3510 T  
705 446-3520 F  
WWW.CFCROZIER.CA  
INFO@CFCROZIER.CA

Drawn By	P.R.	Design By	K.N.	Project	1716-5554
Check By	K.N.	Check By		Scale	AS SHOWN
				Drawing	LD-1