

LEGEND

FFE=XXXX

FINISH FLOOR ELEVATION

NEW STORM MANHOLE

NEW SANITARY MANHOLE

NEW CATCHBASIN MANHOLE

EX. STORM MANHOLE

EX. SANITARY MANHOLE

NEW CATCH BASIN

EX. CATCH BASIN

NEW WATER VALVE

EX. WATER VALVE

BACKFLOW PREVENTOR

WATER METER

NEW FIRE HYDRANT

EX. FIRE HYDRANT

OVERLAND FLOW PATH

RETAINING WALL

DRAINAGE BOUNDARY

SUB-CATCHMENT BOUNDARY

DRAINAGE AREA #

SIAMISE CONNECTION

EX. SANITARY SEWER

EX. STORM SEWER

EX. WATERMAN

NEW STORM SEWER

NEW SANITARY SEWER

NEW WATERMAIN

SILT FENCE PER TRCA DWG No.03

SILT FENCE PER DETAIL ON CROZIER DRAWING ES-1

CHAIN LINK FENCE (CLF)

SILT/STOX

ROAD, CURB, SIDEWALK & BOULEVARD RESTORATION AS PER ROP STANDARDS

PROPOSED REGULATORY FLOODLINE (FROM CROZIER DESIGN DRAWINGS)

NO PORTION OF THE WORK SHALL BE CARRIED OUT WITHOUT FIRST HAVING OBTAINED APPROVED CONSTRUCTION DRAWINGS, APPROVED PROJECT SCHEDULE(S), APPROVED TRAFFIC STAGING PLANS AND PERMITS FOR SUCH PORTION OF THE INFRASTRUCTURE WORK IN ACCORDANCE WITH THE PROVISIONS HEREOF AND GIVING TO WORKING DAYS PRIOR WRITTEN NOTICE TO THE EXECUTIVE DIRECTOR, ENGINEERING AND CONSTRUCTION SERVICES THAT SUCH WORK IS TO BE CARRIED OUT WITH SUCH NOTICE TO SPECIFY THE ANTICIPATED DATE OF COMMENCEMENT OF THE WORK. A PRE-CONSTRUCTION COORDINATION MEETING WITH THE CITY AND GTA STAFF IS TO BE HELD A MINIMUM OF FIVE WORKING DAYS PRIOR TO THE COMMENCEMENT OF ANY OF THE WORK.

TOWN OF CALEDON PLANNING RECEIVED
January 31, 2023

- GENERAL NOTES**
- PRIOR TO STARTING ANY WORKS, THE CONTRACTOR MUST ENSURE THAT ALL NECESSARY APPROVALS ARE IN PLACE FROM THE TOWN OF CALEDON, REGION OF PEE, CONSERVATION AUTHORITY AND ALL OTHER EXTERNAL AGENCIES, AS REQUIRED.
 - THIS DRAWING CONSTITUTE PART OF THE DESIGN DOCUMENTS PREPARED FOR THE PROJECT PROPOSAL KNOWN AS "PROPOSED SIKE TEMPLE".
 - ALL THE NOTES AND DETAILS PROVIDED ON DRAWINGS "SG-1" AND "SS-1" SHALL APPLY IN FULL.
- TOWN OF CALEDON EROSION AND SEDIMENT CONTROL NOTES**
- ALL CONTROL MEASURES MUST CORRESPOND TO THE LATEST EROSION AND SEDIMENT CONTROL STANDARDS PROVIDED BY THE TOWN OF CALEDON, THE REGION OF PEE, AND THE CONSERVATION AUTHORITY.
 - ALL EROSION AND SEDIMENT CONTROL (ESC) MEASURES MUST BE INSTALLED PRIOR TO THE COMMENCEMENT OF WORKS ON SITE AND SHALL BE MAINTAINED DURING ALL CONSTRUCTION PHASES OF THE WORKS.
 - THE ESC STRATEGIES OUTLINED ON THIS PLAN ARE NOT STATIC AND MAY NEED TO BE UPGRADED/AMENDED AS SITE CONDITIONS CHANGE TO PREVENT SEDIMENT RELEASE OUTSIDE THE WORK AREA. THE TOWN IS TO BE ADVISED OF ANY CHANGES TO ESC MEASURES, AND AT THE DISCRETION OF THE TOWN, UPDATED PLANS MAY BE REQUIRED.
 - THE CONTRACTOR IS TO ASSIGN AN ENVIRONMENTAL MONITOR (EM) TO ASSURE CONSTRUCTION ACTIVITIES COMPLY WITH THE ENVIRONMENTAL PROVISIONS AND AGENCY PERMITS. THE EM WILL BE A QUALIFIED PERSON AS DETERMINED BY THE TOWN AND/OR CONSERVATION AUTHORITY. THE EM SHOULD SUBMIT INSPECTION FORMS ELECTRONICALLY TO THE TOWN AND CONSERVATION AUTHORITY UPON REQUEST.
 - THE CONTRACTOR IS RESPONSIBLE FOR MAINTAINING ALL ESC MEASURES IN WORKING CONDITION AT ALL TIMES TO THE SATISFACTION OF THE TOWN AND/OR CONSERVATION AUTHORITY. ALL DAMAGED ESC MEASURES SHOULD BE REPAIRED AND/OR REPLACED WITHIN 48 HOURS OF THE INSPECTION.
 - THE CONTRACTOR SHALL ROUTINELY INSPECT ALL ESC DEVICES TO ENSURE PROPER WORKING ORDER. FREQUENCY OF INSPECTIONS OF ESC MEASURES IS AS FOLLOWS:
DURING EARTHWORKS ACTIVITIES:
 - ON A WEEKLY BASIS;
 - PRIOR TO PREDICTED RAINFALL EVENTS;
 - AFTER EVERY RAINFALL EVENT;
 - AFTER SIGNIFICANT SNOWMELT EVENT; AND
 - DAILY DURING EXTENDED RAIN OR SNOWMELT PERIODS.DURING TIMES OF NO EARTHWORKS ACTIVITY:
 - ONCE EVERY 2 WEEKS;
 - AFTER SIGNIFICANT SNOWMELT EVENTS;
 - AFTER SIGNIFICANT RAINFALL EVENTS (MORE THAN 25MM OF RAINFALL IN A 24 HOUR PERIOD).
 - ALL CONSTRUCTION VEHICLES MUST ENTER AND EXIT THE SITE ONLY FROM THE APPROVED ACCESS ROUTE(S) AS SHOWN ON THE PLANS. CONSTRUCTION ACCESS WILL BE MAINTAINED TO THE SATISFACTION OF THE TOWN/REGION. STREET SWEEPING IS REQUIRED AS NEEDED.
 - NO CONSTRUCTION ACTIVITY OR MACHINERY SHALL BE ALLOWED BEYOND THE SILT FENCE OR LIMITS OF THE SITE WORKS.
 - THE CONTRACTOR IS RESPONSIBLE TO IMPLEMENT DUST CONTROL MEASURES AND CONSTRUCTION BEST PRACTICE GUIDELINES AS APPROVED BY THE TOWN AND/OR CONSERVATION AUTHORITY.
 - ALL DISTURBED GROUND LEFT INACTIVE FOR 30 DAYS SHALL BE VEGETATED, SUBJECT TO WEATHER CONDITIONS. DISTURBED AREAS ARE TO BE HYDROSEED (OR APPROVED EQUIVALENT) TO THE SATISFACTION OF THE TOWN.
 - ALL EXCAVATED SOIL INCLUDING STRIPPED TOPSOIL SHALL BE REMOVED OFFSITE. NO STOCK PILE SHALL BE ALLOWED WITHIN THE DEVELOPMENT SITE.
 - CONTRACTOR SHALL TAKE CARE AND CONTROL SPILLS, FLUIDS AND MATERIALS DURING CONSTRUCTION TO MINIMIZE RISK TO THE ENVIRONMENT.
 - NO WASHOUT STATION WILL BE PERMITTED WITHIN THE DEVELOPMENT SITE.

- TRCA STANDARD NOTES**
- EROSION AND SEDIMENT CONTROL(ESC) MEASURES WILL BE IMPLEMENTED PRIOR TO, AND MAINTAINED DURING THE CONSTRUCTION PHASES, TO PREVENT ENTRY OF SEDIMENT INTO THE WATER. ALL DAMAGED EROSION AND SEDIMENT CONTROL MEASURES SHOULD BE REPAIRED AND/OR REPLACED WITHIN 48 HOURS OF THE INSPECTION.
 - DISTURBED AREAS WILL BE MINIMIZED TO THE EXTENT POSSIBLE, AND TEMPORARILY OR PERMANENTLY STABILIZED OR RESTORED AS THE WORK PROGRESS.
 - THE ESC STRATEGIES OUTLINED ON THE PLANS ARE NOT STATIC AND MAY NEED TO BE UPGRADED/AMENDED AS SITE CONDITIONS CHANGE TO PREVENT SEDIMENT LAID RUNOFF FROM LEAVING THE WORK AREAS. IF THE PRESCRIBED MEASURES ON THE PLANS ARE NOT EFFECTIVE IN PREVENTING THE RELEASE OF A DELETERIOUS SUBSTANCE, INCLUDING SEDIMENT, THEN ALTERNATIVE MEASURES MUST BE IMPLEMENTED IMMEDIATELY TO MINIMIZE POTENTIAL ECOLOGICAL IMPACTS. TRCA ENFORCEMENT OFFICER SHOULD BE IMMEDIATELY CONTACTED. ADDITIONAL ESC MEASURES TO BE KEPT ON SITE AND USED AS NECESSARY.
 - ALL GRADES WITHIN THE REGULATORY FLOOD PLAN WILL BE MAINTAINED OR MATCHED.
 - THE PROPONENT/CONTRACTOR SHALL MONITOR THE WEATHER SEVERAL DAYS IN ADVANCE OF THE ONSET OF THE PROJECT TO ENSURE THAT THE WORKS WILL BE CONDUCTED DURING FAVOURABLE WEATHER CONDITIONS. SHOULD AN UNEXPECTED STORM ARISE, THE CONTRACTOR WILL REMOVE ALL UNFIXED ITEMS FROM THE REGIONAL STORM FLOOD PLAN THAT WOULD HAVE THE POTENTIAL TO CAUSE A SPILL, OR AN OBSTRUCTION TO FLOW (e.g. FUEL TANKS, POTS/POTTIES, MACHINERY, EQUIPMENT, CONSTRUCTION MATERIAL, etc.
 - ALL DRAINAGE/UNWATERING SHALL BE TREATED AND RELEASED TO THE ENVIRONMENT AT LEAST 30m FROM A WATERCOURSE OR WETLAND AND ALLOWED TO DRAIN THROUGH A WELL-VEGETATED AREA. NO DRAINAGE EFFLUENT SHALL BE SENT DIRECTLY TO ANY WATERCOURSE, WETLAND OR FOREST, OR ALLOWED TO DRAIN INTO DISTURBED SOILS WITHIN THE WORK AREA. THESE CONTROL MEASURES SHALL BE MONITORED FOR EFFECTIVENESS AND MAINTAINED OR REVISED TO MEET THE OBJECTIVE OF PREVENTING THE RELEASE OF SEDIMENT LAIDEN WATER.
 - PLEASE NOTIFY TRCA ENFORCEMENT OFFICER (XXX AT 416-XXX-XXX CELL) AND PROJECT MANAGER (416-661-6600 X XXX) 48 HOURS PRIOR TO COMMENSING CONSTRUCTION.

INTERCEPTOR SWALE DETAIL (N.T.S.)

NOTE:

- SWALE SHALL BE STABILIZED USING SOD.
- DISCHARGE SHOULD ONLY BE DIRECTED TO SWALES ONCE THEY ARE DEEMED STABILIZED.

MUD MAT DETAIL (N.T.S.)

NOTE:

- MUD MAT TO BE INSTALLED AT THE TEMPORARY CONSTRUCTION ACCESS LOCATION.
- EXACT LOCATION OF TEMPORARY CONSTRUCTION ACCESS WILL BE FINALIZED ON SITE AFTER APPOINTMENT OF CONTRACTOR AND PER INSTRUCTION OF THE CITY INSPECTOR.

ADDITIONAL EROSION AND SEDIMENT CONTROL

- NON WOVEN FILTER CLOTH TO BE PLACED UNDER GRATES ON ALL CATCHBASINS TO TRAP SEDIMENT. SILT TRAPS ARE TO BE CLEANED REGULARLY AND ARE NOT TO BE REMOVED UNTIL SUCH TIME AS THE CURBS ARE CONSTRUCTED AND THE BOULEVARDS ARE SODDED OR BACKWARDS GRADED AND SODDED.
- NON WOVEN FILTER CLOTH WILL BE PLACED ON THE CATCHBASINS ON PUBLIC STREET ACROSS THE PROPERTY'S FRONTAGE.
- STREET SWEEPING, CATCH BASIN CLEANING AND DUST CONTROL ARE THE RESPONSIBILITY OF THE CONTRACTOR AND MUST BE KEPT UNDER CONTROL ON ALL ROADWAYS TO THE SATISFACTION OF THE CITY/TOWN/REGION.
- CONTRACTOR IS RESPONSIBLE TO PROVIDE TEMPORARY DITCHES AND OVERLAND FLOW PATHS DURING AND AFTER CONSTRUCTION ALONG ALL PROPERTY LINES WITH POSITIVE SLOPE TOWARDS THE SAFE OUTLET LOCATION. CONTRACTOR IS SOLELY RESPONSIBLE FOR MAINTAINING THIS DITCHES IN PROPER WORKING CONDITION AT ALL TIMES DURING CONSTRUCTION. CONTRACTOR IS TO RESTRICT RUNOFF FROM ENTERING INTO THE ADJOINING PROPERTIES AND ALL REPAIRS AND CONSEQUENCES RESULTING FROM DAMAGE TO THE ADJOINING PROPERTIES.

SEED NOTES

- BUFFER AREA TO BE SEEDDED WITH A "TABLELAND GRASS MIXTURE", AND MADE UP OF THE FOLLOWING:
 - 22% BIG BLUESTEM (ANDROPOGON GERARDII)
 - 5% LITTLE BLUESTEM (ANDROPOGON SCOPARIUS)
 - 20% CANADA WILD RYE (ELYMUS CANADENSIS)
 - 24% SWITCHGRASS (PANICUM VIRGATUM)
 - 15% INDIANGRASS (SORGHOTRITON NUTANS)
 - 4% PRAIRIE CORD GRASS (SPARTINA PECTINATA)
 - 10% SAND DROPSIDE (SPOROBOOLUS CRYPTANDRUS)

CONSTRUCTION SEQUENCE

- INSTALLATION OF THE SILT FENCES PRIOR TO ANY OTHER ACTIVITIES ON THE SITE.
- CONSTRUCTION OF TEMPORARY MUD MATS AT ALL CONSTRUCTION ACCESS.
- PRE-GRADING OF SITE AREA.
- CONSTRUCTION OF TEMPORARY SWALES, SEEDING AND INSTALLATION OF OTHER ESC MEASURES LIKE DITCHCHECK.
- INSTALLATION OF SITE SERVICING AND UNDERGROUND UTILITIES.
- CONSTRUCTION OF BUILDING FOUNDATIONS AND DISPOSAL OF ALL THE SURPLUS EXCAVATED MATERIALS OFF SITE.
- CONSTRUCTION OF BUILDING, PARKING LOT AND DRIVEWAYS.
- RESTORATION / RE-VEGETATION OF DISTURBED AREAS EITHER WITH TEMPORARY MEASURES SUCH AS MULCH OR SEEDING OR WITH FINAL LANDSCAPE AND PAVING.
- REMOVAL OF THE SEDIMENT CONTROLS FOLLOWING STABILIZATION OF DISTURBED AREAS.

CATCHBASIN SEDIMENT TRAP (LANDSCAPE SURFACE) (N.T.S.)

NOTE:

- SILTATION BARRIERS TO BE INSTALLED AROUND ALL CATCHBASINS DURING CONSTRUCTION. SILT BARRIERS TO BE MAINTAINED UNTIL COMPLETION OF SITE WORK.
- TO BE INSPECTED WEEKLY AND AFTER EVERY RAINFALL. SILT TO BE REMOVED AND SACK CLEANED AS REQUIRED.

CATCHBASIN SEDIMENT TRAP (ON HARD SURFACE) (N.T.S.)

TRCA ESC DESIGN DETAIL

SEDIMENT FENCE (UNFROZEN CONDITIONS)

NOTE: THIS DETAIL REPRESENTS AN IDEAL SCENARIO. SITE CONDITIONS VARY AND EROSION AND SEDIMENT CONTROL MEASURES SHOULD BE TAILORED FOR EACH SITE AND PROJECT.

SCALE: N.T.S. REV: 1 DATE: MARCH 2018

DWG NO: 03

PERSPECTIVE VIEW

PLAN VIEW

SECTION VIEW

NOTE: THIS DETAIL REPRESENTS AN IDEAL SCENARIO. SITE CONDITIONS VARY AND EROSION AND SEDIMENT CONTROL MEASURES SHOULD BE TAILORED FOR EACH SITE AND PROJECT.

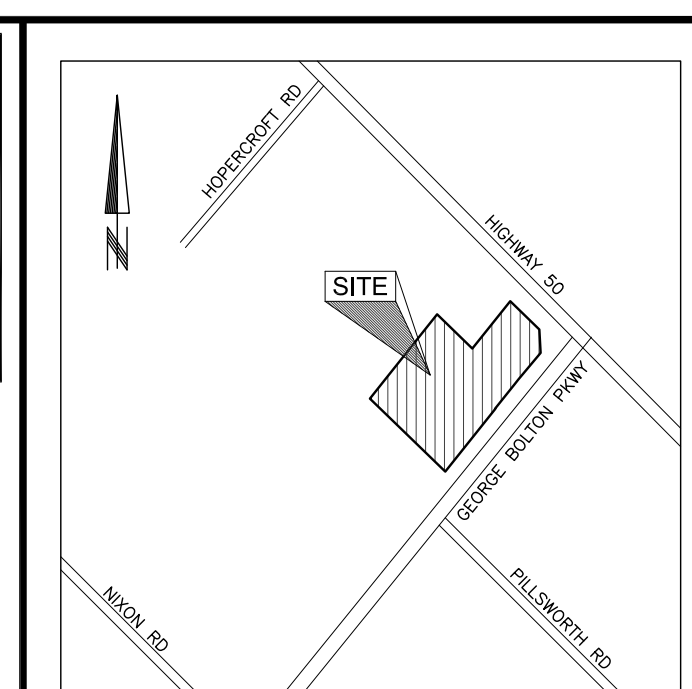

DATE	DESCRIPTION	CHECKED BY
JAN 29, 2023	ISSUED FOR 4th SITE PLAN APPLICATION CIRCULATION	4. CP
MAR 03, 2022	ISSUED FOR 3rd SITE PLAN APPLICATION CIRCULATION	3. CP
AUG 25, 2021	ISSUED FOR 2nd SITE PLAN APPLICATION CIRCULATION	2. CP
SEP 21, 2020	ISSUED FOR SITE PLAN APPLICATION	1. CP

NOTE: Contractor is to check and verify all dimensions and conditions on the project, and is immediately report any discrepancies to the Architect and Engineer before proceeding with the work.

FLORA DESIGNS INC.
Complete civil engineering design solutions

1109 BRITANNIA ROAD EAST
MISSISSAUGA, ON L4W 3Y1
PH: (647) 996-8055 www.floradesigns.net

PROJECT:
PROPOSED MARRIOTT HOTEL

12476 HIGHWAY 50, CALEDON, ON

DRAWING TITLE:
EROSION AND SEDIMENT CONTROL PLAN

JOB NUMBER: FD-020398
Drawn By: YG
Scale: AS NOTED
CHECKED BY: CF
SHEET NUMBER: ESC-11

(36x24) (ARCH-D)