

OBC MATRIX

| NAME OF PRACTICE: WARE MALCOMB (A BUSINESS NAME OF WMA INC.) CERTIFICATE OF PRACTICE NUMBER: 3619 NAME OF PROJECT: LIVINGSTON INDUSTRIAL LOCATION: 12304 HEART LAKE ROAD, CALEDON, ON | |  | | | | | | | | | | | | | | | | | | | | | | | | | | | | | | | | | | | | | | | | | | | | | | | | | | | | | | | | |
|--|--|--|---|------------------------------|------------------------|------------------------------|-------------------------------|---------------|-------------------------------|------------------------|------------------------------|------------------------|-------|----------|-------|---|------|------|---|---|---|---|---|-------|----------|-------|---|------|------|---|---|---|---|---|------|--------|-------|---|-----|-----|------|------------------------|---|---|---|------|--------|-------|---|------|------|---|---|---|---|---|--|--|
| BUILDING CODE REFERENCE: REFERENCES ARE TO DIVISION B UNLESS NOTED. (A) FOR DIVISION A OR (C) FOR DIVISION C. | | | | | | | | | | | | | | | | | | | | | | | | | | | | | | | | | | | | | | | | | | | | | | | | | | | | | | | | | | |
| ITEM | ONTARIO BUILDING CODE DATA MATRIX PARTS 3 OR 9 | | | | | | | | | | | | | | | | | | | | | | | | | | | | | | | | | | | | | | | | | | | | | | | | | | | | | | | | | |
| 1 | PROJECT DESCRIPTION: <input checked="" type="checkbox"/> NEW <input type="checkbox"/> PART 11 <input type="checkbox"/> PART 3 <input type="checkbox"/> PART 9 INDUSTRIAL WAREHOUSE <input type="checkbox"/> CHANGE OF USE <input type="checkbox"/> ADDITION <input type="checkbox"/> ALTERATION 11.1 TO 11.4 1.1.2 (A) 1.1.2 (A) & 9.10.1.3 | | | | | | | | | | | | | | | | | | | | | | | | | | | | | | | | | | | | | | | | | | | | | | | | | | | | | | | | | |
| 2 | MAJOR OCCUPANCY(S) GROUP F - DIVISION 2 | 3.1.2.1.(1) | 9.10.2 | | | | | | | | | | | | | | | | | | | | | | | | | | | | | | | | | | | | | | | | | | | | | | | | | | | | | | | |
| 3 | BUILDING AREA (sq.m.) NEW: 48,647.30m² TOTAL: 48,647.30m² | 1.4.1.2 (A) | 1.4.1.2 (A) | | | | | | | | | | | | | | | | | | | | | | | | | | | | | | | | | | | | | | | | | | | | | | | | | | | | | | | |
| 4 | GROSS AREA (sq.m.) NEW: 48,647.30m² TOTAL: 48,647.30m² | 1.4.1.2 (A) | 1.4.1.2 (A) | | | | | | | | | | | | | | | | | | | | | | | | | | | | | | | | | | | | | | | | | | | | | | | | | | | | | | | |
| 5 | NUMBER OF STOREYS ABOVE GRADE: 1 BELOW GRADE: XX | 1.4.1.2 (A) & 3.2.1.1 | 1.4.1.2 (A) & 9.10.4 | | | | | | | | | | | | | | | | | | | | | | | | | | | | | | | | | | | | | | | | | | | | | | | | | | | | | | | |
| 6 | NUMBER OF STREETS / FIRE FIGHTER ACCESS: 3 | 3.2.2.10 & 3.2.5.5 | 9.10.20 | | | | | | | | | | | | | | | | | | | | | | | | | | | | | | | | | | | | | | | | | | | | | | | | | | | | | | | |
| 7 | BUILDING CLASSIFICATION(S) 3.2.2.67 GROUP F, DIVISION 2, ANY HEIGHT, ANY AREA, SPRINKLERED | 3.2.2.20-83 | 9.10.2 | | | | | | | | | | | | | | | | | | | | | | | | | | | | | | | | | | | | | | | | | | | | | | | | | | | | | | | |
| 8 | SPRINKLER SYSTEM PROPOSED <input checked="" type="checkbox"/> ENTIRE BUILDING <input type="checkbox"/> SELECTED COMPARTMENTS <input type="checkbox"/> SELECTED FLOOR AREAS <input type="checkbox"/> BASEMENT <input type="checkbox"/> IN LIEU OF ROOF RATING <input type="checkbox"/> NOT REQUIRED | 3.2.2.20-83 3.2.1.5 3.2.2.17 INDEX | 9.10.8.2 INDEX | | | | | | | | | | | | | | | | | | | | | | | | | | | | | | | | | | | | | | | | | | | | | | | | | | | | | | | |
| 9 | STANDPIPE REQUIRED <input type="checkbox"/> YES <input checked="" type="checkbox"/> NO | 3.2.9 | N/A | | | | | | | | | | | | | | | | | | | | | | | | | | | | | | | | | | | | | | | | | | | | | | | | | | | | | | | |
| 10 | FIRE ALARM REQUIRED <input type="checkbox"/> YES <input checked="" type="checkbox"/> NO | 3.2.4 | 9.10.18 | | | | | | | | | | | | | | | | | | | | | | | | | | | | | | | | | | | | | | | | | | | | | | | | | | | | | | | |
| 11 | WATER SERVICE / SUPPLY IS ADEQUATE <input checked="" type="checkbox"/> YES <input type="checkbox"/> NO <input type="checkbox"/> N/A | 3.2.5.7 | N/A | | | | | | | | | | | | | | | | | | | | | | | | | | | | | | | | | | | | | | | | | | | | | | | | | | | | | | | |
| 12 | HIGH BUILDING <input type="checkbox"/> YES <input checked="" type="checkbox"/> NO | 3.2.6 | N/A | | | | | | | | | | | | | | | | | | | | | | | | | | | | | | | | | | | | | | | | | | | | | | | | | | | | | | | |
| 13 | CONSTRUCTION RESTRICTIONS <input type="checkbox"/> COMBUSTIBLE PERMITTED <input checked="" type="checkbox"/> NON-COMBUSTIBLE REQUIRED <input type="checkbox"/> BOTH ACTUAL CONSTRUCTION <input type="checkbox"/> COMBUSTIBLE <input checked="" type="checkbox"/> NON-COMBUSTIBLE <input type="checkbox"/> BOTH | 3.2.2.20-83 | 9.10.6 | | | | | | | | | | | | | | | | | | | | | | | | | | | | | | | | | | | | | | | | | | | | | | | | | | | | | | | |
| 14 | MEZZANINE(S) AREA m2 XX | 3.2.1.1.(3)-(8) | 9.10.4.1 | | | | | | | | | | | | | | | | | | | | | | | | | | | | | | | | | | | | | | | | | | | | | | | | | | | | | | | |
| 15 | OCCUPANT LOAD BASED ON <input type="checkbox"/> m2 / PERSON <input checked="" type="checkbox"/> DESIGN OF BUILDING 1ST FLOOR: XX OCCUPANCY: F2 LOAD (PERSONS): <300 | 3.1.17 | 9.9.1.3 | | | | | | | | | | | | | | | | | | | | | | | | | | | | | | | | | | | | | | | | | | | | | | | | | | | | | | | |
| 16 | BARRIER-FREE DESIGN <input checked="" type="checkbox"/> YES <input type="checkbox"/> NO | 3.8 | 9.5.2 | | | | | | | | | | | | | | | | | | | | | | | | | | | | | | | | | | | | | | | | | | | | | | | | | | | | | | | |
| 17 | HAZARDOUS SUBSTANCES <input type="checkbox"/> YES <input checked="" type="checkbox"/> NO | 3.3.1.2 & 3.3.1.19 | 9.10.1.3 (4) | | | | | | | | | | | | | | | | | | | | | | | | | | | | | | | | | | | | | | | | | | | | | | | | | | | | | | | |
| 18 | REQUIRED FIRE RESISTANCE RATING (FRR) HORIZONTAL ASSEMBLIES FRR (HOURS) FLOORS: 2 HOURS ROOF: N/A HOURS MEZZANINE: 1 HOURS FRR OF SUPPORTING MEMBERS FLOORS: 2 HOURS ROOF: N/A HOURS MEZZANINE: 1 HOURS | LISTED DESIGN No. OR DESCRIPTION (SG-2) LISTED DESIGN No. OR DESCRIPTION (SG-2) | 3.2.2.20-83 & 3.2.1.4 9.10.8 9.10.9 | | | | | | | | | | | | | | | | | | | | | | | | | | | | | | | | | | | | | | | | | | | | | | | | | | | | | | | |
| 19 | SPATIAL SEPARATION - CONSTRUCTION OF EXTERIOR WALLS | | 3.2.3 9.10.14 | | | | | | | | | | | | | | | | | | | | | | | | | | | | | | | | | | | | | | | | | | | | | | | | | | | | | | | |
| | <table border="1"> <thead> <tr> <th>WALL</th> <th>AREA OF EBF (sq. m.)</th> <th>LD (m)</th> <th>LH OR H/L</th> <th>PERMITTED MAX. % OF OPENINGS</th> <th>PROPOSED % OF OPENINGS</th> <th>FRR (HOURS)</th> <th>LISTED DESIGN No. OR DESCRIP.</th> <th>COMB. CONSTR.</th> <th>COMB. CONSTR. NONC. CLADDING</th> <th>NON-COMB. CONSTRUCTION</th> </tr> </thead> <tbody> <tr> <td>NORTH</td> <td>2,282.26</td> <td>39.52</td> <td>-</td> <td>100%</td> <td>100%</td> <td>-</td> <td>-</td> <td>-</td> <td>-</td> <td>-</td> </tr> <tr> <td>SOUTH</td> <td>3,342.58</td> <td>69.38</td> <td>-</td> <td>100%</td> <td>100%</td> <td>-</td> <td>-</td> <td>-</td> <td>-</td> <td>-</td> </tr> <tr> <td>EAST</td> <td>889.74</td> <td>13.24</td> <td>-</td> <td>80%</td> <td>40%</td> <td>1 HR</td> <td>CONCRETE PRECAST PANEL</td> <td>-</td> <td>-</td> <td>-</td> </tr> <tr> <td>WEST</td> <td>889.74</td> <td>16.47</td> <td>-</td> <td>100%</td> <td>100%</td> <td>-</td> <td>-</td> <td>-</td> <td>-</td> <td>-</td> </tr> </tbody> </table> | WALL | AREA OF EBF (sq. m.) | LD (m) | LH OR H/L | PERMITTED MAX. % OF OPENINGS | PROPOSED % OF OPENINGS | FRR (HOURS) | LISTED DESIGN No. OR DESCRIP. | COMB. CONSTR. | COMB. CONSTR. NONC. CLADDING | NON-COMB. CONSTRUCTION | NORTH | 2,282.26 | 39.52 | - | 100% | 100% | - | - | - | - | - | SOUTH | 3,342.58 | 69.38 | - | 100% | 100% | - | - | - | - | - | EAST | 889.74 | 13.24 | - | 80% | 40% | 1 HR | CONCRETE PRECAST PANEL | - | - | - | WEST | 889.74 | 16.47 | - | 100% | 100% | - | - | - | - | - | | |
| WALL | AREA OF EBF (sq. m.) | LD (m) | LH OR H/L | PERMITTED MAX. % OF OPENINGS | PROPOSED % OF OPENINGS | FRR (HOURS) | LISTED DESIGN No. OR DESCRIP. | COMB. CONSTR. | COMB. CONSTR. NONC. CLADDING | NON-COMB. CONSTRUCTION | | | | | | | | | | | | | | | | | | | | | | | | | | | | | | | | | | | | | | | | | | | | | | | | |
| NORTH | 2,282.26 | 39.52 | - | 100% | 100% | - | - | - | - | - | | | | | | | | | | | | | | | | | | | | | | | | | | | | | | | | | | | | | | | | | | | | | | | | |
| SOUTH | 3,342.58 | 69.38 | - | 100% | 100% | - | - | - | - | - | | | | | | | | | | | | | | | | | | | | | | | | | | | | | | | | | | | | | | | | | | | | | | | | |
| EAST | 889.74 | 13.24 | - | 80% | 40% | 1 HR | CONCRETE PRECAST PANEL | - | - | - | | | | | | | | | | | | | | | | | | | | | | | | | | | | | | | | | | | | | | | | | | | | | | | | |
| WEST | 889.74 | 16.47 | - | 100% | 100% | - | - | - | - | - | | | | | | | | | | | | | | | | | | | | | | | | | | | | | | | | | | | | | | | | | | | | | | | | |
| 20 | OTHERS (DESCRIBE) | | | | | | | | | | | | | | | | | | | | | | | | | | | | | | | | | | | | | | | | | | | | | | | | | | | | | | | | | |

LIVINGSTON INDUSTRIAL

12304 HEART LAKE ROAD CALEDON, ON



OWNER

12304 HEART LAKE ROAD LIMITED PARTNERSHIP
1676 TRANSCANADIENNE, SUITE 500
KIRKLAND, QC H9H 4M7

OWNER'S CONSULTANTS

CIVIL ENGINEER
IBI GROUP
8133 WARDEN AVE, UNIT 300
MARKHAM, ON L6G 1B3
JASON JENKINS
PH: (905) 763-2322 EXT. 63542

LANDSCAPE CONSULTANT
IBI GROUP
8133 WARDEN AVE, UNIT 300
MARKHAM, ON L6G 1B3
TIM O'BRIEN
PH: (905) 546-1010 EXT. 63118

TRAFFIC CONSULTANT
IBI GROUP
8133 WARDEN AVE, UNIT 300
MARKHAM, ON L6G 1B3
ANDRAE GRIFFITH
PH: (416) 596-1930 EXT. 61450
FAX: (416) 596-0644

SHEET INDEX

ARCHITECTURAL

- A0.1 TITLE SHEET
 - A1.0 SITE PLAN
 - A2.1 FLOOR PLAN
 - A3.1 ROOF PLAN
 - A4.1 EXTERIOR ELEVATIONS
 - A5.1 BUILDING SECTIONS
- ARCHITECTURAL SHEET COUNT: 6

TOTAL SHEETS
6

ARCHITECT

WARE MALCOMB

180 BASS PRO MILLS DR #103
VAUGHAN, ONTARIO, CANADA L4K 5W4
250 UNIVERSITY AVE, SUITE 235
TORONTO, ONTARIO, CANADA M5H 3E5

AYMAN MORSY
PH: 905.760.1221
FAX: 905.248.3344
amorsy@waremalcomb.com

ARCHITECT'S CONSULTANTS

ELECTRICAL ENGINEER
INVIRO ENGINEERED SYSTEMS LTD.
3530 PHARMACY AVE.
SCARBOROUGH, ONTARIO M1W 2S7
MORENO PIVATO
PH: (416) 897-3523
moreno@inviroenergy.com

VICINITY MAP

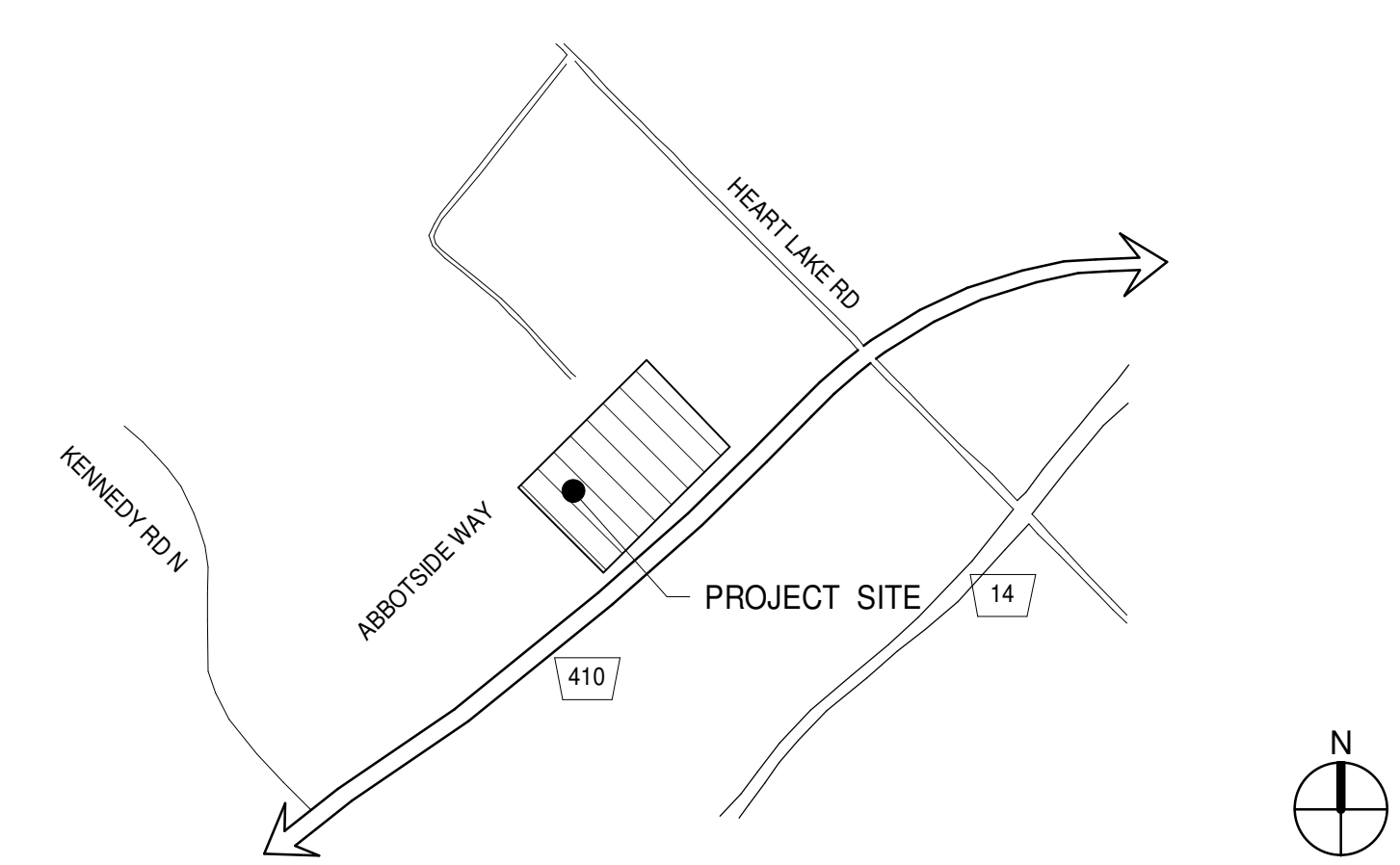

WARE MALCOMB

Leading Design for Commercial Real Estate

architecture 180 bass pro mills drive, suite 103
planning vaughan, ontario, l4k 5w4
interiors p 905.760.1221
graphics f 905.248.3344
civil engineering a business name of WMA Inc.



LIVINGSTON INDUSTRIAL
 12304 HEART LAKE ROAD
 CALEDON, ON

TITLE SHEET

| DATE | REMARKS |
|------------|------------------|
| 2021-10-29 | SPA PROGRESS SET |
| 2021-11-24 | ISSUED FOR SPA |

| | |
|-----------|---------------|
| PA/PM: | A. MORSY |
| DRAWN BY: | A.V / J.J |
| JOB NO.: | TOR21-0032-00 |

SHEET
A0.1