

ARCHITECTURAL :

STRUCTURAL :

MECHANICAL :

ELECTRICAL :



FIRE PROTECTION :

CIVIL :

| REVISIONS | | | |
|-----------|------------|----------------|----|
| No | Date | Description | By |
| 1. | 2022-07-15 | Issued for SPA | EZ |

| No | Date | Description | By |
|--------------|------|-------------|----|
| DISTRIBUTION | | | |

GENERAL NOTE
THE CONTRACTOR IS RESPONSIBLE FOR VERIFYING DIMENSIONS, MEASUREMENTS, AND CONDITIONS PRIOR TO CONSTRUCTION. THE CONTRACTOR SHALL BE RESPONSIBLE FOR THE COORDINATION AND PROTECTION OF ALL ELEMENTS. ALL CHANGES, VARIATIONS, AND ADDITIONS MUST BE REPORTED TO THE ARCHITECT IMMEDIATELY.

DRAWN BY:

SS

VERIFIED BY:

EZ

APPROVED BY:

AV

DRAWING TITLE:

SCALE:

1"=100'

DATE:

PROJECT NUMBER:

DRAWING #:

REV:

| Luminaire Schedule | | | | | | | | | |
|--------------------|-----|-------|-------------|-----------------------------|-------|-----------|-----------|-------|--|
| Symbol | Qty | Label | Arrangement | Description | LLF | Luminaire | Luminaire | Total | |
| □+□ | 33 | A | Back-Back | MRM-LED-36L-SL-5W-40-70CR | 0.940 | 36017 | 288 | 10503 | |
| □+□ | 4 | A1 | Single | MRM-LED-48L-SL-5W-40-70CR | 0.940 | 41987 | 401 | 1804 | |
| □+□ | 4 | A2 | Single | MRM-LED-48L-SL-5W-40-70CR | 0.940 | 41986 | 401 | 1804 | |
| □+□ | 4 | A3 | Single | MRM-LED-36L-SL-5W-40-70CR | 0.940 | 36017 | 288 | 1152 | |
| □+□ | 7 | B | Single | MRM-LED-24L-SL-FT-40-70CR-H | 0.940 | 16813 | 176 | 1232 | |
| □+□ | 2 | B1 | Single | MRM-LED-24L-SL-FT-40-70CR-L | 0.940 | 16436 | 176 | 362 | |
| □+□ | 13 | D | Single | MRM-LED-48L-SL-FT-40-70CR-L | 0.940 | 24099 | 401 | 5271 | |
| □+□ | 5 | F | Single | MRM-LED-24L-SL-FT-40-70CR-L | 0.940 | 24242 | 288 | 1440 | |
| □+□ | 2 | F | Single | MRM-LED-48L-SL-FT-40-70CR-H | 0.940 | 41982 | 419 | 1096 | |
| □+□ | 10 | P | Single | MRM-LED-48L-SL-FT-40-70CR | 0.940 | 44130 | 354 | 3540 | |
| □+□ | 3 | T | Single | MRM-LED-24L-SL-FT-40-70CR-L | 0.940 | 24097 | 176 | 528 | |
| □+□ | 3 | T1 | Single | MRM-LED-24L-SL-FT-40-70CR-L | 0.940 | 15373 | 176 | 362 | |
| □+□ | 30 | M1 | Single | MRM-LED-24L-SL-FT-40-70CR | 0.940 | 24099 | 401 | 5271 | |
| □+□ | 8 | M2 | Single | MRM-LED-48L-SL-FT-40-70CR | 0.940 | 44810 | 401 | 2607 | |
| □+□ | 3 | M3 | Single | MRM-LED-24L-SL-FT-40-70CR | 0.940 | 24143 | 176 | 702 | |
| □+□ | 2 | M4 | Single | MRM-LED-24L-SL-FT-40-70CR | 0.940 | 2272 | 19.87 | 59.61 | |
| □+□ | 3 | M5 | Single | MRM-LED-48L-SL-FT-40-70CR | 0.940 | 44810 | 401 | 2607 | |
| □+□ | 8 | M7 | Single | MRM-LED-24L-SL-FT-40-70CR | 0.940 | 12221 | 102.2 | 817.6 | |

| Calculation Summary | | | | | | | | | |
|-----------------------------|-------------|-------|-------|-----------------|------|--------|--------|--|--|
| Label | CalcType | Units | Avg | Max | Min | AvgMin | MaxMin | | |
| 160 STALLS WEST SIDE | Illuminance | Lux | 18.07 | 40.8 | 5.4 | 3.35 | 7.56 | | |
| 588 STALLS WEST SIDE | Illuminance | Lux | 28.07 | 57.2 | 8.4 | 3.40 | 8.81 | | |
| FRONT TRAILER PARKING | Illuminance | Lux | 20.56 | 58.1 | 6.0 | 3.43 | 9.68 | | |
| FUEL STATION & LOADING DOCK | Illuminance | Lux | 16.29 | 24.6 | 9.4 | 1.73 | 2.62 | | |
| LOADING DOCK | Illuminance | Lux | 22.72 | 80.5 | 8.3 | 2.74 | 9.70 | | |
| NORTH SIDE | Illuminance | Lux | 20.01 | 20.5 | 7.0 | 3.72 | 7.21 | | |
| PROPERTY LINE | Illuminance | Lux | 3.01 | 55.8 (EXTENDED) | 0.0 | N/A | N/A | | |
| SOUTH SIDE PARKING | Illuminance | Lux | 24.18 | 51.0 | 13.0 | 2.07 | 4.42 | | |
| TRUCK DRIVEWAYS | Illuminance | Lux | 19.62 | 53.2 | 6.2 | 3.16 | 8.58 | | |
| TRUCK PARKING WEST SIDE | Illuminance | Lux | 20.97 | 53.5 | 19.1 | 3.87 | 5.90 | | |
| Trucks Entrance Exit | Illuminance | Lux | 33.02 | 55.6 | 8.5 | 3.98 | 8.54 | | |

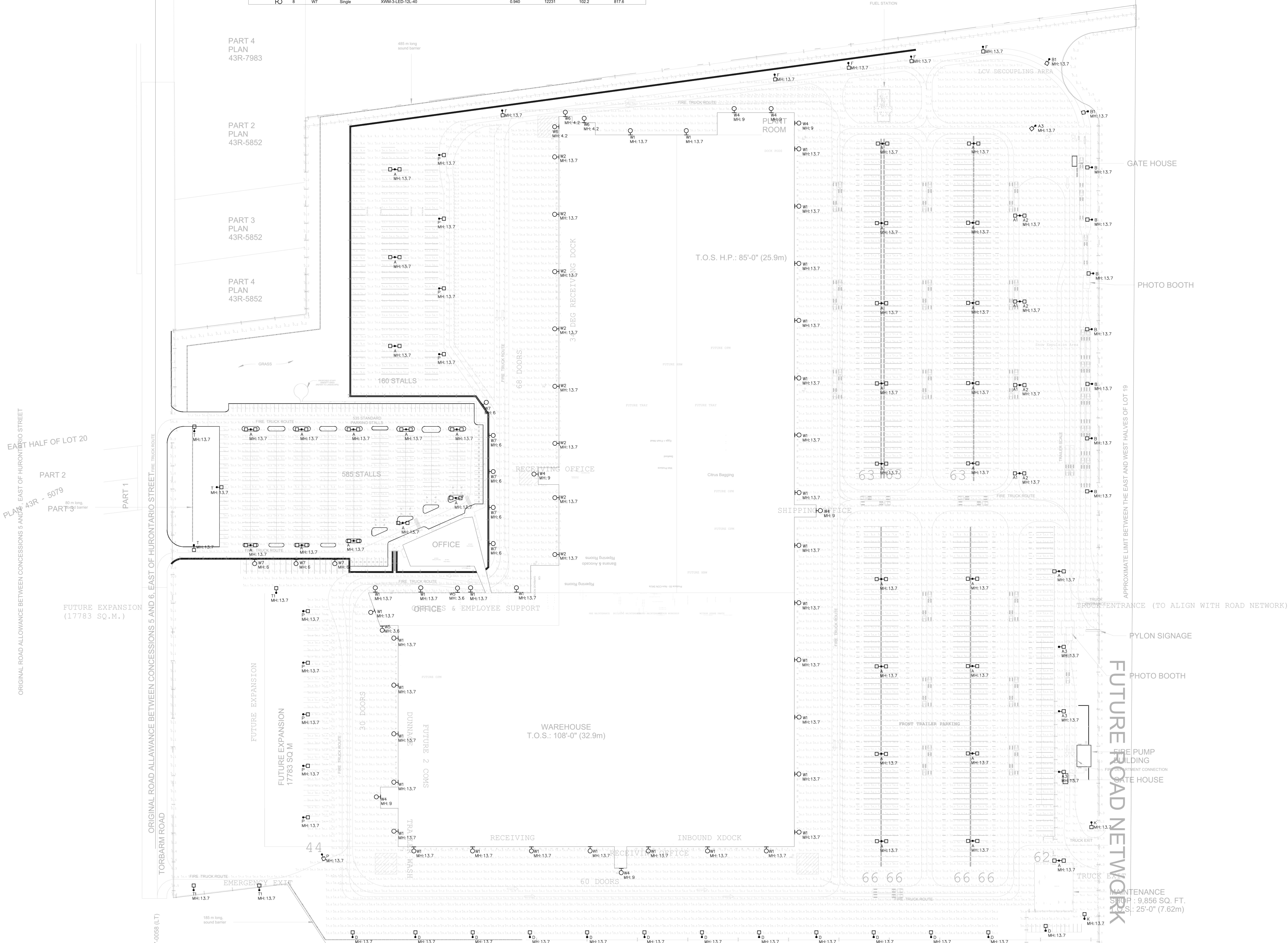

TOWN OF CALEDON
PLANNING
RECEIVED
May 11, 2023