

- ### EROSION CONTROLS
1. THE CONTRACTOR SHALL MONITOR THE WEATHER SEVERAL DAYS IN ADVANCE OF THE ONSET OF THE PROJECT TO ENSURE THAT THE WORKS WILL BE CONDUCTED DURING FAVOURABLE WEATHER CONDITIONS. SHOULD AN UNEXPECTED STORM ARISE, THE CONTRACTOR WILL REMOVE ALL UNFIXED ITEMS FROM THE STORM FLOOD PLAN THAT WOULD HAVE THE POTENTIAL TO CAUSE A SPILL OR AN OBSTRUCTION TO FLOW, E.G., FUEL TANKS, PORTA-POTIES, MACHINERY, EQUIPMENT, CONSTRUCTION MATERIALS, ETC.
 2. THE CONTRACTOR SHALL RETAIN AS MUCH EXISTING VEGETATION AS POSSIBLE BY LIMITING THE DISTURBANCE TO NON-ESSENTIAL AREAS AND STABILIZE EXPOSED SOILS QUICKLY. THE PROPOSED VEGETATION SPECIFICATION INCLUDES A FAST GERMINATING SEED MIX TO QUICKLY ESTABLISH GROUND COVER AND SHALL BE APPLIED WITHIN 15 DAYS OF COMPLETING THE CONSTRUCTION ACTIVITY. THE CONTRACTOR SHALL ENSURE THAT THE PROPOSED VEGETATION GERMINATES AND ESTABLISHES QUICKLY AND SHALL REAPPLY THE GROUND COVER MIX AS DIRECTED BY THE ENGINEER UNTIL A SUITABLE VEGETATED GROUND COVER IS IN PLACE.
 3. THE CONTRACTOR SHALL MINIMIZE THE SLOPE LENGTH AND GRADIENT OF DISTURBED AREAS, MAINTAIN OVERLAND SHEET FLOW AND AVOID CONCENTRATED FLOWS.
 4. THE CONTRACTOR SHALL ENSURE ALL TEMPORARY TOPSOIL AND EARTH STOCKPILES ARE PLACED MORE THAN 30M FROM A WATERCOURSE AND SEPARATED BY SILT FENCE AND A NATURAL VEGETATED AND / OR UNDISTURBED AREA.
 5. THE CONTRACTOR SHALL SHAPE AND GRADE TEMPORARY TOPSOIL STOCKPILE TO A MAXIMUM SLOPE OF 2:1 AND STABILIZE WITH SEED WITHIN 30 DAYS OF COMPLETION OF STOCKPILING.
 6. GRADING, TOPSOIL AND SEEDING IS TO OCCUR PRIOR TO FREEZING TO ALLOW ESTABLISHMENT OF VEGETATION AND SLOPE STABILIZATION.

- ### SEDIMENT CONTROLS
1. SILT FENCE TO BE INSTALLED IN LOCATIONS SHOWN ON PLAN AND AS DIRECTED BY SITE ENGINEER.
 2. SILT FENCE MUST BE INSPECTED WEEKLY FOR RIPS OR TEARS, BROKEN STAKES, BLOW-OUTS AND ACCUMULATION OF SEDIMENT.
 3. SILT FENCE MUST BE INSPECTED FOLLOWING ALL 15mm OR GREATER RAIN STORM EVENT OR AS DIRECTED BY SITE ENGINEER.
 4. SEDIMENT MUST BE REMOVED FROM SILT FENCE WHEN ACCUMULATION REACHES 50% OF THE HEIGHT OF FENCE.
 5. ALL SEDIMENT CONTROLS MUST BE REMOVED ONLY WHEN THE ENTIRE SITE IS STABILIZED AND AS DIRECTED BY THE SITE ENGINEER.
 6. STREET CATCHBASINS TO BE FITTED WITH TEMPORARY SILTSACKS AS PER DETAIL ON THIS DRAWING AND INSPECTED AFTER ALL RAINFALL EVENTS 15mm OR GREATER.
 7. SEDIMENT SHALL BE CLEANED FROM PUBLIC ROADS AT THE END OF EACH DAY.

- ### GENERAL EROSION AND SEDIMENT CONTROL NOTES
1. EROSION AND SEDIMENT CONTROL (ESC) MEASURES WILL BE IMPLEMENTED PRIOR TO, AND MAINTAINED DURING THE CONSTRUCTION PHASES TO PREVENT ENTRY OF SEDIMENT INTO THE WATER. ALL DAMAGED EROSION AND SEDIMENT CONTROL MEASURES SHOULD BE REPAIRED AND/OR REPLACED WITHIN 48 HOURS OF THE INSPECTION. THE EROSION AND SEDIMENT CONTROL STRATEGIES OUTLINED ON THE PLANS ARE NOT STATIC AND MAY NEED TO BE UPGRADED / AMENDED AS SITE CONDITIONS CHANGE TO MINIMIZE SEDIMENT LADEN RUNOFF FROM LEAVING THE WORK AREAS. IF THE PRESCRIBED MEASURES ON THE PLANS ARE NOT EFFECTIVE IN PREVENTING THE RELEASE OF A DELETERIOUS SUBSTANCE, INCLUDING SEDIMENT, THEN ALTERNATIVE MEASURES MUST BE IMPLEMENTED IMMEDIATELY TO MINIMIZE POTENTIAL ECOLOGICAL IMPACTS. TRCA ENFORCEMENT OFFICER SHOULD BE IMMEDIATELY CONTACTED. ADDITIONAL ESC MEASURES ARE TO BE KEPT ON SITE AND USED AS NECESSARY.
 2. AN ENVIRONMENTAL MONITOR WILL ATTEND THE SITE TO INSPECT ALL NEW CONTROLS, AS WELL AS ON A WEEKLY BASIS, OR FOLLOWING RAIN/SNOWMELT EVENT, TO MONITOR ALL WORKS, AND IN PARTICULAR WORKS RELATED TO EROSION AND SEDIMENT CONTROLS. SHOULD CONCERNS ARISE ON SITE THE ENVIRONMENTAL MONITOR WILL CONTACT THE TRCA ENFORCEMENT OFFICER AS WELL AS THE CONTRACTOR. WEEKLY INSPECTION REPORTS ARE TO BE PROVIDED TO THE TOWN AND TRCA.
 3. ALL ACTIVITIES, INCLUDING MAINTENANCE PROCEDURES, WILL BE CONTROLLED TO PREVENT THE ENTRY OF PETROLEUM PRODUCTS, DEBRIS, RUBBLE, CONCRETE OR OTHER DELETERIOUS SUBSTANCES INTO THE WATER. VEHICULAR REFUELING AND MAINTENANCE WILL BE CONDUCTED A MINIMUM OF 30M FROM THE WATER.
 4. AT THE TOWN'S DISCRETION, PRE-GRADE AREAS TO BE STABILIZED BY HYDRO SEEDING C/W APPLICATION OF STRAW MULCH PER OPSS 804 TO A DEPTH OF 25mm to 50mm TO THE SATISFACTION OF TOWN STAFF.

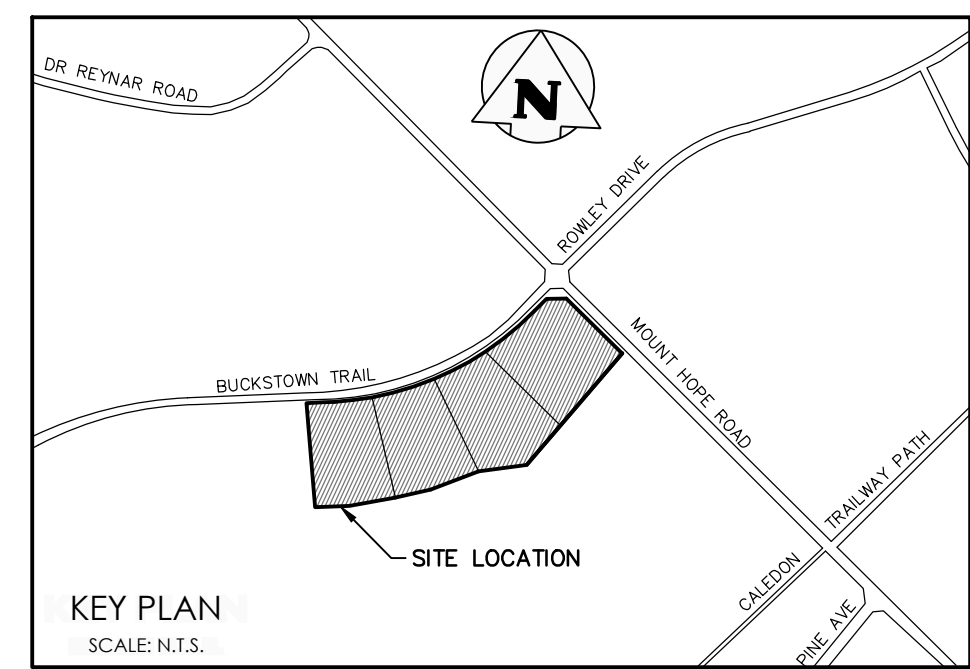
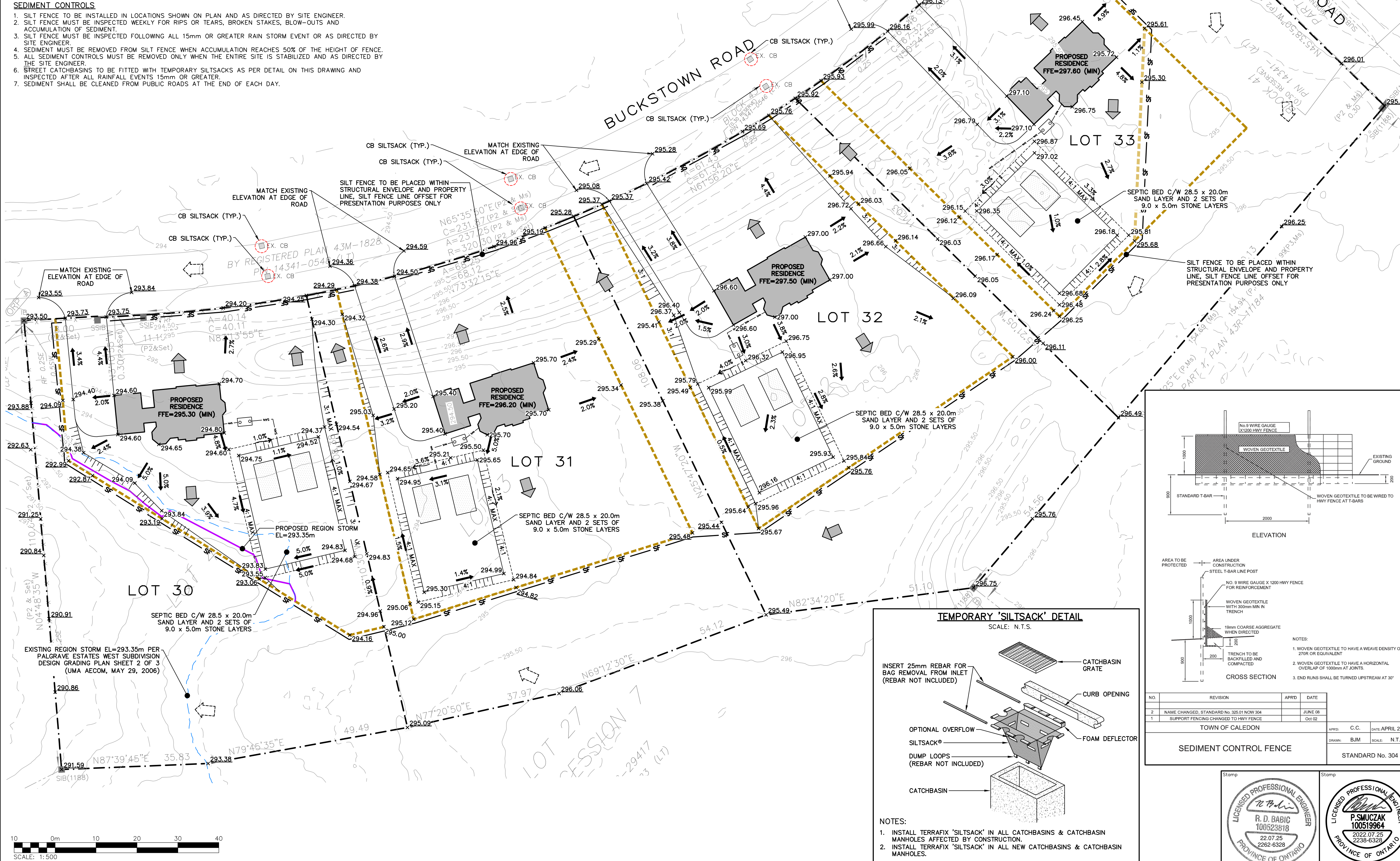

LEGEND

- PROPERTY LINE
- EXISTING CONTOUR (0.5m)
- EXISTING CONTOUR (1.0m)
- REGIONAL STORM EL=293.35m PER PALGRAVE ESTATES WEST SUBDIVISION DESIGN GRADING PLAN SHEET 2 OF 3 (UMA AECOM, MAY 29, 2006)
- PROPOSED REGIONAL STORM EL = 293.35m
- EXISTING FENCE
- SILT FENCE; SEE DETAIL
- EXISTING GRADE
- PROPOSED GRADE
- PROPOSED GRADE (TO MATCH EXISTING)
- PROPOSED MINOR FLOW DIRECTION
- PROPOSED GRASSED SWALE
- PROPOSED SLOPE (3:1 MAX.)
- EXTENTS OF WORK
- EXISTING MAJOR OVERLAND FLOW DIRECTION
- PROPOSED MAJOR OVERLAND FLOW DIRECTION
- EXISTING SINGLE CATCHBASIN

SEPTIC SYSTEM DESIGN (PER LOT)

DAILY DESIGN FLOW	4,500 L/day
PROPOSED SEPTIC TANK SIZE	MIN. SIZE = 0x2 = 9,000 L PROPOSED TANK = 10,000 L
SOIL PERCOLATION RATE	T = 50 min/cm
MIN. STONE AREA (DISTRIBUTION PIPE EVENLY SPACED)	0/50 = 4,500/50 90 m ² REQUIRED
MIN. SAND AREA	0T/400 = 4,500*50/400 562.5 m ² REQUIRED 570 m ² PROVIDED

1	ISSUED FOR FIRST SUBMISSION	2022/JUL/25
0	ISSUED FOR FIRST SUBMISSION	2022/MAY/06
No.	ISSUE / REVISION	YYYY/MM/DD

ELEVATION NOTE:
ELEVATIONS SHOWN ON THIS PLAN ARE DERIVED FROM EQUATOR STUDIOS LIDAR DATA DATED: 2022/APR/04

SURVEY NOTES:
SURVEY COMPLETED BY YOUNG & YOUNG SURVEYING INC. (2022/APR/01)
PROJECT No. 21-87589

BEARINGS ARE UTM GRID, DERIVED FROM RTN OBSERVATIONS
UTM ZONE 17, NAD83 (ORIGINAL) (1997.0)

DISTANCES ARE GROUND AND CAN BE CONVERTED TO GRID BY MULTIPLYING BY THE COMBINED SCALE FACTOR OF 0.9996673

DRAWING NOTES:
THIS DRAWING IS THE EXCLUSIVE PROPERTY OF C.F. CROZIER & ASSOCIATES INC. AND THE REPRODUCTION OF ANY PART OF IT WITHOUT PRIOR WRITTEN CONSENT OF THIS OFFICE IS STRICTLY PROHIBITED.
THE CONTRACTOR SHALL VERIFY ALL DIMENSIONS, LEVELS, AND DATUMS ON SITE AND REPORT ANY DISCREPANCIES OR OMISSIONS TO THIS OFFICE PRIOR TO CONSTRUCTION.
THIS DRAWING IS TO BE READ AND UNDERSTOOD IN CONJUNCTION WITH ALL OTHER PLANS AND DOCUMENTS APPLICABLE TO THIS PROJECT. DO NOT SCALE THIS DRAWING.
ALL EXISTING UNDERGROUND UTILITIES TO BE VERIFIED IN THE FIELD BY THE CONTRACTOR PRIOR TO CONSTRUCTION.

Project: **ANGELSTONE TOURNAMENTS INC. LOTS 30 - 33 TOWN OF PALGRAVE**

Drawing: **GRADING, EROSION & SEDIMENT CONTROL PLAN**

2800 HIGH POINT DRIVE SUITE 100 MILTON, ON L9T 6P4 905-875-0026 T 905-875-4915 F WWW.CFCROZIER.CA

CROZIER CONSULTING ENGINEERS

Drawn: S.O. Design: P.S. Project No.: **2262-6328**
Check: P.S. Check: T.E. Scale: 1:500 Dwp: **C 101**

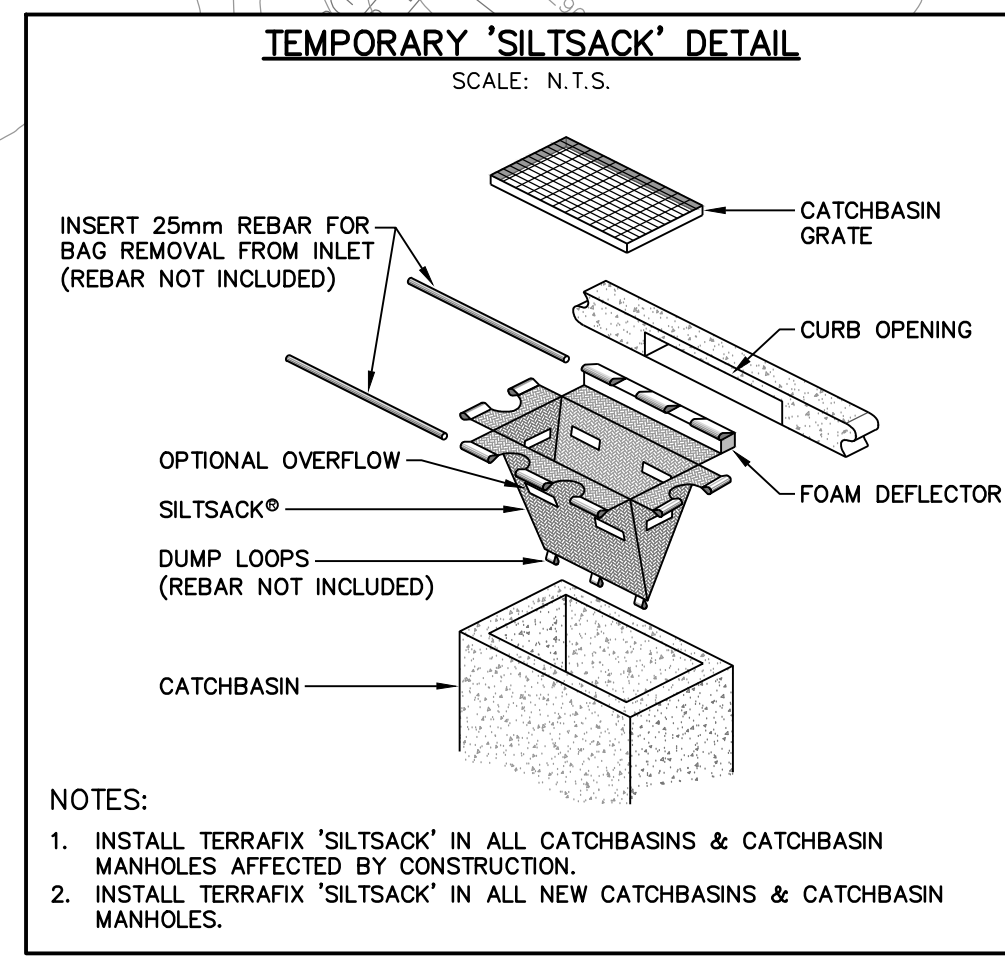
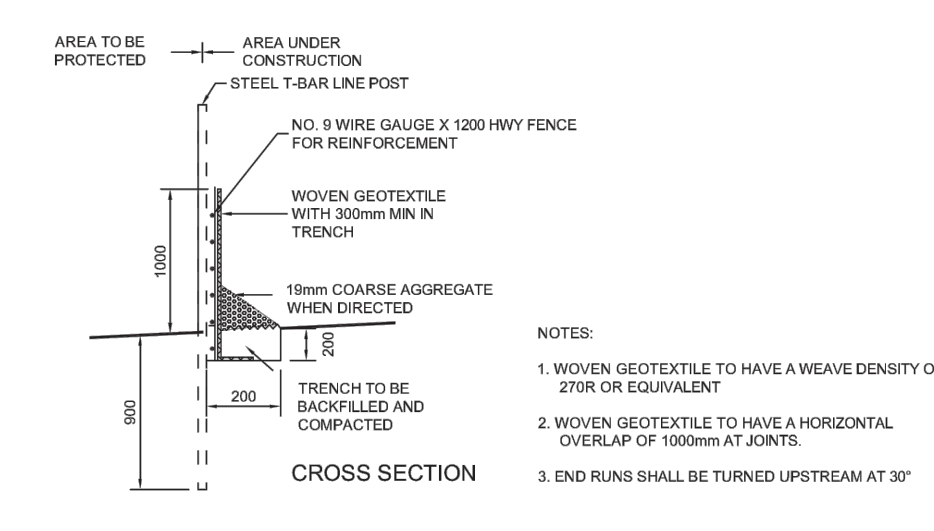
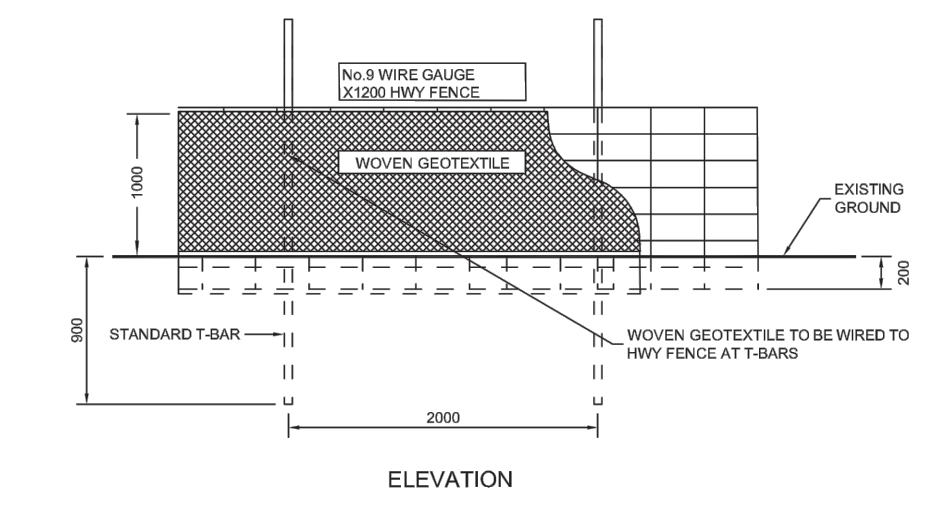

NO.	REVISION	APPROVED	DATE
2	NAME CHANGED, STANDARD No. 304 TO NEW 304		JUNE 08
1	SUPPORT FENCINGS CHANGED TO HWY FENCE		OCT 02

TOWN OF CALEDON

SEDIMENT CONTROL FENCE

STANDARD No. 304



Stamp: **R. D. BABIC**
22.07.25
2262-6328
PROVINCE OF ONTARIO

Stamp: **P. SMUCZAK**
2022.07.25
2262-6328
PROVINCE OF ONTARIO