

Bruce Tree Expert Company Ltd.

3-1750 The Queensway, Suite 1329
Toronto, ON M9C 5H5
p. 416.252.8769
f. 416.252.4574
e. contact@bruce-tree.com
www.bruce-tree.com



TITLE
APPENDIX III
TREE PROTECTION PLAN

SITE
GRAHAM PROPERTY ESTATE DEVELOPMENT, Mount Pleasant and Hwy 9, Caledon

DATE
2019.09.24

Brec FILE
7210-2207

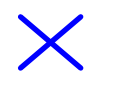
SCALE
1:1000

- LEGEND**
- 401 Tree number corresponding to inventory
 -  Minimum tree protection zone based on drip line
 -  Proposed tree removal
 -  Tree protection fencing

GENERAL NOTES

1. This plan is to be read in conjunction with the arborist report prepared by Bruce Tree Expert Company Ltd. dated September 24, 2019.
2. Bruce Tree Expert Company Ltd. provided the tree numbers, tree protection comments, and icons for Trees 420, 421 and 422 (locations approximate). All other information was provided on a grading plan prepared by GHD dated May 2019.

TREE PROTECTION NOTES:

1. All tree protection fencing is to be immovable construction fencing or 1200mm high snow fence secured to T-bar stakes at minimum of 2400mm O.C. as approved by the Town of Caledon.

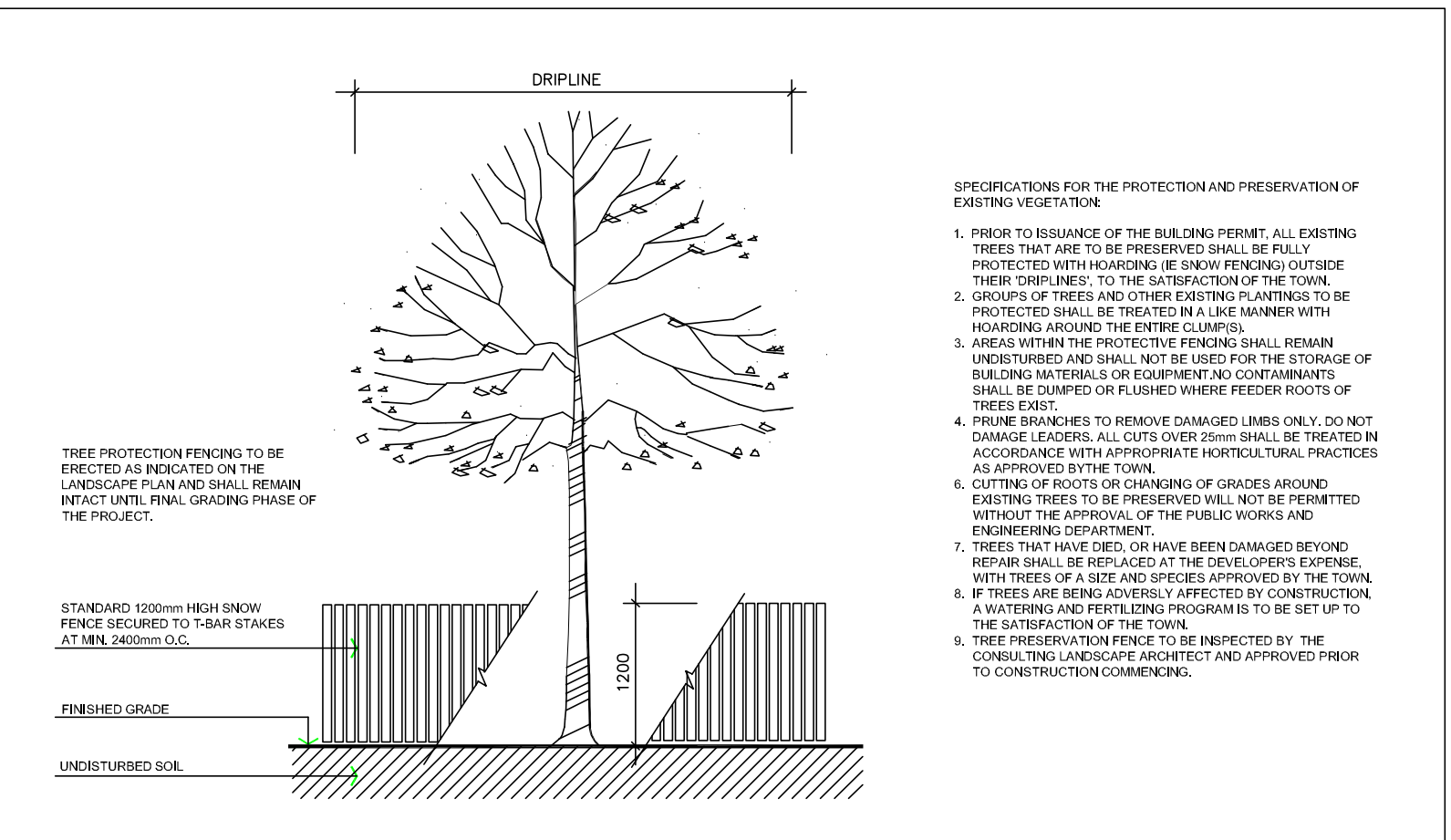
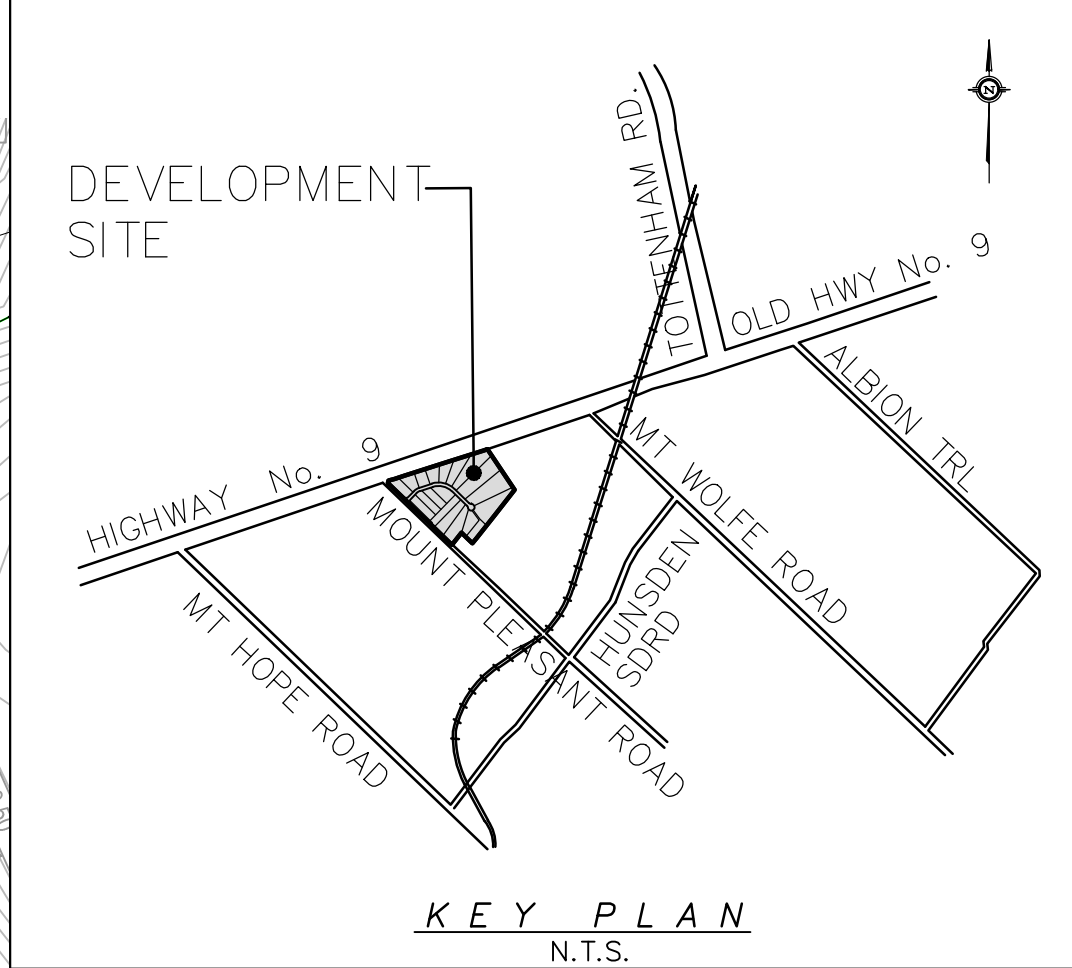

TOWN OF CALEDON		APPROVED: C.C.	DATE: JUNE 08
TREE PRESERVATION		DRAWN: abal	SCALE: NTS
NO.	REVISION	APPROVED	DATE
1	STANDARD N.L. 1101 NOV 707 NOTES EDIT		
2	NOTE N.L. 8 ADDED		
STANDARD No. 707			