

TOWN OF CALEDON  
 PLANNING  
 RECEIVED  
 May 04, 2020

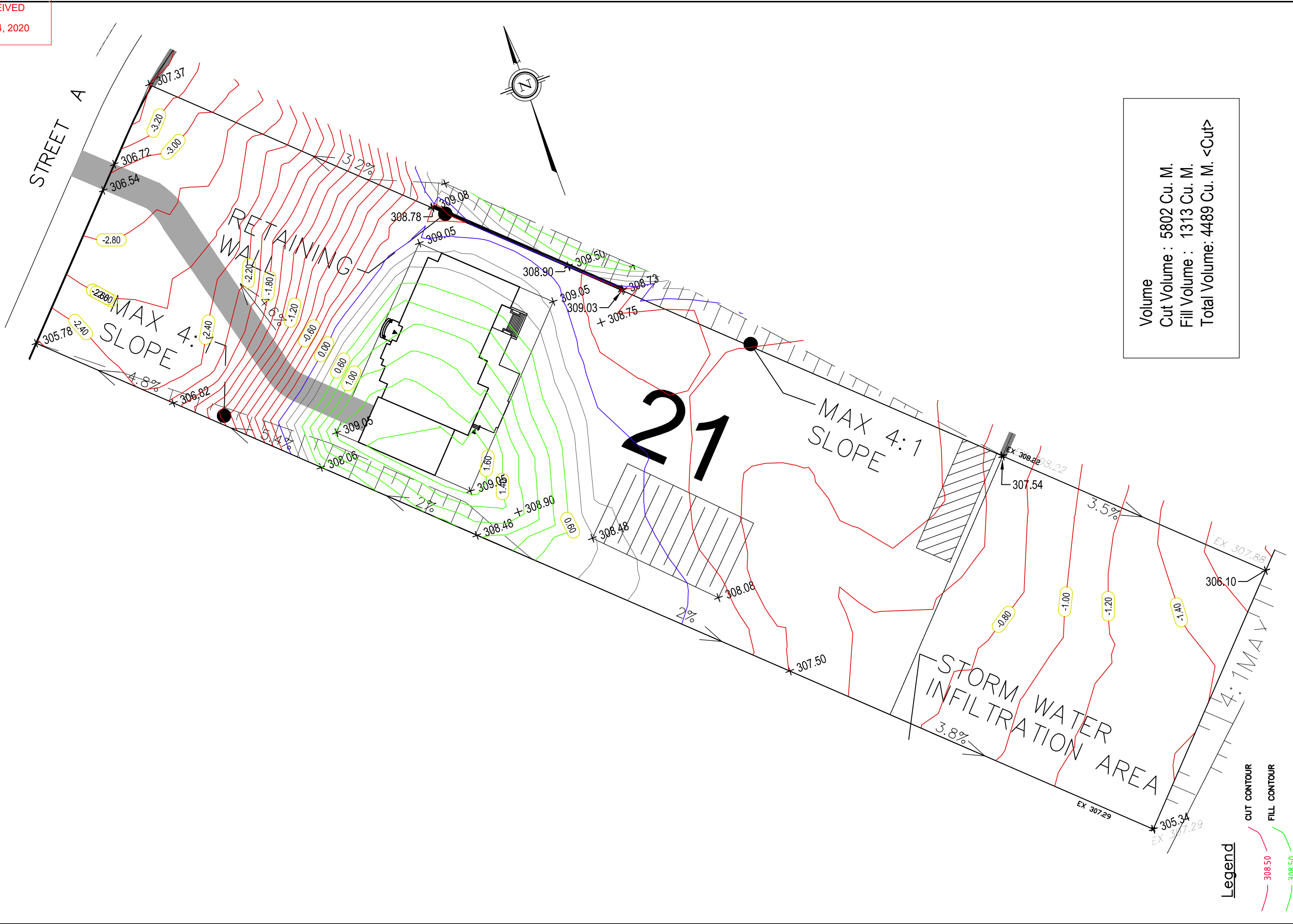

**GRAHAM PROPERTY  
 ESTATE DEVELOPMENT**

The Serras Group Inc. (A GHD Company)  
 6705 Millcreek Drive, Unit 104  
 T 1 416 213 7121 F 1 416 890 8499  
 E yjones@ghd.com W www.ghd.com



**CUT-FILL PLAN  
 LOT 21**

DESIGN	DRAWN	CAD	CHECKED	CONTRACT No. 06131
SCALE: 1:500	DATE: FEB. 2020	DRAWING NUMBER		<b>CF-5</b>