

TOWN OF CALEDON
PLANNING
RECEIVED
July 31, 2020

- LEGEND:**
- 113.62 -100.00 DENOTES EXISTING SPOT ELEVATION
 - + (100.00) DENOTES PROPOSED ELEVATION
 - 1.0% DENOTES PROPOSED FLOW ARROW AND SLOPE
 - DENOTES PROPOSED FLOW ARROW
 - DENOTES EMERGENCY OVERLAND FLOW
 - 195.50 DENOTES EXISTING CONTOUR

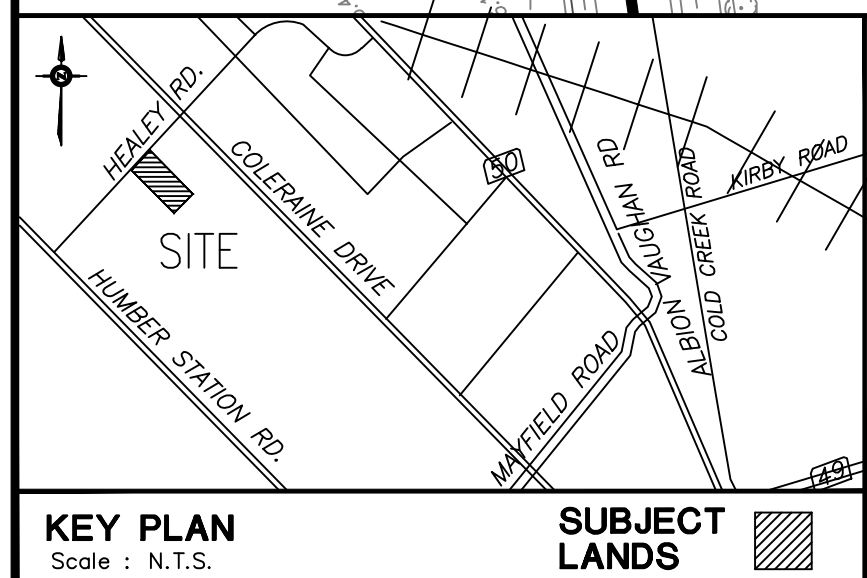
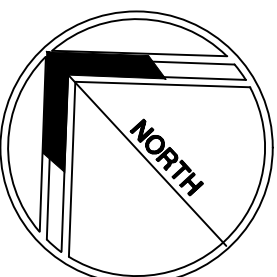

NOTES:

THE POSITION OF POLE LINES, CONDUITS, WATERMANS, SEWERS AND UNDERGROUND AND ABOVE GROUND UTILITIES IS NOT NECESSARILY SHOWN ON THE CONTRACT DRAWINGS, AND WHERE SHOWN, THE ACCURACY OF THE POSITION OF SUCH UTILITIES AND STRUCTURES IS NOT GUARANTEED. BEFORE STARTING THE WORK THE CONTRACTOR SHALL INFORM HIMSELF OF THE EXACT LOCATION OF ALL UTILITIES AND STRUCTURES, AND SHALL ASSUME ALL LIABILITY FOR DAMAGE TO THEM.

THE CONTRACTOR MUST CHECK AND VERIFY ALL DIMENSIONS ON THE JOB AND REPORT ANY DISCREPANCY TO THE ARCHITECTS/ENGINEERS BEFORE PROCEEDING WITH THE WORKS.

ALL DRAWINGS AND SPECIFICATIONS ARE INSTRUMENTS OF SERVICE AND THE PROPERTY OF THE ENGINEER WHICH MUST BE RETURNED AT THE COMPLETION OF WORK.

THIS DRAWING IS NOT TO BE SCALED.

THE APPROVAL OF THIS PLAN DOES NOT EXEMPT THE OWNER'S CONTRACTOR FROM OBTAINING, BUT NOT LIMITED TO THE FOLLOWING PERMITS: ROAD CUT, SEWER PERMITS, RELOCATION OF SERVICES, ENCROACHMENT AGREEMENTS, APPROACH APPROVAL PERMITS, ETC.

EXISTING TOPOGRAPHICAL INFORMATION SUPPLIED BY R. AYS SURVEYING INC.

BOUNDARY DATA DERIVED FROM INFORMATION FROM R. AYS SURVEYING INC.

BENCH MARK:
ELEVATIONS ARE GEODETIC AND ARE DERIVED FROM THE TOWN OF CALEDON BENCHMARK No. 758056.

ELEVATION:
PUBLISHED ELEVATION - 251263 metres.

BEARING NOTE:
BEARINGS SHOWN HEREON ARE GRID BEARINGS AND ARE REFERRED TO THE NORTHEASTERLY LIMIT OF PART 1 AS SHOWN ON PLAN 43R-30545, HAVING A BEARING OF N49°52'40"W.

METRIC NOTE:
DISTANCES AND ELEVATIONS ON THIS PLAN ARE TYPICALLY SHOWN IN METRES AND CAN BE CONVERTED TO FEET BY DIVIDING BY 0.3048.

| NO. | REVISIONS | DATE | BY |
|-----|----------------|------------|--------|
| 1 | 1ST SUBMISSION | JULY 31/20 | M.H.H. |
| | | | |
| | | | |
| | | | |
| | | | |
| | | | |
| | | | |
| | | | |
| | | | |
| | | | |

PROJECT:
PROPOSED INDUSTRIAL DEVELOPMENT
8281 HEALEY ROAD
CALEDON, ONTARIO

CITY FILE: RZ 2020-0007

CLIENT:
8281 HEALEY ROAD GP LIMITED
c/o ONE PROPERTIES
333 BAY ST SUITE 2710,
TORONTO, ON. M5H 2R2

The Odan/Detech Group Inc. P. (905) 632-3811 F. (905) 632-3363
5230 SOUTH SERVICE ROAD, BURLINGTON, ONTARIO, L7L 5K2

SCALE: 1:750

PROJECT NO: 19233

DATE: JUNE 2020

SCALE:

| | |
|---|-----------------------|
| DRAWING : 8281 HEALEY ROAD CONCEPT SITE GRADING | DESIGN BY: M.H.H. |
| | DRAWN BY: Z.Z. |
| | CHECKED BY: J.K. |
| | APPROVED BY: J.K. |
| | DRWG. NO.: FIG. SG |
| | ENGINEER |