

LEGEND

- PLANT CODE
- PLANT QUANTITY
- DECIDUOUS TREE
- CONIFEROUS TREE
- PROPOSED SHRUB
- PROPOSED GROUND COVER
- SOD SEE NOTE #4 DWG LP-2
- CONCRETE WALKWAY
- 19mmØ STONE AT 150mm DEPTH OVER TERRAFIX 270R FILTER FABRIC
- LIMESTONE BOULDER SEE NOTE #12 DWG LP-2
- DECORATIVE METAL FENCE SEE DETAIL ON LP-2
- TREE PROTECTION FENCE AS PER TREE PRESERVATION PLAN
- SILT FENCE AS PER TREE PRESERVATION PLAN
- EXISTING VEGETATION TO REMAIN
- EXISTING VEGETATION TO BE REMOVED

PLANT LIST

CODE	BOTANICAL NAME	COMMON NAME	QTY.	SIZE	COND.	SPACING
DECIDUOUS TREES						
AS	ACER X FREEMANII CELEBRATION	CELEBRATION MAPLE	5	70MM	WB	5.00M
BP	BETULA Papyrifera	PAPER BIRCH	4	70MM	WB	5.00M
GB	GINKGO BILOBA 'MAGYAR'	MAGYAR MAIDENHAIR TREE	1	50MM	WB	
QM	QUERCUS MACROCARPA	BURR OAK	5	70MM	WB	5.00M
CONIFEROUS TREES						
PP	PICEA Pungens 'BABY BLUE'	BABY BLUE SPRUCE	4	250CM	WB	5.00M
SHRUBS						
CS	CORNUS SERICEA	RED OSIER DOGWOOD	12	80CM	2 GAL	1.5M
DL	DIERVILLA Lonicera	BUSH HONEYSUCKLE	13	80CM	2 GAL	0.80M
HP	HYPERICUM Prolificum	SHRUBBY ST. JOHN'S WORT	3	80CM	2 GAL	0.80M
JH	JUNIPERUS HORIZONTALIS	LIMEGLOW CREEPING JUNIPER	9		2 GAL	1.5M
TM	TAXUS X MEDIA 'DENSIFORMIS'	DENSE YEW	61	80CM	2 GAL	1.0M
PERENNIALS/GRASSES/GROUNDCOVERS						
PV	PANICUM VIRGATUM	SWITCH GRASS	28		1 GAL	0.75M
HS*	CALAMAGROSTIS CANADENSIS	CANADA BLUEJOINT	85		1 GAL	0.80M
	DESCHAMPSIA CESPITOSA	TUFTED HAIR GRASS	85		1 GAL	0.55M
	SORGHASTRUM NUTANS	INDIAN GRASS	85		1 GAL	0.45M

* PLACE IN GROUPINGS OF 3-5

THIS DRAWING HAS BEEN PREPARED BASED ON A BASE DRAWING PREPARED BY OTHERS. DILLON CONSULTING LIMITED CANNOT ASSURE THE ACCURACY OF OTHER'S INFORMATION AND IS NOT RESPONSIBLE FOR THE ACCURACY OF THE DOCUMENT OR FOR ANY ERROR OR OMISSION THAT MAY HAVE BEEN INCORPORATED INTO IT AS A RESULT. CONTRACTOR SHALL VERIFY THE ACCURACY PRIOR TO CONSTRUCTION.

TREE PROTECTION INFORMATION BASED ON TREE PRESERVATION PLAN AND ARBORIST REPORT PROVIDED BY 7 OAKS TREE CARE & URBAN FORESTRY CONSULTATIONS INC. DATED OCTOBER 2, 2019

SEE TREE PRESERVATION PLAN FOR INVENTORY AND RECOMMENDATIONS

Conditions of Use

Verify elevations and/or dimensions on drawing prior to use. Report any discrepancies to Dillon Consulting Limited.

Do not scale dimensions from drawing.

Do not modify drawing, re-use it, or use it for purposes other than those intended at the time of its preparation without prior written permission from Dillon Consulting Limited.



THE TDL GROUP CORP.
HEAD OFFICE
226 WYECROFT ROAD
OAKVILLE, ON
L6K 3X7
Ph (905) 339-6115
Fax (905) 845-1536



DESIGN	JG	REVIEWED BY	JB
DRAWN	JG	CHECKED BY	JB
DATE	August 2019		
SCALE	1:200		
1	SITE PLAN CONTROL	2019-11-29	JB
No.	ISSUED FOR	DATE	BY

16054 & 16060 Airport Road, Caledon, ON
Store #10XXXX

Tim Hortons
Landscape Plan

PROJECT NO.
19 9799

SHEET NO.

LP-1

DO NOT CUT LEADER

ALLOW FOR SETTLEMENT WHEN SETTING PLANTS, SET PLANTS 50mm HIGHER THAN ADJACENT FINISHED GRADE.

PROVIDE SAUCER 900mm DIA. AND 75mm HIGH AROUND BASE OF TREE, SAUCER TO BE SOAKED WITH WATER IMMEDIATELY AFTER INSTALLATION.

50x50x6mm STEEL "T" BARS DRILLED TO RECEIVE #11 GAL. WIRE ENCASED IN 25mm O.D. TWO PLY NEW BLACK RUBBER HOSE. DO NOT DRIVE STAKE THROUGH ROOT BALL. REMOVE BARS ONLY AT THE END OF THE WARRANTY PERIOD. DECIDUOUS TREES UP TO 75mm CAL. SHALL BE DOUBLE STAKED -DECIDUOUS TREES OVER 75mm CAL. SHALL BE TRIPLE STAKED.

REMOVE PROTECTIVE WRAPPING

75mm DEPTH OF SHREDDED PINE BARK MULCH

PROVIDE EDGE AROUND SAUCER AS SHOWN

REMOVE WIRE BASKET, ALL ROPE AND BURLAP FROM TOP 1/3 OF ROOT BALL BEFORE PLACING MULCH (SYNTHETIC BURLAP SHALL NOT BE USED ON ROOT BALL.)

BACKFILL WITH PLANTING MEDIUM AS SPECIFIED

COMPACTED SUBGRADE SCARIFY BOTTOM OF PLANTING BED

DECIDUOUS TREE
N.T.S.

TOPSOIL SAUCER WHERE NOT IN PLANTING BEDS
SPADE CUT EDGING
COMPACTED FILL OR UNDISTRIBUTED SUBSOIL

150mm MIN. TOPSOIL CLEARANCE, OR AS SPECIFIED
REST ROOTBALL ON 75-150mm OF PACKED SUBSOIL

SHRUB/ ORNAMENTAL GRASS PLANTING
N.T.S.

SAUCER OR BED TO BE SOAKED WITH WATER IMMEDIATELY AFTER PLANTING

FINISHED GRADE
REMOVE CONTAINER (SEE *)

BACKFILL WITH PLANTING MEDIUM AS SPECIFIED. PROVIDE CONTINUOUS PLANTING SOIL THROUGHOUT PLANTING BEDS.

* CONTAINER SIZE AS SPECIFIED
* CONTAINER TO BE CUT CAREFULLY AWAY FROM ROOT SYSTEM SO AS NOT TO DISTURB PLANT
* PLANTING BEDS TO HAVE 75mm DEPTH OF SHREDDED PINE BARK MULCH

GENERAL PLANTING NOTES

- ALL PLANT MATERIAL SHALL MEET THE "GUIDE SPECIFICATION FOR NURSERY STOCK" OF THE CANADIAN NURSERY TRADES ASSOCIATION AND SHALL BE PLANTED ACCORDING TO ACCEPTED NURSERY TRADE PRACTICES.
- TREES ARE TO BE NURSERY GROWN STOCK WITH TRUNKS, LIMBS, AND BASIC SHAPE TYPICAL OF ITS SPECIES. TREES SHALL HAVE STRAIGHT TRUNKS, BE WELL BRANCHED AND BE BALANCED WITH A STRONG CENTRAL LEADER.
- TREES SHALL BE MAINTAINED SO AS TO BE FREE FROM INSECTS, DISEASE, AND ALL PHYSICAL INJURY.
- ALL AREAS TO BE SODDED SHALL HAVE A MINIMUM DEPTH OF 150mm OF TOPSOIL. SOD IS TO CONFORM TO THE CANADIAN NURSERY SOD GROWERS SPECIFICATIONS.
- OBTAIN APPROVAL FOR SUBSTITUTIONS AS TO VARIETY, SIZE OR GRADE FROM THE LANDSCAPE ARCHITECT.
- ALL LANDSCAPE WORKS WILL BE GUARANTEED FOR TWO YEARS FOLLOWING INSPECTION. PLANT MATERIAL WHICH IS NOT IN A HEALTHY GROWING CONDITION TWO YEARS AFTER INSPECTION SHALL BE REPLACED TO THE SATISFACTION OF THE LANDSCAPE ARCHITECT OR OWNER WITH AN ADDITIONAL ONE YEAR MAINTENANCE GUARANTEE PERIOD. SUPPLY AND PLANT ALL REPLACEMENTS IN STRICT ACCORDANCE WITH PLANS AND SPECIFICATIONS.
- SITE VEGETATION SHALL BE MAINTAINED IN A HEALTHY, VIGOROUS, DISEASE AND PEST FREE CONDITION, OR BE REPLACED. DEAD, SEVERELY DAMAGED, OR DISEASED PLANT MATERIAL SHALL BE REPLACED AS SOON AS POSSIBLE.
- DETERMINE THE LOCATION OF ALL EXISTING SERVICES AND OBTAIN NECESSARY STAKE-OUTS BEFORE ANY EXCAVATION.
- REPORT ANY DISCREPANCIES TO THE LANDSCAPE ARCHITECT PRIOR TO CONSTRUCTION.
- PLANTING MEDIUM FOR TREES AND SHRUBS: TOPSOIL SHALL BE A FERTILE, FRIABLE, NATURAL SANDY LOAM FREE OF STONES, SUBSOIL, REFUSE OR OTHER EXTRANEOUS MATERIALS, AND CAPABLE OF SUSTAINING HEALTHY PLANT GROWTH. PLANTING MEDIUM TO BE 6 PARTS TOPSOIL, 2 PARTS DECOMPOSED WEED-FREE MANURE, 1 PART PEAT MOSS AND 0.75 kg SUPERPHOSPHATE PER CUBIC METRE (TRIPLE MIX).
- CONTRACTORS AND SUBCONTRACTORS TO HAVE A MINIMUM OF 5 YEARS CANADIAN EXPERIENCE IN THE SUCCESSFUL EXECUTION OF WORK OF THIS TYPE.
- STONE TO BE LIMESTONE MIN 60CM HIGH X 60CM WIDE X 100CM LONG. PLACE STONE OVER 150mm GRANULAR 'A' GRAVEL, AND BURY A MINIMUM OF 75mm.

IRRIGATION NOTES:

- CONTRACTOR TO DESIGN AND BUILD A FULLY AUTOMATIC UNDERGROUND IRRIGATION SYSTEM FOR ALL NEW LANDSCAPED AREAS. CONTRACTOR TO PROVIDE SHOP DRAWINGS TO LANDSCAPE ARCHITECT FOR APPROVAL. SHOP DRAWINGS TO BE STAMPED BY A CERTIFIED IRRIGATION DESIGNER.
- AUTOMATIC IRRIGATION SYSTEM TO BE WATER CONSERVING.
- IRRIGATION SYSTEM TO BE DESIGNED AND INSTALLED BY AN IRRIGATION CONTRACTOR WITH A MINIMUM OF FIVE YEARS EXPERIENCE.
- ALL WORK SHALL BE CARRIED OUT IN ACCORDANCE WITH BY-LAWS AND CODES HAVING JURISDICTION OVER SITE LOCATION.
- IT IS THE RESPONSIBILITY OF THE PLAN USER TO INFORM THEMSELVES OF THE EXACT LOCATION OF ALL POLES, LINES, CONDUIT, WATER MAINS, SEWERS AND OTHER UNDERGROUND AND OVERHEAD UTILITIES AND STRUCTURES BEFORE COMMENCING WORK.
- ACTUAL LOCATION OF SPRINKLERS TO BE DETERMINED AT TIME OF CONSTRUCTION.
- ALL SPRAY HEADS TO BE PRESSURE COMPENSATED
- ALL SPRINKLERS LOCATED IN THE SHRUB BEDS TO BE HI-POP SPRINKLERS
- IT IS THE RESPONSIBILITY OF THE PLAN USER TO INFORM THEMSELVES OF THE EXACT MATERIAL QUANTITIES REQUIRED
- ELECTRICAL CONTRACTOR IS TO PROVIDE 110 VOLT POWER SUPPLY TO THE IRRIGATION CONTROLLER AND 1" ELECTRICAL CONDUITS FROM THE CONTROLLERS TO THE WATER SUPPLY POINT OF CONNECTION OUTSIDE OF THE BUILDING.
- ALL VALVE BOXES TO BE SECURED WITH SECURITY LOCKING SCREWS.
- IRRIGATION TO PROVIDE FULL, EVEN COVERAGE OF PLANTED AREAS WITHOUT SPRAYING ONTO BUILDINGS, SIDEWALKS, FENCES, ETC.
- ARRANGE VALVE STATIONS TO OPERATE IN AN EASY-TO-VIEW PROGRESSIVE SEQUENCE AROUND BUILDING. RECORD SEQUENCE ON CONTROLLER LID.
- THE CONTROLLER SHALL BE OF A HYBRID TYPE THAT COMBINES ELECTRO-MECHANICAL AND MICROELECTRONIC CIRCUITRY CAPABLE OF FULLY AUTOMATIC OR MANUAL OPERATION.
- ALL POLYETHYLENE PIPE SHALL HAVE A MINIMUM 75-PSI PRESSURE RATING
- P.V.C. PIPE WILL BE CLASS 160 (SDR26) DIRECT BURIAL PIPE CONFORMING TO CS-256-63 AND WILL BE HOMOGENEOUS THROUGHOUT AND FREE FROM VISIBLE CRACKS, DENTS, HOLES OR FOREIGN MATERIALS.
- AFTER SYSTEM IS INSTALLED AND APPROVED, INSTRUCT OWNER'S DESIGNATED PERSONNEL IN COMPLETE OPERATION AND MAINTENANCE PROCEDURES.
- PROVIDE STANDARD ONE-YEAR GUARANTEE ON WORKMANSHIP AS WELL AS PRODUCT WARRANTY INCLUDING BLOW OUT TO PROTECT FROM FREEZE DAMAGE AND ADJUSTMENT TO SUPPLY PROPER COVERAGE OF AREAS TO RECEIVE WATER.

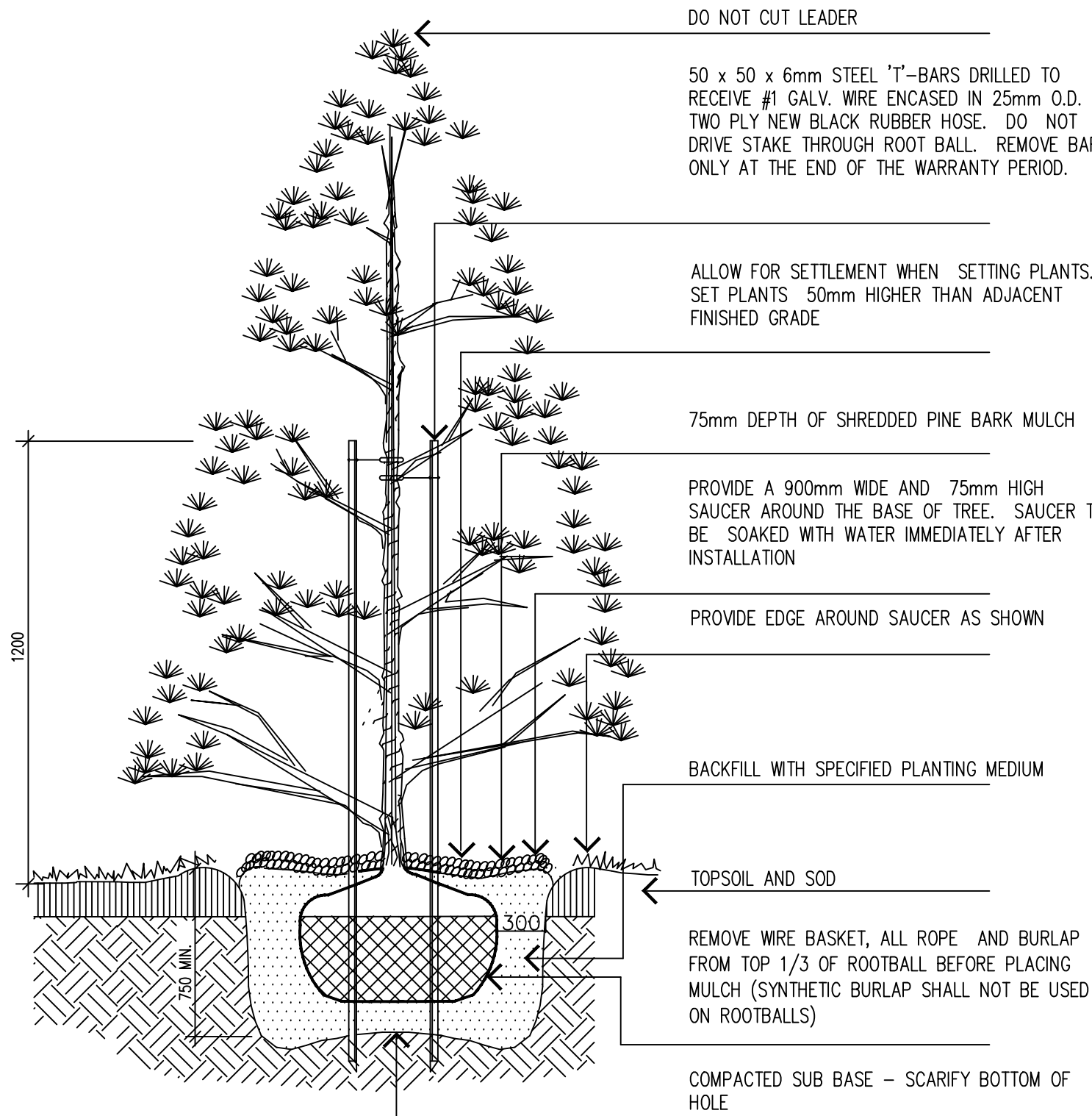

EVERGREEN TREES
N.T.S.

50mm (2") SQUARE HOLLOW TUBULAR STEEL POST WITH ORNAMENTAL BALL POST CAP. BOLT TO CONCRETE SLAB WITH FOUR GALVANIZED STEEL ANCHOR BOLTS PER POST.

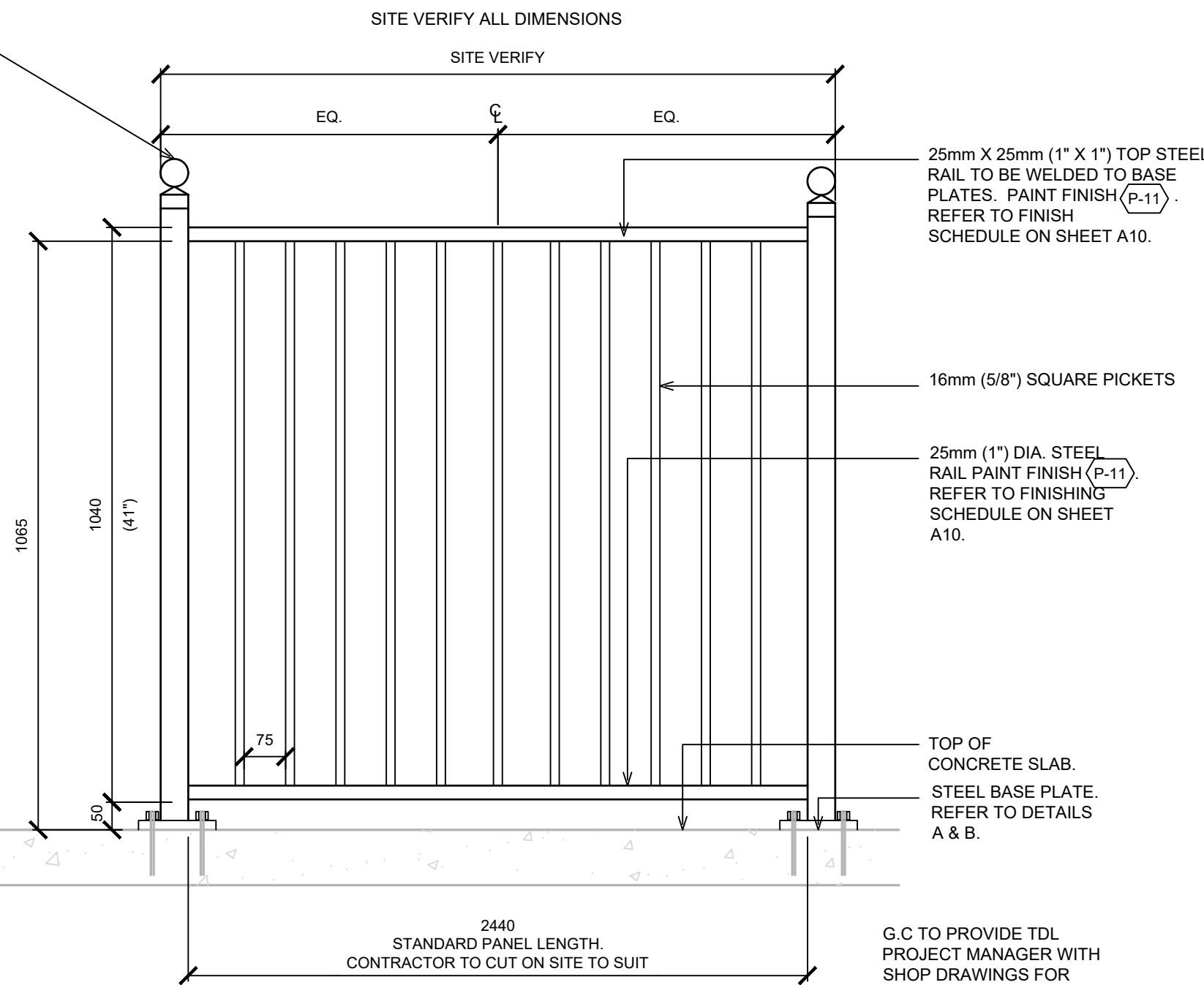
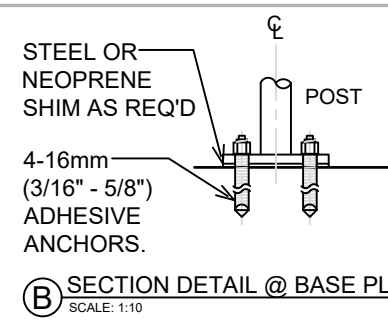
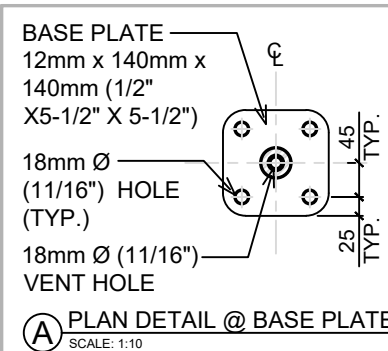

DECORATIVE METAL FENCE DETAIL
N.T.S.

NOTE: ANCHOR SUPPORTS TO BE IN CONFORMANCE WITH ONTARIO PROVINCIAL STANDARD DRAWING OPSD - 512.011

FENCE SUPPLIER: ROMA FENCE
CONTACT: CHRISTINA MARRA
905 794-0416 (PHONE)
905 794-0276 (FAX)
STYLE OF FENCE: LIBERTY - 41" HIGH IN COLOUR BLACK

TDL STANDARD DETAILS HAVE BEEN DESIGNED BY OTHERS

Conditions of Use

Verify elevations and/or dimensions on drawing prior to use. Report any discrepancies to Dillon Consulting Limited.

Do not scale dimensions from drawing.

Do not modify drawing, re-use it, or use it for purposes other than those intended at the time of its preparation without prior written permission from Dillon Consulting Limited.



THE TDL GROUP CORP.
HEAD OFFICE
226 WYECROFT ROAD
OAKVILLE, ON
L6K 3X7
Ph (905) 339-6115
Fax (905) 845-1536



DESIGN	REVIEWED BY
DRAWN	CHECKED BY
DATE	August 2019
SCALE	1:200
1 SITE PLAN CONTROL	2019-11-29 JB
No.	ISSUED FOR

DATE	BY
------	----

16054 & 16060 Airport Road, Caledon, ON
Store #10XXXX

Tim Hortons
Landscape Plan

PROJECT NO.
19 9799

SHEET NO.
LP-2